



Three Rivers Forestry  
PO Box 764  
Tappahannock, VA 22560  
(804) 445-5774

Date: April 3, 2026  
Time: 3:00 PM  
Size: 79 Acres

Total Vol: 1,525.9 MBF  
Vol/Acre: 19.32 MBF

**Timber Sale Notice  
Clear-Cut  
Hardwood and Pine Timber**

Three Rivers Forestry has been contracted to sell the merchantable timber belonging to Jeff Hinton by sealed bid on 79 acres, located 0.7 miles northwest of Lara, on the north side of RT. 600 (Ridge Road) in Northumberland County, Virginia (see attached map).

A 10% sample cruise of the standing sawtimber and pulpwood has been made. All pine and hardwood trees 10 inches DBH and larger were tallied as sawtimber. All sawtimber volumes were calculated using the International Log Rule and pulpwood volumes are based on standard cords of 128 cubic feet. An estimate of the timber volume is provided; however, no guarantee is expressed or implied as to the actual timber that may be harvested due to individual utilization practices.

|                |                    |                                     |
|----------------|--------------------|-------------------------------------|
| Loblolly Pine  | 649.1 MBF          | Pine Pulpwood - 56 Cords            |
| Yellow Poplar  | 591.5 MBF          |                                     |
| White Oak      | 102.2 MBF          |                                     |
| Red Oak        | 78.3 MBF           | Hardwood Pulpwood - 150 Cords       |
| Gum            | 41.1 MBF           |                                     |
| American Beech | 37.0 MBF           |                                     |
| Virginia Pine  | 11.7 MBF           |                                     |
| Misc. Hardwood | 11.4 MBF           |                                     |
| Hickory        | 3.6 MBF            |                                     |
| <b>Total</b>   | <b>1,525.9 MBF</b> | <b>International 1/4 inch scale</b> |

**Bids will be accepted subject to the following conditions:**

1. The purchaser will have two (2) years to cut and remove the timber from the date the contract is signed.
2. Timber harvesting will be done in accordance to Forestry Best Management Practices (BMP's) as stipulated by guidelines set forth by the Virginia Department of Forestry.
3. The owner requires proof of worker's compensation and liability insurance.
4. Landowner assumes responsibility for the VA. Seed Tree Law.
5. The timber purchase contract will be executed within 30 days of bid opening.
6. Access permitted by Ingress and Egress from RT. 600 (Ridge Road) using farm roads and field crossings as needed.

Lump-sum sealed bids will be accepted **Friday, April 3, 2026** at the office of Three Rivers Forestry (990 Richmond Hwy, Tappahannock, VA) at **3:00 PM** or by mailing to Three Rivers Forestry, PO Box 764, Tappahannock, VA 22560 or calling **(804) 580-1063** or emailing **bid@trfva.com** prior to the sale. Mail bids should be marked **Sealed Bid, Hinton Tract**. Bidder is responsible for verifying receipt of mail bids prior to the sale. Only sealed bids will be accepted and the landowner reserves the right to refuse any or all bids.

Prospective buyers are invited to inspect the timber at any time. Any questions regarding the terms of sale or location of the tract should be directed to Three Rivers Forestry.

Submitted By:

Daniel Deitz  
Consulting Forester

# VOLUME ANALYSIS

Tract: Jeff Hinton  
 Cruised By: Daniel Deitz

Acres: 79  
 Date: 12/3/2024

| Loblolly Pine  |           |           |            |            |             |             |            |             |              |         |
|----------------|-----------|-----------|------------|------------|-------------|-------------|------------|-------------|--------------|---------|
| Number of Logs |           |           |            |            |             |             |            |             |              |         |
| DBH            | 1         | 1 1/2     | 2          | 2 1/2      | 3           | 3 1/2       | 4          | Trees       | Vol          |         |
| 10             | 10        | 10        | 100        | 150        | 40          | 0           | 0          | 310         | 20.4         | Avg DBH |
| 11             | 0         | 0         | 20         | 180        | 110         | 0           | 0          | 310         | 28.6         | 13.6    |
| 12             | 0         | 0         | 20         | 90         | 210         | 60          | 0          | 380         | 45.8         | Tot Vol |
| 13             | 0         | 0         | 10         | 10         | 240         | 220         | 10         | 490         | 77.1         | 171.8   |
| 14             | 20        | 0         | 10         | 30         | 200         | 210         | 20         | 490         | 89.6         |         |
| 15             | 0         | 0         | 0          | 40         | 120         | 110         | 30         | 300         | 66.4         |         |
| 16             | 0         | 0         | 0          | 10         | 90          | 230         | 70         | 400         | 106.6        |         |
| 17             | 0         | 0         | 10         | 0          | 20          | 30          | 80         | 140         | 44.4         |         |
| 18             | 0         | 0         | 0          | 0          | 50          | 50          | 20         | 120         | 41.8         |         |
| 19             | 0         | 0         | 10         | 0          | 30          | 70          | 70         | 180         | 73.2         |         |
| 20             | 0         | 0         | 0          | 0          | 20          | 10          | 10         | 40          | 17.8         |         |
| 21             | 0         | 0         | 0          | 10         | 0           | 30          | 10         | 50          | 24.9         |         |
| 22             | 0         | 0         | 0          | 0          | 0           | 0           | 0          | 0           | 0.0          |         |
| 23             | 0         | 0         | 0          | 0          | 10          | 0           | 0          | 10          | 5.7          | Tot Vol |
| 24             | 0         | 0         | 0          | 0          | 0           | 0           | 0          | 0           | 0.0          | 477.3   |
| 25             | 0         | 0         | 0          | 0          | 10          | 0           | 0          | 10          | 6.8          |         |
| 26             | 0         | 0         | 0          | 0          | 0           | 0           | 0          | 0           | 0.0          |         |
| 27             | 0         | 0         | 0          | 0          | 0           | 0           | 0          | 0           | 0.0          |         |
| 28             | 0         | 0         | 0          | 0          | 0           | 0           | 0          | 0           | 0.0          |         |
| 29             | 0         | 0         | 0          | 0          | 0           | 0           | 0          | 0           | 0.0          |         |
| 30+            | 0         | 0         | 0          | 0          | 0           | 0           | 0          | 0           | 0.0          |         |
| <b>TOTAL</b>   | <b>30</b> | <b>10</b> | <b>180</b> | <b>520</b> | <b>1150</b> | <b>1020</b> | <b>320</b> | <b>3230</b> | <b>649.1</b> |         |

| Virginia Pine  |          |          |           |           |          |          |          |            |             |         |
|----------------|----------|----------|-----------|-----------|----------|----------|----------|------------|-------------|---------|
| Number of Logs |          |          |           |           |          |          |          |            |             |         |
| DBH            | 1        | 1 1/2    | 2         | 2 1/2     | 3        | 3 1/2    | 4        | Trees      | Vol         |         |
| 10             | 0        | 0        | 20        | 0         | 0        | 0        | 0        | 20         | 1.2         | Avg DBH |
| 11             | 0        | 0        | 0         | 10        | 0        | 0        | 0        | 10         | 0.9         | 12.1    |
| 12             | 0        | 0        | 10        | 30        | 0        | 0        | 0        | 40         | 4.3         | Tot Vol |
| 13             | 0        | 0        | 0         | 0         | 0        | 0        | 0        | 0          | 0.0         | 6.4     |
| 14             | 0        | 0        | 0         | 20        | 0        | 0        | 0        | 20         | 3.2         |         |
| 15             | 0        | 0        | 0         | 0         | 0        | 0        | 0        | 0          | 0.0         |         |
| 16             | 0        | 0        | 0         | 0         | 0        | 0        | 0        | 0          | 0.0         |         |
| 17             | 0        | 0        | 10        | 0         | 0        | 0        | 0        | 10         | 2.1         |         |
| 18             | 0        | 0        | 0         | 0         | 0        | 0        | 0        | 0          | 0.0         |         |
| 19             | 0        | 0        | 0         | 0         | 0        | 0        | 0        | 0          | 0.0         |         |
| 20             | 0        | 0        | 0         | 0         | 0        | 0        | 0        | 0          | 0.0         |         |
| 21             | 0        | 0        | 0         | 0         | 0        | 0        | 0        | 0          | 0.0         |         |
| 22             | 0        | 0        | 0         | 0         | 0        | 0        | 0        | 0          | 0.0         |         |
| 23             | 0        | 0        | 0         | 0         | 0        | 0        | 0        | 0          | 0.0         | Tot Vol |
| 24             | 0        | 0        | 0         | 0         | 0        | 0        | 0        | 0          | 0.0         | 5.3     |
| 25             | 0        | 0        | 0         | 0         | 0        | 0        | 0        | 0          | 0.0         |         |
| 26             | 0        | 0        | 0         | 0         | 0        | 0        | 0        | 0          | 0.0         |         |
| 27             | 0        | 0        | 0         | 0         | 0        | 0        | 0        | 0          | 0.0         |         |
| 28             | 0        | 0        | 0         | 0         | 0        | 0        | 0        | 0          | 0.0         |         |
| 29             | 0        | 0        | 0         | 0         | 0        | 0        | 0        | 0          | 0.0         |         |
| 30+            | 0        | 0        | 0         | 0         | 0        | 0        | 0        | 0          | 0.0         |         |
| <b>TOTAL</b>   | <b>0</b> | <b>0</b> | <b>40</b> | <b>60</b> | <b>0</b> | <b>0</b> | <b>0</b> | <b>100</b> | <b>11.7</b> |         |

| White Oak      |            |            |            |           |          |          |          |            |              |         |
|----------------|------------|------------|------------|-----------|----------|----------|----------|------------|--------------|---------|
| Number of Logs |            |            |            |           |          |          |          |            |              |         |
| DBH            | 1          | 1 1/2      | 2          | 2 1/2     | 3        | 3 1/2    | 4        | Trees      | Vol          |         |
| 10             | 40         | 0          | 0          | 0         | 0        | 0        | 0        | 40         | 1.5          | Avg DBH |
| 11             | 90         | 20         | 0          | 0         | 0        | 0        | 0        | 110        | 5.6          | 14.0    |
| 12             | 80         | 0          | 10         | 0         | 0        | 0        | 0        | 90         | 5.6          | Tot Vol |
| 13             | 20         | 40         | 60         | 0         | 0        | 0        | 0        | 120        | 12.2         | 24.9    |
| 14             | 20         | 20         | 40         | 0         | 0        | 0        | 0        | 80         | 9.4          |         |
| 15             | 0          | 30         | 20         | 10        | 0        | 0        | 0        | 60         | 8.9          |         |
| 16             | 20         | 10         | 30         | 0         | 0        | 0        | 0        | 60         | 9.1          |         |
| 17             | 10         | 10         | 40         | 10        | 0        | 0        | 0        | 70         | 13.9         |         |
| 18             | 0          | 20         | 20         | 0         | 0        | 0        | 0        | 40         | 8.6          |         |
| 19             | 0          | 0          | 0          | 10        | 0        | 0        | 0        | 10         | 3.2          |         |
| 20             | 10         | 0          | 30         | 0         | 0        | 0        | 0        | 40         | 10.9         |         |
| 21             | 0          | 0          | 0          | 0         | 0        | 0        | 0        | 0          | 0.0          |         |
| 22             | 0          | 10         | 0          | 0         | 0        | 0        | 0        | 10         | 3.0          |         |
| 23             | 0          | 0          | 0          | 0         | 0        | 0        | 0        | 0          | 0.0          | Tot Vol |
| 24             | 0          | 0          | 0          | 0         | 0        | 0        | 0        | 0          | 0.0          | 77.3    |
| 25             | 0          | 0          | 0          | 0         | 0        | 0        | 0        | 0          | 0.0          |         |
| 26             | 0          | 0          | 10         | 0         | 0        | 0        | 0        | 10         | 5.4          |         |
| 27             | 0          | 0          | 0          | 0         | 0        | 0        | 0        | 0          | 0.0          |         |
| 28             | 0          | 10         | 0          | 0         | 0        | 0        | 0        | 10         | 5.0          |         |
| 29             | 0          | 0          | 0          | 0         | 0        | 0        | 0        | 0          | 0.0          |         |
| 30+            | 0          | 0          | 0          | 0         | 0        | 0        | 0        | 0          | 0.0          |         |
| <b>TOTAL</b>   | <b>290</b> | <b>170</b> | <b>260</b> | <b>30</b> | <b>0</b> | <b>0</b> | <b>0</b> | <b>750</b> | <b>102.2</b> |         |

| Red Oak        |            |            |            |           |          |          |          |            |             |         |
|----------------|------------|------------|------------|-----------|----------|----------|----------|------------|-------------|---------|
| Number of Logs |            |            |            |           |          |          |          |            |             |         |
| DBH            | 1          | 1 1/2      | 2          | 2 1/2     | 3        | 3 1/2    | 4        | Trees      | Vol         |         |
| 10             | 10         | 0          | 0          | 0         | 0        | 0        | 0        | 10         | 0.4         | Avg DBH |
| 11             | 30         | 0          | 0          | 0         | 0        | 0        | 0        | 30         | 1.4         | 16.3    |
| 12             | 30         | 10         | 0          | 0         | 0        | 0        | 0        | 40         | 2.5         | Tot Vol |
| 13             | 20         | 20         | 20         | 0         | 0        | 0        | 0        | 60         | 5.6         | 9.9     |
| 14             | 0          | 0          | 10         | 0         | 0        | 0        | 0        | 10         | 1.4         |         |
| 15             | 10         | 0          | 10         | 10        | 0        | 0        | 0        | 30         | 4.4         |         |
| 16             | 10         | 0          | 0          | 0         | 0        | 0        | 0        | 10         | 1.1         |         |
| 17             | 0          | 10         | 20         | 0         | 0        | 0        | 0        | 30         | 5.9         |         |
| 18             | 0          | 10         | 0          | 0         | 0        | 0        | 0        | 10         | 1.9         |         |
| 19             | 0          | 0          | 40         | 0         | 0        | 0        | 0        | 40         | 10.9        |         |
| 20             | 10         | 10         | 10         | 10        | 0        | 0        | 0        | 40         | 10.8        |         |
| 21             | 0          | 20         | 0          | 0         | 0        | 0        | 0        | 20         | 5.4         |         |
| 22             | 10         | 10         | 10         | 0         | 0        | 0        | 0        | 30         | 8.9         |         |
| 23             | 0          | 10         | 0          | 0         | 0        | 0        | 0        | 10         | 3.3         | Tot Vol |
| 24             | 0          | 10         | 0          | 0         | 0        | 0        | 0        | 10         | 3.6         | 68.3    |
| 25             | 0          | 0          | 0          | 0         | 0        | 0        | 0        | 0          | 0.0         |         |
| 26             | 0          | 0          | 10         | 0         | 0        | 0        | 0        | 10         | 5.4         |         |
| 27             | 0          | 0          | 0          | 0         | 0        | 0        | 0        | 0          | 0.0         |         |
| 28             | 0          | 0          | 0          | 0         | 0        | 0        | 0        | 0          | 0.0         |         |
| 29             | 0          | 10         | 0          | 0         | 0        | 0        | 0        | 10         | 5.4         |         |
| 30+            | 0          | 0          | 0          | 0         | 0        | 0        | 0        | 0          | 0.0         |         |
| <b>TOTAL</b>   | <b>130</b> | <b>120</b> | <b>130</b> | <b>20</b> | <b>0</b> | <b>0</b> | <b>0</b> | <b>400</b> | <b>78.3</b> |         |

| Misc Hardwood  |            |           |           |          |          |          |          |            |             |         |
|----------------|------------|-----------|-----------|----------|----------|----------|----------|------------|-------------|---------|
| Number of Logs |            |           |           |          |          |          |          |            |             |         |
| DBH            | 1          | 1 1/2     | 2         | 2 1/2    | 3        | 3 1/2    | 4        | Trees      | Vol         |         |
| 10             | 20         | 0         | 0         | 0        | 0        | 0        | 0        | 20         | 0.8         | Avg DBH |
| 11             | 40         | 0         | 0         | 0        | 0        | 0        | 0        | 40         | 1.9         | 12.3    |
| 12             | 10         | 0         | 0         | 0        | 0        | 0        | 0        | 10         | 0.6         | Tot Vol |
| 13             | 10         | 0         | 0         | 0        | 0        | 0        | 0        | 10         | 0.7         | 4.0     |
| 14             | 10         | 20        | 0         | 0        | 0        | 0        | 0        | 30         | 3.0         |         |
| 15             | 10         | 0         | 0         | 0        | 0        | 0        | 0        | 10         | 1.0         |         |
| 16             | 0          | 0         | 10        | 0        | 0        | 0        | 0        | 10         | 1.8         |         |
| 17             | 0          | 10        | 0         | 0        | 0        | 0        | 0        | 10         | 1.7         |         |
| 18             | 0          | 0         | 0         | 0        | 0        | 0        | 0        | 0          | 0.0         |         |
| 19             | 0          | 0         | 0         | 0        | 0        | 0        | 0        | 0          | 0.0         |         |
| 20             | 0          | 0         | 0         | 0        | 0        | 0        | 0        | 0          | 0.0         |         |
| 21             | 0          | 0         | 0         | 0        | 0        | 0        | 0        | 0          | 0.0         |         |
| 22             | 0          | 0         | 0         | 0        | 0        | 0        | 0        | 0          | 0.0         |         |
| 23             | 0          | 0         | 0         | 0        | 0        | 0        | 0        | 0          | 0.0         | Tot Vol |
| 24             | 0          | 0         | 0         | 0        | 0        | 0        | 0        | 0          | 0.0         | 7.5     |
| 25             | 0          | 0         | 0         | 0        | 0        | 0        | 0        | 0          | 0.0         |         |
| 26             | 0          | 0         | 0         | 0        | 0        | 0        | 0        | 0          | 0.0         |         |
| 27             | 0          | 0         | 0         | 0        | 0        | 0        | 0        | 0          | 0.0         |         |
| 28             | 0          | 0         | 0         | 0        | 0        | 0        | 0        | 0          | 0.0         |         |
| 29             | 0          | 0         | 0         | 0        | 0        | 0        | 0        | 0          | 0.0         |         |
| 30+            | 0          | 0         | 0         | 0        | 0        | 0        | 0        | 0          | 0.0         |         |
| <b>TOTAL</b>   | <b>100</b> | <b>30</b> | <b>10</b> | <b>0</b> | <b>0</b> | <b>0</b> | <b>0</b> | <b>140</b> | <b>11.4</b> |         |

| Poplar         |            |            |            |            |            |           |          |             |              |         |
|----------------|------------|------------|------------|------------|------------|-----------|----------|-------------|--------------|---------|
| Number of Logs |            |            |            |            |            |           |          |             |              |         |
| DBH            | 1          | 1 1/2      | 2          | 2 1/2      | 3          | 3 1/2     | 4        | Trees       | Vol          |         |
| 10             | 80         | 40         | 10         | 0          | 0          | 0         | 0        | 130         | 5.6          | Avg DBH |
| 11             | 20         | 20         | 40         | 0          | 0          | 0         | 0        | 80          | 5.3          | 16.9    |
| 12             | 0          | 30         | 60         | 50         | 0          | 0         | 0        | 140         | 13.6         | Tot Vol |
| 13             | 10         | 10         | 70         | 50         | 30         | 0         | 0        | 170         | 21.2         | 45.7    |
| 14             | 10         | 10         | 40         | 70         | 20         | 0         | 0        | 150         | 22.3         |         |
| 15             | 0          | 10         | 30         | 20         | 70         | 10        | 0        | 140         | 27.1         |         |
| 16             | 10         | 10         | 40         | 30         | 100        | 0         | 0        | 190         | 40.9         |         |
| 17             | 0          | 0          | 60         | 50         | 120        | 10        | 0        | 240         | 62.6         |         |
| 18             | 0          | 10         | 60         | 40         | 60         | 30        | 0        | 200         | 57.8         |         |
| 19             | 0          | 10         | 0          | 10         | 70         | 20        | 0        | 110         | 39.4         |         |
| 20             | 10         | 10         | 10         | 60         | 30         | 0         | 0        | 120         | 41.2         |         |
| 21             | 0          | 0          | 30         | 30         | 60         | 10        | 0        | 130         | 55.3         |         |
| 22             | 0          | 0          | 20         | 10         | 0          | 0         | 0        | 30          | 12.0         |         |
| 23             | 0          | 0          | 0          | 20         | 0          | 0         | 0        | 20          | 9.9          | Tot Vol |
| 24             | 0          | 0          | 20         | 40         | 20         | 0         | 0        | 80          | 43.4         | 645.8   |
| 25             | 10         | 0          | 0          | 0          | 10         | 10        | 0        | 30          | 17.2         |         |
| 26             | 10         | 10         | 10         | 10         | 0          | 0         | 0        | 40          | 19.1         |         |
| 27             | 0          | 10         | 10         | 20         | 0          | 0         | 0        | 40          | 24.5         |         |
| 28             | 0          | 10         | 0          | 20         | 0          | 0         | 0        | 30          | 20.1         |         |
| 29             | 0          | 0          | 0          | 0          | 10         | 0         | 0        | 10          | 9.5          |         |
| 30+            | 0          | 0          | 40         | 10         | 0          | 0         | 0        | 50          | 43.5         |         |
| <b>TOTAL</b>   | <b>160</b> | <b>190</b> | <b>550</b> | <b>540</b> | <b>600</b> | <b>90</b> | <b>0</b> | <b>2130</b> | <b>591.5</b> |         |

| Gum            |            |           |            |           |          |          |          |            |             |         |
|----------------|------------|-----------|------------|-----------|----------|----------|----------|------------|-------------|---------|
| Number of Logs |            |           |            |           |          |          |          |            |             |         |
| DBH            | 1          | 1 1/2     | 2          | 2 1/2     | 3        | 3 1/2    | 4        | Trees      | Vol         |         |
| 10             | 60         | 0         | 10         | 0         | 0        | 0        | 0        | 70         | 2.9         | Avg DBH |
| 11             | 20         | 0         | 10         | 0         | 0        | 0        | 0        | 30         | 1.7         | 12.6    |
| 12             | 20         | 10        | 10         | 20        | 0        | 0        | 0        | 60         | 5.1         | Tot Vol |
| 13             | 0          | 20        | 40         | 10        | 0        | 0        | 0        | 70         | 7.9         | 17.6    |
| 14             | 30         | 10        | 30         | 0         | 0        | 0        | 0        | 70         | 7.7         |         |
| 15             | 0          | 10        | 10         | 0         | 0        | 0        | 0        | 20         | 2.9         |         |
| 16             | 0          | 0         | 10         | 0         | 0        | 0        | 0        | 10         | 1.8         |         |
| 17             | 0          | 0         | 0          | 10        | 0        | 0        | 0        | 10         | 2.5         |         |
| 18             | 0          | 0         | 0          | 0         | 0        | 0        | 0        | 0          | 0.0         |         |
| 19             | 0          | 0         | 10         | 0         | 0        | 0        | 0        | 10         | 2.7         |         |
| 20             | 0          | 0         | 0          | 0         | 0        | 0        | 0        | 0          | 0.0         |         |
| 21             | 0          | 0         | 0          | 0         | 0        | 0        | 0        | 0          | 0.0         |         |
| 22             | 0          | 0         | 0          | 0         | 0        | 0        | 0        | 0          | 0.0         |         |
| 23             | 0          | 0         | 0          | 0         | 0        | 0        | 0        | 0          | 0.0         | Tot Vol |
| 24             | 0          | 0         | 0          | 0         | 0        | 0        | 0        | 0          | 0.0         | 23.5    |
| 25             | 0          | 0         | 0          | 0         | 0        | 0        | 0        | 0          | 0.0         |         |
| 26             | 0          | 0         | 0          | 0         | 0        | 0        | 0        | 0          | 0.0         |         |
| 27             | 0          | 0         | 10         | 0         | 0        | 0        | 0        | 10         | 5.9         |         |
| 28             | 0          | 0         | 0          | 0         | 0        | 0        | 0        | 0          | 0.0         |         |
| 29             | 0          | 0         | 0          | 0         | 0        | 0        | 0        | 0          | 0.0         |         |
| 30+            | 0          | 0         | 0          | 0         | 0        | 0        | 0        | 0          | 0.0         |         |
| <b>TOTAL</b>   | <b>130</b> | <b>50</b> | <b>140</b> | <b>40</b> | <b>0</b> | <b>0</b> | <b>0</b> | <b>360</b> | <b>41.1</b> |         |

| Hickory        |           |          |          |          |          |          |          |           |            |         |
|----------------|-----------|----------|----------|----------|----------|----------|----------|-----------|------------|---------|
| Number of Logs |           |          |          |          |          |          |          |           |            |         |
| DBH            | 1         | 1 1/2    | 2        | 2 1/2    | 3        | 3 1/2    | 4        | Trees     | Vol        |         |
| 10             | 20        | 0        | 0        | 0        | 0        | 0        | 0        | 20        | 0.8        | Avg DBH |
| 11             | 10        | 0        | 0        | 0        | 0        | 0        | 0        | 10        | 0.5        | 12.9    |
| 12             | 0         | 0        | 0        | 0        | 0        | 0        | 0        | 0         | 0.0        | Tot Vol |
| 13             | 0         | 0        | 0        | 0        | 0        | 0        | 0        | 0         | 0.0        | 1.2     |
| 14             | 0         | 0        | 0        | 0        | 0        | 0        | 0        | 0         | 0.0        |         |
| 15             | 0         | 0        | 0        | 0        | 0        | 0        | 0        | 0         | 0.0        |         |
| 16             | 0         | 0        | 0        | 0        | 0        | 0        | 0        | 0         | 0.0        |         |
| 17             | 0         | 0        | 0        | 0        | 0        | 0        | 0        | 0         | 0.0        |         |
| 18             | 0         | 0        | 0        | 0        | 0        | 0        | 0        | 0         | 0.0        |         |
| 19             | 0         | 0        | 0        | 0        | 0        | 0        | 0        | 0         | 0.0        |         |
| 20             | 0         | 0        | 0        | 0        | 0        | 0        | 0        | 0         | 0.0        |         |
| 21             | 0         | 0        | 0        | 0        | 0        | 0        | 0        | 0         | 0.0        |         |
| 22             | 0         | 0        | 0        | 0        | 0        | 0        | 0        | 0         | 0.0        |         |
| 23             | 10        | 0        | 0        | 0        | 0        | 0        | 0        | 10        | 2.4        | Tot Vol |
| 24             | 0         | 0        | 0        | 0        | 0        | 0        | 0        | 0         | 0.0        | 2.4     |
| 25             | 0         | 0        | 0        | 0        | 0        | 0        | 0        | 0         | 0.0        |         |
| 26             | 0         | 0        | 0        | 0        | 0        | 0        | 0        | 0         | 0.0        |         |
| 27             | 0         | 0        | 0        | 0        | 0        | 0        | 0        | 0         | 0.0        |         |
| 28             | 0         | 0        | 0        | 0        | 0        | 0        | 0        | 0         | 0.0        |         |
| 29             | 0         | 0        | 0        | 0        | 0        | 0        | 0        | 0         | 0.0        |         |
| 30+            | 0         | 0        | 0        | 0        | 0        | 0        | 0        | 0         | 0.0        |         |
| <b>TOTAL</b>   | <b>40</b> | <b>0</b> | <b>0</b> | <b>0</b> | <b>0</b> | <b>0</b> | <b>0</b> | <b>40</b> | <b>3.6</b> |         |

| Chestnut Oak   |   |       |   |       |   |       |   |       |     |         |
|----------------|---|-------|---|-------|---|-------|---|-------|-----|---------|
| Number of Logs |   |       |   |       |   |       |   |       |     |         |
| DBH            | 1 | 1 1/2 | 2 | 2 1/2 | 3 | 3 1/2 | 4 | Trees | Vol |         |
| 10             |   |       |   |       |   |       |   |       |     | Avg DBH |
| 11             |   |       |   |       |   |       |   |       |     |         |
| 12             |   |       |   |       |   |       |   |       |     | Tot Vol |
| 13             |   |       |   |       |   |       |   |       |     | 0.0     |
| 14             |   |       |   |       |   |       |   |       |     |         |
| 15             |   |       |   |       |   |       |   |       |     |         |
| 16             |   |       |   |       |   |       |   |       |     |         |
| 17             |   |       |   |       |   |       |   |       |     |         |
| 18             |   |       |   |       |   |       |   |       |     |         |
| 19             |   |       |   |       |   |       |   |       |     |         |
| 20             |   |       |   |       |   |       |   |       |     |         |
| 21             |   |       |   |       |   |       |   |       |     |         |
| 22             |   |       |   |       |   |       |   |       |     |         |
| 23             |   |       |   |       |   |       |   |       |     | Tot Vol |
| 24             |   |       |   |       |   |       |   |       |     | 0.0     |
| 25             |   |       |   |       |   |       |   |       |     |         |
| 26             |   |       |   |       |   |       |   |       |     |         |
| 27             |   |       |   |       |   |       |   |       |     |         |
| 28             |   |       |   |       |   |       |   |       |     |         |
| 29             |   |       |   |       |   |       |   |       |     |         |
| 30+            |   |       |   |       |   |       |   |       |     |         |
| <b>TOTAL</b>   |   |       |   |       |   |       |   |       |     |         |

| American Beech |            |           |           |          |          |          |          |            |             |         |
|----------------|------------|-----------|-----------|----------|----------|----------|----------|------------|-------------|---------|
| Number of Logs |            |           |           |          |          |          |          |            |             |         |
| DBH            | 1          | 1 1/2     | 2         | 2 1/2    | 3        | 3 1/2    | 4        | Trees      | Vol         |         |
| 10             | 50         | 0         | 0         | 0        | 0        | 0        | 0        | 50         | 1.9         | Avg DBH |
| 11             | 70         | 0         | 0         | 0        | 0        | 0        | 0        | 70         | 3.4         | 13.2    |
| 12             | 70         | 0         | 0         | 0        | 0        | 0        | 0        | 70         | 4.1         | Tot Vol |
| 13             | 20         | 0         | 0         | 0        | 0        | 0        | 0        | 20         | 1.4         | 10.7    |
| 14             | 50         | 0         | 0         | 0        | 0        | 0        | 0        | 50         | 4.1         |         |
| 15             | 30         | 0         | 0         | 0        | 0        | 0        | 0        | 30         | 2.9         |         |
| 16             | 30         | 0         | 10        | 0        | 0        | 0        | 0        | 40         | 5.1         |         |
| 17             | 50         | 0         | 0         | 0        | 0        | 0        | 0        | 50         | 6.2         |         |
| 18             | 0          | 0         | 10        | 0        | 0        | 0        | 0        | 10         | 2.4         |         |
| 19             | 10         | 10        | 0         | 0        | 0        | 0        | 0        | 20         | 3.7         |         |
| 20             | 0          | 0         | 0         | 0        | 0        | 0        | 0        | 0          | 0.0         |         |
| 21             | 10         | 0         | 0         | 0        | 0        | 0        | 0        | 10         | 2.0         |         |
| 22             | 0          | 0         | 0         | 0        | 0        | 0        | 0        | 0          | 0.0         |         |
| 23             | 0          | 0         | 0         | 0        | 0        | 0        | 0        | 0          | 0.0         | Tot Vol |
| 24             | 0          | 0         | 0         | 0        | 0        | 0        | 0        | 0          | 0.0         | 26.3    |
| 25             | 0          | 0         | 0         | 0        | 0        | 0        | 0        | 0          | 0.0         |         |
| 26             | 0          | 0         | 0         | 0        | 0        | 0        | 0        | 0          | 0.0         |         |
| 27             | 0          | 0         | 0         | 0        | 0        | 0        | 0        | 0          | 0.0         |         |
| 28             | 0          | 0         | 0         | 0        | 0        | 0        | 0        | 0          | 0.0         |         |
| 29             | 0          | 0         | 0         | 0        | 0        | 0        | 0        | 0          | 0.0         |         |
| 30+            | 0          | 0         | 0         | 0        | 0        | 0        | 0        | 0          | 0.0         |         |
| <b>TOTAL</b>   | <b>390</b> | <b>10</b> | <b>20</b> | <b>0</b> | <b>0</b> | <b>0</b> | <b>0</b> | <b>420</b> | <b>37.0</b> |         |

Hardwd Pulpwood Cords 149.9



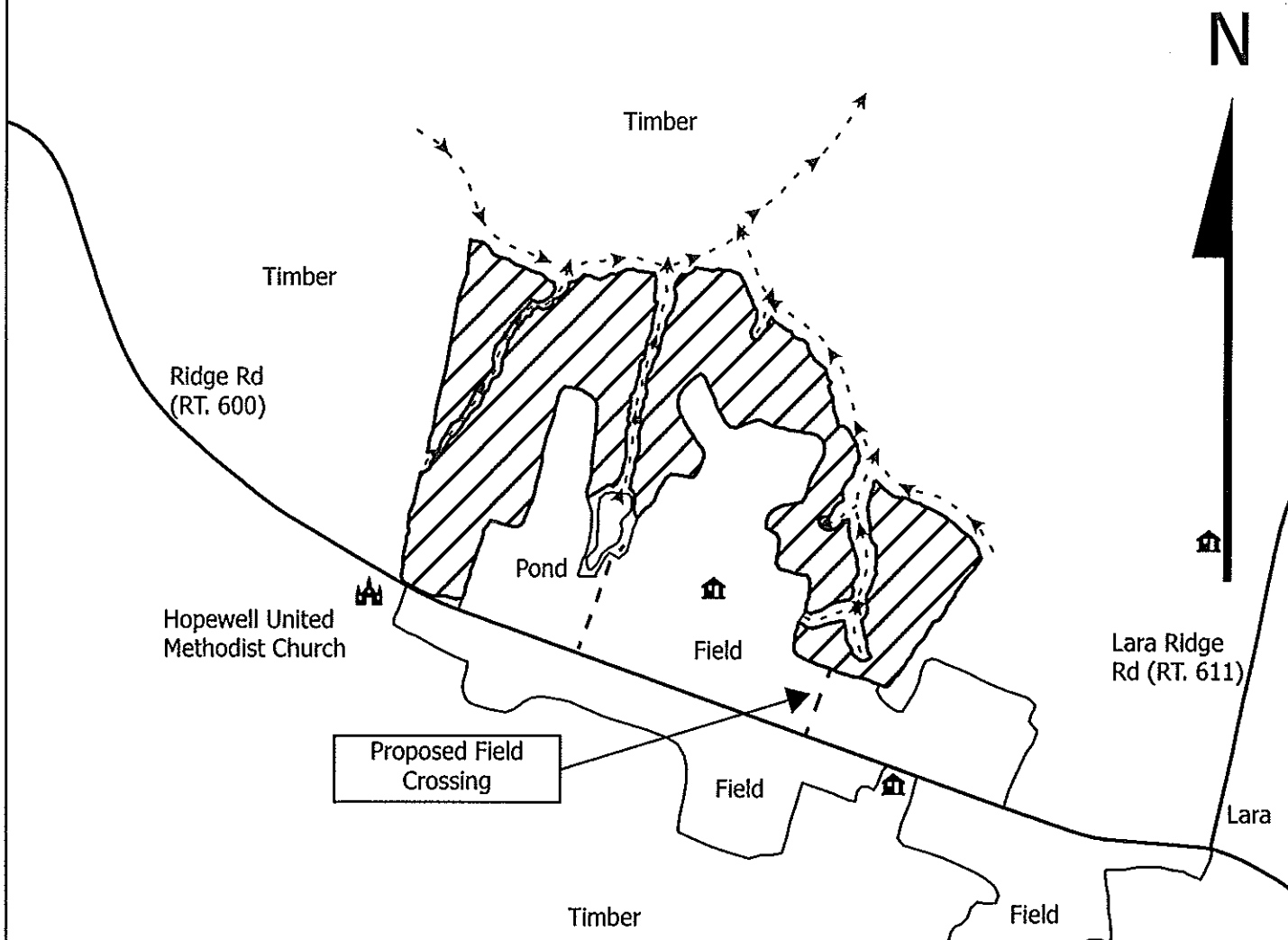

Pine Pulpwood Cords 55.7

**Timber Sale Area  
 Jeff Hinton  
 Northumberland County, Virginia**

Longitude: 76°31'46"W  
 Latitude: 37°51'23"N



Streamside Management Zone  
 Blue Paint  
 Cut Marked Trees Only

-  Timber Sale Area
-  Orange Paint
-  Streams
-  Logging Access

Created By: Gabriel Dawkins  
 Consulting Forester  
 3/12/2026 10:56 AM

Tract Size= 79 Acres  
 SCALE 1" = 1,320'

# Timber Sale

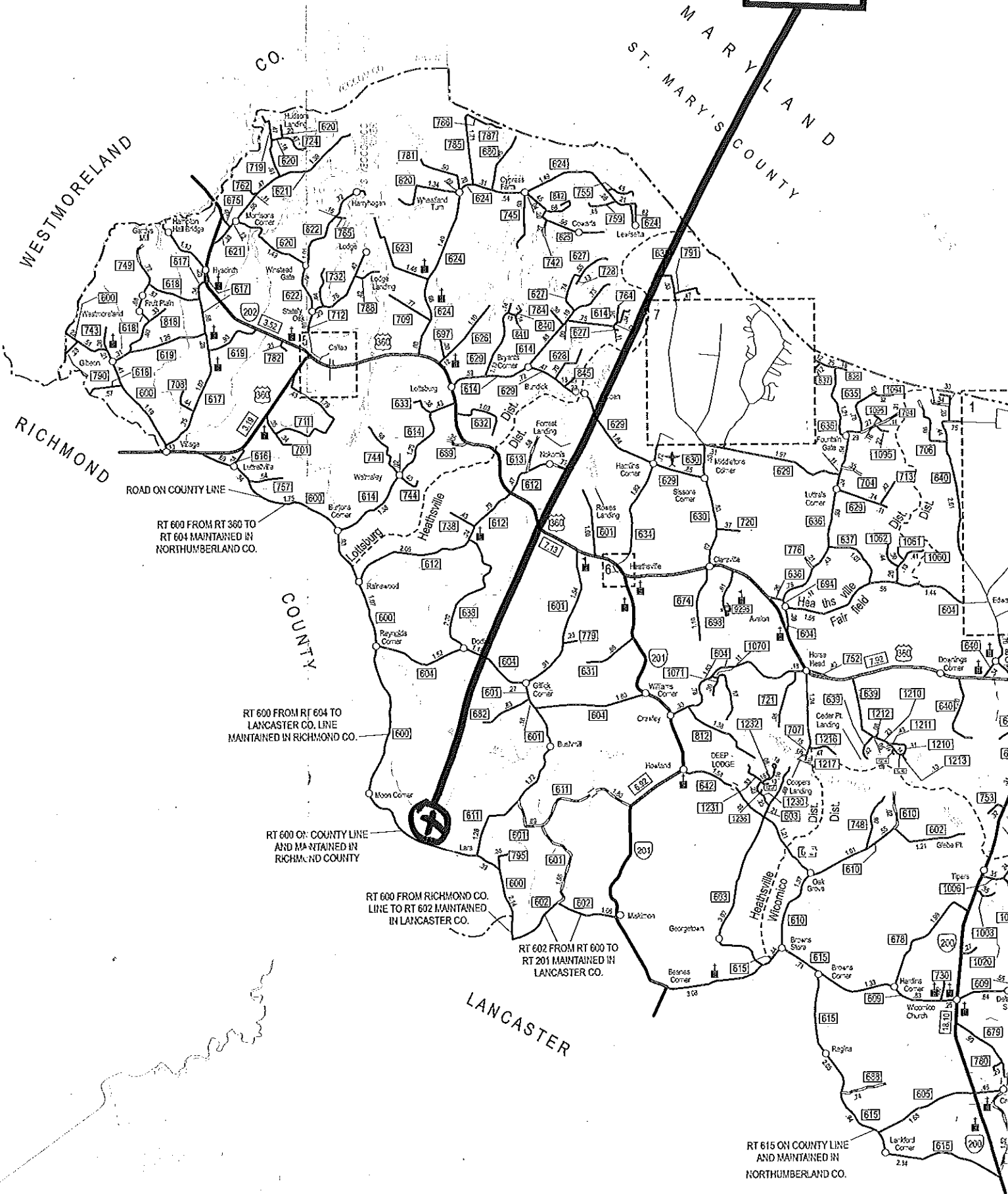

RT 600 FROM RT 360 TO RT 604 MAINTAINED IN NORTHUMBERLAND CO.

RT 600 FROM RT 604 TO LANCASTER CO. LINE MAINTAINED IN RICHMOND CO.

RT 600 ON COUNTY LINE AND MAINTAINED IN RICHMOND COUNTY

RT 600 FROM RICHMOND CO. LINE TO RT 602 MAINTAINED IN LANCASTER CO.

RT 602 FROM RT 600 TO RT 201 MAINTAINED IN LANCASTER CO.

RT 615 ON COUNTY LINE AND MAINTAINED IN NORTHUMBERLAND CO.