



Three Rivers Forestry
PO Box 764
Tappahannock, VA 22560
804/445-5774

Date: June 10, 2016
Time: 3:00 PM
Size: 10 Acres

Total Vol: 121.7 MBF
Vol./Acre: 12.17 MBF

**Timber Sale Notice
Clear-Cut
Pine and Hardwood Timber**

Three Rivers Forestry has been contracted to sell the merchantable timber belonging to Barron S. Baird by sealed bid on approximately 10 acres, located 2.0 miles north of Chance off Brookes Bank Road in Essex County (see attached map).

A 10% sample cruise of the standing sawtimber and pulpwood has been made. All pine and hardwood trees 10 inches DBH and larger were tallied as sawtimber. All sawtimber volumes were calculated using the International Log Rule and pulpwood volumes are based on standard cords of 128 cubic feet. An estimate of the timber volume is provided; however, no guarantee is expressed or implied as to the actual timber that may be harvested due to individual utilization practices.

Loblolly Pine	82.4 MBF	Pine Pulpwood — 16 Cords
Yellow Poplar	26.9 MBF	
Misc. Hardwood	6.8 MBF	Hardwood Pulpwood — 30 Cords
Red Oak	5.6 MBF	
Total	121.7 MBF	International 1/4 inch scale

Bids will be accepted subject to the following conditions:

1. The purchaser will have Two (2) years to cut and remove the timber from the date the contract is signed.
2. Timber harvesting will be done in accordance to Forestry Best Management Practices (BMP's) as stipulated by guidelines set forth by the Virginia Department of Forestry.
3. The owner requires proof of worker's compensation and liability insurance.
4. Landowner assumes the responsibility for the VA. Seed Tree Law.
5. The timber purchase contract will be executed within 30 days of the bid opening.
6. Access permitted by use of the farm road (see map).

Lump-sum sealed bids will be accepted **Friday, June 10, 2016** at the office of Three Rivers Forestry (990 Richmond Hwy, Tappahannock, VA) at **3:00 PM** or by mailing to Three Rivers Forestry, PO Box 764, Tappahannock, VA 22560 or calling (434)531-0456 prior to the sale. Mail bids should be marked **Sealed Bid, Baird Tract**. Only sealed bids will be accepted and the landowner reserves the right to refuse any or all bids.

Prospective buyers are invited to inspect the timber at any time. Any questions regarding the terms of sale or location of the tract should be directed to Three Rivers Forestry.

Submitted By:

Daniel Wilson
Consulting Forester

VOLUME ANALYSIS

Barron S. Baird - 10 Acres

Loblolly Pine
Number of Logs

DBH	1	1 1/2	2	2 1/2	3	3 1/2	4	Trees	Vol
10	30	10	30	0	0	0	0	70	3.5
11	0	10	20	20	10	0	0	60	5.0
12	10	0	30	50	50	0	0	140	15.2
13	10	0	50	100	0	0	0	160	20.1
14	0	0	10	20	40	0	0	70	11.9
15	0	0	10	40	20	0	0	70	13.4
16	10	0	0	20	10	0	0	40	7.8
17	0	0	0	10	0	0	0	10	2.5
18	0	0	0	0	10	0	0	10	3.3
19	0	0	0	0	0	0	0	0	0.0
20	0	0	0	0	0	0	0	0	0.0
TOTAL	60	20	150	260	140	0	0	630	82.4

10"-13"
43.7

14"+
38.8

Poplar
Number of Logs

DBH	1	1 1/2	2	2 1/2	3	3 1/2	4	Trees	Vol
10	0	0	20	0	0	0	0	20	1.2
11	0	0	20	0	0	0	0	20	1.6
12	0	0	10	0	0	0	0	10	1.0
13	0	10	10	0	10	0	0	30	3.6
14	0	0	10	40	0	0	0	50	7.8
15	0	0	10	20	0	0	0	30	5.3
16	0	0	10	0	0	0	0	10	1.8
17	0	0	10	10	0	0	0	20	4.6
18	0	0	0	0	0	0	0	0	0.0
19	0	0	0	0	0	0	0	0	0.0
20	0	0	0	0	0	0	0	0	0.0
TOTAL	0	10	100	70	10	0	0	190	26.9

10"-13"
7.4

14"+
19.6

Miscellaneous
Number of Logs

DBH	1	1 1/2	2	2 1/2	3	3 1/2	4	Trees	Vol
10	0	0	0	0	0	0	0	0	0.0
11	0	0	0	0	0	0	0	0	0.0
12	10	0	0	0	0	0	0	10	0.6
13	0	0	0	0	0	0	0	0	0.0
14	0	0	0	0	0	0	0	0	0.0
15	0	0	0	0	0	0	0	0	0.0
16	0	0	0	0	0	0	0	0	0.0
17	0	10	10	0	0	0	0	20	3.8
18	0	0	0	0	0	0	0	0	0.0
19	0	0	0	0	0	0	0	0	0.0
20	0	10	0	0	0	0	0	10	2.4
TOTAL	10	20	10	0	0	0	0	40	6.8

10"-13"
0.6

14"+
6.2

Red & Black Oak
Number of Logs

DBH	1	1 1/2	2	2 1/2	3	3 1/2	4	Trees	Vol
10	10	0	0	0	0	0	0	10	0.4
11	0	0	0	0	0	0	0	0	0.0
12	0	0	0	0	0	0	0	0	0.0
13	10	0	0	0	0	0	0	10	0.7
14	0	0	0	0	0	0	0	0	0.0
15	10	0	0	0	0	0	0	10	1.0
16	0	0	0	0	0	0	0	0	0.0
17	0	0	0	0	0	0	0	0	0.0
18	10	0	0	0	0	0	0	10	1.4
19	0	10	0	0	0	0	0	10	2.2
20	0	0	0	0	0	0	0	0	0.0
TOTAL	40	10	0	0	0	0	0	50	5.6

10"-13"
1.1

14"+
4.5

Hardwood Pulpwood - 30 Cords

Pine Pulpwood - 16 Cords

**Timber Sale Area
Barron S. Baird
Essex County, Virginia**

Latitude: 38°05'15"N
Longitude: 77°00'42"W

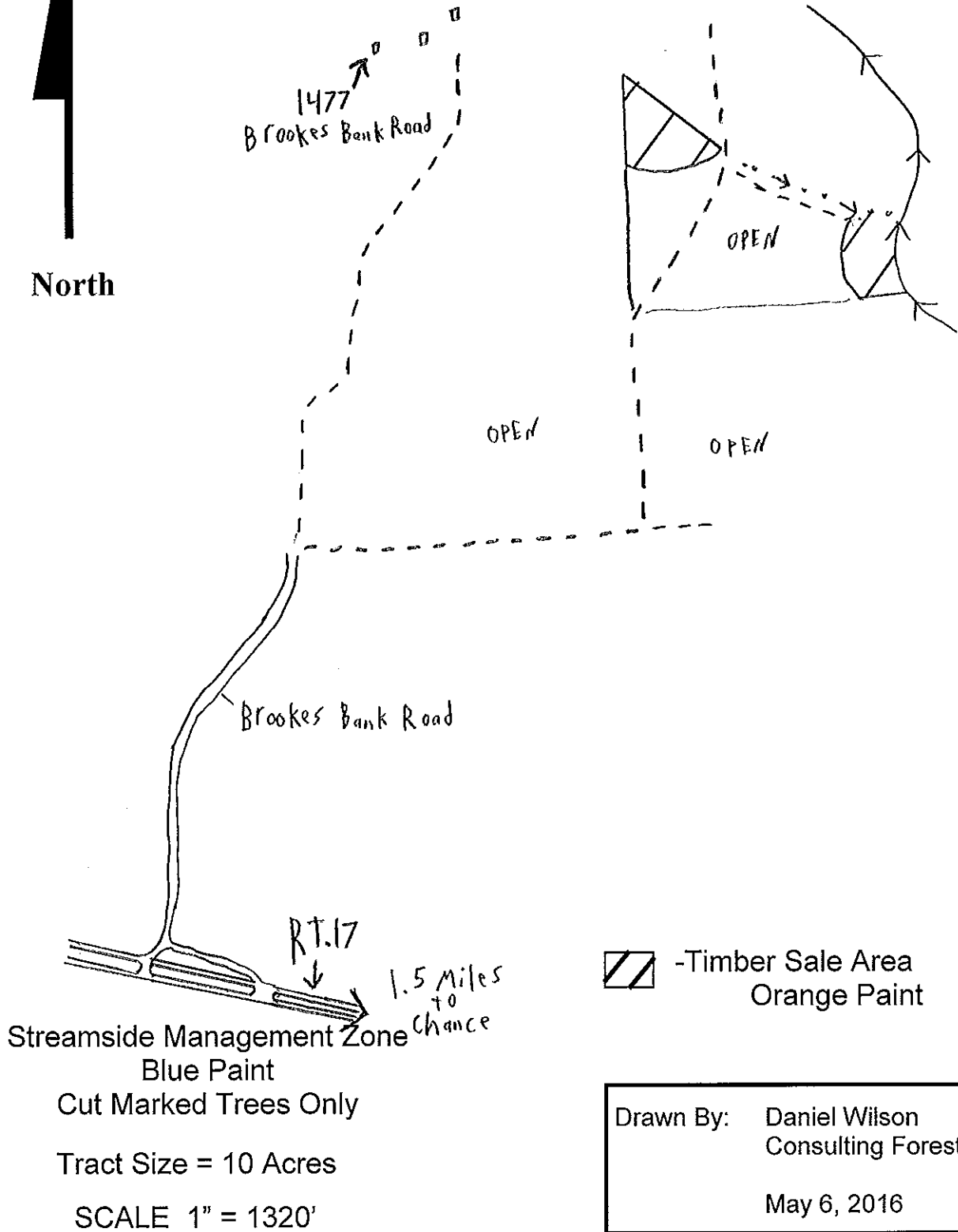

Streamsides Management Zone
Blue Paint
Cut Marked Trees Only
Tract Size = 10 Acres
SCALE 1" = 1320'

 -Timber Sale Area
Orange Paint

Drawn By: Daniel Wilson
Consulting Forester

May 6, 2016

KING GEORGE COUNTY

WESTMORELAND COUNTY

Timber Sale

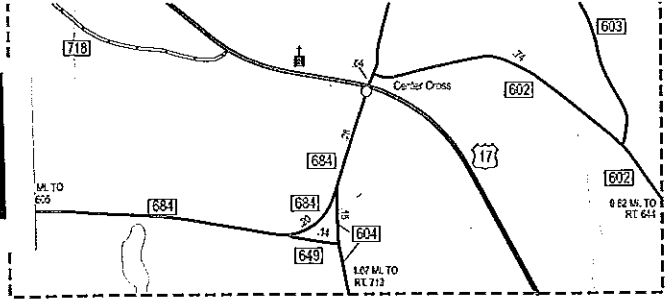

2
CENTER CROSS AREA
four times map scale
see notations on map cover for distance information

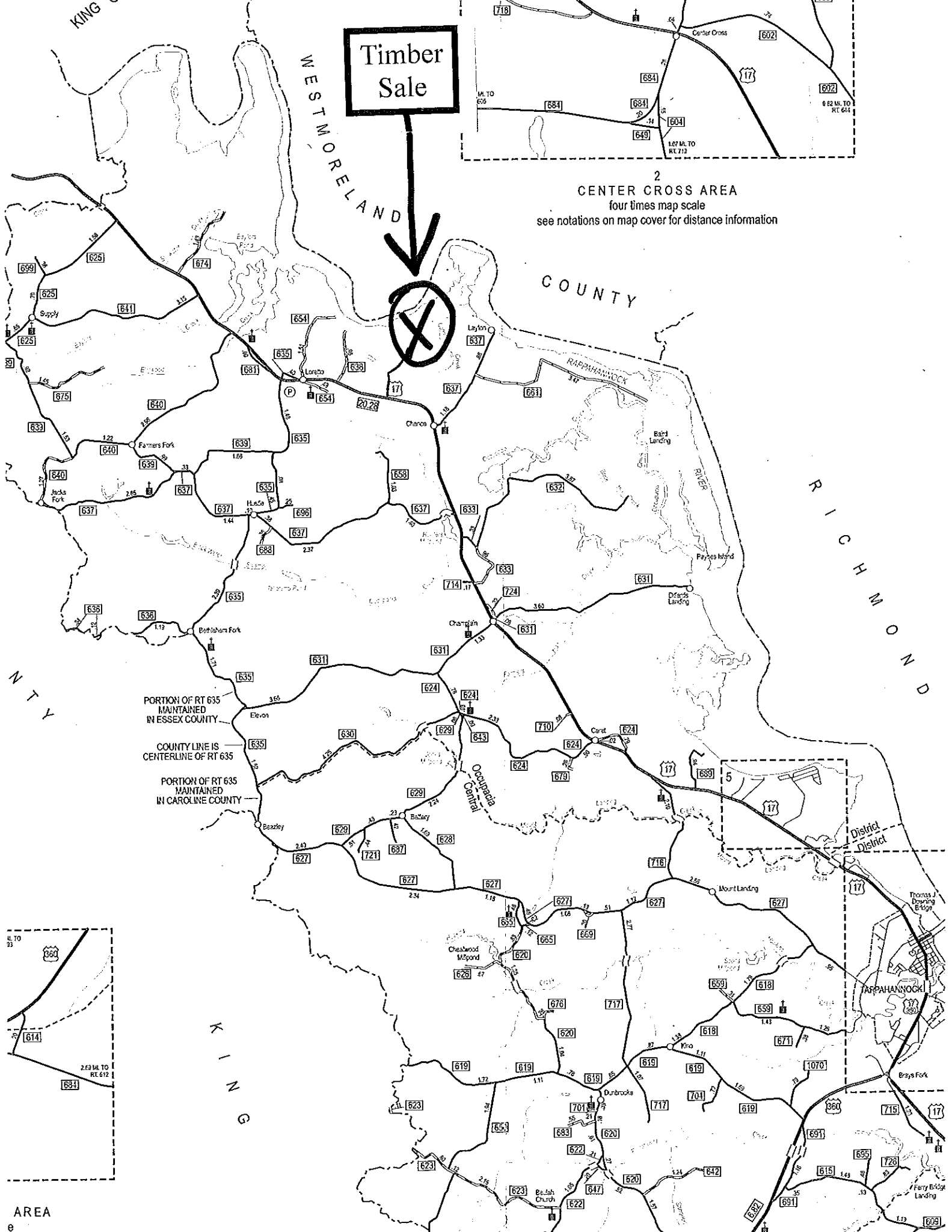

NTY

PORTION OF RT 635 MAINTAINED IN ESSEX COUNTY
COUNTY LINE IS CENTERLINE OF RT 635
PORTION OF RT 635 MAINTAINED IN CAROLINE COUNTY

RICHMOND COUNTY

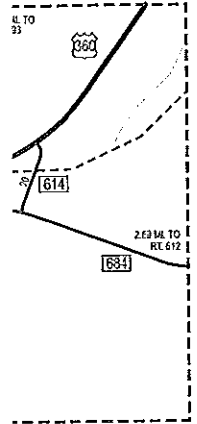

AREA