



Three Rivers Forestry
PO Box 764
Tappahannock, VA 22560
804/445-5774

Date: June 26, 2015 Time: 3:00 PM Size: 12 Acres
Total Vol: 116.6 MBF Vol./Acre: 9.72 MBF

**Timber Sale Notice
Clear-Cut
Hardwood and Pine Sawtimber and Pulpwood**

Three Rivers Forestry has been contracted to sell the merchantable timber belonging to Terry Adams by sealed bid on approximately 12 acres, located 0.2 miles south of Lewistown on the west side of RT. 743 (Carter Heights Road) in Hanover County (see attached map).

A 10% sample cruise of the standing sawtimber and pulpwood has been made. All pine and hardwood trees 10 inches DBH and larger were tallied as sawtimber. All sawtimber volumes were calculated using the International Log Rule and pulpwood volumes are based on standard cords of 128 cubic feet. An estimate of the timber volume is provided; however, no guarantee is expressed or implied as to the actual timber that may be harvested due to individual utilization practices.

Yellow Poplar	31.0 MBF	
Red Oak	28.1 MBF	Hardwood Pulpwood — 45 Cords
Loblolly Pine	33.1 MBF	
Misc. Hardwood	18.6 MBF	Pine Pulpwood — 14 Cords
White Oak	5.0 MBF	
Virginia Pine	0.8 MBF	
Total	116.6 MBF	International 1/4 inch scale

Bids will be accepted subject to the following conditions:

1. The purchaser will have **Two (2) years** to cut and remove the timber from the date the contract is signed.
2. Timber harvesting will be done in accordance to Forestry Best Management Practices (BMP's) as stipulated by guidelines set forth by the Virginia Department of Forestry.
3. The owner requires proof of worker's compensation and liability insurance.
4. Landowner assumes the responsibility for the VA. Seed Tree Law.
5. The timber purchase contract will be executed within 30 days of the bid opening.
6. Access guaranteed by Ingress and Egress from RT.743 (see map).

Lump-sum sealed bids will be accepted **Friday, June 26, 2015** at the office of Three Rivers Forestry (990 Richmond Hwy, Tappahannock, VA) at **3:00 PM** or by mailing to Three Rivers Forestry, PO Box 764, Tappahannock, VA 22560 or calling (434)531-0456 prior to the sale. Mail bids should be marked **Sealed Bid, Adams Tract**. Only sealed bids will be accepted and the landowner reserves the right to refuse any or all bids.

Prospective buyers are invited to inspect the timber at any time. Any questions regarding the terms of sale or location of the tract should be directed to Three Rivers Forestry.

Submitted By:

Daniel Wilson

Daniel Wilson
Consulting Forester

VOLUME ANALYSIS

Terry Adams - 12 Acres

Poplar

Number of Logs

DBH	1	1 1/2	2	2 1/2	3	3 1/2	4	Trees	Vol
10	0	0	10	0	0	0	0	10	0.6
11	0	0	20	0	0	0	0	20	1.6
12	0	0	0	0	0	0	0	0	0.0
13	0	10	0	0	0	0	0	10	0.9
14	0	0	0	10	10	0	0	20	3.4
15	0	0	0	0	0	0	0	0	0.0
16	0	0	0	0	10	0	0	10	2.5
17	0	0	0	10	20	0	0	30	8.2
18	0	0	0	10	0	0	0	10	2.8
19	0	0	0	10	0	0	0	10	3.2
20	0	0	0	0	0	0	0	0	0.0
21	0	0	0	10	0	0	0	10	4.0
22	0	0	10	0	0	0	0	10	3.8
TOTAL	0	10	40	50	40	0	0	140	31.0

Miscellaneous

Number of Logs

DBH	1	1 1/2	2	2 1/2	3	3 1/2	4	Trees	Vol
10	0	0	0	0	0	0	0	0	0.0
11	10	0	40	0	0	0	0	50	3.6
12	10	0	30	0	0	0	0	40	3.5
13	0	0	0	0	0	0	0	0	0.0
14	10	0	10	10	0	0	0	30	3.8
15	0	10	0	10	0	0	0	20	3.2
16	0	0	0	0	0	0	0	0	0.0
17	0	0	10	10	0	0	0	20	4.6
18	0	0	0	0	0	0	0	0	0.0
19	0	0	0	0	0	0	0	0	0.0
20	0	0	0	0	0	0	0	0	0.0
21	0	0	0	0	0	0	0	0	0.0
22	0	0	0	0	0	0	0	0	0.0
TOTAL	30	10	90	30	0	0	0	160	18.6

Loblolly Pine

Number of Logs

DBH	1	1 1/2	2	2 1/2	3	3 1/2	4	Trees	Vol
10	0	0	50	0	0	0	0	50	3.1
11	0	0	20	0	0	0	0	20	1.6
12	0	0	10	0	20	0	0	30	3.4
13	0	0	0	10	0	10	0	20	3.0
14	0	0	0	0	20	0	0	20	3.6
15	0	0	10	0	10	0	0	20	3.7
16	0	0	0	0	20	0	0	20	4.9
17	0	0	0	0	20	0	0	20	5.7
18	0	0	0	0	0	0	0	0	0.0
19	0	0	0	0	0	10	0	10	4.1
20	0	0	0	0	0	0	0	0	0.0
TOTAL	0	0	90	10	90	20	0	210	33.1

Virginia Pine

Number of Logs

DBH	1	1 1/2	2	2 1/2	3	3 1/2	4	Trees	Vol
10	0	0	0	0	0	0	0	0	0.0
11	0	0	10	0	0	0	0	10	0.8
12	0	0	0	0	0	0	0	0	0.0
13	0	0	0	0	0	0	0	0	0.0
14	0	0	0	0	0	0	0	0	0.0
15	0	0	0	0	0	0	0	0	0.0
16	0	0	0	0	0	0	0	0	0.0
17	0	0	0	0	0	0	0	0	0.0
18	0	0	0	0	0	0	0	0	0.0
19	0	0	0	0	0	0	0	0	0.0
20	0	0	0	0	0	0	0	0	0.0
TOTAL	0	0	10	0	0	0	0	10	0.8

White Oak

Number of Logs

DBH	1	1 1/2	2	2 1/2	3	3 1/2	4	Trees	Vol
10	0	0	0	0	0	0	0	0	0.0
11	0	0	0	0	0	0	0	0	0.0
12	10	0	10	0	0	0	0	20	1.5
13	10	0	10	0	0	0	0	20	1.9
14	0	0	0	0	0	0	0	0	0.0
15	0	0	10	0	0	0	0	10	1.6
16	0	0	0	0	0	0	0	0	0.0
17	0	0	0	0	0	0	0	0	0.0
18	0	0	0	0	0	0	0	0	0.0
19	0	0	0	0	0	0	0	0	0.0
20	0	0	0	0	0	0	0	0	0.0
21	0	0	0	0	0	0	0	0	0.0
22	0	0	0	0	0	0	0	0	0.0
TOTAL	20	0	30	0	0	0	0	50	5.0

Red & Black Oak

Number of Logs

DBH	1	1 1/2	2	2 1/2	3	3 1/2	4	Trees	Vol
10	20	0	0	0	0	0	0	20	0.8
11	10	20	0	0	0	0	0	30	1.7
12	20	10	20	0	0	0	0	50	3.9
13	0	30	0	0	0	0	0	30	2.8
14	0	0	20	0	0	0	0	20	2.8
15	0	0	10	0	0	0	0	10	1.6
16	0	0	10	0	0	0	0	10	1.8
17	0	0	30	0	0	0	0	30	6.4
18	0	0	0	0	0	0	0	0	0.0
19	0	0	0	0	0	0	0	0	0.0
20	0	0	0	0	0	0	0	0	0.0
21	0	0	10	0	0	0	0	10	3.4
22	0	10	0	0	0	0	0	10	3.0
TOTAL	50	70	100	0	0	0	0	220	28.1

Hardwood Pulpwood - 45 Cords

Pine Pulpwood - 14 Cords

**Timber Sale Area
Terry Adams
Hanover County, Virginia**

Latitude: 37°42'55"N
Longitude: 77°27'10"W

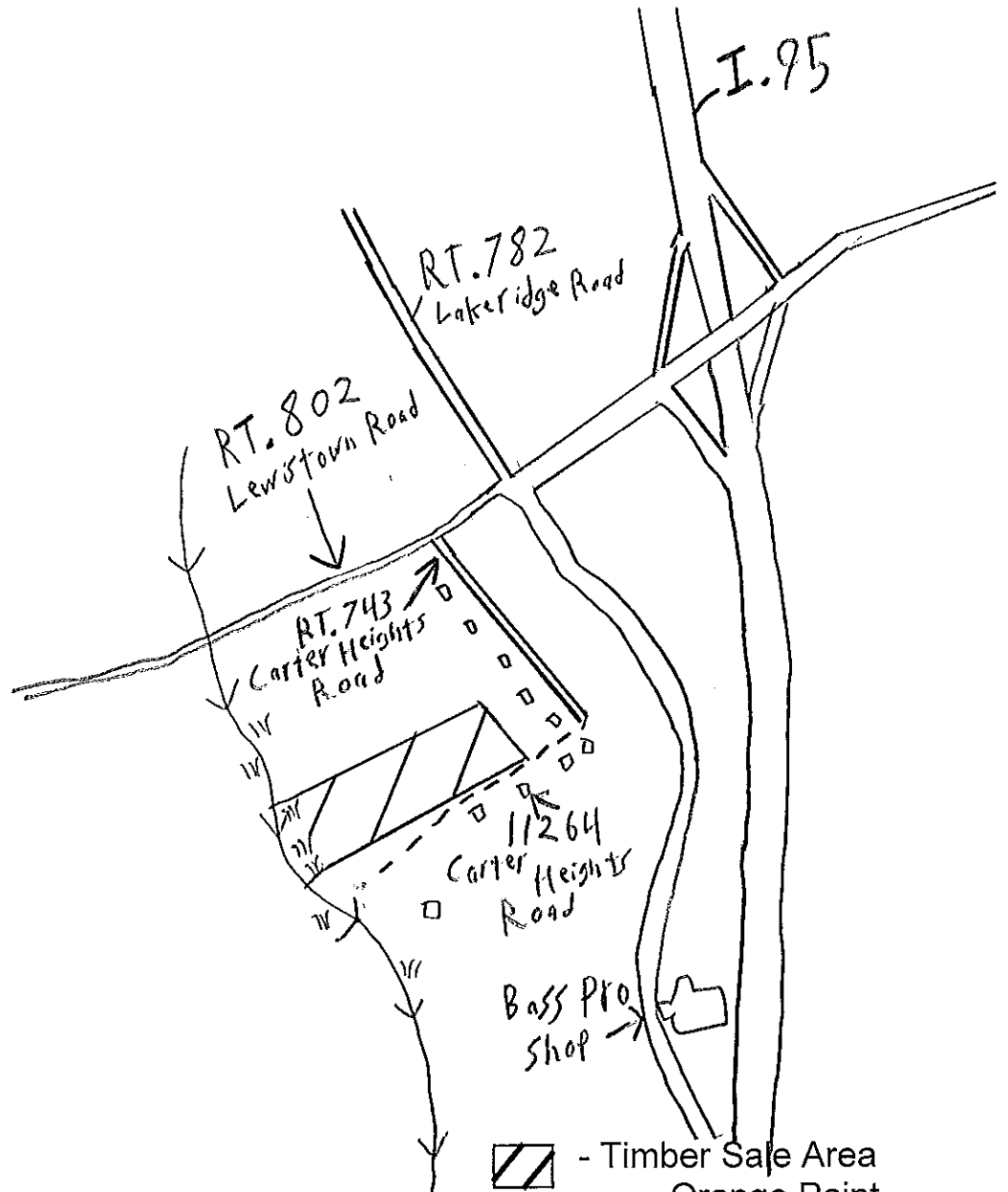

Streamside Management Zone
Blue Paint
Cut Marked Trees Only

Tract Size = 12 Acres
SCALE 1" = 1320'

Drawn By: Daniel Wilson
Consulting Forester

June 11, 2015

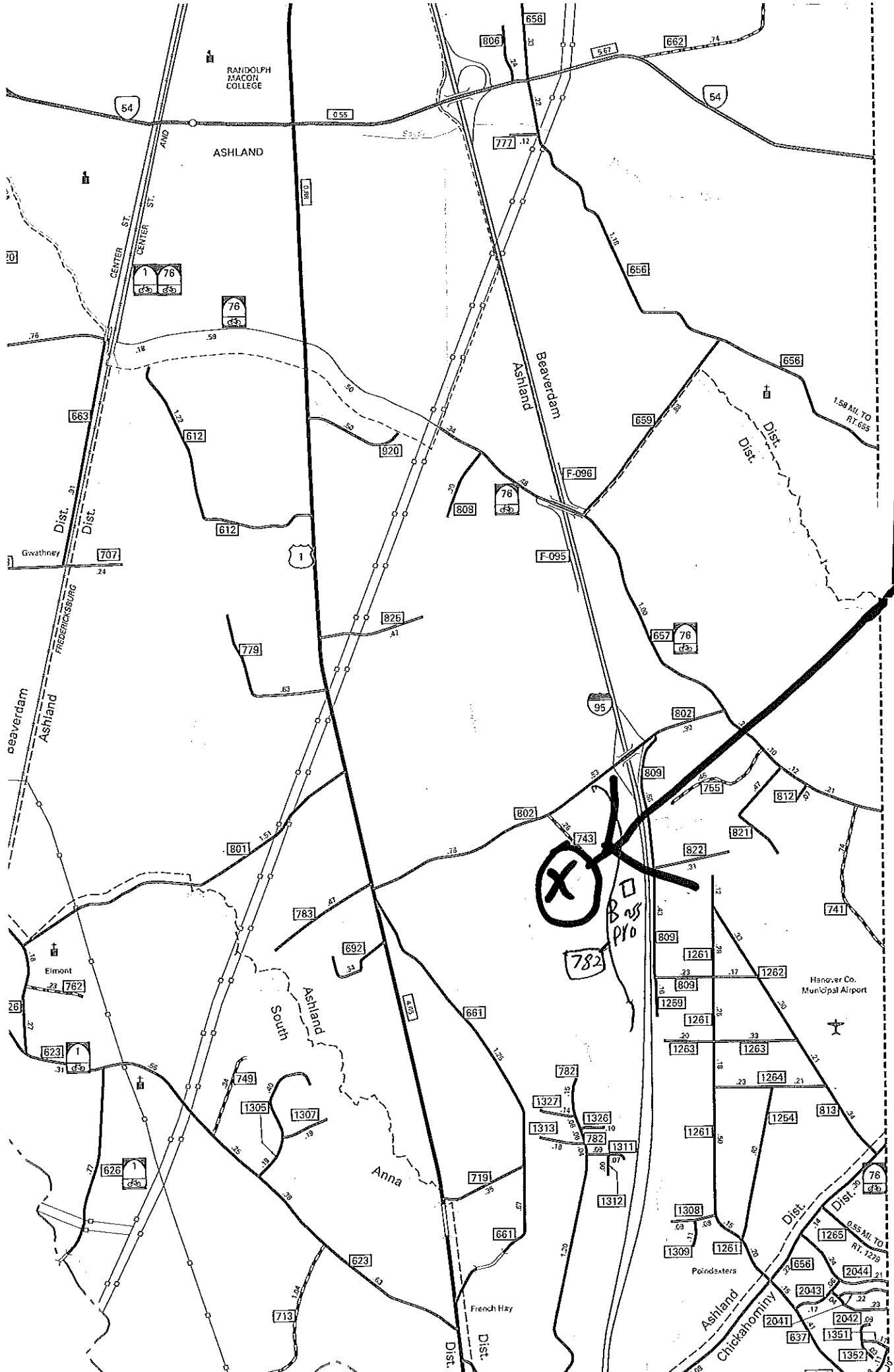

Timber Sale

X
Bass Pro