



Three Rivers Forestry
PO Box 764
Tappahannock, VA 22560
804/445-5774

Date:	March 24, 2017
Time:	3:00 PM
Size:	9.4 Acres

Total Vol:	82.5 MBF
Vol/Acre:	8.78 MBF

Timber Sale Notice Clear-Cut Pine and Hardwood Timber

Three Rivers Forestry has been contracted to sell the merchantable timber belonging to Wiatt Garland by sealed bid on approximately 9.4 acres, located 0.5 miles north of Village, on the east side of RT.600 (Gibeon Road) in Northumberland County (see attached map).

A **25%** sample cruise of the standing sawtimber and pulpwood has been made. All pine and hardwood trees 10 inches DBH and larger were tallied as sawtimber. All sawtimber volumes were calculated using the International Log Rule and pulpwood volumes are based on standard cords of 128 cubic feet. An estimate of the timber volume is provided; however, no guarantee is expressed or implied as to the actual timber that may be harvested due to individual utilization practices.

Loblolly Pine	63.4 MBF	Hardwood Pulpwood - 10 Cords
Virginia Pine	10.3 MBF	
Misc. Hardwood	5.3 MBF	Pine Pulpwood - 4 Cords
Yellow Poplar	3.5 MBF	
Total	82.5 MBF	International 1/4 inch scale

Bids will be accepted subject to the following conditions:

1. The purchaser will have **two (2) years** to cut and remove the timber from the date the contract is signed.
2. Timber harvesting will be done in accordance to Forestry Best Management Practices (BMP's) as stipulated by guidelines set forth by the Virginia Department of Forestry.
3. The owner requires proof of worker's compensation and liability insurance.
4. Landowner assumes responsibility for the VA. Seed Tree Law.
5. The timber purchase contract will be executed within 30 days of bid opening.
6. Access permitted by Ingress and Egress from RT.600 via the field edge (see map)

Lump-sum sealed bids will be accepted **Friday, March 24, 2017** at the office of Three Rivers Forestry (990 Richmond Hwy, Tappahannock, VA) at **3:00 PM** or by mailing to Three Rivers Forestry, PO Box 764, Tappahannock, VA 22560 emailing dan@trfva.com or calling (434) 531-0456 prior to the sale. Mail bids should be marked **Sealed Bid, Garland Tract**. Only sealed bids will be accepted and the landowner reserves the right to refuse any or all bids.

Prospective buyers are invited to inspect the timber at any time. Any questions regarding the terms of sale or location of the tract should be directed to Three Rivers Forestry.

Submitted By:

Daniel Wilson
Consulting Forester

VOLUME ANALYSIS

Wiatt A. Garland - 9.4 Acres 25% Cruise

Loblolly Pine

Number of Logs

avg DBH

DBH	1	1 1/2	2	2 1/2	3	3 1/2	4	Trees	Vol
10	0	4	4	0	0	0	0	8	0.4
11	0	4	24	8	0	0	0	36	2.8
12	0	4	8	8	12	0	0	32	3.4
13	0	0	8	8	8	0	0	24	3.2
14	0	0	0	20	4	0	0	24	3.9
15	0	0	4	4	12	4	0	24	4.9
16	0	0	4	4	20	4	0	32	7.6
17	0	0	0	8	8	0	0	16	4.3
18	0	0	4	8	16	0	0	28	8.4
19	0	0	0	4	32	0	0	36	13.1
20	0	0	0	8	8	0	0	16	6.2
21	0	0	0	4	4	0	0	8	3.5
22	0	0	4	0	0	0	0	4	1.5
TOTAL	0	12	60	84	124	8	0	288	63.4

17.42
10"-13"
10.0

14"+
53.4

Virginia Pine

Number of Logs

DBH	1	1 1/2	2	2 1/2	3	3 1/2	4	Trees	Vol
10	0	0	4	0	0	0	0	4	0.2
11	0	0	24	4	0	0	0	28	2.2
12	0	0	16	0	0	0	0	16	1.5
13	0	0	16	0	0	0	0	16	1.9
14	0	0	4	4	0	0	0	8	1.2
15	0	0	4	0	0	0	0	4	0.6
16	0	0	4	0	0	0	0	4	0.7
17	0	0	4	0	0	0	0	4	0.8
18	0	0	4	0	0	0	0	4	1.0
19	0	0	0	0	0	0	0	0	0.0
20	0	0	0	0	0	0	0	0	0.0
21	0	0	0	0	0	0	0	0	0.0
22	0	0	0	0	0	0	0	0	0.0
TOTAL	0	0	80	8	0	0	0	88	10.3

10"-13"
5.9

14"+
4.4

Poplar

Number of Logs

DBH	1	1 1/2	2	2 1/2	3	3 1/2	4	Trees	Vol
10	0	0	0	0	0	0	0	0	0.0
11	0	0	0	0	0	0	0	0	0.0
12	0	0	0	0	0	0	0	0	0.0
13	0	4	4	0	0	0	0	8	0.8
14	4	0	8	0	0	0	0	12	1.4
15	0	0	0	0	0	0	0	0	0.0
16	0	0	0	0	0	0	0	0	0.0
17	0	0	0	0	0	0	0	0	0.0
18	0	0	0	0	0	0	0	0	0.0
19	0	0	0	0	0	0	0	0	0.0
20	0	0	4	0	0	0	0	4	1.2
21	0	0	0	0	0	0	0	0	0.0
22	0	0	0	0	0	0	0	0	0.0
TOTAL	4	4	16	0	0	0	0	24	3.5

10"-13"
0.8

14"+
2.7

Miscellaneous

Number of Logs

DBH	1	1 1/2	2	2 1/2	3	3 1/2	4	Trees	Vol
10	4	0	0	0	0	0	0	4	0.2
11	4	4	4	0	0	0	0	12	0.8
12	0	0	4	0	0	0	0	4	0.4
13	8	0	4	0	0	0	0	12	1.0
14	0	0	0	0	0	0	0	0	0.0
15	0	0	0	0	0	0	0	0	0.0
16	0	0	8	4	0	0	0	12	2.3
17	0	4	0	0	0	0	0	4	0.7
18	0	0	0	0	0	0	0	0	0.0
19	0	0	0	0	0	0	0	0	0.0
20	0	0	0	0	0	0	0	0	0.0
21	0	0	0	0	0	0	0	0	0.0
22	0	0	0	0	0	0	0	0	0.0
TOTAL	16	8	20	4	0	0	0	48	5.3

10"-13"
2.3

14"+
3.0

Hardwood Pulpwood - 10 Cords

Pine Pulpwood - 4 Cords

**Timber Sale Area
Wiatt Garland
Northumberland County, Virginia**

Latitude: 37°57'22"N
Longitude: 76°36'27"W

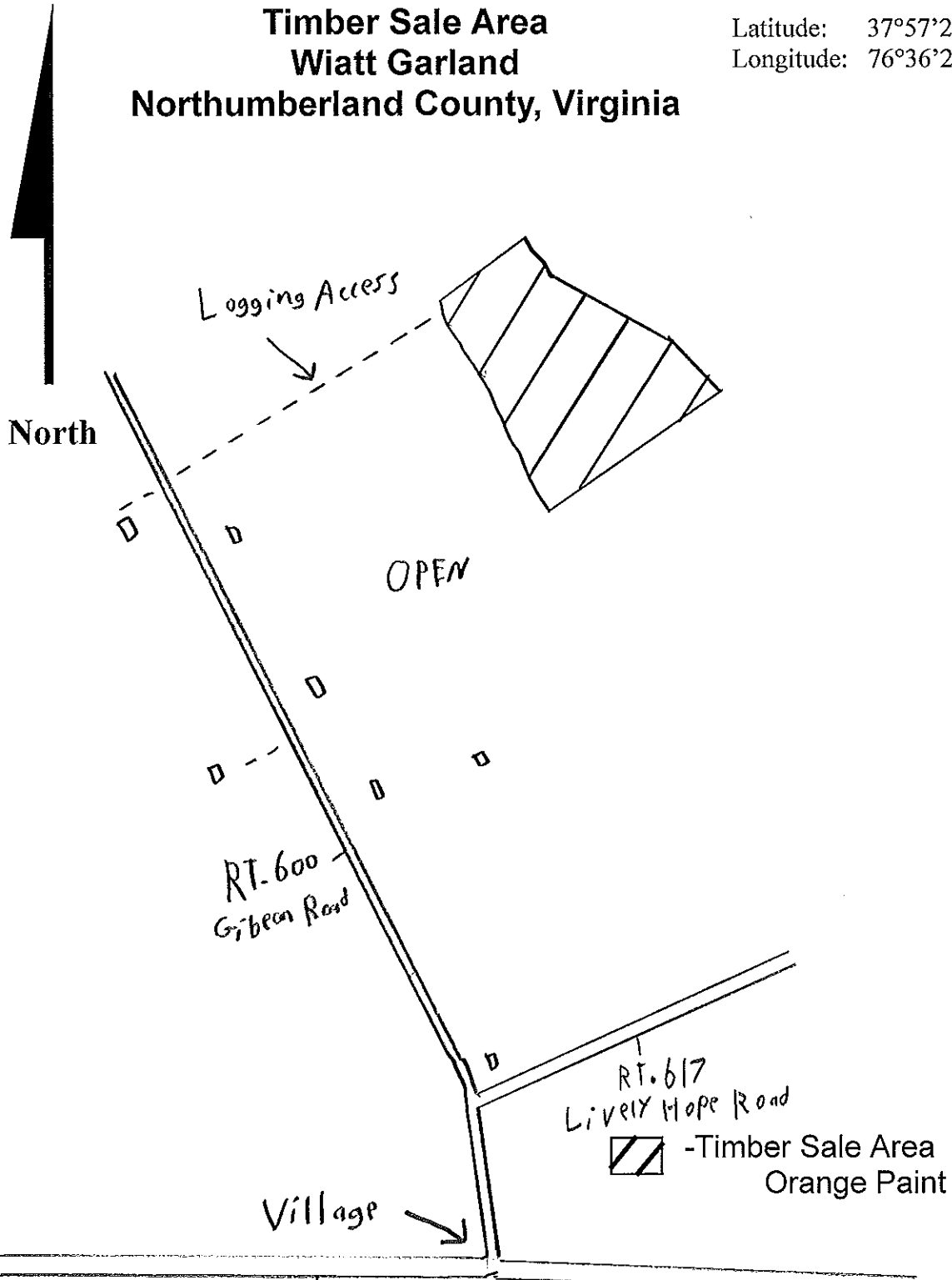

Tract Size = 9.4 Acres
SCALE 1" = 660'

Drawn By: Daniel Wilson
Consulting Forester
March 2, 2017

Timber Sale



ROAD ON COUNTY LINE
RT 600 FROM RT 360 TO
RT 604 MAINTAINED IN
NORTHUMBERLAND CO.

RT 600 FROM RT 604 TO
LANCASTER CO. LINE
MAINTAINED IN RICHMOND CO.

RT 600 ON COUNTY LINE
AND MAINTAINED IN
RICHMOND COUNTY

RT 600 FROM RICHMOND CO.
LINE TO RT 602 MAINTAINED
IN LANCASTER CO.

RT 602 FROM RT 600 TO
RT 201 MAINTAINED IN
LANCASTER CO.

RT 615 ON COUNTY
AND MAINTAINED
NORTHUMBERLAND

