



Three Rivers Forestry
PO Box 764
Tappahannock, VA 22560
804/445-5774

Date: March 2, 2018
Time: 3:00 PM
Size: 16 Acres

Total Vol: 145.5 MBF
Vol/Acre: 9.09 MBF

**Timber Sale Notice
Clear-Cut
Pine and Hardwood Timber**

Three Rivers Forestry has been contracted to sell the merchantable timber belonging to Samuel Edwards by sealed bid on two parcels of land totaling approximately 16 acres, located 0.8 and 1.3 miles south of Ino, on the east side of RT.614 (Rock Spring Road) in King & Queen County.

A **20%** sample cruise of the standing sawtimber and pulpwood has been made. All pine and hardwood trees 10 inches DBH and larger were tallied as sawtimber. All sawtimber volumes were calculated using the International Log Rule and pulpwood volumes are based on standard cords of 128 cubic feet. An estimate of the timber volume is provided; however, no guarantee is expressed or implied as to the actual timber that may be harvested due to individual utilization practices.

Loblolly Pine	74.3 MBF	
Yellow Poplar	37.3 MBF	Pine Pulpwood - 21 Cords
White Oak	10.4 MBF	
Red Oak	9.4 MBF	Hardwood Pulpwood - 31 Cords
Misc. Hardwood	9.0 MBF	
Virginia Pine	5.1 MBF	
Total	145.5 MBF	International 1/4 inch scale

Bids will be accepted subject to the following conditions:

1. The purchaser will have two (2) years to cut and remove the timber from the date the contract is signed.
2. Timber harvesting will be done in accordance to Forestry Best Management Practices (BMP's) as stipulated by guidelines set forth by the Virginia Department of Forestry.
3. The owner requires proof of worker's compensation and liability insurance.
4. Landowner assumes responsibility for the VA. Seed Tree Law.
5. The timber purchase contract will be executed within 30 days of bid opening.
6. Access permitted from RT.614 by use of the woods road (see map).

Lump-sum sealed bids will be accepted **Friday, March 2, 2018** at the office of Three Rivers Forestry (990 Richmond Hwy, Tappahannock, VA) at **3:00 PM** or by mailing to Three Rivers Forestry, PO Box 764, Tappahannock, VA 22560 or calling (434) 531-0456 prior to the sale. Mail bids should be marked **Sealed Bid, Edwards Tract**. Only sealed bids will be accepted and the landowner reserves the right to refuse any or all bids.

Prospective buyers are invited to inspect the timber at any time. Any questions regarding the terms of sale or location of the tract should be directed to Three Rivers Forestry.

Submitted By:

Daniel Wilson
Consulting Forester

VOLUME ANALYSIS

Samuel Edwards - 16 Acres 20% Cruise

Loblolly Pine

DBH	Number of Logs							Trees	Vol	avg DBH
	1	1 1/2	2	2 1/2	3	3 1/2	4			
10	0	0	25	5	0	0	0	30	1.9	18.8
11	0	0	30	5	15	0	0	50	4.3	
12	5	0	5	10	10	5	0	35	3.8	14"+
13	0	0	10	35	10	0	0	55	7.4	17.4
14	0	0	5	15	0	5	0	25	4.1	
15	5	0	0	5	5	10	0	25	4.8	
16	0	0	5	10	5	5	0	25	5.6	
17	0	0	10	5	5	5	0	25	6.4	
18	0	0	0	5	0	0	0	5	1.4	
19	0	0	5	10	10	0	0	25	8.3	
20	0	0	5	5	5	0	0	15	5.4	
21	0	0	0	5	0	0	0	5	2.0	
22	0	0	5	10	0	0	0	15	6.4	
23	0	0	5	0	0	0	0	5	2.1	
24	0	0	10	0	0	0	0	10	4.6	
25	0	0	0	10	0	0	0	10	5.9	14"+
26	0	0	0	0	0	0	0	0	0.0	56.9
TOTAL	10	0	120	135	65	30	0	360	74.3	

Virginia Pine

DBH	Number of Logs							Trees	Vol	avg DBH
	1	1 1/2	2	2 1/2	3	3 1/2	4			
10	0	0	15	0	0	0	0	15	0.9	
11	0	0	20	0	0	0	0	20	1.6	
12	0	0	10	0	0	0	0	10	1.0	14"+
13	0	0	10	0	0	0	0	10	1.2	4.6
14	0	0	0	0	0	0	0	0	0.0	
15	5	0	0	0	0	0	0	5	0.5	
16	0	0	0	0	0	0	0	0	0.0	
17	0	0	0	0	0	0	0	0	0.0	
18	0	0	0	0	0	0	0	0	0.0	
19	0	0	0	0	0	0	0	0	0.0	
20	0	0	0	0	0	0	0	0	0.0	
21	0	0	0	0	0	0	0	0	0.0	
22	0	0	0	0	0	0	0	0	0.0	
23	0	0	0	0	0	0	0	0	0.0	
24	0	0	0	0	0	0	0	0	0.0	
25	0	0	0	0	0	0	0	0	0.0	14"+
26	0	0	0	0	0	0	0	0	0.0	0.5
TOTAL	5	0	55	0	0	0	0	60	5.1	

Poplar

DBH	Number of Logs							Trees	Vol	avg DBH
	1	1 1/2	2	2 1/2	3	3 1/2	4			
10	5	0	20	0	0	0	0	25	1.4	
11	0	5	10	0	0	0	0	15	1.1	
12	0	0	30	5	10	0	0	45	4.7	14"+
13	0	0	5	0	0	0	0	5	0.6	7.8
14	5	0	15	10	0	0	0	30	4.1	
15	0	0	0	10	0	0	0	10	1.9	
16	0	0	10	0	0	0	0	10	1.8	
17	0	10	10	5	0	0	0	25	5.0	
18	5	0	5	10	0	0	0	20	4.7	
19	0	0	5	5	0	0	0	10	3.0	
20	0	0	0	0	0	0	0	0	0.0	
21	0	0	0	0	0	0	0	0	0.0	
22	0	10	10	0	0	0	0	20	6.8	
23	0	0	0	0	0	0	0	0	0.0	
24	0	0	5	0	0	0	0	5	2.3	
25	0	0	0	0	0	0	0	0	0.0	14"+
26	0	0	0	0	0	0	0	0	0.0	29.6
TOTAL	15	25	125	45	10	0	0	220	37.3	

Miscellaneous

DBH	Number of Logs							Trees	Vol	avg DBH
	1	1 1/2	2	2 1/2	3	3 1/2	4			
10	5	0	0	0	0	0	0	5	0.2	
11	5	0	5	0	0	0	0	10	0.6	
12	0	0	5	5	0	0	0	10	1.0	14"+
13	0	0	5	0	0	0	0	5	0.6	2.4
14	0	0	10	5	0	0	0	15	2.2	
15	0	0	0	0	0	0	0	0	0.0	
16	10	0	0	5	0	0	0	15	2.2	
17	0	0	0	0	0	0	0	0	0.0	
18	0	0	0	0	0	0	0	0	0.0	
19	0	0	0	0	0	0	0	0	0.0	
20	0	0	0	0	0	0	0	0	0.0	
21	0	0	0	0	0	0	0	0	0.0	
22	0	0	0	5	0	0	0	5	2.2	
23	0	0	0	0	0	0	0	0	0.0	
24	0	0	0	0	0	0	0	0	0.0	
25	0	0	0	0	0	0	0	0	0.0	14"+
26	0	0	0	0	0	0	0	0	0.0	6.6
TOTAL	20	0	25	20	0	0	0	65	9.0	

White Oak

DBH	Number of Logs							Trees	Vol	avg DBH
	1	1 1/2	2	2 1/2	3	3 1/2	4			
10	0	0	0	0	0	0	0	0	0.0	
11	5	0	5	0	0	0	0	10	0.6	
12	0	0	0	0	0	0	0	0	0.0	
13	5	0	0	0	0	0	0	5	0.4	14"+
14	0	0	0	0	0	0	0	0	0.0	1.0
15	5	10	0	0	0	0	0	15	1.8	
16	15	5	0	0	0	0	0	20	2.4	
17	15	0	5	0	0	0	0	20	2.9	
18	0	0	0	0	0	0	0	0	0.0	
19	0	0	0	0	0	0	0	0	0.0	
20	0	0	0	0	0	0	0	0	0.0	
21	0	0	0	0	0	0	0	0	0.0	
22	5	0	0	0	0	0	0	5	1.1	
23	0	0	0	0	0	0	0	0	0.0	
24	5	0	0	0	0	0	0	5	1.3	
25	0	0	0	0	0	0	0	0	0.0	14"+
26	0	0	0	0	0	0	0	0	0.0	9.4
TOTAL	55	15	10	0	0	0	0	80	10.4	

Red & Black Oak

DBH	Number of Logs							Trees	Vol	avg DBH
	1	1 1/2	2	2 1/2	3	3 1/2	4			
10	25	0	0	0	0	0	0	25	1.0	
11	15	0	20	0	0	0	0	35	2.3	
12	5	0	0	0	0	0	0	5	0.3	14"+
13	0	0	5	0	0	0	0	5	0.6	4.1
14	5	0	5	0	0	0	0	10	1.1	
15	10	0	10	0	0	0	0	20	2.6	
16	0	0	0	0	0	0	0	0	0.0	
17	0	0	0	0	0	0	0	0	0.0	
18	5	5	0	0	0	0	0	10	1.7	
19	0	0	0	0	0	0	0	0	0.0	
20	0	0	0	0	0	0	0	0	0.0	
21	0	0	0	0	0	0	0	0	0.0	
22	0	0	0	0	0	0	0	0	0.0	
23	0	0	0	0	0	0	0	0	0.0	
24	0	0	0	0	0	0	0	0	0.0	
25	0	0	0	0	0	0	0	0	0.0	14"+
26	0	0	0	0	0	0	0	0	0.0	5.3
TOTAL	65	5	40	0	0	0	0	110	9.4	

Hardwood Pulpwood - 31 Cords

Pine Pulpwood - 21 Cords

**Timber Sale Area
Samuel Edwards
King & Queen County, Virginia**

Latitude: 37°45'10"N
Longitude: 76°47'30"W

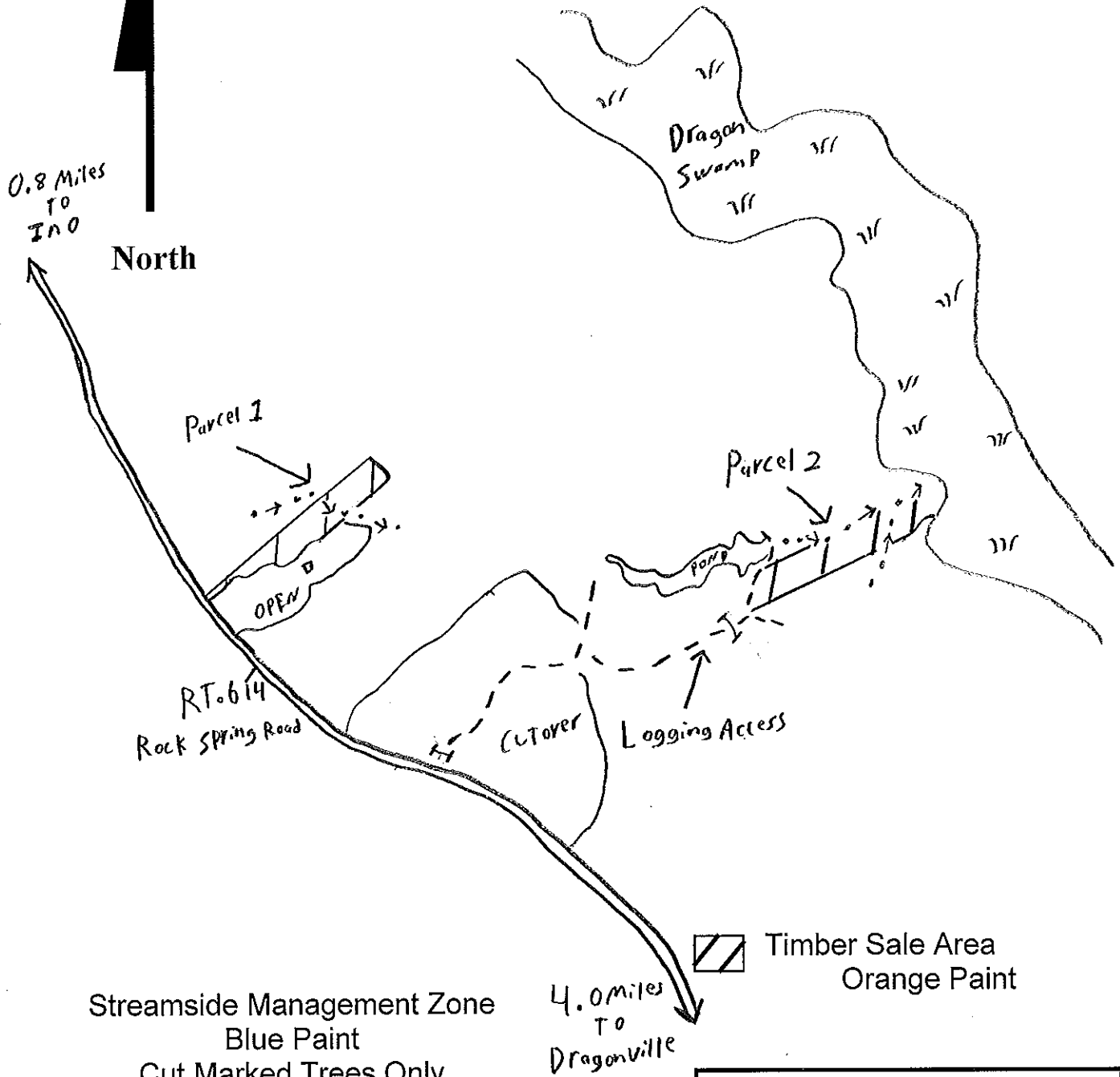

Streamside Management Zone
Blue Paint
Cut Marked Trees Only

Tract Size = 16 Acres

SCALE 1" = 1320'

 Timber Sale Area
 Orange Paint

Drawn By: Daniel Wilson
Consulting Forester

February 12, 2018

C O U N T Y

Timber
Sale

AD ON COUNTY LINE
OBTAINED IN ESSEX COUNTY

