



Three Rivers Forestry
PO Box 764
Tappahannock, VA 22560
(804) 445-5774

Date: March 15, 2019
Time: 3:00 PM
Size: 40 Acres

Total Vol: 169.2 MBF
Vol/Acre: 4.23 MBF

Timber Sale Notice
Clear-Cut
AFF Certified Hardwood and Pine Timber

Three Rivers Forestry has been contracted to sell the merchantable timber belonging to James & Jacqueline Richardson by sealed bid on approximately 40 acres, located 1.0 miles east of Slaterville, at the end of Kentmere Road in New Kent County (see attached map).

A 10% sample cruise of the standing sawtimber and pulpwood has been made. All pine and hardwood trees 10 inches DBH and larger were tallied as sawtimber. All sawtimber volumes were calculated using the International Log Rule and pulpwood volumes are based on standard cords of 128 cubic feet. An estimate of the timber volume is provided; however, no guarantee is expressed or implied as to the actual timber that may be harvested due to individual utilization practices.

Misc. Hardwood	64.3 MBF	
White Oak	61.1 MBF	Hardwood Pulpwood - 74 Cords
Red Oak	26.5 MBF	
Poplar	11.1 MBF	Pine Pulpwood - 32 Cords
Loblolly Pine	3.9 MBF	
Virginia Pine	2.3 MBF	
Total	169.2 MBF	International 1/4 inch scale

Bids will be accepted subject to the following conditions:

1. The purchaser will have **two (2) years** to cut and remove the timber from the date the contract is signed.
2. Timber harvesting will be done in accordance to Forestry Best Management Practices (BMP's) as stipulated by guidelines set forth by the Virginia Department of Forestry.
3. The owner requires proof of worker's compensation and liability insurance.
4. Landowner assumes responsibility for the VA. Seed Tree Law.
5. The timber purchase contract will be executed within 30 days of bid opening.
6. Access permitted by use of the woods road. (see map).

Lump-sum sealed bids will be accepted **Friday, March 15, 2019** at the office of Three Rivers Forestry (990 Richmond Hwy, Tappahannock, VA) at **3:00 PM** or by mailing to Three Rivers Forestry, PO Box 764, Tappahannock, VA 22560 or calling (434) 531-0456 or emailing bid@trfva.com prior to the sale. Mail bids should be marked **Richardson Tract**. Bidder is responsible for verifying receipt of mail bids prior to the sale. Only sealed bids will be accepted and the landowner reserves the right to refuse any or all bids.

Prospective buyers are invited to inspect the timber at any time. Any questions regarding the terms of sale or location of the tract should be directed to Three Rivers Forestry.

Submitted By:

John Paul Ewan
Forester

VOLUME ANALYSIS

James Richardson 40 Acres

White Oak

DBH	Number of Logs							Trees	Vol	Ave DBH
	1	1 1/2	2	2 1/2	3	3 1/2	4			
10	10	30	0	0	0	0	0	40	1.9	15.2
11	30	30	20	0	0	0	0	80	4.9	10"-13" 22.3
12	20	30	20	0	0	0	0	70	5.4	
13	10	20	30	30	0	0	0	90	10.1	
14	0	10	20	0	0	0	0	30	3.9	14"+ 38.8
15	10	20	10	20	0	0	0	60	8.9	
16	20	20	30	10	0	0	0	80	12.7	
17	0	0	10	10	0	0	0	20	4.6	
18	20	0	0	0	0	0	0	20	2.8	
19	0	0	10	10	0	0	0	20	5.9	
20	0	0	0	0	0	0	0	0	0.0	
TOTAL	120	160	150	80	0	0	0	510	61.1	

Red & Black Oak

DBH	Number of Logs							Trees	Vol	Ave DBH
	1	1 1/2	2	2 1/2	3	3 1/2	4			
10	0	10	0	0	0	0	0	10	0.5	15.9
11	0	10	0	0	0	0	0	10	0.6	10"-13" 4.4
12	0	0	10	0	0	0	0	10	1.0	
13	0	10	0	10	0	0	0	20	2.3	
14	0	0	10	0	10	0	0	20	3.2	14"+ 22.1
15	0	10	10	10	0	0	0	30	4.8	
16	0	0	10	10	0	0	0	20	4.0	
17	0	0	10	0	0	0	0	10	2.1	
18	0	0	10	20	0	0	0	30	8.0	
19	0	0	0	0	0	0	0	0	0.0	
20	0	0	0	0	0	0	0	0	0.0	
TOTAL	0	40	60	50	10	0	0	160	26.5	

Poplar

DBH	Number of Logs							Trees	Vol	Ave DBH
	1	1 1/2	2	2 1/2	3	3 1/2	4			
10	0	0	0	0	0	0	0	0	0.0	10"-13" 0.8
11	0	0	0	0	0	0	0	0	0.0	
12	0	10	0	0	0	0	0	10	0.8	
13	0	0	0	0	0	0	0	0	0.0	
14	0	0	0	0	0	0	0	0	0.0	14"+ 10.3
15	0	0	20	0	0	0	0	20	3.2	
16	0	0	0	0	0	0	0	0	0.0	
17	0	0	10	0	0	0	0	10	2.1	
18	10	0	0	0	0	0	0	10	1.4	
19	0	0	0	0	0	0	0	0	0.0	
20	0	0	0	10	0	0	0	10	3.6	
TOTAL	10	10	30	10	0	0	0	60	11.1	

Miscellaneous

DBH	Number of Logs							Trees	Vol	Ave DBH
	1	1 1/2	2	2 1/2	3	3 1/2	4			
10	60	30	10	0	0	0	0	100	4.4	15.4
11	50	10	0	0	0	0	0	60	3.0	10"-13" 18.8
12	50	20	0	0	0	0	0	70	4.4	
13	30	10	10	20	0	0	0	70	6.9	
14	30	30	10	0	10	0	0	80	9.0	14"+ 45.5
15	10	30	10	0	10	0	0	60	8.5	
16	20	10	10	0	10	0	0	50	7.9	
17	10	30	10	0	0	0	0	50	8.4	
18	20	10	10	0	0	0	0	40	7.1	
19	10	0	0	0	0	0	0	10	1.6	
20	0	0	10	0	0	0	0	10	3.1	
TOTAL	290	180	80	20	30	0	0	600	64.3	

Loblolly Pine

DBH	Number of Logs							Trees	Vol	Ave DBH
	1	1 1/2	2	2 1/2	3	3 1/2	4			
10	0	0	0	0	0	0	0	0	0.0	10"-13" 0.5
11	10	0	0	0	0	0	0	10	0.5	
12	0	0	0	0	0	0	0	0	0.0	
13	0	0	0	0	0	0	0	0	0.0	
14	0	0	0	0	10	0	0	10	1.8	14"+ 3.4
15	0	0	10	0	0	0	0	10	1.6	
16	0	0	0	0	0	0	0	0	0.0	
TOTAL	10	0	10	0	10	0	0	30	3.9	

Virginia Pine

DBH	Number of Logs							Trees	Vol	Ave DBH
	1	1 1/2	2	2 1/2	3	3 1/2	4			
10	0	0	0	10	0	0	0	10	0.7	10"-13" 0.7
11	0	0	0	0	0	0	0	0	0.0	
12	0	0	0	0	0	0	0	0	0.0	
13	0	0	0	0	0	0	0	0	0.0	
14	0	0	0	10	0	0	0	10	1.6	14"+ 1.6
15	0	0	0	0	0	0	0	0	0.0	
16	0	0	0	0	0	0	0	0	0.0	
TOTAL	0	0	0	20	0	0	0	20	2.3	

Hardwood Pulpwood - 74 Cords

Pine Pulpwood - 32 Cords

**Timber Sale Area
James Richardson
New Kent County, Virginia**

Latitude: 37°30'48"N
Longitude: 76°56'04"W

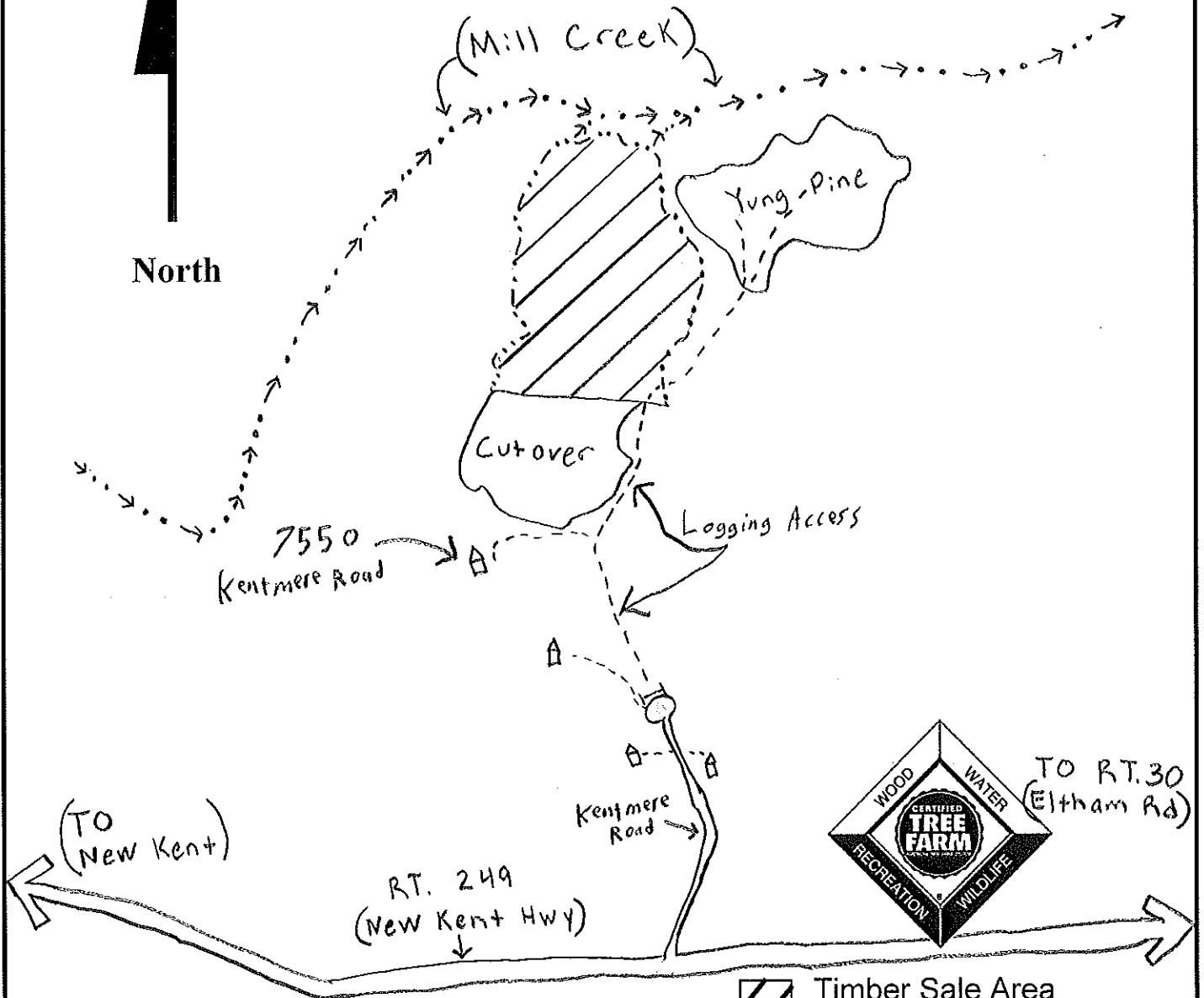

 Timber Sale Area
Orange Paint

Streamside Management Zone
Blue Paint
Cut Marked Trees Only

Tract Size = 40 Acres
SCALE 1" = 1,000'

Drawn By: John Paul Ewan
Forester
February 20, 2019

WILLIAM

COUNTY

KING AND QUEEN COUNTY

Timber Sale

