



Three Rivers Forestry  
PO Box 764  
Tappahannock, VA 22560  
(804) 445-5774

Date: August 29, 2025  
Time: 3:00 PM  
Size: 32 Acres

Total Vol: 913.8 MBF  
Vol/Acre: 28.6 MBF

**Timber Sale Notice  
Clear-Cut  
Pine and Hardwood Timber**

Three Rivers Forestry has been contracted to sell the merchantable timber belonging to Daryl and Cathy Green by sealed bid on 32 acres, located three miles west of Chilesburg on the west side of RT. 698 (Shockey Ln) in Caroline County, Virginia (see attached map).

A 10% sample cruise of the standing sawtimber and pulpwood has been made. All pine and hardwood trees 10 inches DBH and larger were tallied as sawtimber. All sawtimber volumes were calculated using the International Log Rule and pulpwood volumes are based on standard cords of 128 cubic feet. An estimate of the timber volume is provided; however, no guarantee is expressed or implied as to the actual timber that may be harvested due to individual utilization practices.

Loblolly Pine	911.7 MBF	Pine Pulpwood - 16.2 Cords
Yellow Poplar	1.7 MBF	
Red Oak	0.4 MBF	Hardwood Pulpwood - 5.4 Cords
<b>Total</b>	<b>913.8 MBF</b>	<b>International 1/4 inch scale</b>

**Bids will be accepted subject to the following conditions:**

1. The purchaser will have **two (2) years** to cut and remove the timber from the date the contract is signed.
2. Timber harvesting will be done in accordance to Forestry Best Management Practices (BMP's) as stipulated by guidelines set forth by the Virginia Department of Forestry.
3. The owner requires proof of worker's compensation and liability insurance.
4. Landowner assumes responsibility for the VA. Seed Tree Law.
5. The timber purchase contract will be executed within 30 days of bid opening.
6. Access permitted by Ingress and Egress from RT. 698 (Shockey Ln) by use of existing road.

Lump-sum sealed bids will be accepted **Friday, August 29, 2025** at the office of Three Rivers Forestry (990 Richmond Hwy, Tappahannock, VA) at **3:00 PM** or by mailing to Three Rivers Forestry, PO Box 764, Tappahannock, VA 22560 or calling **(804) 580-1063** or emailing **bid@trfva.com** prior to the sale. Mail bids should be marked **Sealed Bid, Green Tract**. Bidder is responsible for verifying receipt of mail bids prior to the sale. Only sealed bids will be accepted and the landowner reserves the right to refuse any or all bids.

Prospective buyers are invited to inspect the timber at any time. Any questions regarding the terms of sale or location of the tract should be directed to Three Rivers Forestry.

Submitted By:

Daniel Deitz  
Consulting Forester



# VOLUME ANALYSIS

Tract: **Daryl and Cathy Green**  
Cruised By: **Daniel Deitz**

Acres: **32**  
Date: **8/6/2025**

Loblolly Pine										
Number of Logs										
DBH	1	1 1/2	2	2 1/2	3	3 1/2	4	Trees	Vol	
10	10	0	20	60	50	10	0	150	10.4	Avg DBH
11	10	10	20	50	250	140	0	480	48.1	13.5
12	0	0	20	30	170	250	170	640	83.3	Tot Vol
13	0	10	0	30	110	300	280	730	120.3	260.1
14	0	0	0	40	90	250	430	810	162.5	
15	0	0	20	10	110	160	350	650	154.1	
16	0	0	0	10	30	190	370	600	168.7	
17	0	0	10	0	0	30	170	210	69.3	
18	0	0	0	0	0	10	140	150	57.9	
19	0	0	0	0	10	0	20	30	12.6	
20	0	0	0	0	0	0	20	20	9.9	
21	0	0	0	0	0	0	30	30	16.7	
22	0	0	0	0	0	0	0	0	0.0	
23	0	0	0	0	0	0	0	0	0.0	Tot Vol
24	0	0	0	0	0	0	0	0	0.0	651.7
26	0	0	0	0	0	0	0	0	0.0	
28	0	0	0	0	0	0	0	0	0.0	
27	0	0	0	0	0	0	0	0	0.0	
28	0	0	0	0	0	0	0	0	0.0	
29	0	0	0	0	0	0	0	0	0.0	
30+	0	0	0	0	0	0	0	0	0.0	
TOTAL	20	20	90	230	820	1340	1880	4500	911.7	

Virginia Pine										
Number of Logs										
DBH	1	1 1/2	2	2 1/2	3	3 1/2	4	Trees	Vol	
10										Avg DBH
11										Tot Vol
12										0.0
13										
14										
15										
16										
17										
18										
19										
20										
21										
22										
23										Tot Vol
24										0.0
25										
26										
27										
28										
29										
30+										
TOTAL										

White Oak										
Number of Logs										
DBH	1	1 1/2	2	2 1/2	3	3 1/2	4	Trees	Vol	
10										Avg DBH
11										Tot Vol
12										0.0
13										
14										
15										
16										
17										
18										
19										
20										
21										
22										
23										Tot Vol
24										0.0
25										
26										
27										
28										
29										
30+										
TOTAL										

Red Oak										
Number of Logs										
DBH	1	1 1/2	2	2 1/2	3	3 1/2	4	Trees	Vol	
10	10	0	0	0	0	0	0	10	0.4	Avg DBH
11	0	0	0	0	0	0	0	0	0.0	10.0
12	0	0	0	0	0	0	0	0	0.0	Tot Vol
13	0	0	0	0	0	0	0	0	0.0	0.4
14	0	0	0	0	0	0	0	0	0.0	
16	0	0	0	0	0	0	0	0	0.0	
16	0	0	0	0	0	0	0	0	0.0	
17	0	0	0	0	0	0	0	0	0.0	
18	0	0	0	0	0	0	0	0	0.0	
19	0	0	0	0	0	0	0	0	0.0	
20	0	0	0	0	0	0	0	0	0.0	
21	0	0	0	0	0	0	0	0	0.0	
22	0	0	0	0	0	0	0	0	0.0	
23	0	0	0	0	0	0	0	0	0.0	Tot Vol
24	0	0	0	0	0	0	0	0	0.0	0.0
25	0	0	0	0	0	0	0	0	0.0	
26	0	0	0	0	0	0	0	0	0.0	
27	0	0	0	0	0	0	0	0	0.0	
28	0	0	0	0	0	0	0	0	0.0	
29	0	0	0	0	0	0	0	0	0.0	
30+	0	0	0	0	0	0	0	0	0.0	
TOTAL	10	0	0	0	0	0	0	10	0.4	

Misc Hardwood										
Number of Logs										
DBH	1	1 1/2	2	2 1/2	3	3 1/2	4	Trees	Vol	
10										Avg DBH
11										Tot Vol
12										0.0
13										
14										
16										
16										
17										
18										
19										
20										
21										
22										
23										Tot Vol
24										0.0
25										
26										
27										
28										
29										
30+										
TOTAL										

Poplar										
Number of Logs										
DBH	1	1 1/2	2	2 1/2	3	3 1/2	4	Trees	Vol	
10	20	0	0	0	0	0	0	20	0.8	Avg DBH
11	0	0	0	0	0	0	0	0	0.0	10.7
12	0	0	10	0	0	0	0	10	1.0	Tot Vol
13	0	0	0	0	0	0	0	0	0.0	1.7
14	0	0	0	0	0	0	0	0	0.0	
15	0	0	0	0	0	0	0	0	0.0	
16	0	0	0	0	0	0	0	0	0.0	
17	0	0	0	0	0	0	0	0	0.0	
18	0	0	0	0	0	0	0	0	0.0	
19	0	0	0	0	0	0	0	0	0.0	
20	0	0	0	0	0	0	0	0	0.0	
21	0	0	0	0	0	0	0	0	0.0	
22	0	0	0	0	0	0	0	0	0.0	
23	0	0	0	0	0	0	0	0	0.0	Tot Vol
24	0	0	0	0	0	0	0	0	0.0	0.0
25	0	0	0	0	0	0	0	0	0.0	
26	0	0	0	0	0	0	0	0	0.0	
27	0	0	0	0	0	0	0	0	0.0	
28	0	0	0	0	0	0	0	0	0.0	
29	0	0	0	0	0	0	0	0	0.0	
30+	0	0	0	0	0	0	0	0	0.0	
TOTAL	20	0	10	0	0	0	0	30	1.7	

Hardwd Pulpwood Cords

5.4

Pine Pulpwood Cords

16.2



**Timber Sale Area  
Daryl and Cathy Green  
Caroline County, Virginia**

Longitude: 77°38'10"W  
Latitude: 37°59'12"N

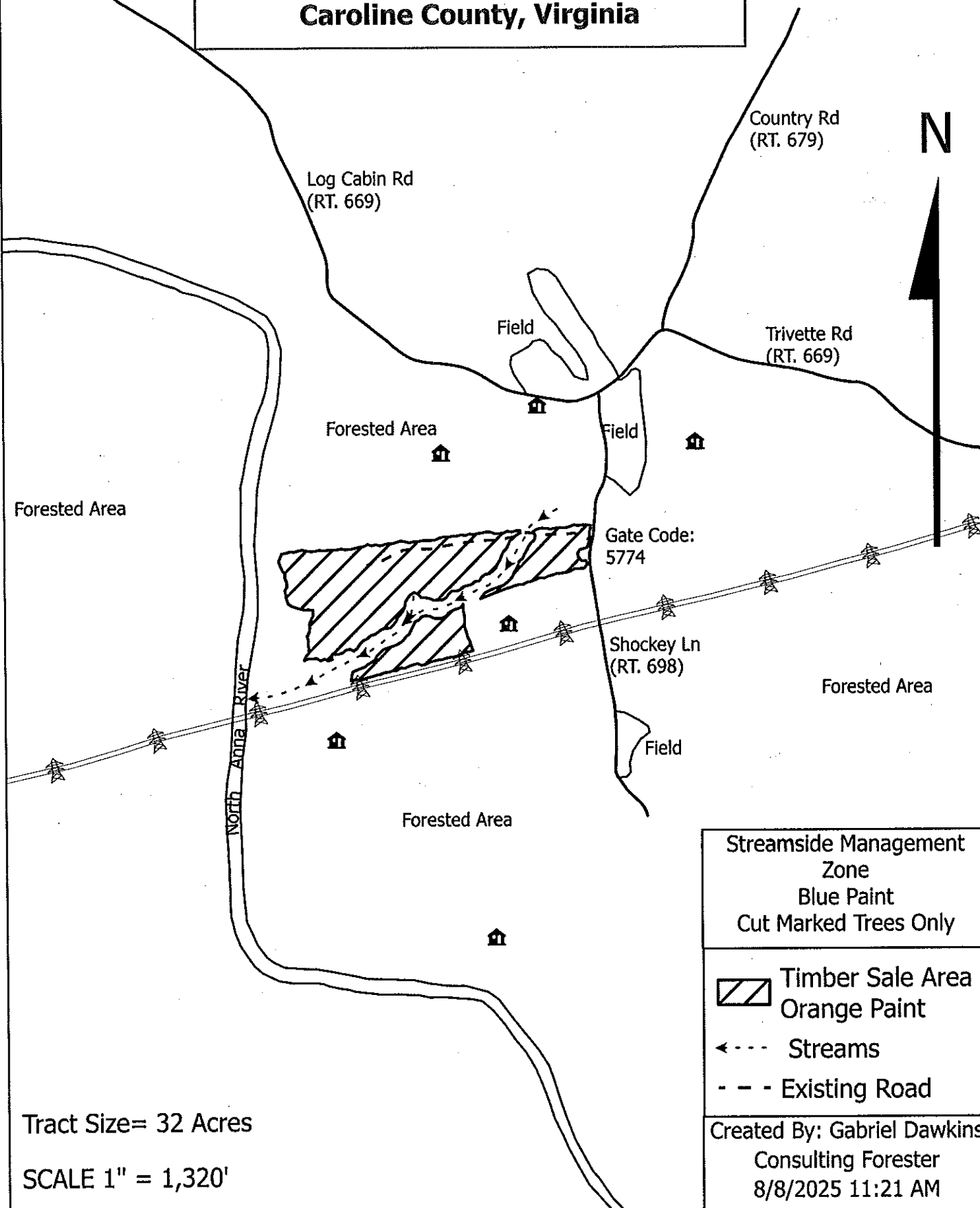

**THREE RIVERS FORESTRY, LLC PO Box 764 Tappahannock, VA 22560**



# Timber Sale

