



Three Rivers Forestry  
PO Box 764  
Tappahannock, VA 22560  
(804) 445-5774

Date: January 24, 2025
Time: 3:00 PM
Size: 42 Acres

Total Vol: 821.7 MBF
Vol/Acre: 19.56 MBF

**Timber Sale Notice  
Clear-Cut  
Pine and Hardwood Timber**

Three Rivers Forestry has been contracted to sell the merchantable timber belonging to Burkett A. Reynolds Jr. and Betty Anne Garrett by sealed bid on approximately 42 acres, located 0.7 miles southeast of Hustle, on the south side of RT. 637 (Occupacia Road) in Essex County (see attached map).

A 10% sample cruise of the standing sawtimber and pulpwood has been made. All trees 10 inches DBH and larger were tallied as sawtimber. All sawtimber volumes were calculated using the International Log Rule and pulpwood volumes are based on standard cords of 128 cubic feet. An estimate of the timber volume is provided; however, no guarantee is expressed or implied as to the actual timber that may be harvested due to individual utilization practices.

Loblolly Pine	736.0 MBF	Pine Pulpwood — 24 Cords
Yellow Poplar	85.1 MBF	Hardwood Pulpwood — 47 Cords
Red Oak	0.6 MBF	
<b>Total</b>	<b>821.7 MBF</b>	<b>International 1/4 inch scale</b>

**Bids will be accepted subject to the following conditions:**

1. The purchaser will have **two (2) years** to cut and remove the timber from the date the contract is signed.
2. Timber harvesting will be done in accordance to Forestry Best Management Practices (BMP's) as stipulated by guidelines set forth by the Virginia Department of Forestry.
3. The owner requires proof of worker's compensation and liability insurance.
4. Landowner assumes responsibility for the VA. Seed Tree Law.
5. The timber purchase contract will be executed within 30 days of bid opening.
6. Access permitted via ingress and egress from RT. 637 and use of existing road (see map).

Lump-sum sealed bids will be accepted **Friday, January 24, 2025** at the office of Three Rivers Forestry (990 Richmond Hwy, Tappahannock, VA) at **3:00 PM** or by mailing to Three Rivers Forestry, PO Box 764, Tappahannock, VA 22560 or calling **(804) 580-1063** or emailing **bid@trfva.com** prior to the sale. Mail bids should be marked **Sealed Bid, Garret-Rennolds Tract**. Bidder responsible for confirming mail bids prior to the sale. Only sealed bids will be accepted and the landowner reserves the right to refuse any or all bids.

Prospective buyers are invited to inspect the timber at any time. Any questions regarding the terms of sale or location of the tract should be directed to Three Rivers Forestry.

Submitted By:

Daniel Deitz  
Consulting Forester

# VOLUME ANALYSIS

Tract: Garrett-Rennolds  
 Cruised By: Daniel Deitz

Acres: 42  
 Date: 1/1/2025

Loblolly Pine											
DBH	Number of Logs								Trees	Vol	
	1	1 1/2	2	2 1/2	3	3 1/2	4				
10	30	40	110	70	10	0	0	0	260	15.4	Avg DBH
11	50	10	200	370	60	0	0	0	690	57.5	12.9
12	30	20	100	360	180	10	0	0	700	76.1	Tot Vol
13	40	30	70	310	580	40	0	0	1070	151.0	300.1
14	20	0	40	390	560	100	0	0	1110	191.1	
15	0	0	60	140	400	60	0	0	660	135.4	
16	0	0	0	90	150	40	10	0	290	69.8	
17	0	0	0	0	60	20	0	0	80	23.4	
18	0	0	0	0	50	0	0	0	50	16.2	
19	0	0	0	0	0	0	0	0	0	0.0	
20	0	0	0	0	0	0	0	0	0	0.0	
21	0	0	0	0	0	0	0	0	0	0.0	
22	0	0	0	0	0	0	0	0	0	0.0	
23	0	0	0	0	0	0	0	0	0	0.0	Tot Vol
24	0	0	0	0	0	0	0	0	0	0.0	436.0
25	0	0	0	0	0	0	0	0	0	0.0	
26	0	0	0	0	0	0	0	0	0	0.0	
27	0	0	0	0	0	0	0	0	0	0.0	
28	0	0	0	0	0	0	0	0	0	0.0	
29	0	0	0	0	0	0	0	0	0	0.0	
30+	0	0	0	0	0	0	0	0	0	0.0	
<b>TOTAL</b>	<b>170</b>	<b>100</b>	<b>580</b>	<b>1730</b>	<b>2050</b>	<b>270</b>	<b>10</b>	<b>4910</b>	<b>738.0</b>		

Virginia Pine											
DBH	Number of Logs								Trees	Vol	
	1	1 1/2	2	2 1/2	3	3 1/2	4				
10											Avg DBH
11											
12											Tot Vol
13											0.0
14											
15											
16											
17											
18											
19											
20											
21											
22											
23											Tot Vol
24											0.0
25											
26											
27											
28											
29											
30+											
<b>TOTAL</b>											

White Oak											
DBH	Number of Logs								Trees	Vol	
	1	1 1/2	2	2 1/2	3	3 1/2	4				
10											Avg DBH
11											
12											Tot Vol
13											0.0
14											
15											
16											
17											
18											
19											
20											
21											
22											
23											Tot Vol
24											0.0
25											
26											
27											
28											
29											
30+											
<b>TOTAL</b>											

Red Oak											
DBH	Number of Logs								Trees	Vol	
	1	1 1/2	2	2 1/2	3	3 1/2	4				
10	0	0	0	0	0	0	0	0	0	0.0	Avg DBH
11	0	0	0	0	0	0	0	0	0	0.0	12.0
12	10	0	0	0	0	0	0	0	10	0.6	Tot Vol
13	0	0	0	0	0	0	0	0	0	0.0	0.6
14	0	0	0	0	0	0	0	0	0	0.0	
15	0	0	0	0	0	0	0	0	0	0.0	
16	0	0	0	0	0	0	0	0	0	0.0	
17	0	0	0	0	0	0	0	0	0	0.0	
18	0	0	0	0	0	0	0	0	0	0.0	
19	0	0	0	0	0	0	0	0	0	0.0	
20	0	0	0	0	0	0	0	0	0	0.0	
21	0	0	0	0	0	0	0	0	0	0.0	
22	0	0	0	0	0	0	0	0	0	0.0	
23	0	0	0	0	0	0	0	0	0	0.0	Tot Vol
24	0	0	0	0	0	0	0	0	0	0.0	0.0
25	0	0	0	0	0	0	0	0	0	0.0	
26	0	0	0	0	0	0	0	0	0	0.0	
27	0	0	0	0	0	0	0	0	0	0.0	
28	0	0	0	0	0	0	0	0	0	0.0	
29	0	0	0	0	0	0	0	0	0	0.0	
30+	0	0	0	0	0	0	0	0	0	0.0	
<b>TOTAL</b>	<b>10</b>	<b>0</b>	<b>0</b>	<b>0</b>	<b>0</b>	<b>0</b>	<b>0</b>	<b>0</b>	<b>10</b>	<b>0.6</b>	

Misc Hardwood											
DBH	Number of Logs								Trees	Vol	
	1	1 1/2	2	2 1/2	3	3 1/2	4				
10											Avg DBH
11											
12											Tot Vol
13											0.0
14											
16											
16											
17											
18											
19											
20											
21											
22											
23											Tot Vol
24											0.0
25											
26											
27											
28											
29											
30+											
<b>TOTAL</b>											

Poplar											
DBH	Number of Logs								Trees	Vol	
	1	1 1/2	2	2 1/2	3	3 1/2	4				
10	70	0	0	0	0	0	0	0	70	2.7	Avg DBH
11	80	60	10	0	0	0	0	0	150	8.4	12.6
12	70	90	70	0	0	0	0	0	230	17.7	Tot Vol
13	10	60	50	10	0	0	0	0	130	13.5	42.3
14	10	0	80	20	0	0	0	0	110	15.1	
15	10	10	20	10	0	0	0	0	50	7.3	
16	30	0	20	10	0	0	0	0	60	9.0	
17	0	0	30	0	0	0	0	0	30	6.4	
18	0	0	10	0	0	0	0	0	10	2.4	
19	0	0	0	0	0	0	0	0	0	0.0	
20	0	0	0	0	0	0	0	0	0	0.0	
21	0	0	0	0	0	0	0	0	0	0.0	
22	0	0	0	0	0	0	0	0	0	0.0	
23	0	0	0	0	0	0	0	0	0	0.0	Tot Vol
24	10	0	0	0	0	0	0	0	10	2.6	42.8
25	0	0	0	0	0	0	0	0	0	0.0	
26	0	0	0	0	0	0	0	0	0	0.0	
27	0	0	0	0	0	0	0	0	0	0.0	
28	0	0	0	0	0	0	0	0	0	0.0	
29	0	0	0	0	0	0	0	0	0	0.0	
30+	0	0	0	0	0	0	0	0	0	0.0	
<b>TOTAL</b>	<b>290</b>	<b>220</b>	<b>290</b>	<b>50</b>	<b>0</b>	<b>0</b>	<b>0</b>	<b>0</b>	<b>850</b>	<b>85.1</b>	

Hardwood Pulpwood Cords 46.7

Pine Pulpwood Cords 24.4

**Timber Sale Area  
Garrett-Rennolds  
Essex County, Virginia**

Latitude: 38°01'51"N  
Longitude: 77°03'15"W

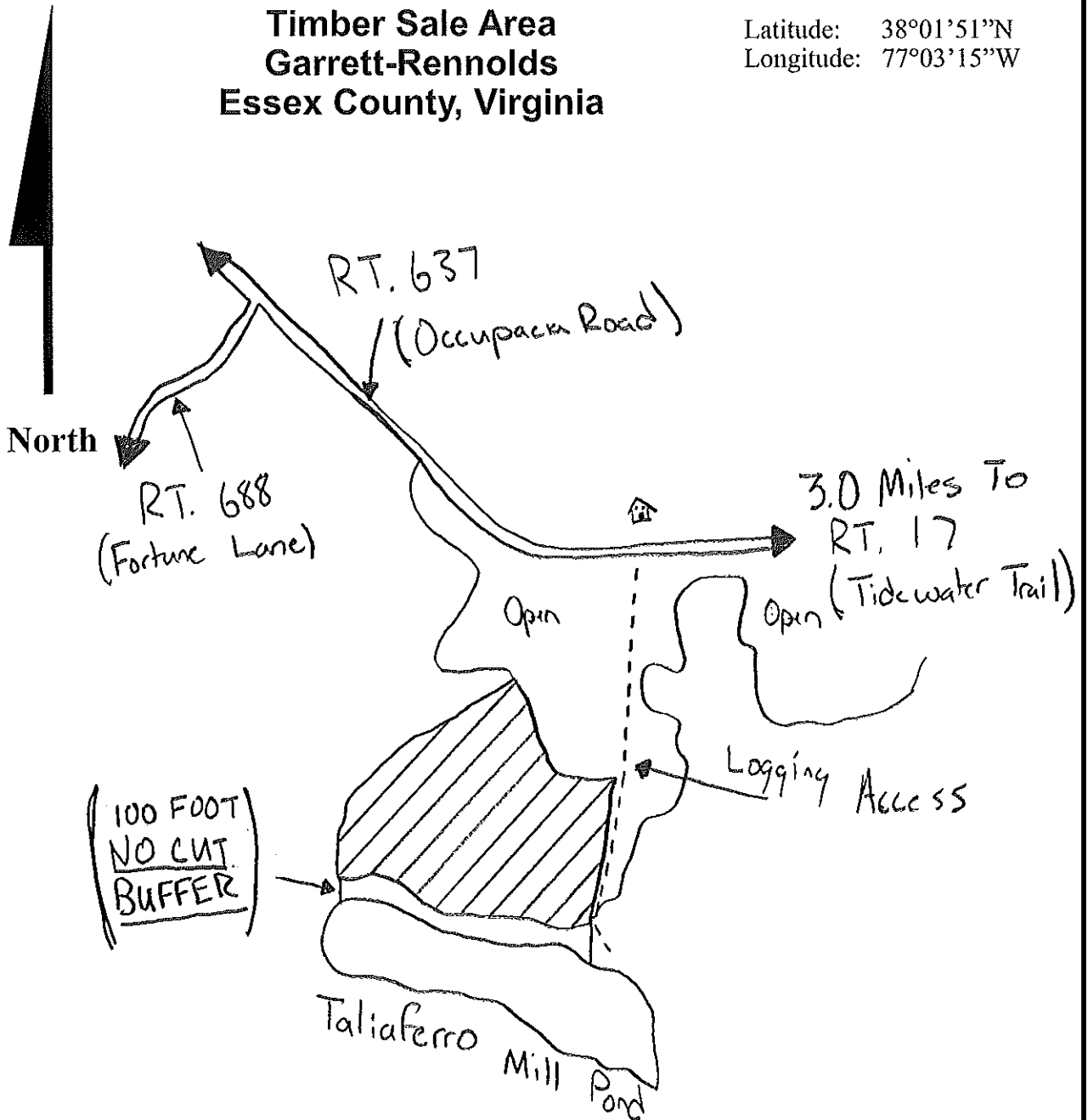

Streamside Management Zone  
Blue Paint

**NO CUT BUFFER**

Tract Size = 42 Acres

SCALE 1" = 1320'

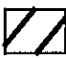
 -Timber Sale Area  
Orange Paint

Drawn By: Daniel Deitz  
Consulting Forester

January 3, 2025

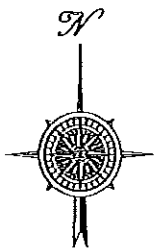

KING GEORGE COUNTY

WESTMORELAND COUNTY

COUNTY

CAROLINE COUNTY

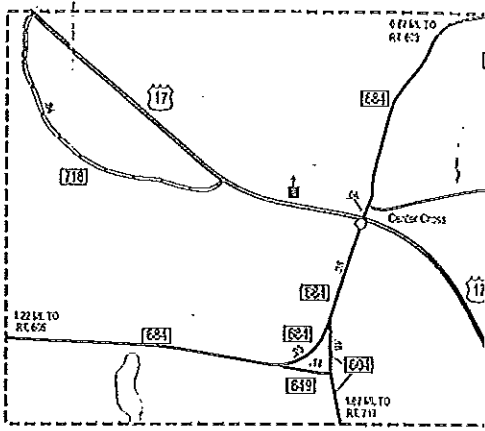
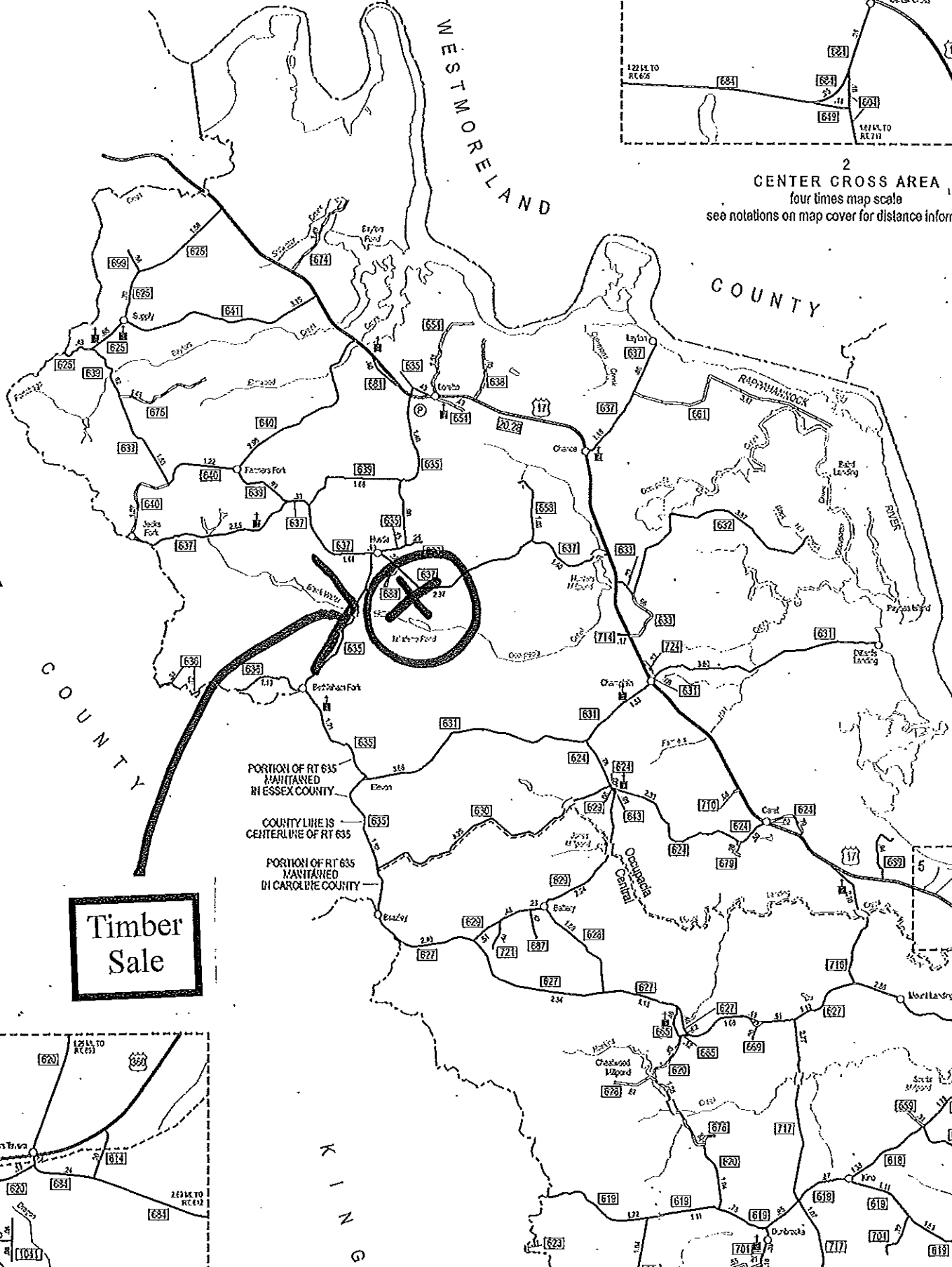

2  
CENTER CROSS AREA  
four times map scale  
see notations on map cover for distance in feet

PORTION OF RT 635 MAINTAINED IN ESSEX COUNTY.  
COUNTY LINE IS CENTERLINE OF RT 635  
PORTION OF RT 635 MAINTAINED IN CAROLINE COUNTY

**Timber Sale**

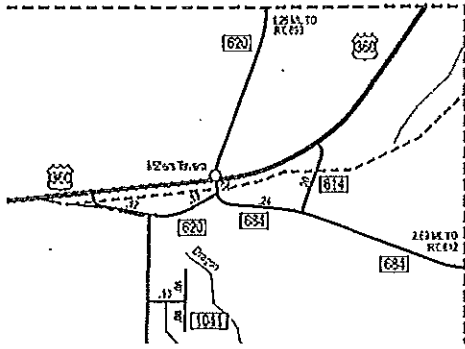

KING