



# Double Storefront Former Luncheonette 434 Howe Avenue, Shelton 2,300rsf available for Lease



## Retail/Restaurant/Office for Lease - \$2,600/month + utilities

This location has excellent access to Route 8 and has great visibility on Howe Avenue. Large, double storefront unit is a former luncheonette and can be adapted to a variety of retail or restaurant uses. Also, potential to be converted to storefront professional office space for lawyer, accountant, financial services, health services, etc. Numerous possibilities! There is a large, open area in the front of the unit and a former dining area in the back of the unit.

The unit is directly adjacent to 2 municipal parking lots, one off Center Street and a larger lot off Bridge Street. Rapidly developing downtown area with numerous apartments.

The large double windows provide lots of natural light into the space. The unit has 2 lavatories, 1 of which is ADA compliant.

**Call Mark Yash Today – 203-209-6713!**

*The information above has been obtained from sources believed reliable. While we do not doubt its accuracy we have not verified it and make no guarantee, warranty or representation about it.*



Mark Yash/Hodson Realty, Inc.  
6515 Main St. , Trumbull, Ct. 06611  
Ph: 203-268-7743  
Cell: 203-209-6713  
Mark@HodsonRealty.com  
www.HodsonCommercial.com



*Integrity. Quality. Experience. Service.*

Location Map

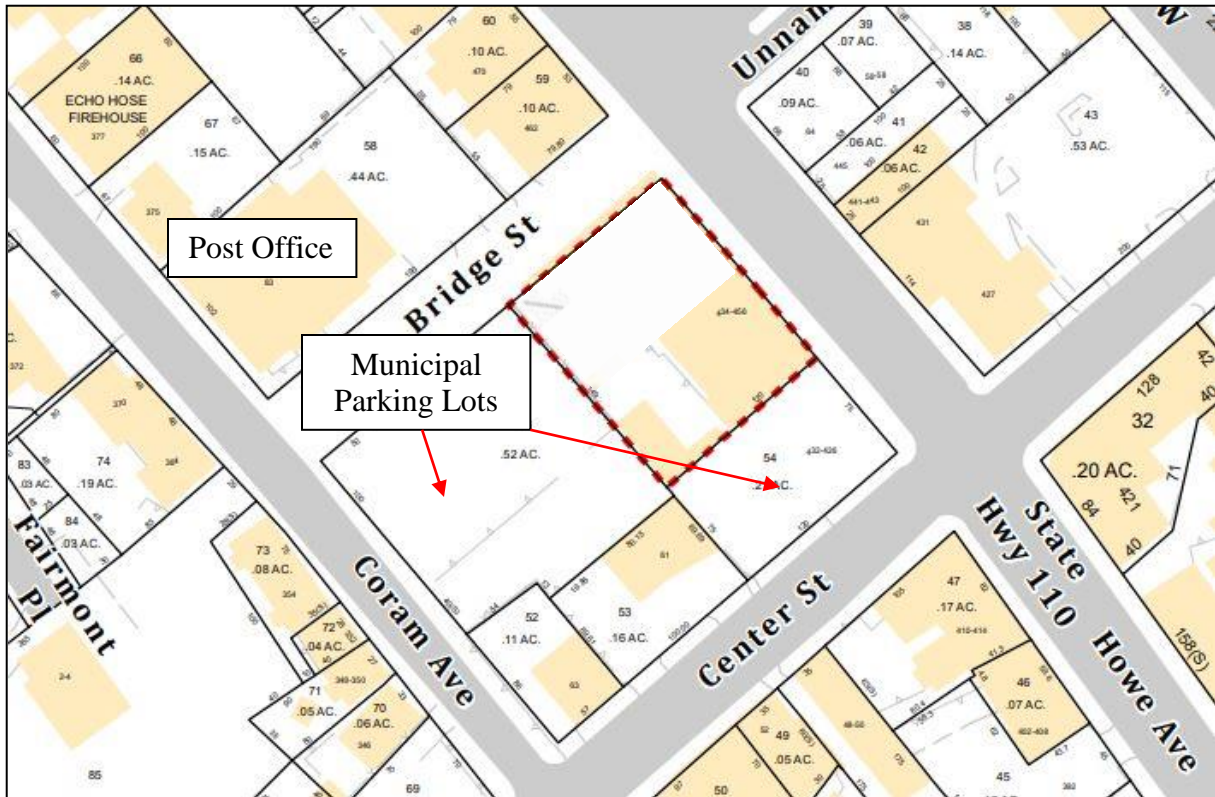

Layout Sketch

