

**CIBOLA & JAY ROAD IMPROVEMENTS
COST ESTIMATE**

ITEM NO	ITEM DESCRIPTION	UNIT	QUANTITY	UNIT PRICE	AMOUNT
1	MOBILIZATION ¹	L. SUM	1	\$ 15,410	\$ 15,410
2	ROADWAY GRADING/SHAPING ²	SQ. YD.	31,680	\$ 3	\$ 95,040
3	ROADWAY EXCAVATION FOR DRAINAGE ³	LF	22,810	\$ 15	\$ 342,144
4	AGGREGATE BASE, CLASS 2 ⁴	CU. YD.	1,760	\$ 45	\$ 79,200
5	CATTLE GUARDS ⁵	EACH	2	\$ 50,000	\$ 100,000
Sub Total:					\$ 631,794
Contingency (5%):					\$ 31,590
Total:					\$ 663,383

Notes:

- 1 - Mobilization was estimated to be 2.5% of the estimated amount, without the contingency.
- 2 - Roadway Grading/Shaping was assumed to be the entire length of the roadway, 25 feet in width.
- 3 - Roadway excavation for drainage was assumed to be required on both sides of the roadway, for the total length of the road.
- 4 - It was assumed that half of the roadway will need aggregate base.
- 5 - It was assumed that each cattle guard will be 4-sections based on Old Castle Precast Detail G2100.

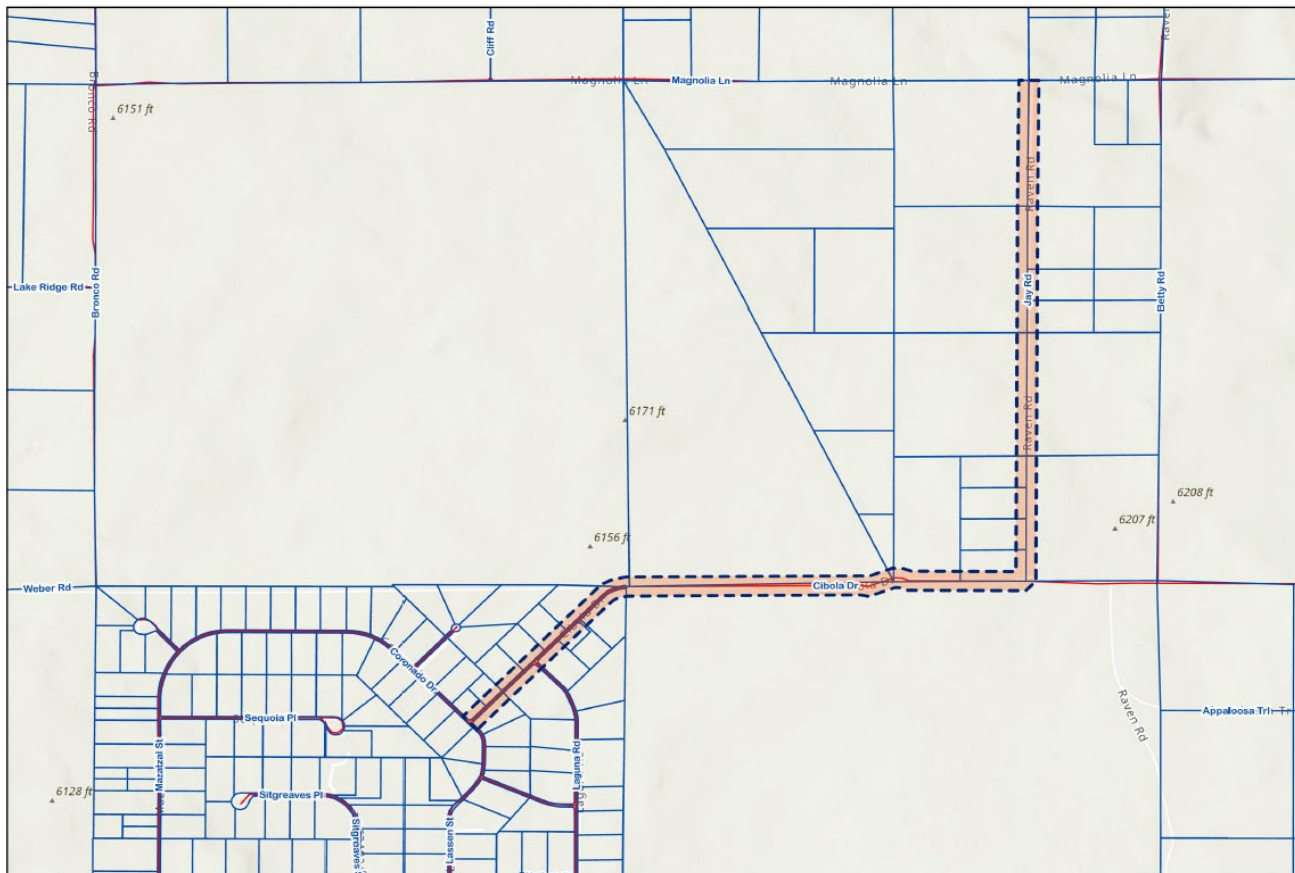

2.16 miles Cibola Drive to Magnolia Lane