



CWL01-02
DYFFRYN LANE, NEWPORT
NP10 8BE

Design Team	
Design	BP
Drawn	SC
Checked	JJ
Date	19/05/2023
Company Project No.	C2208163
M.S. Project No.	P-17683

Approvals	
CUSTOMER	MICROSOFT
Microsoft Design Manager	LEVI HOLLAND
Microsoft Electrical Engineer	MARK GLEESON
Microsoft Mechanical Engineer	OSWALD CLUNHAM
Microsoft Software Engineer	ANDY LAZAR
Microsoft Mechanical Engineer	PAUL HOCKING
CSA	PAUL HOCKING
Designer	JOAN PARLAMBANELL RAU MARK KELLY
Security Manager	DAVID BEADLE
Environmental	DEBORAH CORNAN

PROJECT MANAGEMENT	
Project Planner	
Project Manager	
Senior Project Manager	
Development Manager	
Project Manager	
Quality Control Reviewer	
Quality Control P&E	

Revisions		
No.	Date	Description
P01	15.06.23	FOR COMMENT
P02	27.06.23	FOR COMMENT
P03	30.06.23	WORK IN PROGRESS
P04	03.11.23	ISSUED FOR PLANNING

Registration

Key Plan

Bar Code

Sheet Title/Number

PRIVATE SEWER
DIVERSIONS
SHEET 1

CWL01-02-C-B-05

LEGEND

- PROPOSED SITE BOUNDARY
- EXISTING STORM WATER SEWER
- PROPOSED FOUL WATER SEWER
- EXISTING BT
- EXISTING CATV
- EXISTING ELECTRIC
- EXISTING CABLES
- UNDERGROUND UNIDENTIFIED SERVICES
- UNDERGROUND UNIDENTIFIED PIPE
- EXISTING FOUL RISING MAIN
- EXISTING PUBLIC SURFACE WATER OVERFLOW SEWER
- EXISTING PUBLIC COMBINED SEWER
- WELSH WATER 12m EASEMENT FOR COMBINED SEWER
- WELSH WATER 10m EASEMENT FOR STORM WATER SEWER
- EXISTING SERVICES TO BE REMOVED
- PROPOSED DIVERTED STORM WATER SEWER
- PROPOSED DIVERTED FOUL WATER SEWER
- PROPOSED FOUL RISING MAIN
- PROPOSED PUMPING CHAMBER
- FOUL WATER STORAGE TANK

DRAINAGE NOTES

1. CONTRACTOR TO CONFIRM THE APPROVAL FOR THE TYPE OF PIPE AND BEDDING BEING USED WITH THE PERMITTING AUTHORITY PRIOR TO ANY CONSTRUCTION COMMENCING.
2. ALL WORKS TO THE ADOPTABLE SYSTEM ARE TO BE CARRIED OUT IN ACCORDANCE WITH THE CODE FOR ADOPTION, DESIGN AND CONSTRUCTION GUIDANCE.
3. ALL WORKS TO THE PRIVATE SYSTEM ARE TO BE CARRIED OUT IN ACCORDANCE WITH THE BUILDING REGULATIONS APPROVED DOCUMENT H 2015 EDITION.
4. ALL PRECAST CONCRETE UNITS ARE TO BE BS 5911 (CLASS 3 SULPHATE RESISTANT CEMENT).
5. ALL PROPOSED MANHOLE COVERS AND FRAMES ARE TO BE DUCTILE IRON COMPLYING WITH BS EN 124.
6. ANY TRAFFIC MANAGEMENT REQUIRED TO UNDERTAKE WORKS IN THE PUBLIC HIGHWAY MUST BE APPROVED BY THE LOCAL AUTHORITY PRIOR TO THESE WORKS COMMENCING.
7. ALL WORKS IN THE PUBLIC HIGHWAY MUST BE CARRIED OUT WITH THE PRIOR APPROVAL AND TO THE SATISFACTION OF THE LOCAL HIGHWAY AUTHORITY.
8. THE CONTRACTOR IS TO LAISE WITH THE WATER AUTHORITY ENGINEER, AFFORDING THEM REASONABLE NOTICE TO INSPECT THE WORKS DURING CONSTRUCTION.
9. THE CONTRACTOR IS TO ALLOW FOR JET WASHING AND COTV OF ALL LENGTHS OF EXISTING SEWERS WHICH ARE TO BE RETAINED.
10. ALL PRIVATE DRAINAGE WORKS TO BE IN ACCORDANCE WITH BS EN 752.
11. THE CONTRACTOR MUST CHECK THE LEVELS AND CONDITION OF ALL EXISTING MANHOLES AND DRAINAGE OUTFALLS PRIOR TO CONSTRUCTION OF ANY DRAINAGE, UNLESS OTHERWISE AGREED. TO ENSURE THE PROPOSED DESIGN MAY BE ACHIEVED, ANY DISCREPANCIES MUST BE REPORTED TO PINNACLE IMMEDIATELY.
12. THE CONTRACTOR IS TO KEEP A RECORD OF ANY VARIATIONS MADE ON SITE FOR THEIR 'AS BUILT' DRAWINGS, TO BE PREPARED ON PROJECT COMPLETION.
13. ALL MANHOLE COVER LEVELS ARE APPROXIMATE AND SHOULD BE ADJUSTED TO SUIT THE FINAL SITE PROPOSED LEVELS.
14. CONTRACTOR IS TO ALLOW FOR ALL ABANDONED DRAINAGE RUNS AND MANHOLES / SOAKWAYS TO BE FULLY REMOVED AS NECESSARY.
15. ALL BURIED MANHOLES TO BE REINSTATED AND INVERT LEVELS SUPPLIED TO PINNACLE. MANHOLE COVERS ARE TO BE BROUGHT UP TO THE REQUIRED LEVELS.
16. ALL MANHOLE COVERS TO BE D400 LOADING UNLESS OTHERWISE AGREED OR AS SHOWN IN THE DRAWING.
17. ALL MANHOLE COVERS, DRAINAGE CHANNELS, AND GULLIES TO BE SET 5mm LOWER THAN THE PROPOSED FINISHED LEVELS.
18. ALL SPECIALIST / PROPRIETARY PRODUCTS SUCH AS SEPARATORS, ATTENUATION TANKS, CHANNEL DRAINS, SOAKWAYS, PACKAGE PUMPING STATION AND WATER TREATMENT UNITS TO BE INSTALLED AS PER THE MANUFACTURERS INSTALLATION DETAILS AND SPECIFICATIONS.
19. UNLESS NOTED OTHERWISE, ALL LATERAL CONNECTIONS ARE TO BE INSTALLED WITH LEVEL SOFFITS TO THE DIAMETER AND GRADIENTS SHOWN ON THE LAYOUT DRAWINGS. ANY PIPE BENDS SHOULD BE PROVIDED TO SUIT THE DIRECTION OF FLOW & NO PIPEWORK SHOULD BE DOWNSIZED IN THE DIRECTION OF FLOW.
20. ALL THE PROPOSED DIVERTED MANHOLES AND EXISTING MANHOLES SERVING ADJACENT PROPERTY TO HAVE KEY OPERATED FULLY SEALED SECURE MANHOLE COVERS AND FRAME AND LABELING AS PER SECURITY REQUIREMENTS.

DESIGN NOTE
PROPOSED FOUL WATER DIVERSION PIPE DIAMETER AND GRADIENT IS MATCHED WITH EXISTING PIPE SIZES AND GRADIENT.

DESIGN NOTE
PROPOSED DIVERTED MANHOLE COVER LEVELS ARE SUBJECT TO FINAL DESIGN OF THE LEVEL STRATEGY FOR THE SITE.

DESIGN NOTE
REFER TO CWL01 DEMOLITION SCOPE OF WORKS R02 FOR FURTHER INFORMATION.

DESIGN NOTE
TEMPORARY RISING MAIN AND CONNECTION WORKS TO BE COSTED SEPARATELY.

DESIGN NOTE
PROPOSED PUMPING STATION PUMPING RATE AND STORAGE REQUIREMENT WILL BE SUBJECT TO CONFIRMING THE EXISTING FLOW RATE FROM THE NORTHERN BUILDINGS.

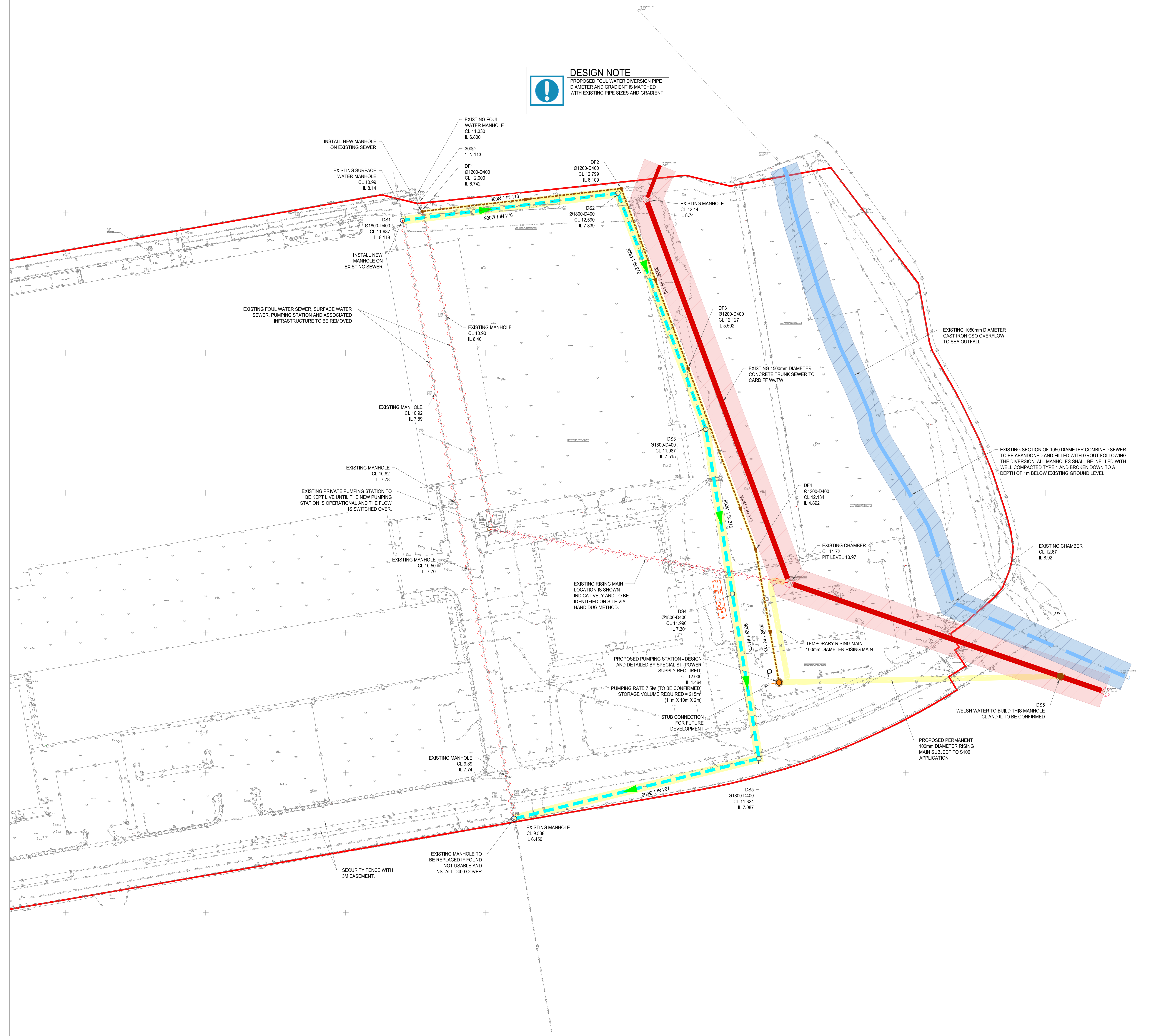

SCALE 1:500
DIMENSIONS IN METRES