

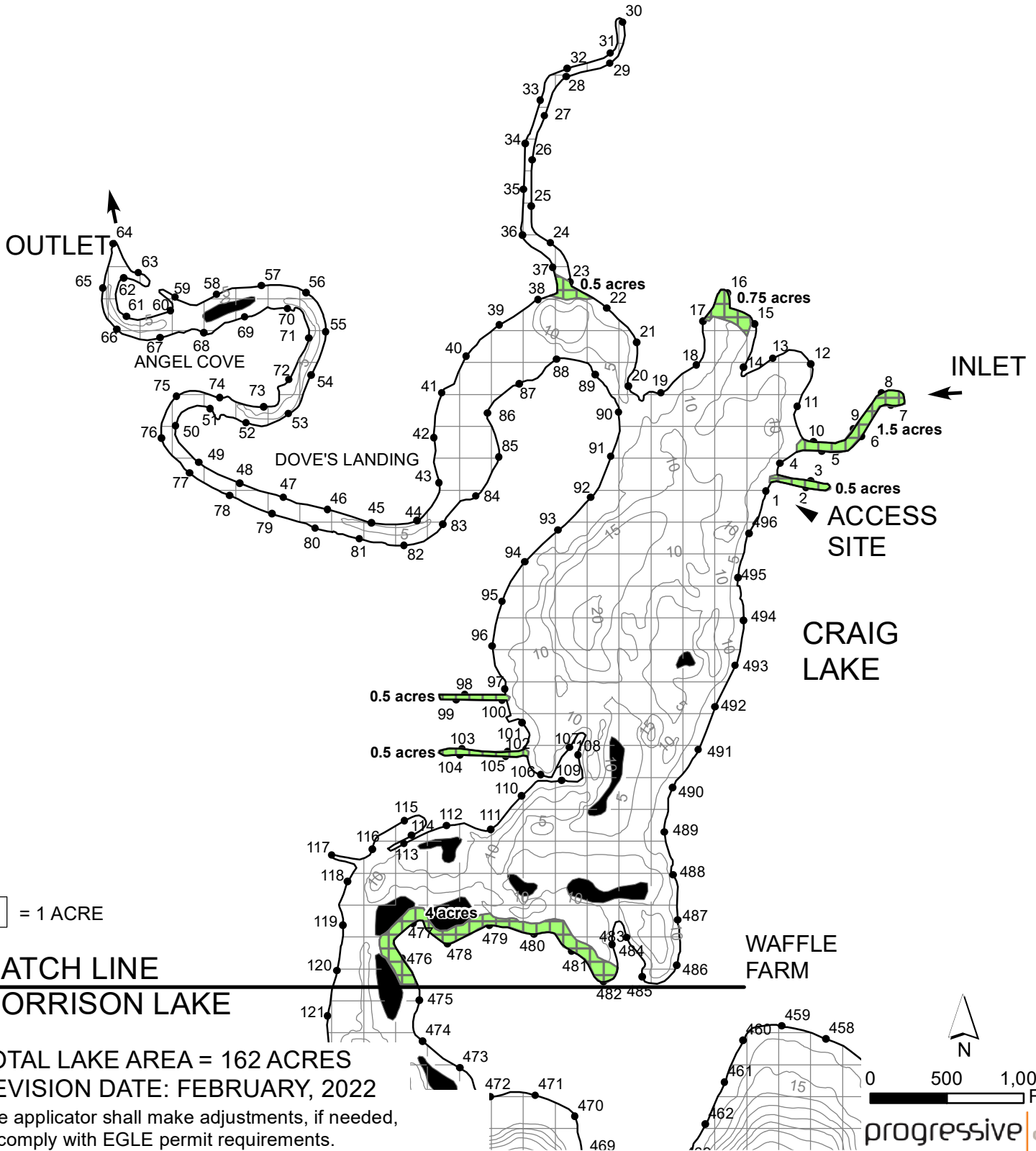

HODUNK - MESSENGER LAKE CHAIN (CRAIG LAKE) BRANCH COUNTY, MICHIGAN APRIL 2023 ALGAE TREATMENT MAP

Treatment

 SeClear @ 20 lbs/acre (8.25 acres)



 = 1 ACRE

MATCH LINE
MORRISON LAKE

TOTAL LAKE AREA = 162 ACRES
REVISION DATE: FEBRUARY, 2022

The applicator shall make adjustments, if needed, to comply with EGLE permit requirements.

HODUNK - MESSENGER LAKE CHAIN (MORRISON LAKE) BRANCH COUNTY, MICHIGAN APRIL 2023 ALGAE TREATMENT MAP

Treatment

 SeClear @ 20 lbs/acre (4.5 acres)

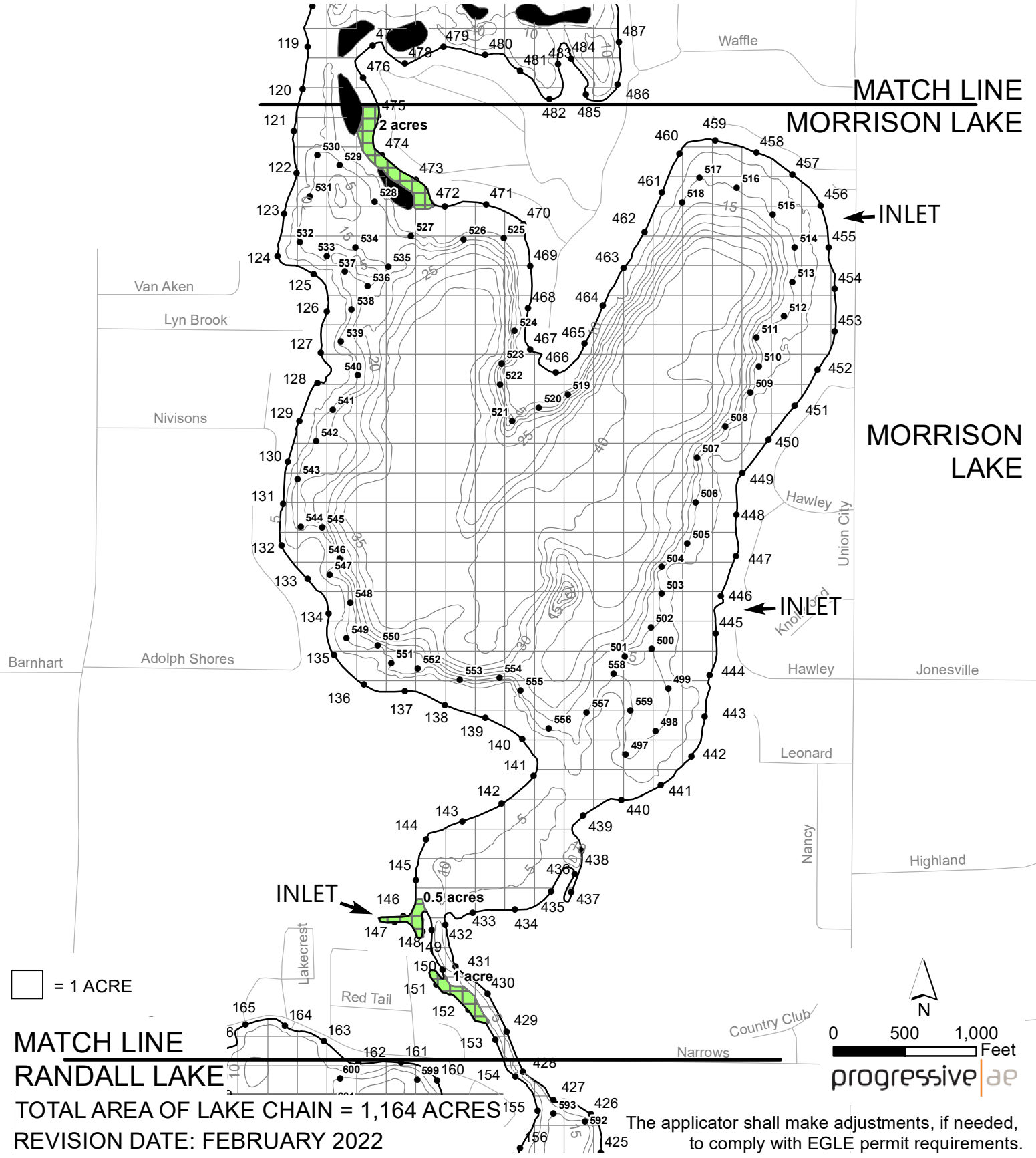

Bidwell

Waffle

Van Aken

Lyn Brook

Nivisons

Barnhart

Adolph Shores

Hawley
Union City

Knob
Hawley

Hawley

Jonesville

Leonard

Nancy

Highland

Country Club

Narrows

Red Tail

Lakecrest



0 500 1,000 Feet

progressive|ae

The applicator shall make adjustments, if needed, to comply with EGLE permit requirements.

HODUNK - MESSENGER LAKE CHAIN (RANDALL/NORTH/CEMETERY LAKE) BRANCH COUNTY, MICHIGAN APRIL 2023 ALGAE TREATMENT MAP

ACCESS

MATCH LINE
RANDALL LAKE

Treatment

 SeClear @ 20 lbs/acre
(21.5 acres)

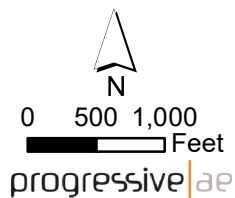
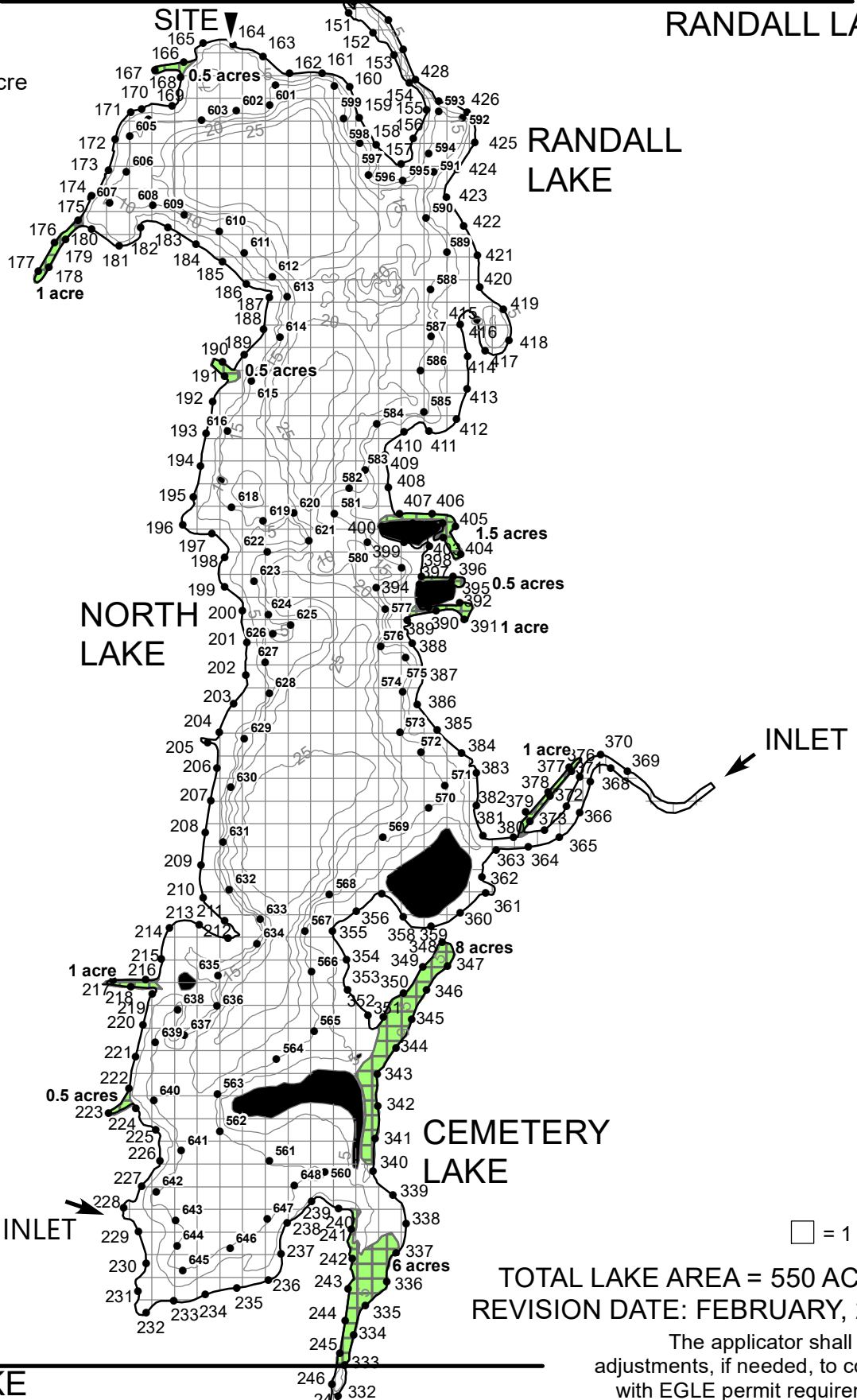



MATCH LINE
MESSENGER LAKE

HODUNK - MESSENGER LAKE CHAIN (SOUTH/MESSENGER LAKE) BRANCH COUNTY, MICHIGAN APRIL 2023 ALGAE TREATMENT MAP

Treatment

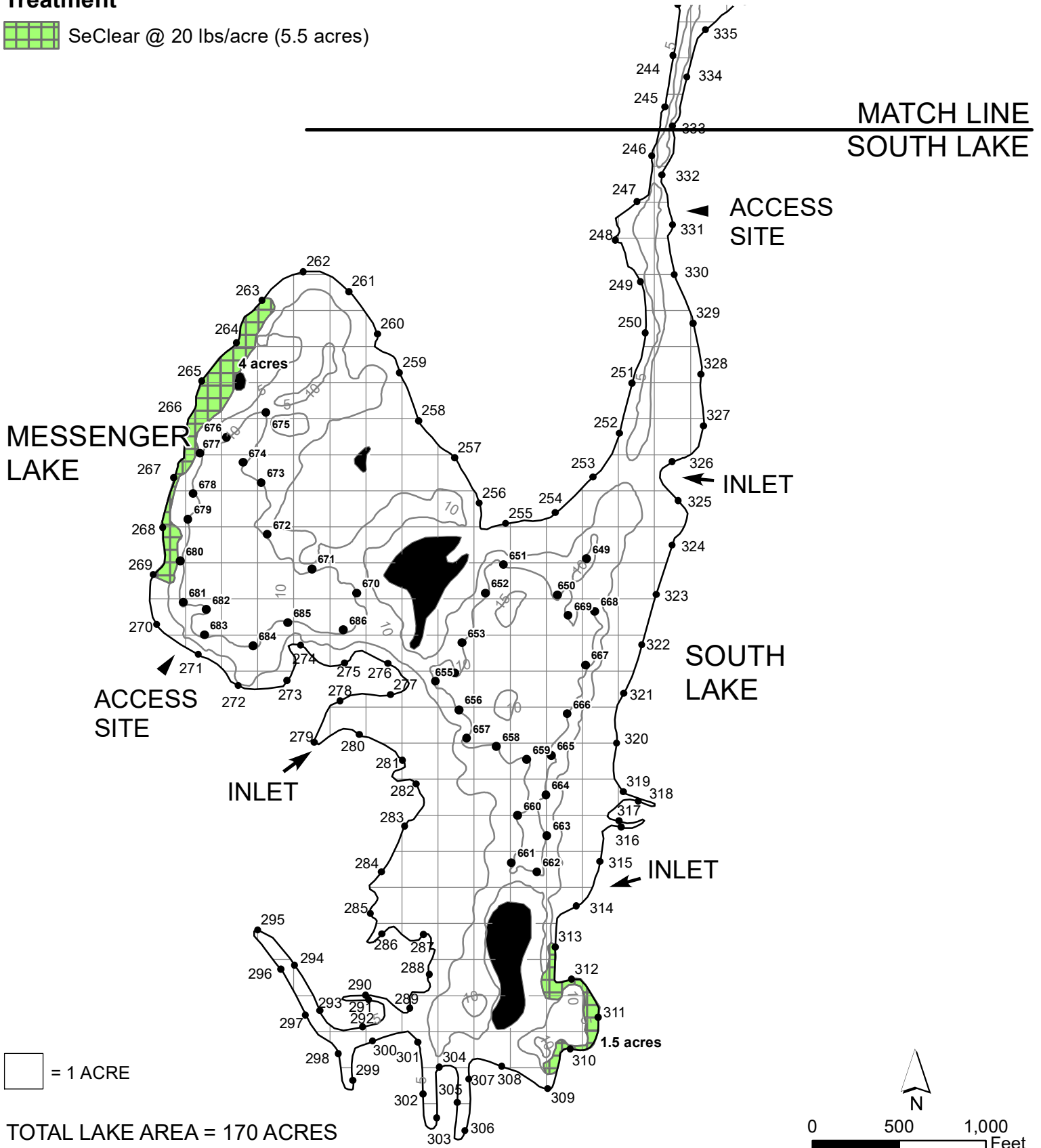
 SeClear @ 20 lbs/acre (5.5 acres)



 = 1 ACRE

TOTAL LAKE AREA = 170 ACRES
REVISION DATE: FEBRUARY, 2022

The applicator shall make adjustments, if needed, to comply with EGLE permit requirements.

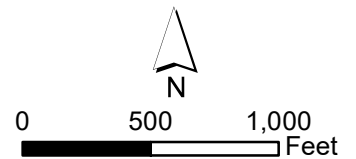

progressive|ae