



EMERGENCY RESPONSE & DISASTER RELIEF



KINGDOM BUILDING
GLOBAL INITIATIVE

IGI Kingdom Building Global Initiative exists to advance the Kingdom of God by building, empowering, and transforming communities worldwide. Guided by faith, integrity, and compassion, we deliver innovative, sustainable, and ethically grounded solutions that strengthen families, restore dignity, and create pathways for economic and social advancement.

Through our Zariyah's Kids programs, we are especially committed to protecting, uplifting, and creating inclusive opportunities for children—particularly children with disabilities—ensuring they receive the care, resources, and environments they need to thrive.

Through strategic partnerships, humanitarian outreach, and development initiatives, we work to uplift nations, cultivate stability, and inspire hope—ensuring individuals, families, and children can flourish spiritually, physically, and economically according to God's purpose and design.



KINGDOM BUILDING
GLOBAL INITIATIVE

ZARIYAH'S KIDS

Comprehensive Initiative to Stabilize Families

- Specialty Housing & Accommodations
- Medical Centers & Therapeutic Support
- Family Counseling & Support Centers
- Schools & Developmental Center
- Specialty Recreational & Social Activities
- Travel, Mobility & Adaptive Funding
- Wellness & Emotional Care
- Food & Nutrition Services
- Emergency & Crisis Relief Programs
- Community Integration & Advocacy



- **Subject:** Letter of Need for [Specify Purpose]
- Dear [Recipient's Name/To Whom It May Concern],
- I am writing to express a need for EMERGENCY HOUSING ASSISTANCE formally WHAT TYPE HOTEL RENTAL, ETC. "describe the REASON, TO HOUSE WHO This request is essential to [explain the goal or mission and its importance, e.g., "helping uninsured VICTIMS access LOCATION services" (SPECIFIC NEEDS (SOME ARE DISABLE AND REQUIRES)
- **Background**
- [Provide a brief overview of your MISSION or situation, highlighting its importance and relevance. Explain why the need has arisen and the impact it will have.]
- **Example:**
Our organization, [Your Organization's Name], has been dedicated to [mission or purpose] for [duration]. Over the years, we have [describe key accomplishments or ongoing efforts]. However, due to [specific challenge or reason], we require additional [resources/support] to continue or expand our work effectively.
- **The Need**
- We are requesting [clearly outline what you need, e.g., "a financial contribution of \$50,000," "access to materials," or "collaboration with specialists"]. This [support/resource] will enable us to:....

NEED HELP!



KINGDOM BUILDING
GLOBAL INITIATIVE

Submit A Request

Example Letter Of Need!

HUMANITERIAN

1. INFRASTRUCTURE
2. HOUSING
3. AGRICULTURE/FOOD
4. FARMS
5. TRANSPORTATION
- 6.. MEDICAL
7. ZARIYAHS KIDS (HEALTH/HOUSING)
8. EDUCATION
9. TRAINING/TRADES
10. BUILD ECONOMIC SYSTEM
11. WATER
12. ENERGY
13. FAMILY PRESERVATION
- 14 SUSTAINABILITY
15. EMERGENCY RESPONSE
16. DISASTER RELIEF





IGI-KBGI SHELTER SOLUTIONS

HOTEL STAY
HOUSING STRUCTURES
TEMPORARY SHELTER
COMMERCIAL POP-UP SPACE



RAPID HOUSING

SOLUTIONS



**THE NIYA
VILLAGE
LUXURY
1 & 2
BEDROOMS
1 BA**

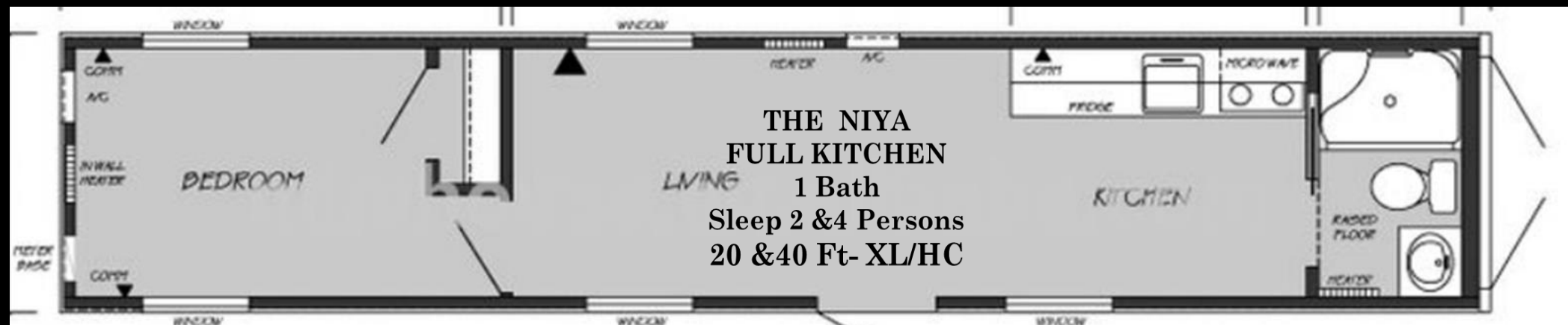



CUSTOM CONTAINER STYLE
NIYA ECO FRIENDLY





RAPID HOUSING

- **Transport:** Designed for convenient mobility, especially ideal for projects requiring frequent relocation of construction units.
- **Quality & Stress Resistance:** Built with robust steel construction, offering exceptional durability, earthquake resistance, and deformation resistance.
- **Sealing:** This feature has excellent sealing capabilities due to a precise manufacturing process, ensuring outstanding water-tightness.
- **Product Application Scope:** The mobile home, based on a standard steel chassis, supports various configurations, such as conference rooms, dormitories, kitchens, and toilets. Standard dimensions include a width of 2.4 meters, a height of 2.2 meters, and lengths ranging from 4 to 12 meters.
- **Merits:**
 - Easy to disassemble and reassemble
 - Superior structural stability and firmness
 - Excellent shockproof, waterproof, fireproof, and anti-corrosion properties
 - Lightweight and transportable as a single structure
 - Walls made of steel plates, with optional wood veneer finishes
 - Long service life, exceeding 20 years
 - This design is suitable for versatile applications while maintaining durability and functionality.



1 & 2 BEDROOM 1 & ½ BATH 1k Sq Ft
Same-day installation

THE AYDEN





THE AYDEN

ENCORE
DECOR

600 to 800 sq. ft.



ZARI SMART HOUSE

FULLY
FURNISHED



ZARI SMART HOUSE INTERIOR LIVING*KITCHEN *SHOWER *BATH BED



ZARI SMART HOUSE Floor Plan

MOVE IN READY





FURNISHED
ENCORE THE DÉCOR



THE ZARI SMART HOME

SLEPP 2 & 4, PERSONS RAPID HOUSING COMMUNITIES

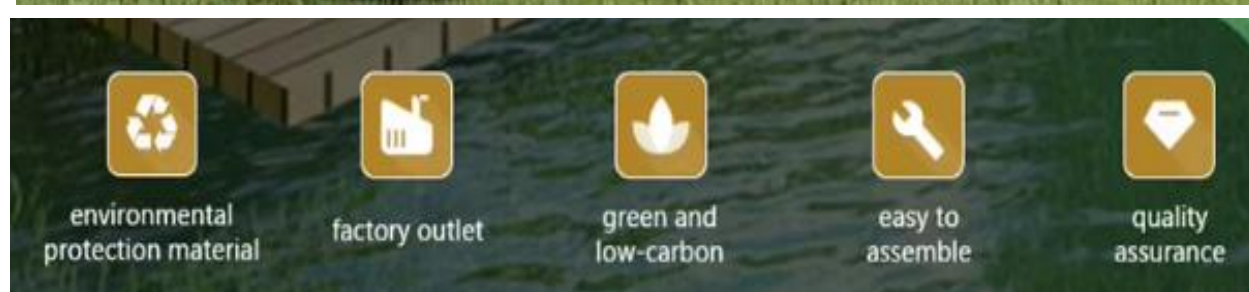

20 & 40 feet (sleep 2 & 4)
MOBILE HOTEL RAPID HOUSING





EMERGENCY SHELTER



NAZIRE EMERGENCY SHELTER SOLUTIONS

**40ft Expendable Container House Prefab Fordable Container House Customized Office Mall Modern
Small House Expandable Container, 20FT, 30FT & 40 FT, SLEEP 4 TO 6 . READY TO OCCUPY.**

The Nazaire STACKABLE

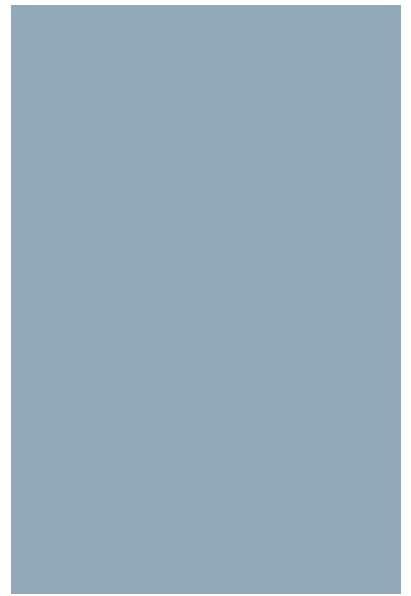



NAZIRE ASSEMBLE IN MINUTES

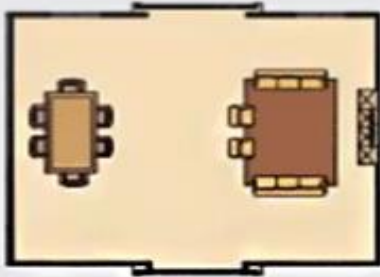

One Living room



One Living room
One Bedroom
One Restroom



One Living room
One Bedroom
One Restroom



One Living room
Two Bedrooms
One Restroom



One Living room
Two Bedrooms
One Restroom



One Living room
Three Bedrooms
One Restroom

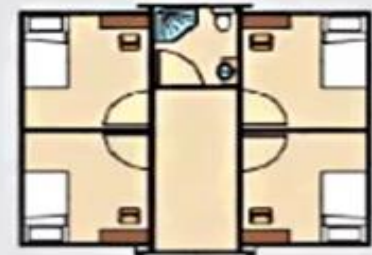

Four Bedrooms
One Restroom

THE NAZAIRE

1,2,3,&4 BEDROOMS

FLOOR PLANS



Rapid Response Camp Sites

Kitchens* Bathrooms* Showers





EmergencyHomes

Folding Design
Quick Install



The JR

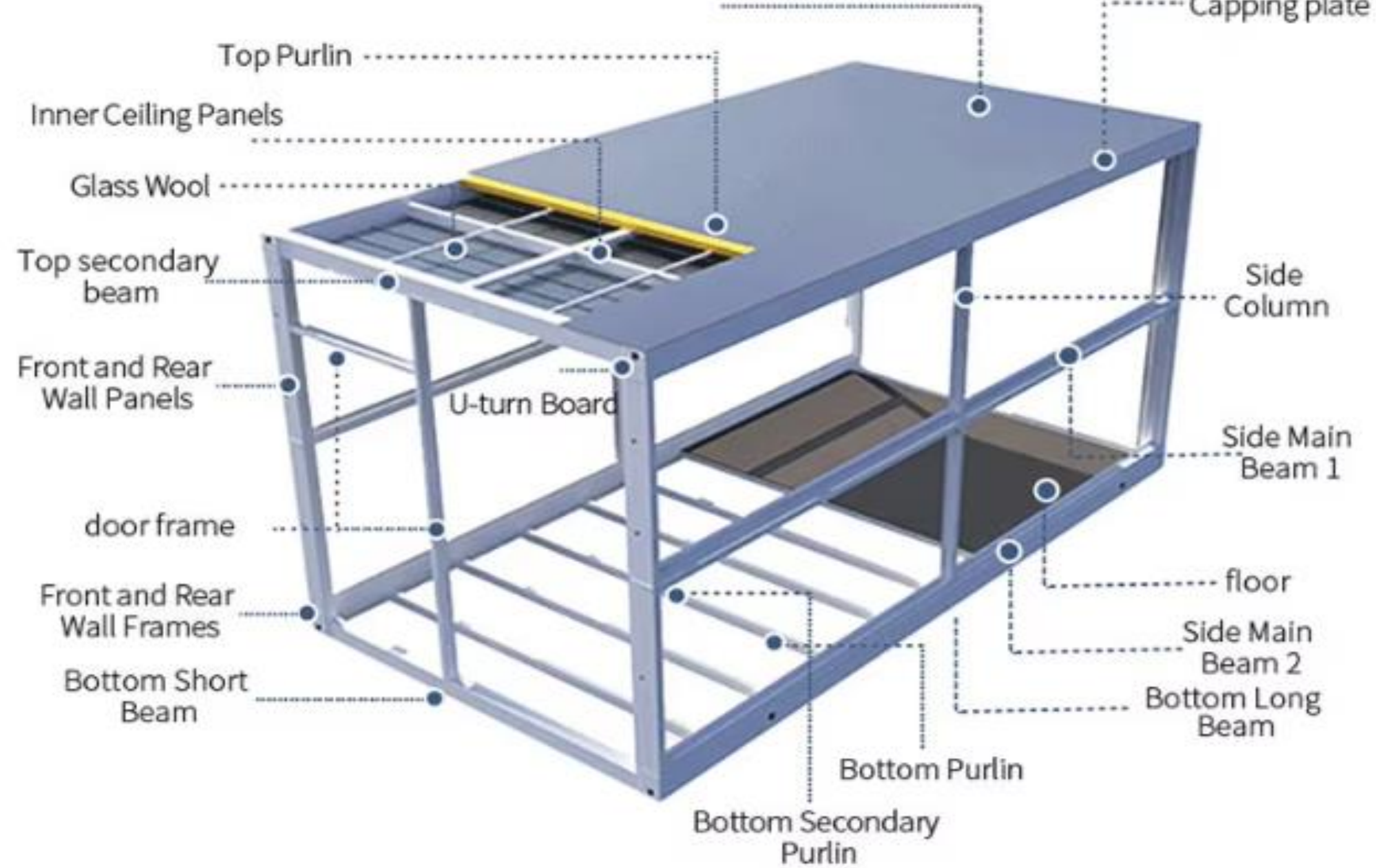

No	Products name	Developed size W*L*H mm	Folding size W*L*H mm	Mode of transport
1	20 feet standard room	6300*5900*2480	2200*5900*2480	40 feet high container
2	40 feet standard room	6200*11800*2480	2200*11800*2480	40 feet high container
Other	Wall board/ceiling	thickness 50mm (EPS Clean color plate/Metal carving board)		
	Window	Plastic steel window/aluminum alloy window/broken bridge aluminum window		
	Flooring	Laminated wood/floor leather		

THE JR SLEEP 1 TO 4 PRODUCT DESCRIPTION

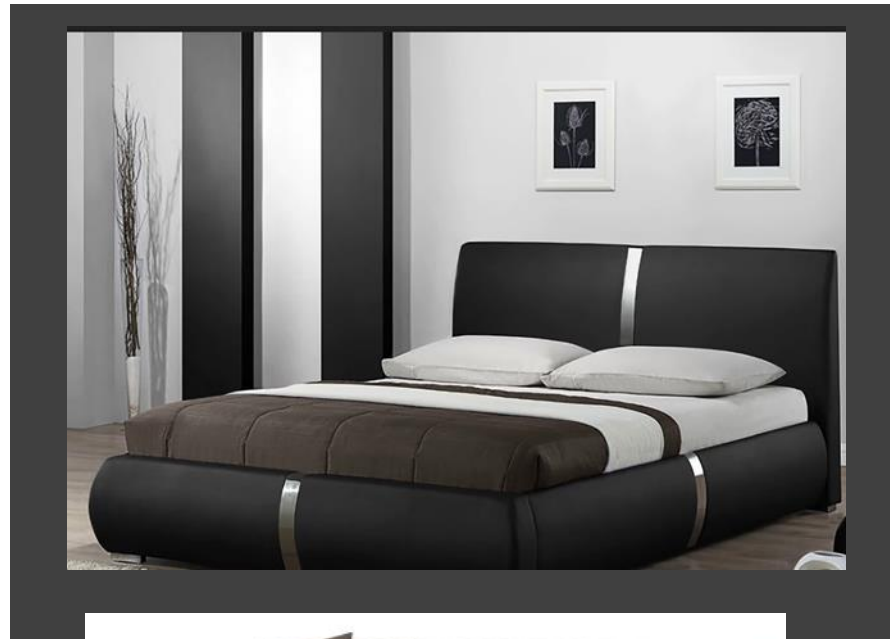

• FULLY FURNISHED



WATER
PURIFIER

SOLAR
SYSTEMS

GENERATORS





EMERGENCY-MEDICAL -SURGICAL EQUIPED UNITS
IGI-KBGI

**Green & Energy Efficient
Sustainable
Earthquake Proof
Fire Proof
Termite Proof
Tsunami Resistant
Low Maintenance**



WANT TO JOIN OUR CAUSE

CONTRACTORS

BUILDERS

SUPPLIERS

WELCOME!



Permanent Structures

ONE WEEK -MOVE IN READY

ON SITE ASSEMBLY

PROPERTY OWNER'S ARE RESPONSIBLE FOR THE FOLLOWING ON-SITE CONSTRUCTION ITEMS: PERMITS, INTERIOR FRAMING, PLUMBING, HVAC, CONCRETE BUILDING ASSEMBLY, ELECTRICAL (EXTERIOR FINISH IF CHANGED TO ANYTHING OTHER THAN THE METAL FINISH PROVIDED BY US) INTERIOR FLOOR PLAN, VERIFYING THAT LOCAL WIND, ROOF, AND GROUND LOADS ARE CORRECT. INTERIOR FINISHING (THE INTERIOR CAN BE FINISHED WITH A VARIETY OF MATERIALS, WOOD, SHEETROCK OR METAL)

OPT 1. DO IT YOURSELF

Plumbing,
General Contracting services
Heating & A/C
Flooring
Concrete/Foundation work
Electrical
Stucco
Insulation
Handyman Services
You are Responsible for Installation, Hook-ups and Proper Work.

• OPT 2. WE DELIVER & INSTALL

Turnkey (furnishings may be included)



THE T UNITS

RESIDENTIAL OR COMMERCIAL TECHNOLOGY

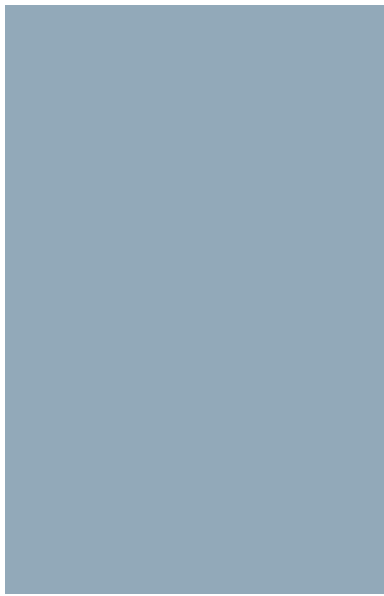

T UNITS MULTI-USE

NO WASTE

WATER/RESISTANT

FIRE RETARDANT

MULTI PURPOSE

ECO-FRIENDLY

FRAMED IN 7 DAYS

ASSEMBLED ON SITE

MEET ALL BUILDING CODES

Structural Insulated Panels vs. Traditional Framing



Structures built with SIPs perform above and beyond traditionally built buildings in numerous ways:

SIP structures are significantly more energy efficient than stick-built/fiberglass insulation structures.

SIP buildings are stronger than stick-built structures. Exhaustive laboratory testing has found them superior in sheer resistance and tensile strength.

SIP buildings are frequently found to be the only structures left standing after earthquakes, hurricanes, and tornadoes.

SIP homes and buildings are significantly quieter than traditionally built structures. Studies have shown that a more peaceful home or office is a healthier place to be.

- SIP structures have reduced air infiltration. When ventilated properly, they have superior indoor air quality compared with other traditional building methods.
- SIP buildings can be erected significantly faster. No other structural framing or insulation is necessary.
- SIP installation produces significantly less job site waste than traditional building materials.
- Most of the small amount of waste produced can be recycled.
- Building with SIPs is a sound financial investment. When you factor in labor, waste hauling, and energy savings, SIP structures are comparable to traditionally built homes.
- In addition, energy-efficient SIP homes often have a higher value on the real estate market and often qualify for energy-efficient mortgages.
- And more. Speak with a Hi-tech build engineer today.



CONSTRUCTION
MATERIALS



PERMANENT HOUSING

HI-TECH BUILD. FACTORY CONSTRUCTION HAS GAINED POPULARITY AS A WIDELY USED BUILDING SYSTEM. SOME OF THE TECHNOLOGIES HAVE BEEN AROUND SINCE THE 1950S; THEY REMAIN VALUED FOR THEIR EFFICIENCY AND ADAPTABILITY.

BUILDING EXCELLENCE IN HALF OF THE TIME.



ENCORE THE DECOR





4 MEN-8 HOURS-30 YEARS WARRANTY



OUTDOORS LIVING SPACE



+
**COMMERCIAL &
MIXED-USE
STRUCTURES
BUILT IN WEEKS**



Pop-up
food & commercial spaces



KINGDOM BUILDING
GLOBAL INITIATIVE



KINGDOM BUILDING
GLOBAL INITIATIVE

CONTACTIGL-KBGIAT
WWW.INVESTGLOBAL.BIZ

+1-619-993-2356



**HI-TECH
BUILD**

**INNOVATIVE & ROBOTIC
TECHNOLOGIES USED TO
BUILD STRUCTURES,
HIGHWAYS, STREETS &
BRIDGES**

**CONTACT
404 559 3225
VISIT WWW.HITECH.BUILD**

**DISASTER RECOVERY PARTNER
GIVING BACK IS HOW WE MOVE FORWARD**



360  **CONSTRUCTION**



MOV2LIV WELLNESS CENTERS
HYDROTHERAPY REDEFINED
Experience Life in a Whole New Way