

Date	Serial #	Prefix	E/ER	Sawgrd	Wedges	Fence	Brkt Slot	1/8 Ways	Headrest	Tbl Rod	Flat Base	Name
Australia	264	A	E	solid	1	horiz	?	N	2,iron	hollow	Y	Leo Canning
Australia	891	A	ER	solid	2	horiz	E	N	2,iron	solid	N	Colin Woodhouse
	1032	E	E	slots	2	horiz	E	N	4,iron	hollow	N	
Australia	1186	A	E	solid	2	horiz		4 N	2,iron	solid	Y	Gary Shilson-Josling
Late 1947	1414		E	slots	2 Brass	horiz 1	E	N	4,iron	solid	N	Everett L. Davis
	1564	E	E	slots	2	horiz	E	N	4,iron	solid	N	Jerome Karnowski
Australia	1565	A	E	solid	2	horiz		4 N	?	solid	N	Colin Benporath
Australia	1594	A	E	solid	2	horiz		4 Y	2,iron	solid	Y	Mark Randall
	1602		E	none	2	horiz	E	N	4,iron	solid	N	Dennis Teets
	1702		E	solid?	2	horiz	none	N	2,iron	solid	N	Paul Naylor
	1935		E	none	2	horiz	E	N	2,iron	hollow	N	Dick Adamson
	1983	E	E	slots	2	horiz	E	N	4,iron	solid	N	Robb Ruyle
	2102		E	solid	2	horiz		4 N	2,iron	hollow?	Y	Mike Taborski
	2107	E	E	slots	2	horiz	E	N	4,iron	solid	N	Quin Leach
	2230	ER	ER	na	2	horiz		4 N	4,alum	solid	Y	Paul Dunbar
	2273		E	solid	2	horiz	E	N	4E	solid	N	Barry Gough
	2328	E	E	solid	2	horiz		4 N	2,	solid	Y	Don Winans
	2328	E	E	solid	2	horiz		4 N		hollow	Y	Don Winans
	2397		E	slots	2	horiz	none	N	4,iron	solid	Y?	Jefferson Howery
	2577		E	slots	2	horiz	E	Y?	4,iron	solid	N	Chip Colby
	2733		E	slots	2	horiz	E	N	4,iron	solid	N	Richard Lofton
	2770		E	na	2	horiz	na	N	4,iron	solid	N	David Gaskill
	3072	E	ER	slots	2	horiz	E	N	4,alum	solid	N	Jacob Anderson
	3362		E	slots	2	horiz	none	N	4,iron	solid	N	Mike Theisen
	3400		E	slots	2	horiz	E	N	4,iron	solid	Y	Howard Mann
	3449	E	E	slots	2	horiz	none	N	4,iron	solid	N	Ed Brody
	3575	E	E	slots	2	horiz	E	N	4,iron	solid	N	Randy Kwapis
	3779	E	E	slots	2	horiz	E	N	4,iron	solid	N	James Grange Sr
	3799	E	E	slots	2	horiz	E	N	4,iron	solid	N	Mark O'Donnell
	4038	E	E	na	2	horiz		5 N	4,iron	solid	N	Clem Ashley
	4072		E	none	2	none	none	N	4,iron	solid	N	Michael Skinner
	4178	E	E	slots	2	horiz	E	N	4,iron	solid	N	Jack Wood
	4405		e	na	2	horiz	E	N	2,alum	solid	N	Jim Folger
	4593	E	E	solid	2	horiz	E	N	2,iron	solid	N	Robert Reid
	4598	E	ER	slots	2	horiz	E	N	4,iron	solid	N	Bob Reid
	4624		ER	na	2	horiz		4 N	4,iron	solid	N	Frank
	4748	E	E	slots	2	horiz	E	N	4,iron	solid		Bill Atnip
	4952		E	none	2	horiz	E	?	?	solid	N	David Baker
	5588	E	ER	none	2	horiz		5 N	4,iron	solid	N	Brad Willett
	5838		E	slots	2	horiz	E	N	4,iron	solid	N	Daniel Kopp
	5907		E	none	2	na		5 N	4,iron	solid	N	Randy Nick
	5910	E	E	slots	2	horiz	E	N	4,iron	solid	Y	William L. Watson
	6092	E	E	slots	2	horiz	E	N	4,iron	solid	N	Peter Kennedy
	6252		E	none	2	horiz	E	N	4,iron	solid	N	Jonathan Fox
	6473		E	slots	2	horiz	?	?		solid	N	
	6853	E	E	slots	2	horiz	E	N	4,iron	solid	N	Steve Witter
	7491	E	E	solid?	2	horiz	none	N	4,iron	solid	Y	
	7521		E	none	2	horiz	E	N	4,iron	solid	N	Peter Crowl
	7526	E	E	none	2	horiz	E	Y?	4,iron	solid	N	Joe Dupre
	7584	E	ER	slots	2	horiz	E	N	4,iron	solid	N	Bob Barsalou
	8068	E	E									Stephen Robinson
	8121		E	slots	2	horiz	E	Y	4,iron	solid	N	Scott Little
	8165		E	solid?	2	horiz	E	Y	4,iron	solid	N	Don Dakan
	9049		ER	slots	2	horiz		4 N	4,iron	solid	N	Bob Thompson
	9050		ER	slots	2	horiz		4 N				John Hastie
	10392		E	none	2	horiz	none	N	4,alum	solid	Y	Robert Miller
	10541		E	slots	2	none	E	N	4,alum	solid	N	Gary Bashian
	10637	E	ER	slots	2	horiz	none	N	4,iron	solid	N	Skip Dawson
	10665	E	E	none	2	horiz	none	N	4,iron	solid	N	Henry Boulden
	10771		E	none	2	none	none	N	4,iron	solid	N	Robert Kruyer
	10974	E	ER	none	2	horiz		4 N	4,iron	solid	N	Don Kirwan
	11051		E	slots	2	angled? 3	none	N	4,alum	solid	N	Ted Thousand
	11056	E	ER	slots	2	horiz		4 N	4,iron	solid	Y	Joe Pospisil
Sep1949*	11122		ER									George Gibason
	11709	ER	ER	na	2	horiz	na	N	4,alum	solid	Y	Michael Dundas
	11908	ER	ER	slots	2	horiz		4 N	4,iron	solid	Y	Curtis Matthews
	12103	E	E	slots	2	angled 3		N	2,iron	solid	N	Erik van Oudheusden

Example Photos

This re-working of the 10E and 10ER Serial Number Data is Extensively Based on the original painstaking work by Skip Campbell, the Dean of the 10E and 10ER - Everett-



Serial = Numbers Only
Prefix = Letters In front of Numbers
E/ER = Model Number 10E, 10ER as Printed on the Circumference of the Badge itself



Sawgrd = slotted or solid



2 Piece Brass

Wedges = 2 for 2 Piece, 1 for 1 Piece, or 2 Brass for 2 Piece Brass

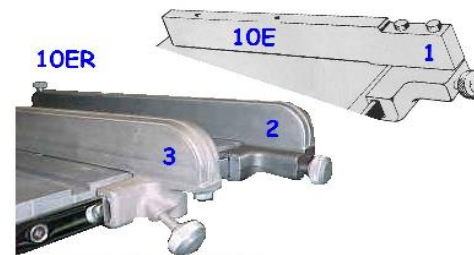

Plain or Wedged?

Fence = Horiz 1, Horiz 2, or Angled 3
If Fence type = Angled 3 it needs a suffix P or W see next photo

Date	Serial #	Prefix	E/ER	Sawgrd	Wedges	Fence	Brkt Slot	1/8 Ways	Headrest	Tbl Rod	Flat Base	Name
	12141	E	ER	slots	2	horiz	E	N	2,iron	solid	N	
	12397		E	none	2	horiz	none	N	4,iron	solid	N	Mark Woodyard
	12869		E	none	2	horiz	E	N	4,alum	solid	N	Joe Allen
	12910	ER	E	slots		horiz		N	4,iron	solid	N	John Jones
	13114		E	solid?	2	horiz	E	N	?	solid	N	Dennis Brittain
	13538		E	slots	2	horiz	E	N	2	solid	N	Bob Reeder
	13538		E	none	2	horiz	E	N	2,alum	solid	N	Joe Kelsay
	13648	E	E	slots	2	horiz		4 N	4,iron	solid	N	Al Durrell
	14688		E	?	?	?	?	?	?	?	?	Thao Tran
	15004	ER	na		2	horiz		4 N	4,iron	solid	N	Marc Cadorette
	15006	ER	ER	na	2	horiz		4 Y?	4,iron	solid	N	Dan Pennington
	15107	ER	ER	slots	2	horiz		4	2,iron	solid	N	Steve Merchant
	15141		E	slots	1?	horiz	none	Y?	2,iron	solid	N	Morris Swenson
	15386		E	slots	2	angled? 3	6?	Y?	2,alum	solid	N	Griffin L. Meredith
	15667	ER	ER	slots	2	horiz		4 N	4,iron	solid	N	Stephen R. Quintal
	15845		ER	solid	2	horiz		4 N	4,alum	solid	N	Roy Wiesner
	15937		E	none	1?	horiz	none	N		2 solid	N	Gene Allen
	15969	E	ER	?	1?	?		N	2,iron	solid	Y	Greg Morse
	16061	E	E	na	2	angled 3		N	2,iron	solid	N	Erik van Oudheusden
	16068	E	E	slots	2	horiz		N	2,iron	solid	N	Erik van Oudheusden
	16075		ER	none	2	horiz		4 N	4,iron	solid	N	Bill Bauer
	16186		E	slots	1	horiz		4 N		2 solid	N	James D. Caldwell
	16197	ER	ER	solid	2	horiz		4 N	4,iron	solid	N	Ron Roberts
	16295		ER	slots	2	angled? 3	none	N	4,alum	solid	N	Chris Boyer
	16653		E	slots	2	horiz	E	N	4,alum	solid	N	Mike Theisen
	16844		E	solid	2	horiz		5 N	4,iron	solid	N	Ralph Bozenda
	17386	ER	ER	na	2	horiz		4 N	4,iron	solid	N	Ron Gerlach
	17389		E	slots	2	horiz	E	N	4,alum	solid	N	Russ DeVall
	17433	ER	ER	slots	2	horiz		4 ?	4,alum	solid	N	Harry Brunner
	17566		E	na	2	horiz	n	N	4,alum	solid	N	George Winters
	17627	ER	ER	slots	2	horiz		4 N	4,iron	solid	N	Jim Shirley
	18618		ER	none	2	horiz		4 N	2,iron	solid	N	R Loyd Harrison
	18891		E	slotted	2	horiz	E	N	2,iron	solid	N	Charles Tullis
Mar1950*	19102	ER	ER	slots	2	horiz		4	4,iron	solid	N	Paul Penny
	19148		E	none	2	horiz		N	4,alum	solid	N	Mark Ferro (sold)
	19743		E	none	2	horiz	E	N	4,alum	solid	N	Bill Baldwin
	19925		E	slots	2	horiz		5 N	4,iron	solid	N	Tom Walker
	20392	E	ER	slots	2	horiz		4 N	4,alum	solid	N	Kevin Corry
	20419	ER	ER	solid	2	horiz		4 N	4,iron	solid	N	David Owens
	20560		E	none	2	horiz	none	N	4,alum	solid	N	Vern Schervem
	20666	E	ER	solid	2	horiz	6?	N		4 solid	N	Doug Mella
	20748	E	ER	solid	2	horiz	6?	N	2,iron	solid	N	Jonathan Wickham
	21033		E	Nn	2	Nn	E	N	4,alum	solid	N	Sean Barry
	21051	ER	ER	solid	2	horiz		4 N	4,iron	solid	N	Chris Lucas
	21062	E	ER	solid	2	N(E)	E?	N	4,alum	solid	N	Paul Eisenbrandt
	21502	E	E	solid	2	horiz	E	N	4,alum	solid	Y	Frank Regalado
	21564		ER	na	2	horiz	E	N	4,iron	solid	N	Barry Wilson
	21719	ER	ER	solid	2	horiz		6 N	2,alum	solid	Y	Vaughn Heifner
	21831		E	slotted	2	horiz	E	N	4,alum	solid	N	Gary Ford
	21925	ER	ER	na	2	horiz		N	4,iron	solid	Y	Jacob Anderson
	22122	E	ER	slots	2	horiz		4 N	4,alum	solid	N	Bob Reeder
	22138		ER	solid	2	horiz		4 N	4,alum	solid	N	Don Collingwood
	22249	ER	ER	solid	2	horiz		6 N	4,iron	hollow	N	Gary Pound
	22387		ER	solid	2	horiz		4 N	4,alum	solid	N	Michael Pizzola
	22477		ER	solid	2	horiz		4 N	4,alum	solid	N	Davey Mallett
	22613		E	na	2	na	na	N	4,alum	solid	N	Joe Stewart
	22876	E	ER	solid	2	horiz	?	N	2,iron	hollow?	?	Dave Shubert
	22970		ER	slots	2	angled? 3	6?	Y	4,alum	solid	N	Kent Oakley
	23171		E	slots	2	na	E	N	4,iron	solid	N	Chip Colby
	23204	E	ER	solid	2	horiz		4 N	2,alum	solid	N	Demetrios Marousis
	23741	R	E	solid		horiz			2,alum	solid	N	Jack O'Connor
	23757	R	ER	none	2	horiz		4 N	4,alum	solid	N	MKC
	23781	E	ER	solid	2	horiz		4 N	4,alum	solid	N	Don Fyler
	23841	R	ER	solid		horiz		4 N	?	solid	N	Patty K
	23888	R	ER	na	2	horiz	na	N	4,alum	solid	N	Ralph Cobb
	24013	ER	ER	solid	2	horiz		4 N	4,alum	solid	N	Garry West
	24028	R	ER	slots	2	horiz		4 N	4,alum	solid	N	Steve Hutchins

Example Photos



Angled Fence Lock can be one with Plain Screw (left) or With Wedge (right)
 Plain Screw = Angled/3P
 Wedged = Angled/3W
 The original survey just did Horizontal which is (1 & 2) or Angled which is (/3W or /3P)
 Those that are listed as Angled 3 could be either type - it was not stated only Angled

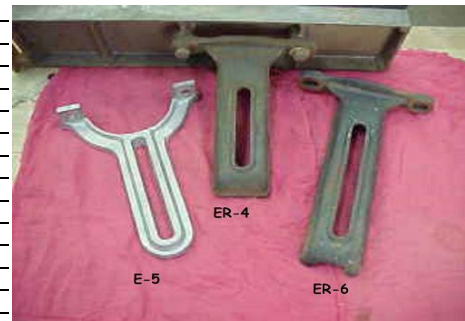

E = Original ER with wooden extension table
 E-4 = First 10ER extension table with short bracket
 E-6 = Later 10ER extension table with longer bracket

There was more confusion on the response for this



1/8 inch wall thickness Way Tubes opposed to 1/4 inch wall in original Thicker Tubes
 1/8 = (Y)es otherwise (N)o

Date	Serial #	Prefix	E/ER	Sawgrd	Wedges	Fence	Brkt Slot	1/8 Ways	Headrest	Tbl Rod	Flat Base	Name	
	24230	E	ER	none	2	horiz	4	N	4,alum	solid	Y	Paul Dunbar	
	24377	R	ER	slots	2	horiz	4	N	4,alum	solid	N	Richard Woelffer	
	24557	R	ER	slots	2	horiz	4	N	4,alum	solid	N	Tim McCoy	
	24630	ER	ER	solid	2	horiz	4	N	2,alum	solid	N	Jeff Loney	
	24656	E	ER	?	2	horiz	4	N	?	solid	?	Daniel Van Horn	
	24804	E	E	none	2	horiz	E	N	2,iron	solid	N	Judy Vratil	
	24936	E	ER	none	2	horiz		6	N	2,iron	solid	N	Scott M Grade
	24978	E	E	slots	2	horiz	?	N	4,alum	solid	N	Dale Shore	
	25079	E	ER	slots	2	horiz		4	N	4,alum	solid	Y	Carl Neste
	25107	ER	ER	none	2	horiz		4	N	4	solid	N	Gary Dutschmann
	25470	R	ER	slots	2	horiz		4	N	4,iron	solid	Y	David Metz
	25982	R	ER	none	2	horiz		4	N	4l	solid	N	Bob Jennings
	26062	R	E	solid?	2	horiz	6?	N	2,iron	solid	Y	Bruce Jackson	
	26150	R	E	slots	2	horiz	E	N		4	solid	N	Joe m Ortiz
	26507	E	ER	solid	2	horiz		6	N	4,alum	solid	N	Rev Tom Cox
	26585	ER	ER	solid	2	horiz		6	N	4,iron	solid	N	Gregg Jones
	27168	E	E	slots	2	horiz		4	N	4,alum	solid	N	Steve Brouillard
	27190	ER	ER	none	2	none		4	N	4,iron	solid	Y	John Schwanz
	27301	ER	ER	solid	2	horiz		6	N	4,alum	solid	N	Michael J. Pawlek
	27383	R	ER	slots	2	horiz		4	N	4,alum	solid	N	Bob Reeder
	27445	R	ER	slots	2	horiz		4	N	4,alum	solid	N	Keith A. Palmer
	27789	R	ER	slots	1?	horiz		4	N	4,alum	solid	N	Horst Hartung
	27972	E	ER	solid	2	horiz		4	N	4,alum	solid	N	Ed Brody
	28288	R	E	slots	2	horiz	E	N	4,alum	solid	N	Al Heath	
	28440		ER	none	2	horiz		4	N	4,alum	solid	N	Scott McNeil
	28460	E	ER	slots	2	horiz		4	N	4,iron	solid	N	Michael Goldberg
	28519	R	ER	slots	2	horiz		4	N	4	solid	N	R. Burnside
	29020	E	ER	solid	2	horiz		4	N	4,alum	solid	N	Terry Hennessy
	29225	E	ER	none	2	horiz		4	N	2	solid	N	Dion Loving
	29408	ER	na	na	2	horiz	na	N	4,alum	solid	N	Thomas Little	
	29559	E	ER	solid	2	horiz		4	N	4	solid	N	Tom Paddock
	29705	E	ER	slots	2	horiz		4	N	4,alum	solid	N	John Lawson
	29810	ER	ER	solid	2	horiz		4	N	4,alum	solid	N	Jim Yanacek
	29947	R	E	none	2	horiz		4	N	4,iron	solid	N	Kenn Geiger
	29956		E	slots	2	horiz		4	N	4,iron	solid	N	James Neal
	30081	ER	ER	solid	2	horiz		4	N	2,alum	solid	N	Eric Council
	30085	R	E	slots	2	horiz		4	N	4,alum	solid	N	Steve Skouson
	30241	R	ER	slots	2	horiz		4	N	4	solid	N	Bill Canine
	30641	ER	ER	slots	2	horiz		4	N	4,iron	solid	N	Maynard Olson
	31068		ER									Scott	
	31096		ER	solid	2	horiz						Shane Poley	
	31154		ER	solid	2	horiz		4	N	4,alum	solid	N	Leif Henecke
	31696	R	ER	slots	2	horiz		4	N	4,alum	solid	N	Mike Boehme
	31916		ER	na	2	horiz		4	N	4,alum	solid	Y	Bruce Brenner
	32198		ER									Stephen Robinson	
	32241		ER	slots	2	horiz		4	N	4,alum	solid	N	Scott Olsen
	32330	R	ER	slots	2	horiz		6	N	4	solid	Y	Keith
	32628	R	ER	slots	2	horiz		4	N	4,alum	solid	N	Geoff Crimmins
	32688	R	ER	na	2	horiz	na	N	4,alum	solid	N	Ron Krager	
	33665	E	ER	solid	2	horiz		4	N	4,alum	solid	N	Ries Collier
	34008	R	ER	solid	2	horiz	none	N		4	solid	Y	Keith
	34080	E	ER	solid	2	horiz		4	N	2,alum	solid	N	Glenn Campbell
	34084	ER	ER	solid	2	horiz		4	N	4,iron	solid	N	David Burcham
Dec1950*	34170		ER										
	34183		ER	solid	2	horiz		4	N	4,iron	solid	N	Michael Long
	34268	E	ER	solid	1	horiz		4	N	4,alum	solid	N	Gary Williams
	34269	E	ER	solid	2	horiz		4	N		solid	N	
	34428	ER	ER	solid	2	horiz		4	N	4,iron	solid	N	Jim Kiely
	34538	R	ER	na	2	horiz	na	N	4,alum	solid	N	Grant Erwin	
	34648	ER	ER	solid	2	horiz	na	N	4,iron	solid	N	Rob Brenner	
	34724	R	ER	na	2	na		4	N	4E	solid	N	Jeffery Morris
	34777		ER	na	2	na		6	N	4,iron	solid	N	Ken Woolard
	34788		ER	solid	2	horiz		4	N	4	solid	N	Richard James
	35259	ER	ER	none	2	horiz		4	N	4,iron	solid	N	Paul Knight
	35365	ER	ER	solid	2	horiz		4	Y	4,alum	solid	N	Andrew Albright
	35601	R	ER	solid	2	horiz		4	N	2,iron	solid	N	Marvin Roe
	35673	R	ER	none	2	horiz		4		solid	N	Arnold Court	

Example Photos

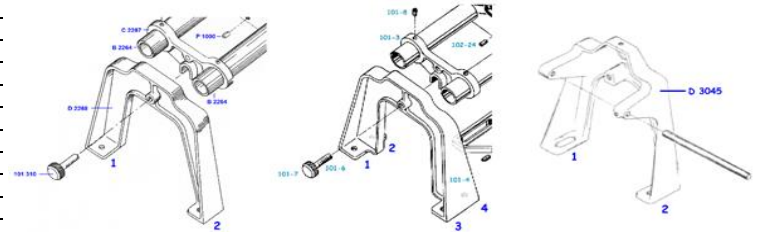

Headrest = 2 Bolt 4 Bolt or J for Jointer

Four Bolt Original = 4
Two Bolt 2nd Generation Headrest = 2
Jointer Headrest = J

Apparently some were made of Iron some Aluminum based on responses of owners

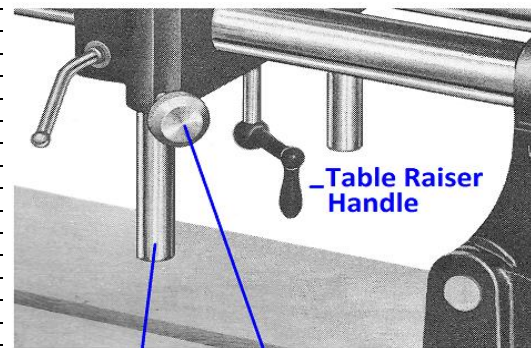
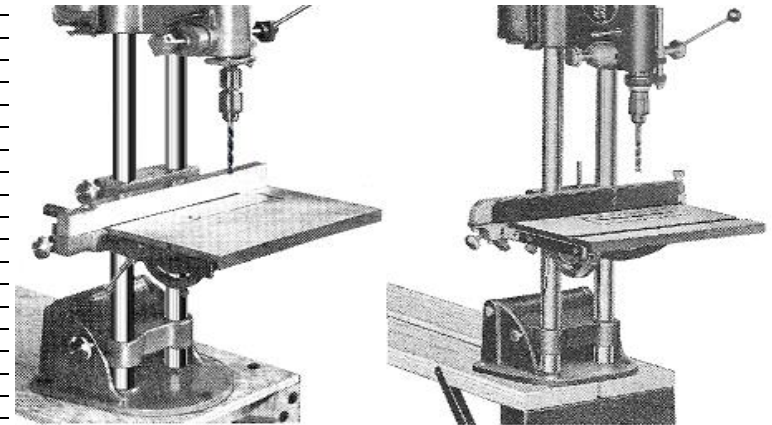

Table Rods

Carriage Knob

Tbl Rod = solid or hollow



Flat Base = N for Original 10E Rounded Base or = Y for 10ER Trimmed Base

Date	Serial #	Prefix	E/ER	Sawgrd	Wedges	Fence	Brkt Slot	1/8 Ways	Headrest	Tbl Rod	Flat Base	Name	Example Photos
	35683	R	ER	solid	2	horiz	4	N	4,alum	solid	N	Joseph Watson	
	35727	R	ER	solid	?	angled? 3	4	Y?	4	solid	N	Ron Henderson	
	35831	R	ER	none	2	horiz	4	N	4,alum	solid	N	Paul Kinney	
	35997		ER	solid	2	horiz	4	N	2,iron	solid	N	David Ruggles	
	36037	R	ER	solid	2	horiz	4	N	4,alum	solid	N	Grant Erwin	
	36062	ER	ER	solid	2	horiz	6	N	4,iron	solid	N	Steve Harmony	
	36320	R	ER	solid	2	horiz	4	N	4,alum	solid	N	Ron Jones	
	36715	R	ER	?	?	?	?	?		solid	?	Ed Chalfant	
	37012	R	ER	solid	2	horiz	4	N	4,alum	solid	N	Russ DeVall	
	37188	E	ER	none	2	none	6	N	4,iron	solid	N	Ed Gloeggler_	
	37319	R	ER	solid	2	horiz	4	N	2,alum	solid	N	Dave Hart	
	37358	R	ER	slots	2	horiz		N	4,alum	solid	Y	Micheal M Muckey	
	37606	ER	ER	solid	2	horiz	4	N	4,iron	solid	N	John C. Jones	
	37690	E	ER	solid	2	horiz	4	N	2,alum	solid	Y	Jason Kuehl	
	37874	R	ER	solid	2	angled/3W	4	N	4,iron	solid	N	Ryan Scoggins	
	38248	R	ER	na	2	horiz	4	N	4,alum	solid	N	Gene Bradley	
	38335	ER	ER	solid	2	horiz	6	N	4,iron	solid	Y	Philip Dion	
	38510	R	ER	solid	2	horiz	4	N	4,alum	solid	N	Fred Schwartz	
	38648	E	ER	none	2	horiz	6	N	2,iron	solid	Y	Rich H	
	38781	E	ER	none	2	horiz	6	N	2,iron	solid	Y	David Powell	
	38799	R	ER	solid	2	horiz	4	N	4,alum	solid	N	Joey Prather	
	39158	R	ER	solid	2	horiz	4	N	4,iron	solid	N	Clint Casebier	
	39221	R	ER	none	2	horiz	none	N	4,alum	solid	N	Richard Schenck	
	39365	R	ER	solid	2	horiz	4	N	4,alum	solid	Y	Cheryl Heinrichs	
	39374		ER	solid	?	horiz	?	N	2,iron	solid	N	Paul Huebner	
	39500	E	ER	solid	2	horiz	4	N	2,iron	solid	Y	Richard Titus	
	39587	R	ER	none	2	horiz	?	N	2,alum	solid	Y	Jerry Johnson	
	39668	R	ER	solid	2	horiz	4	N	4,alum	solid	N	Tom Hoke	
	39939	R	ER	none	2	horiz	4	Y?	4	solid	N	Jim Craig	
	39946	ER	ER	solid	2	horiz	6	N	2,iron	solid	Y	Mark Mendelson	
	39984	E	ER	solid	?	horiz	6	N	2,iron	solid	N	John Jameson	
1951*	40340		ER	none	?	horiz	6	N	2	solid	?	Bill Taggart	
	40443		ER	solid	2	horiz	4	N	4	solid	N	Tom Todd	
	41076	R	ER	solid	2	horiz	4	N	4,alum	solid	N	Will Schnabel	
	41507	R	ER	solid	2	horiz	4	N	4,alum	solid	N	Sam Wright	
	41508	E	ER	solid	1	angled 3	6	N	2,iron	solid	Y	Hennon Gilbert, Jr.	
	41570	ER	ER	solid	1	angled/P 3	6	N	2,iron	solid	Y	Evan Davies	
	42034	E	ER	none	1	angled 3	6	N	2,iron	solid	Y		
	42034	E	ER	?	1	angled/P 3	6	Y	2,iron	solid	N	Tom O'Connor	
	42304	R	ER	solid	2	horiz	4	N	2,alum	solid	N	Joel Abler	
	42380	R	ER	solid	2	horiz	4	N	4	solid	N	Gary Reber	
	42661	E	ER	solid	?	angled 3	6	N	2,iron	solid	Y	Rob Diggs	
	42867	R	ER	solid	2	horiz	4	N	2	solid	N	Steve Angermayer	
	42977	E	ER	solid	1	horiz	6	N	?	hollow	?	Robert Cook	
	43132	R	ER	solid	2	horiz	4	N	4,alum	solid	N	Chuck Knox	
	43144	ER	ER	na	1	horiz	na	N	na	solid	Y	Clem Ashley	
1951	43209	R	ER	solid	2	horiz	4	N	4,iron	solid	Y	Everett L. Davis	
	43272		ER	solid	2	angled 3	6	N	2,iron	solid	Y	David Billman	
	43430	R	ER	na	2	horiz	4	N	4,alum	solid	N	Jim Hudson	
	43509	R	ER	solid	2	horiz	4	N	4,alum	solid	N	George Winters	
	43723		ER	solid		angled/3P	6	N	2,iron	solid	Y	Glenn Campbell	
	43783		ER	solid	2	horiz	4	N	2,iron	solid	Y	John Pyle	
	43925	R	ER	solid	2	horiz	4	N	4		N	MKC	
	44181		ER	solid	2	horiz	4	N	2,iron	hollow	N	Thomas Boore	
	44501		ER									Scott	
	44533	R	ER	solid	2	horiz	4	N	4,alum	solid	N	Bob Wasilewski	
	44637		ER	solid	1?	angled? 3	6?	N	2,iron	solid	Y	Chris Ryan	
	45109	R	ER	solid	2	horiz	4	N	4,alum	solid	N	Larry Foster	
	45209	R	ER	solid		angled/3W	6	N	4,iron	solid	N	David J. Oberholzer	
	45374		ER	solid	1?	angled 3	6?	N	2,iron	solid	Y	Carol Thacker	
	45396		ER	solid	1?	horiz	6	N	2,iron	solid	Y	Alan Galbraith	
	45543		ER	?	2	angled 3	6	N	2,iron	solid	N	Harry Beadles	
	45635	R	ER	none	2	horiz	4	N	4,alum	solid	N	John Gomes	
	45699		ER	na	1	angled 3	4	N	2,iron	solid	Y	Dave Julian	
	45705		ER	solid	1?	angled 3	6	N	2		N	John Nixon	
	45748		ER	na	1	angled 3	na	N	4,alum	solid	Y	Dan Boschen	
	46054	R	ER	solid	2	horiz	none	N	4,alum	solid	Y	Mark Seidel	

Date	Serial #	Prefix	E/ER	Sawgrd	Wedges	Fence	Brkt Slot	1/8 Ways	Headrest	Tbl Rod	Flat Base	Name	Example Photos
	46291	R	ER	solid	2	horiz	4		4,alum	solid	N	Don Bowen	
	46574	E	ER	solid	1	angled 3	6	N	2,iron	solid	Y	Jim Kiely Sr.	
	46992	ER	ER	slots	2		4	N	2	solid	Y	Frank Yafchak	
	47176	R	ER	na	2	horiz	4	N	4,alum	solid	N	David Abshire	
	47286		ER	solid	1?	angled 3	6	N	2		Y	MKC	
	47308	R	ER	solid	2	horiz	4	N	4,iron	solid	Y	John Lundberg	
	47360		ER	solid	1	angled 3	4	N	2,iron	solid	N	John Schwinn	
	47407		ER	solid	1	angled 3	6	N	2,iron	solid	N	Dennis Muehring	
	48040		ER	solid	2	horiz	4	N	4,alum		N	Dave Freehill	
	48499	E	ER	solid	2?	angled/3P	6	N	2,iron	hollow	Y	Kurt Kimberling	
	48843	R	ER	solid	2	horiz	4	N	2		Y	MKC	
	49652		ER	none	?1	angled/3P	6	N	2,iron	solid	N	Lee R. Harper	
	50064		ER									Scott Grunewald	
	50615	R	ER	solid	2	horiz	6	N	2,iron	solid	N	Craig (by phone)	
	50786	R	ER	none	2	horiz	4	N	2,iron	solid		Del Ackley	
1952	51041	R	ER	solid	2	angled/3W	4	N	2,iron	solid	Y	Everett L. Davis	
	51086	E	ER	none	1	angled 3	6	N	2,iron	solid	Y	Keith Galbraith	
	51096	R	ER	solid	?	horiz	4	N	2,alum		Y	MKC	
	51354	R	ER	solid	2	horiz	?	N	2,iron	solid	N	Bill Cleary	
	51485	E	ER	solid	2	angled/3P	4	N	2,iron	solid	Y	Alvin Dyck	
	51512	E	ER	Nn	1	angled 3	6	N	2,alumj	solid	Y	John Phillips	
	51587	E	ER	na	1	angled 3	6	N	2,iron	solid	Y	Phil Scott	
	51897	R	ER	none	2	horiz	4	N	2,iron	solid	Y	David Hart	
	51951	E	ER	solid		angled/3P	6	N	2,iron	solid	Y	Jeff Johnson	
	51996	R	ER	solid	2	angled 3	6	N	2,iron	solid	Y	Mike Bott	
	52355	R	ER	solid	2	angled 3	none	N	2,iron	solid	Y		
	52356	E	ER	solid	1	angled 3	6	N	2		Y	George K. DeHaven	
	52716	E	ER	na	1	angled 3	6	N	2,iron	solid	Y	Dennis Harvey	
	52721	E	ER	solid	1	angled 3	6	N	2,iron	solid	N	Mark Odonnel	
	52903	E	ER	solid	1	angled/3W	6	N	2,iron	solid	Y	Ben Burns	
	52905	R	ER	solid	2	horiz	6	N	2,iron	solid	Y	Gary Parker	
	52927	R	ER	none	2	horiz	none	N	4,alum	solid	Y	Scott M Grade	
	53006	R	ER	solid	2	horiz	6	N	2,iron	hollow	Y	Jerry Brown	
	53183	R	ER	solid	2	horiz	6	N	2,iron	solid	N	Joseph Ujfalusi	
	53449	E	ER	solid								Al Humphries	
	53593	E	ER	solid	1	angled 3	6	Y	2,iron	solid	Y	Mark Herman	
	53696	R	ER	na	1	na	na	na	na	solid	Y	John Sawicky	
	53720	R	ER	na	1	angled 3	6	N	2,iron	solid	Y	John Sawicky	
	53862	E	ER				6			solid		James Dakin	
	54557	R	ER	solid	1	angled 3	6	N	2,iron	solid	Y	Tom Lightner	
	54680	E	ER	solid	1	angled/3P	6	N	2,iron	solid	Y	Jim McGowan	
	54732	R	ER	solid	2	angled 3	6	N	2,iron	solid	N	Mike Bumbaca	
	54733	E	ER	solid	1	angled 3	6	N	2,alum	solid	Y	miles parsons	
	54764	R	ER	na	1	angled 3	6	N	2,alum	solid	Y	Jim Kellar	
	54784	E	ER	none	1	angled/3P	6	N	2,iron	solid	Y	Jim Parker	
	54933	E	ER	na	1	angled 3	6	N	2,iron	solid	Y	Rich Koch	
	55394	R	ER	solid	1	horiz	6	N	2,		N	Bob Wetmore	
	55401	R	ER	solid	1	angled/3P	6	N	2,iron	solid	Y	Greg Bowes	
	55827	R	ER	solid	1	angled 3	6	N	2,iron	solid	N	Richard Arnold	
	56007	R	ER	na	1	angled 3	6	N	2,iron	hollow	Y	Jeff Turnbaugh	
	56148	R	ER	solid	1	angled 3	6	N	2,iron	solid	N	Lyndell W Thompson	
	56471	E	ER	slots	1	angled 3	6	N	2,iron	solid	Y	Herbert Hedstrom	
	56492	E	ER	solid	1	angled/? 3	6	N	2,iron	solid	Y	Paul Knight	
	56750	R	ER	solid	1	angled 3	6	N	2		Y	MKC	
	56781	E	ER	na	2	na	na	Y	4,alum	solid	N	Richard Lutz	
	56843	E	ER	na	1	na	na	N	2,iron	solid	Y	Jack Bonham	
	57009	E	ER	solid	1	angled 3	4	N	2,iron	solid	Y	David Henderson	
	57594	E	ER	solid	2	angled 3	6	N	2,iron	solid	N	Don Schuster	
	57706	R	ER	solid	1	angled 3	4	N	2,iron	solid	Y	Tom Pajak	
	57782	E	ER	solid	1	angled/3W	6	N	2,iron	solid	Y	Don Edgar	
	57788	E	ER	solid	2	angled/3P	6	N	2,iron	solid	Y	Michael Moore	
	57799	R	ER	solid	1	na	6	N	2,iron	solid	N	James Rice	
	57949	E	ER	solid	1	angled 3	6	N	2,iron	solid	Y	John McMichael	
	58100	E	ER	none	2	horiz	?	N	2,iron	solid	Y	Chuck Patterson	
	58169	E	ER	solid	1	angled/3P	6	N	2,iron	hollow	Y	Larry Stilwell	
	58216	E	ER	solid	1	angled/3P	4	N	2,iron	solid	Y	Jeff simpson	
	58535	E	ER		1	angled 3	6	N		solid	Y	Mark Mirski	

Date	Serial #	Prefix	E/ER	Sawgrd	Wedges	Fence	Brkt Slot	1/8 Ways	Headrest	Tbl Rod	Flat Base	Name	Example Photos
	58670	R	ER	solid	1	angled 3	6 N		2,iron	solid	Y	Fran Lynch	
	58867	E	ER	solid	1	angled 3	6 N		2,iron	solid	N	markodonnell9@aol.com	
	58909	R	ER	none	1	angled/3P	6 N		2,iron	solid	Y	Vincent Ancona	
	59061		ER	solid	1	angled 3P	6 N		2,iron	solid	N	Patrick Daugherty	
	59153	E	ER	na	1	na	6 N		4EJ	solid	Y	Rich Koch	
	59580	R	ER	solid	1	angled 3	6 N		2,alum	solid	Y	Richard King	
	60014	R	ER	solid	1	angled/3P	6 N		2,iron	solid	Y	Mike Hajovsky	
	60040	R	ER	none	?	angled 3	6 N		2,iron	solid	Y	Ira Shapiro	
	60295	R	ER	solid	1	angled 3	6 N		2,iron	solid	Y	Gary Parker	
	60650	R	ER	na	1	angled 3	6 N		2,iron	solid	Y	George Davis	
	60783		ER	slots?	1	angled 3	6 N		2,iron	solid	Y	Dale Sisson	
	60825	R	ER	slots	1	angled/3P	6 N		2,iron	solid	N	Larry Hart	
	61069	R	ER	none	1	angled/3P	6 N		2,iron	solid	N	Robert Hibbard	
	61259	R	ER	solid	?	angled 3	?	?	?	?	?	Mike Theisen	
	61470	R	ER	none	2	angled 3	6 N		2	solid	Y	ebay	
Dec1952*	61705	R	ER	solid	1	angled 3	na	N	2,iron	solid	Y	Robert Challman	
	64334	R	ER	na	1	angled 3	6 N		2,iron	solid	Y	Rick Berndt	
	64689	R	ER	solid	2	angled 3	6 N		2,iron	solid	Y	Frank	
	64728	R	ER	solid	1	angled 3	6 N		2,iron	solid	Y	Terry Carl	
	65057	R	ER	solid	1	angled/3W	6 N		2,iron	solid	Y	Bill Hayes	
	65142	R	ER	solid	1	angled 3	6 N		2,iron	solid	Y	Rich Koch	
	66311		ER	solid	1	horiz	6 N		2,iron	solid	Y	Jeffery Morris	
	66422	R	ER	solid	1	angled 3	6 N		2,iron	solid	Y	Lynn Seller	
	66552		ER	solid	1	angled/3W	4 N		2,iron	solid	Y	Tim Gossler	
	67108	R	ER	solid	1	angled 3	6 N		2,iron	solid	Y	Rich Koch	
	67344	R	ER	none	1	angled/3P	6 N		2,iron	solid	Y	Ernie M. Eden	
	67936	R	ER	none	2	angled/3P	6 N		2,iron	solid	N	Rich Hoffman	
	68346	R	ER	none	1	angled 3	6 N		Nn	solid	Y	Chris Boyer	
	68346	R	ER	none	1	?	none				Y	Chris Boyer	
	68426	R	ER	na	2	angled 3	6 N		2,iron	solid	Y	Laura Grant	
	68793	R	ER	na	1	angled 3	6 N		2,iron	solid	Y	Michael Diesso	
	69136	R	ER	solid	1	angled 3	6 N		2,iron	solid	Y	Dave Hart	
	69562		ER	solid	1	angled/3W	6		2,iron	solid	Y	Jim Stodder	
	70172	E	ER	none	2?	none	4 N		2	solid	N	Gary C Dawson	
	70362		ER	solid	1	angled/3W	6		2,iron	solid	Y	Wayne Triebold	
	70603		ER	solid	1	angled/3W	6 N		2,alum	hollow	Y	Gary Whiteman	
Aug-52	70714		ER	solid	1	angled/3W	4 N		2,iron	solid	Y	Everett L. Davis	
	70794	E	ER	solid	2?	horiz	4 N		4,iron	solid	N	Robert Kruyer	
	70915		ER	solid	1	angled/3W	6 N		2,iron	hollow	Y	Erick Lorenz	
	70968		ER	none	1	angled 3	6 N		2,iron	hollow	Y	Bob Reeder	
	71169		ER	none		angled/3W	4?	Y	2,iron	hollow	Y	Vally D'Souza	
	71315		ER	solid	1	angled 3	6 N		2,iron	hollow	Y	George Jew	
	72360		ER	none	2?	angled 3	none	N	2,iron	hollow	Y	ebay part out	
Sep1952*	72628		ER									Mike (toolie)	
	73152		ER	none	1	angled 3	6 N		2,iron	?	Y	Jim Magill	
	73257		ER	na	1	angled 3	6 N		2,alum	hollow	Y	Rod Sauvageau	
	74383		ER	na	1	angled/3W	6 N		2,	hollow	Y	Joe Fisher	
	74598		ER	na	1	angled/3W	6 N		2,iron	hollow	Y	Donald E. Campbell	
	75088		ER	solid	2	angled/3W	6 N		2,iron	solid	Y	Gary Pound	
	75348		ER	solid	1	angled/3W	6 N		2,iron	hollow	Y	Sandy Thompson	
	76236	R	ER	solid	2	angled 3	6 N		2,iron	?	Y	Ed Chalfant	
	77341		ER	solid		angled/3W	6 N		2,alum	hollow	Y	Ralph Cobb	
	77929		ER	solid	1	angled 3	6 N		2,iron	hollow	Y	Kevin Cox	
	78370		ER	solid	1	angled/3W	6 N		2,iron	hollow	Y	Dave Griffith	
	78373		ER	solid	2?	angled 3	6 Y		2,iron	?	Y	Bill Jones	
	78519		ER	solid	1	angled 3	6 ?		2,iron	hollow	Y	Brian DeRoshia	
	78815		ER	slots?	1	angled 3	6 N		2,alum	hollow	Y	John Bovard	
	78818		ER	solid	1	angled 3	4 N		2,iron	hollow	Y	Fred Sutton	
	79577		ER	solid	1	angled/3W	6 Y		2,iron	hollow	Y	Tony Allinson	
	80515		ER	solid	1	angled/3W	6 N		2,iron	hollow	Y	Clark Emerson	
	80622		ER	solid	1	?	6 N		2,iron	hollow	Y	Chris Boyer	
	80752		ER	none	1	angled/3W	6 N		2,iron	hollow	Y	Chris Christensen	
	81134		ER	solid	2	angled/3W	6 N		2,iron	hollow	Y	Rick Berndt	
	82569		ER	solid	1	angled 3	6 Y		2,iron	hollow	N	Dean McAlister	
	82627		ER	none		horiz	6 Y		2,alum	hollow	Y	Gary C Dawson	
	82971		ER	solid	1	angled 3	6 Y		2,iron	hollow	Y	Robert Scavilla	
	83058		ER	solid	1	angled 3	6 Y		2,iron	hollow	N	Paul Self-Price	

Date	Serial #	Prefix	E/ER	Sawgrd	Wedges	Fence	Brkt Slot	1/8 Ways	Headrest	Tbl Rod	Flat Base	Name	Example Photos
	83237		ER	none	?	angled 3	6 N		2,iron	hollow	N?	Drew Morton_	
	83369		ER	solid	1	angled 3	6 Y		2	?	Y	Terry Ney	
	83390		ER									Neil Vincent	
	83509		ER	slots?	1	angled 3	6 Y		2,alumj	hollow	Y	Walter Mathews	
	83676		ER	none	1	angled 3W	6 Y		?	?	Y	MKC	
	83974		ER	solid	1	angled/3W	6 Y		2,iron	hollow	Y	John S. Burger	
	84014		ER	solid	1	angled 3	6 Y		2,iron	solid	N	Roy Hennagir	
	84542		ER	na	1	na	6 N		2,iron	hollow	Y	John Shield	
	84547		ER	solid	1	angled/3W	6 N		2,iron	hollow	Y	Eric Prince	
	85076		ER	solid	2	angled/3W	na	N	2,iron	hollow	Y	Chuck Badeaux	
	85097	E	ER	none	2?	horiz	6 N		4,iron	solid	N	Ed Gloeggler_	
	85163		ER	solid	1	angled 3	6 N		2,iron	hollow	N	Morris Sweet	
	85725		ER	solid	2	angled/3W	6 N		2,iron	hollow	Y	Royce Taylor	
	86197		ER	none	1	angled 3	6 N		2,iron	hollow	Y	Scott Allread	
	86574		ER	solid	1	angled 3	6 N		2,iron	?	Y	Michael Goldberg	
	86600		ER	solid	1	none	6 N		2,alum	hollow	Y	Robert Miller	
	87130	E	ER	solid	1	angled/3W	none	Y	2,iron	hollow	Y	David Rickey	
	87130		ER	solid	1	angled 3	6 ?		2,iron		Y	EBAY	
	87694		ER	na	1	angled/3W	6 Y		2,iron	hollow	Y	Daniel Edwards	
	88857		ER	solid	1	angled 3	6 Y		2,iron	hollow	N	Loyd Harrison	
	88933		ER	solid	1	angled 3	6 Y		2,iron	hollow	N	Paul Chafin	
	89805		ER	solid	1	angled/3W	6 Y		2,iron	hollow	Y	Mitchell Maged	
	89891		ER	solid	1	angled/3W	6 Y		2,iron	hollow	Y	LeeRoy Hegwood	
	90591		ER	none	1	angled 3	6 Y		2,iron	hollow	Y	Grant Erwin	
	90979	E	ER	none	?	horiz	6 Y		4,alum	hollow	N	Bob Jones	
	91134		ER	none	1	angled 3	6 Y		2,iron	hollow	Y	Anthony Lembi	
	91164		ER	none	1	angled/3P	6 N		2,iron	hollow	Y	Jerry Coker	
	91176		ER	none	1	angled/3W	6 Y		2,iron	hollow	Y	Michael (Mike) P. Pizzola	
	91966		ER	solid	?	horiz	6 Y		2,iron	hollow	N?	Frank Bruce	
	92120		ER	na	1	angled 3	6 Y		2,iron	hollow	Y	Gary Bashian	
	92168		ER	na	1	angled 3	6 Y		2,iron	hollow	Y	Keith Galbraith	
	92939		ER	solid	1	angled/3W	4?	Y		hollow	Y	John Margeotes	
	93107		ER	na	1	angled/3W	6 Y		2,iron	hollow	Y	George Whited	
	94214		ER	na	1	angled 3	6 Y		2,iron	hollow	N	Joe Yablonski	
	94499		ER	na		angled 3	6 Y		2,iron	hollow	Y	Gary Clark	
	94852		ER	solid	2?	angled/3W	6 Y		2,iron	solid	Y	John Tomasaitis	
	94911		ER	solid	1	angled 3	6 Y		2,iron	hollow	N?	Tom Segelhorst	
	95214		ER	solid	1	angled 3	6 Y		2,iron	hollow	Y	Joseph DiPietro	
1953	95470		ER	solid	1	angled/3W	6 Y		2,iron	hollow	Y	Everett L. Davis	
	95479		ER	solid	1	angled/3W	6 Y		2,iron	hollow	Y	John Roos	
	96562		ER	solid	1	angled 3	6 N?		2,iron	hollow	Y	Bill Hayes	
	97182		ER	solid	1	angled/3W	6 N		2,iron	hollow	Y	Jack Boyd	
	97393		ER	solid	1	angled/3W	6 Y		2,a	solid	Y	Richard Lutz	
	97799		ER	solid	1	angled/3W	6 Y		2,alum	hollow	Y	Scott	
	97873		ER	solid	1	angled 3	6 N?		2,alum	hollow	Y	Brent Schwartz	
	97915		ER	slots	1	angled/3W	6 N		2,alum	hollow	Y	Paul Naylor	
	98460		ER	solid	1	angled 3	6 Y		2,alumj	hollow	Y	Les Edmundson	
	98890	E	ER	na	1	angled/3W	6 Y		2,alum	hollow	Y	Warren McCrary	
	98989		ER	solid	1	angled 3	6 Y		2,alum	hollow	Y	Bruce Cunha	
	99001		ER	slots	1	?	6 N		2,iron	solid	Y	Chris Boyer	
	99125		ER						2,a	solid	Y	Barry Varga	
	99840		ER	solid	1	angled 3	6 Y		2,alum	hollow	Y	Ed Friedl	
	99958		ER	na	1	angled/3W	6 N		2,alum	hollow	Y	Gary Whiteman	
	100179		ER	solid		angled/3W	6 Y		2,alum	hollow	Y	Ed Fickel	
	100811		ER	solid	1	angled 3	6 Y		2,alum	hollow	Y	Labeaux Schiek	
	101358		ER	solid	2	angled/3W	6 Y		2,alum	hollow	Y	Ed Fickel	
	101546		ER	solid	1	angled 3	none	Y	2,iron	hollow	Y		
	101655		ER	solid	1	na	6 Y		2,alum	hollow	Y	Rich Koch	
	101733		ER	solid	1	angled/3W	6 Y		2,alum	hollow	Y	John Kilmartin	
	102213		ER	na	1	angled/3W	6 Y		2,alum	hollow	Y	MKC	
	102429		ER	solid	1	angled/3W	6 Y		2,alum	hollow	Y	David Zamora	