

DOWINX GAMING CHAIR USER GUIDE

Dowinx Ergonomic Gaming Chair

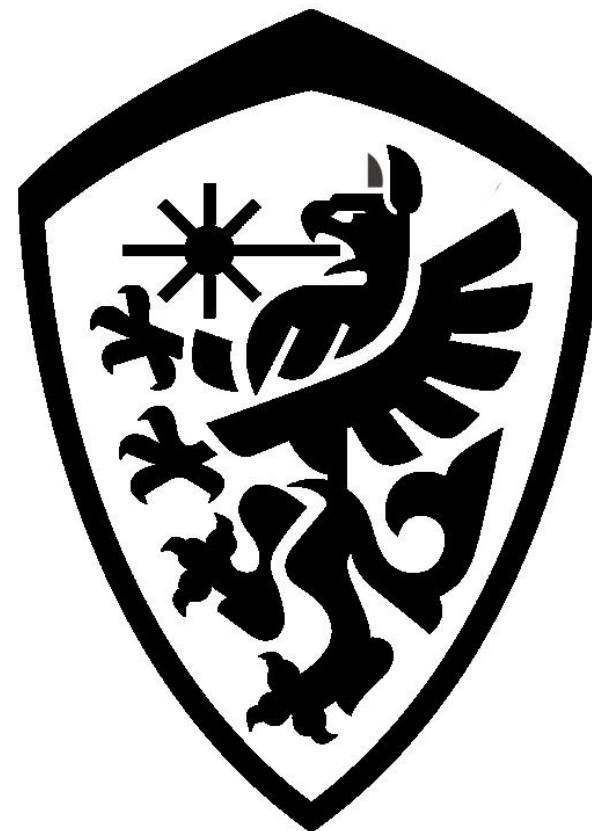

DOWINX

The logo for DOWINX features the word "DOWINX" in a bold, italicized, black sans-serif font. A white diagonal line runs through the letters from the bottom-left to the top-right. A small red diamond is positioned above the letter 'i'.

DOWINX

WWW.DOWINX.COM

CONTENTS

DOWINX LS-6689 Gaming Chair

●	Brand Story	01
●	Introduction	02
	Component	03
	Instruction	05
●	Main Features of The Product	11



Dowinx was founded in 2013, and has been specializing in design and producing gaming chair for more than 7 years. We have designed a variety of professional gaming chair with the ergonomic function, which is suitable for long-time working or playing.

The company focusing at creating the best gaming chair with professional product lines and skilled technicians. With the purpose of leading healthy working environment, Dowinx keeps crafting better products to improve people's sitting quality. Meanwhile we have set up warehouses overseas and service agencies in USA, UK and AUS to provide better customer service.

"FOR YOUR SATIFICATION, DO MY BEST" is our key word. We expect that bring you a great purchasing experience.

DOWINX LS-6689S CHARI



Dowinx gaming chair made of faux-leather which is more durable and environmental friendly. With the ergonomic design, high elasticity sponge stuffed pillow and seat cushion, the chair provides a comfortable experience when when you need to sit on it for hours.

The chair has easy adjustment on every single parts, chair back can recline to 180 degree, and the armrests can be adjusted by its angle and height, the seat height also can be easily adjusted by the high quality gas cylinder. Additionally, the head pillow and lumbar support help relaxing when lie on the chair.

To ensure customer experience, 24/7 customer service will be provided by Dowinx@vip.126.com

Please make sure the package contains the following items.

※ Actual product may vary from image.

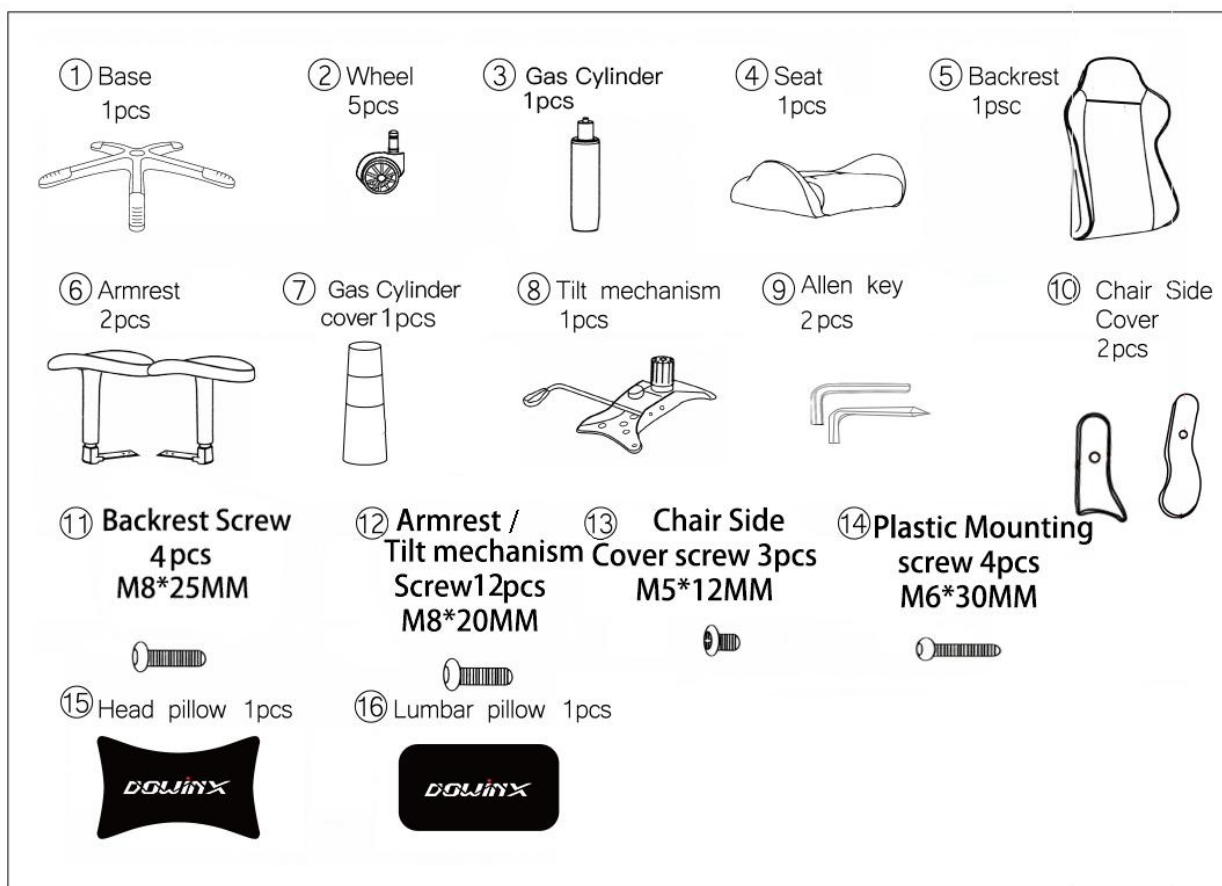
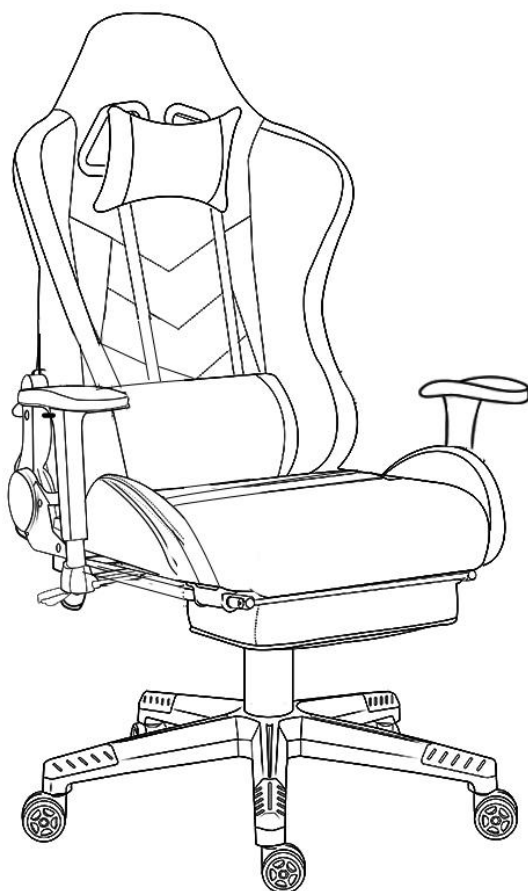

*⑪⑫⑭ has been pre-installed, please check the bottom of the chair

Footrest Components

※ Please make sure the footrest package contains the following items.

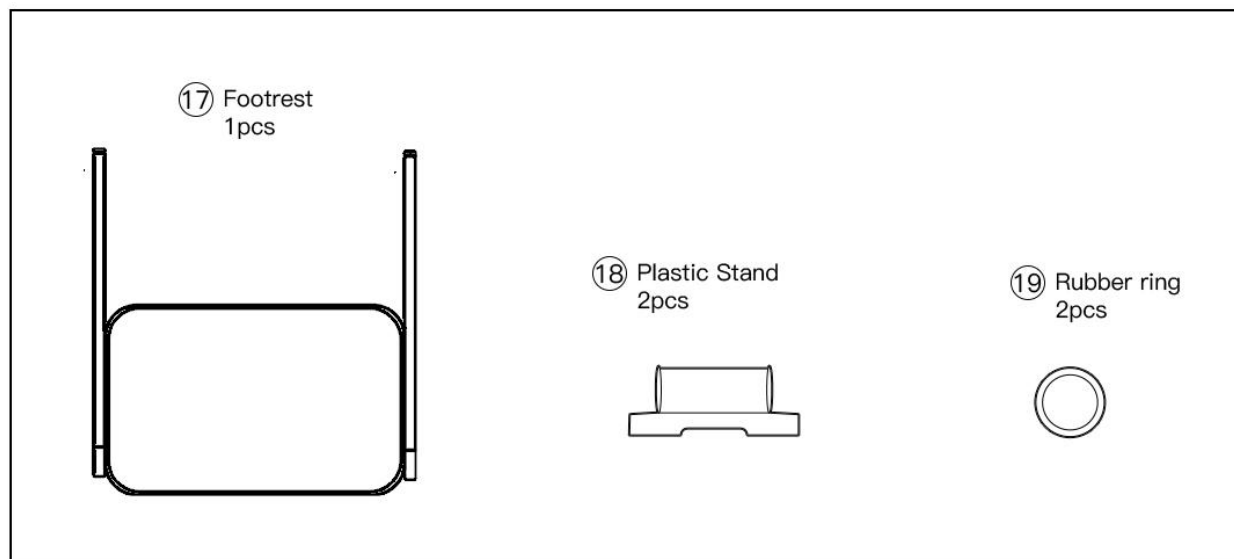
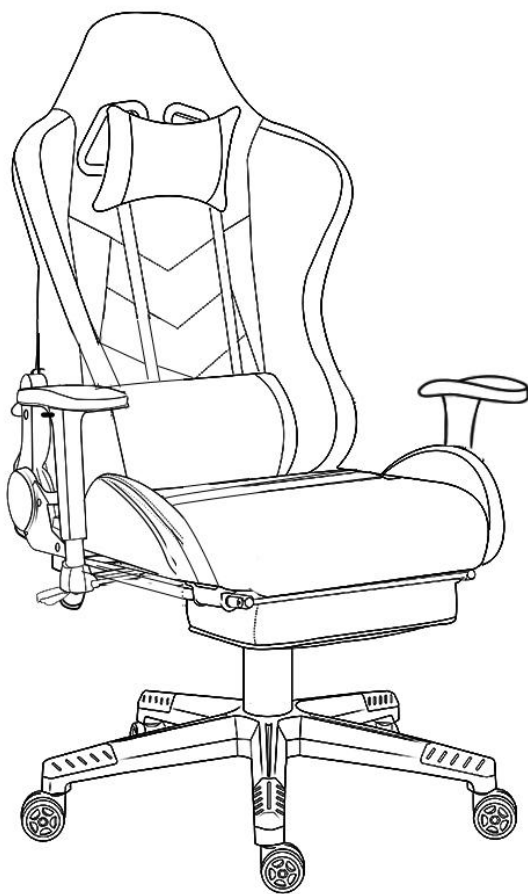

Please Notice:

1. Do not stand on the chair as a step stool or ladder.
2. Do not use the chair unless all screws and parts are tight.
3. Be careful, some of the parts are heavy and sharp.

01 Wheel, Base and Gas Lift Installation

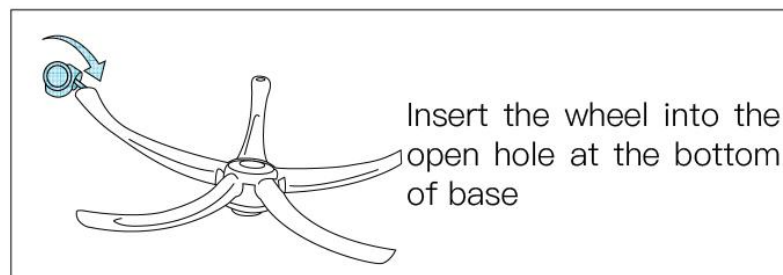
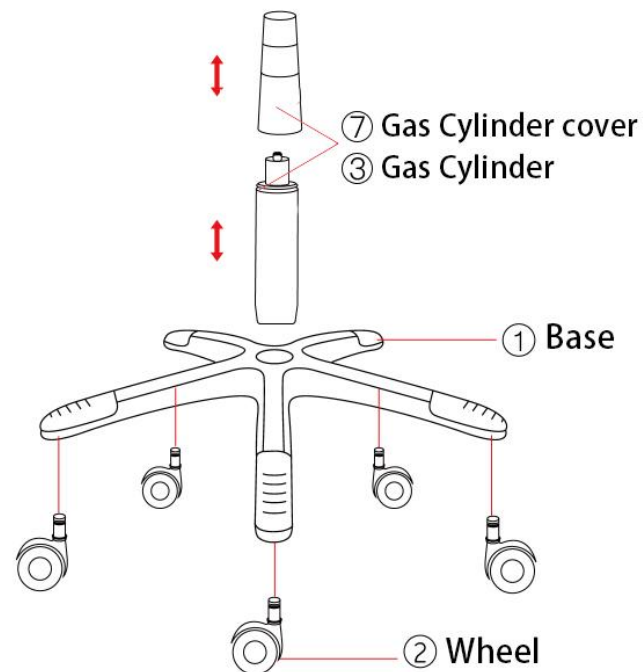

02

Connecting armrest to
the seat

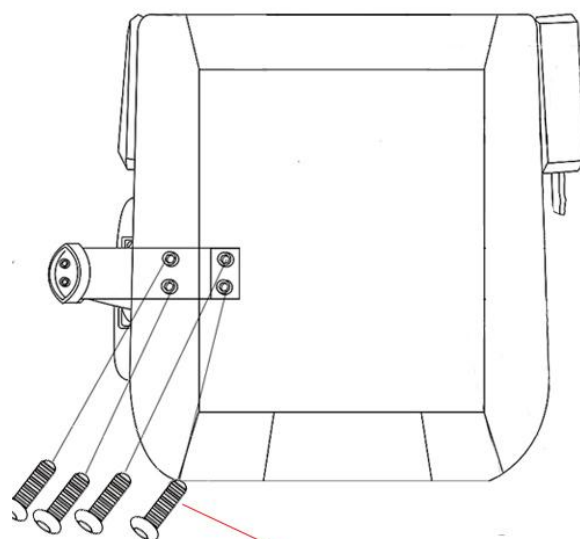
Behind**Front**

* Screws have been assembled on
the seat bottom, please loosen them
for further assembly.*

03

Connecting armrest to
the seat

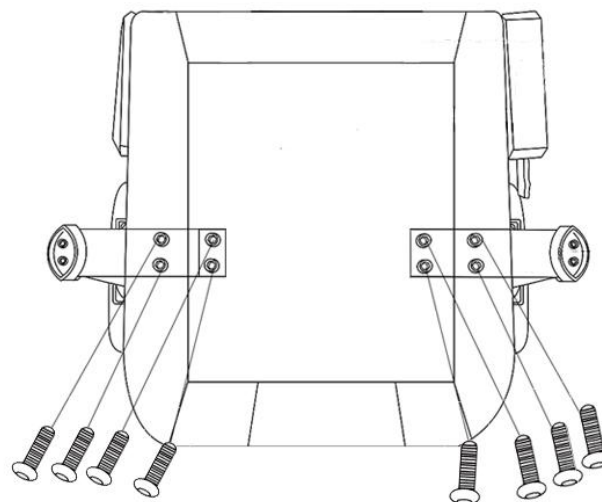

04

Connecting tilt mechanism
to the seat

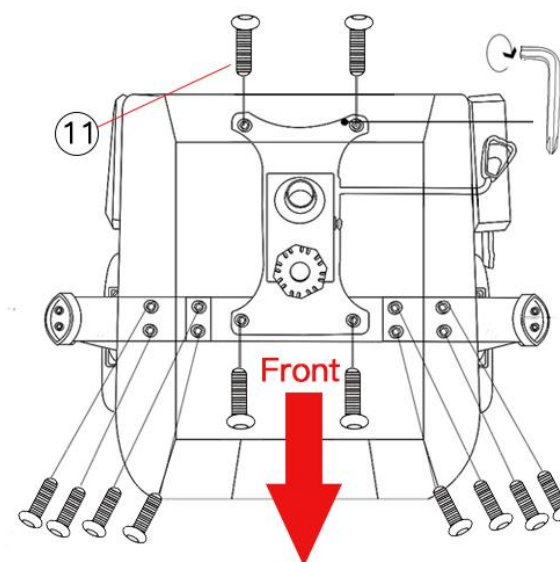

* Tilt mechanism assembly sequence
Please pay attention to the direction *

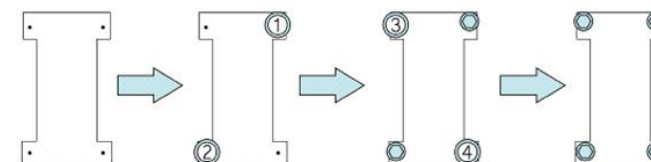

07

05

Connecting footrest with stands to the seat bottom

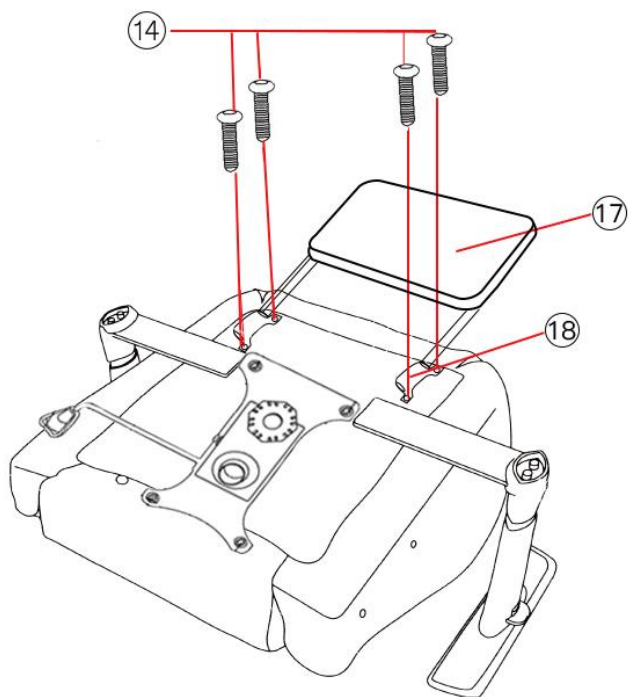

* ⑭ Screws have been assembled on the seat, please loosen them for further assembly.*

06

Putting the rubber rings to the footrest

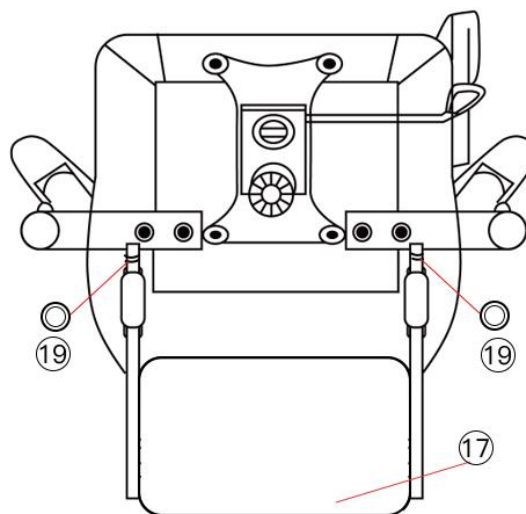

Be careful with the direction of the footrest.

07

Connecting the backrest to the seat Assemble the left side(recliner mechanism)-first

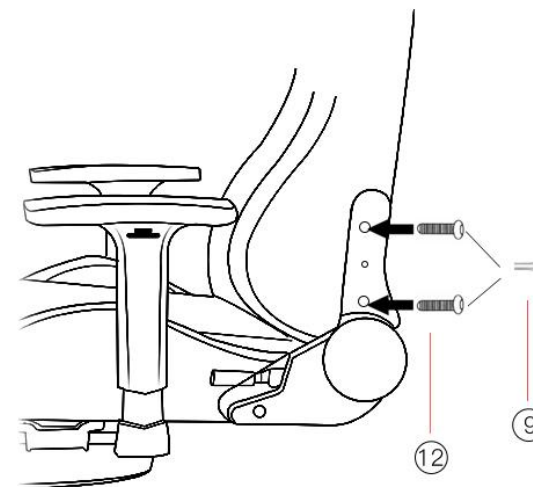

08

Assemble the plastic cover

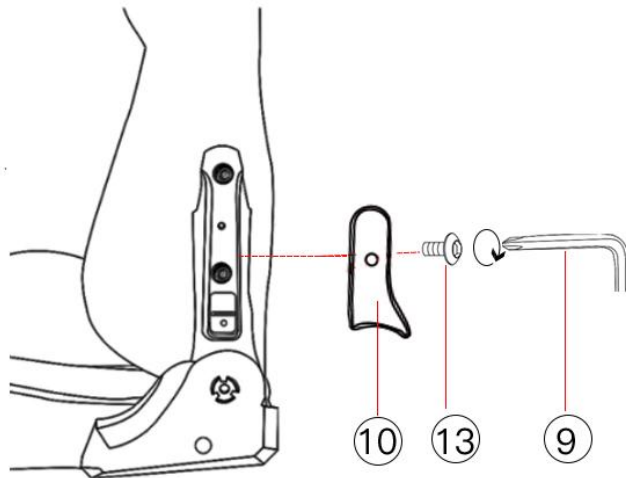
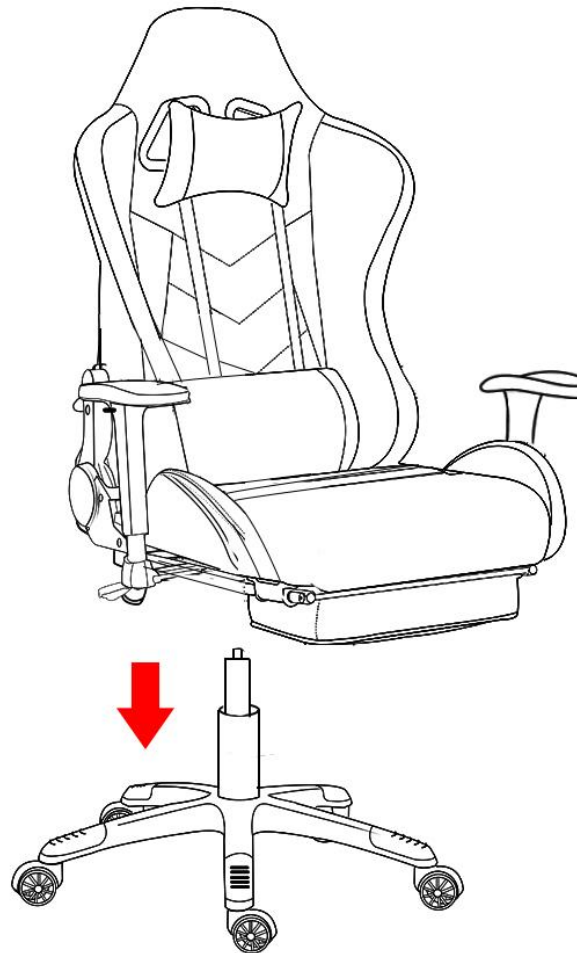
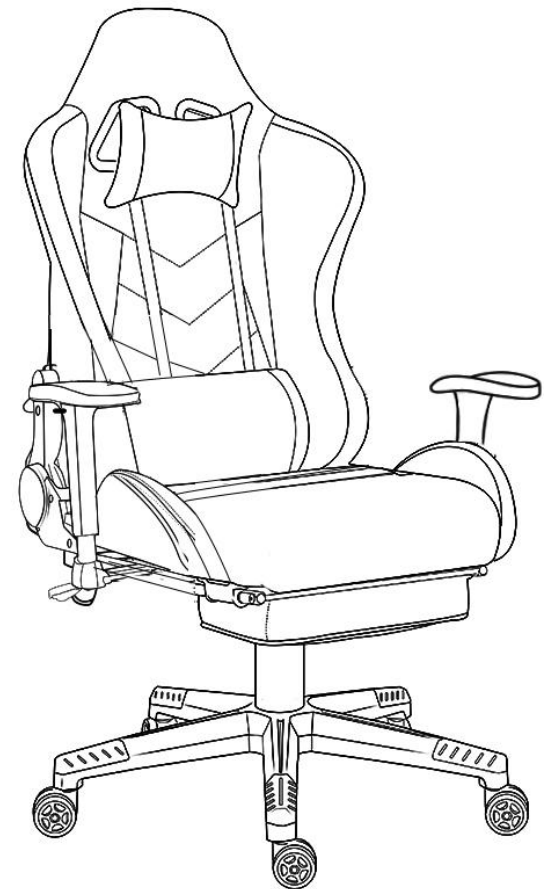
**09**Connecting the upper body and—
push it down connected with gas**10**Assembly of chair with footrest is
complete

Cautions

Right hand

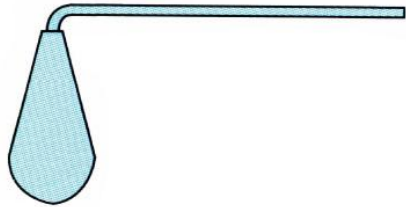

Height handle

Left hand

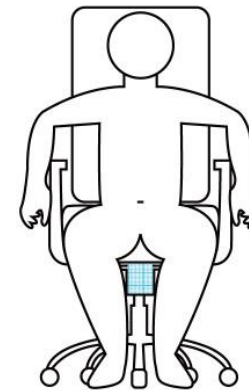

No handle

Tilt Mechanism knob should be located under the front of the seat

Cautions

Rocking

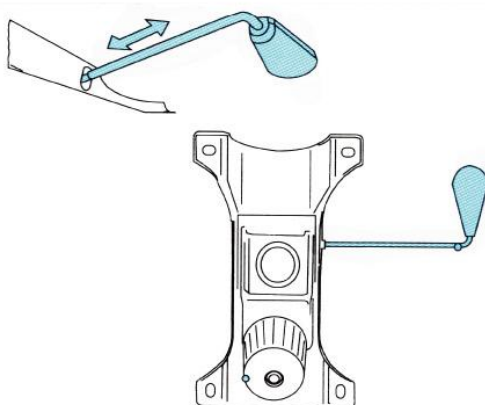

Put out/push in the lever to
enable/disable rocking function
Twist the knob to adjust tension of tilting

Recline and Lock

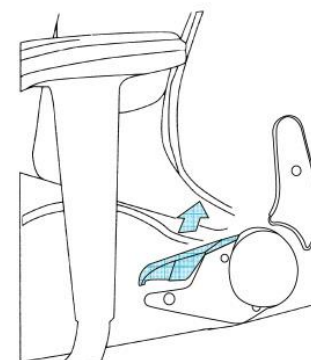

When tilting down the backrest to 180 degrees (if vigorously laying down) , you may hear noises of clicking. It's from the gear rotating, not a defect of the product.

You can control the tilt angle by adjust the handle. Pulling up the handle and find the angle position you want, release the handle to lock the tilt.

Main Features of the Product

01

Adjustable lumbar pillow height



02

Adjustable seat height

Raise your chair:

Stand up and pull height handle upwards.

Lower your chair:

Sit down on the chair to pull height handle upwards.

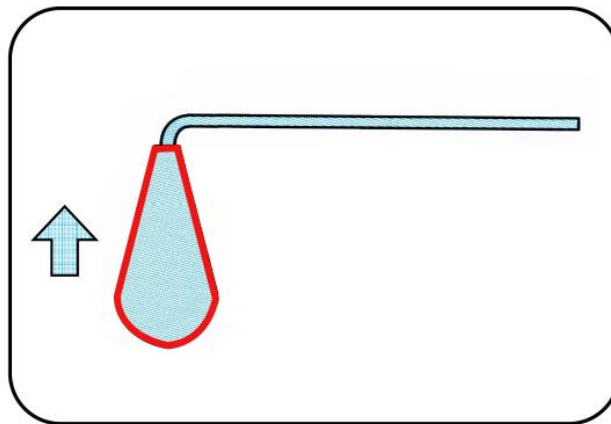

03

Adjust the backrest angle

The backrest can adjust to 180 degrees

To tilting the backrest backwards:

Pulling up the handle and find the angle position you want, release the handle to lock the tilt.

When tilting the backrest forward:

Stright your back and pu upward the lever the backrest will lean back, be careful with lean back force.

**Caution: Please be careful that leaning the back to the maximum 180 degree may cause the chair to fall backwards.*



04

Adjustable armrest

Height adjustable(adjustable up and down):

Both arms can be moved up and Up and down while pulling switch underneath the arm pad.



05

Rocking

Angle range: 0–20°

Twist on/off the lever to adjust tilt extent

Pull out the lever to enable rocking

Push in the lever to disable this function

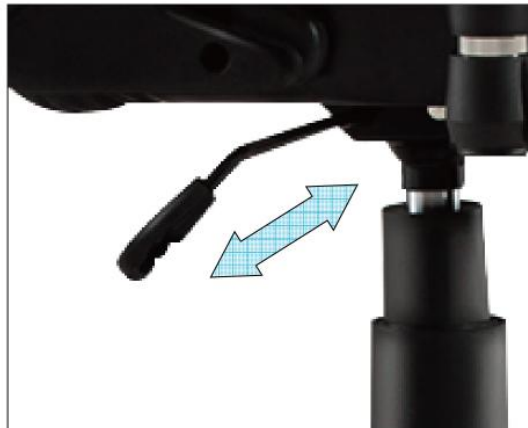

Pull out lever/Turn on rocking
Push in lever/Turn off rocking

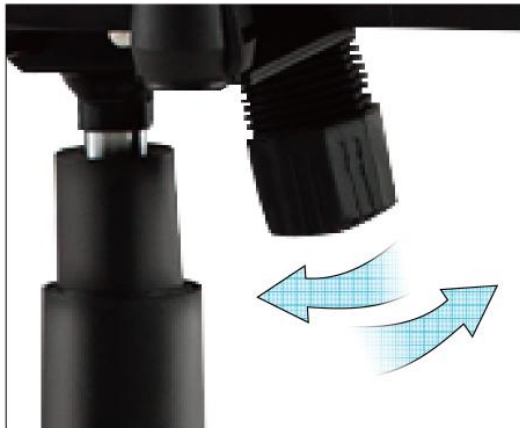

Clocking to tight rocking
Counterclockwise opposite effect





Congratulations! You have finished all steps of building up the chair.
Now you can enjoy your new multifunctional gaming chair!

Your recognition of our brand helps us to make progress better.
Looking forward to see your sharing review and pictures on our Amazon page
Any problems please feel free to contact our customer service email: Dowinx@vip.126.com

Noted

Please tight all screws every 3 months (screws loose may cause squeak and wobble)

