

AHS2 Heavy Duty H-20 Rated Aluminum Hatch

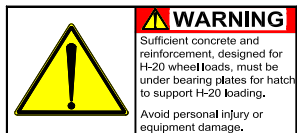
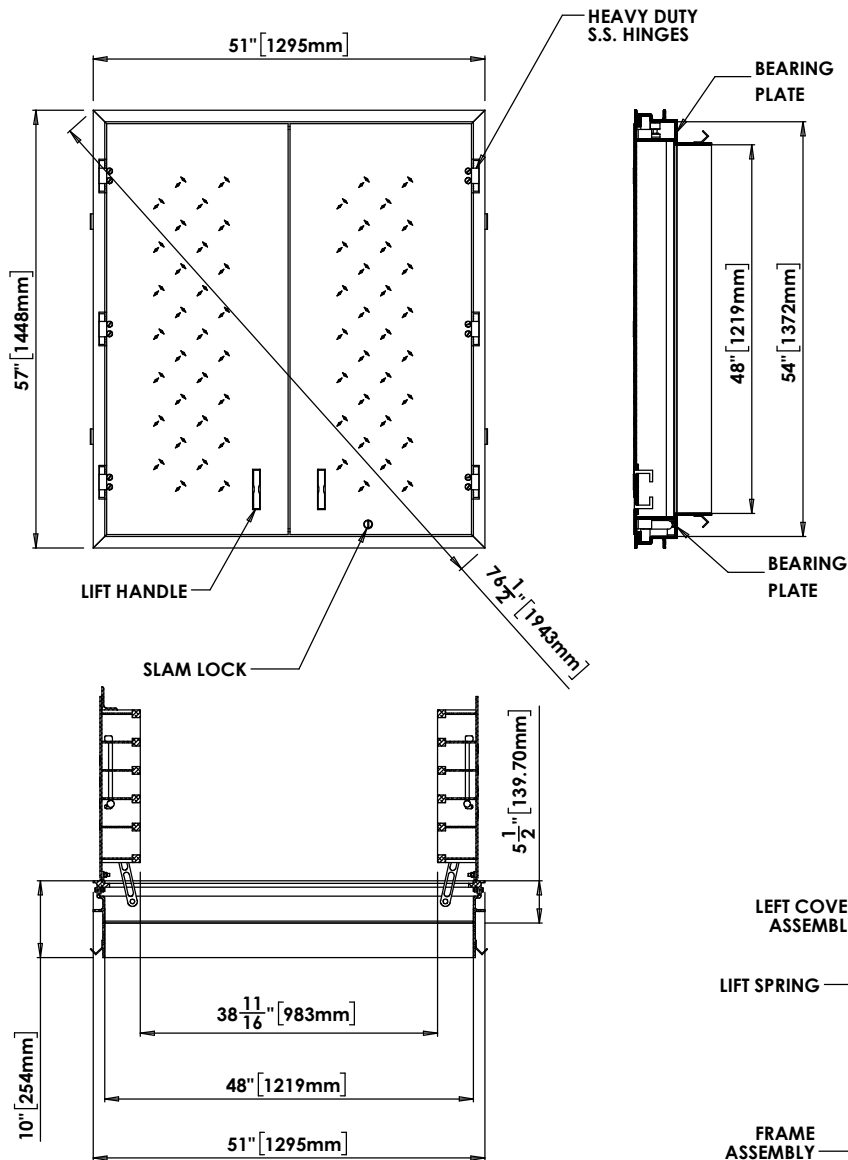

STYLE "AHS2" ACCESS HATCH, AS MANUFACTURED BY EJ.

MATERIAL SHALL BE 6061-T6 ALUMINUM FOR BARS, ANGLES, AND EXTRUSIONS. 1/4" DIAMOND PLATE SHALL BE 5086 ALUMINUM.

UNIT DESIGNED HEAVY DUTY, FOR 16,000 LBS + 30% IMPACT H-20 WHEEL LOADS, OVER A 10" X 20" CONTACT AREA. FRAME AND BEARING PLATE MUST BE CAST INTO AND SUPPORTED BY CONCRETE DESIGNED FOR H-20 WHEEL LOADS.

UNIT NOT SUITABLE FOR WHEEL LINE PLACEMENT.

ANGLE STYLE FRAME SHALL BE OF EXTRUDED ALUMINUM, WITH A CONTINUOUS 1-1/2" ANCHOR FLANGE.

UNIT SUPPLIED WITH A HEAVY DUTY STAINLESS STEEL PNEUMATIC SPRING, FOR EASE OF OPERATION WHEN OPENING COVER. COVER SHALL BE COUNTERBALANCED, SO ONE PERSON CAN EASILY OPEN THE HATCH DOOR.

EACH HATCH SHALL BE EQUIPPED WITH A STAINLESS STEEL HOLD OPEN ARM. DOOR SHALL LOCK OPEN IN THE 90 DEGREE POSITION. EACH HOLD OPEN ARM SHALL BE FASTENED TO THE FRAME WITH A 1/2" GRADE 316 STAINLESS STEEL BOLT.

HINGES SHALL BE OF HEAVY DUTY DESIGN. MATERIAL SHALL BE GRADE 316 STAINLESS STEEL. EACH HINGE SHALL HAVE A 3/8" GRADE 316 STAINLESS STEEL PIN. HINGES SHALL BE BOLTED TO THE ANGLE FRAME AND DIAMOND PLATE WITH GRADE 316 STAINLESS STEEL BOLTS AND NY-LOCK NUTS.

ALUMINUM SHALL BE SUPPLIED WITH MILL FINISH. EXTERIOR OF FRAME WHICH COMES IN CONTACT WITH CONCRETE SHALL HAVE ONE COAT BLACK PRIMER.

EACH HATCH SHALL BE EQUIPPED WITH A STAINLESS STEEL LIFT HANDLE. LIFT HANDLES SHALL BE FLUSH WITH TOP OF 1/4" DIAMOND PLATE.

EACH HATCH SHALL BE SUPPLIED WITH A GRADE 316 STAINLESS STEEL SLAM LOCK, WITH KEY WAY PROTECTED BY A THREADED PLUG. PLUG SHALL BE FLUSH WITH THE TOP OF THE 1/4" DIAMOND PLATE. SLAM LOCK SHALL BE FASTENED WITH FOUR, GRADE 316 STAINLESS STEEL BOLTS AND WASHERS.

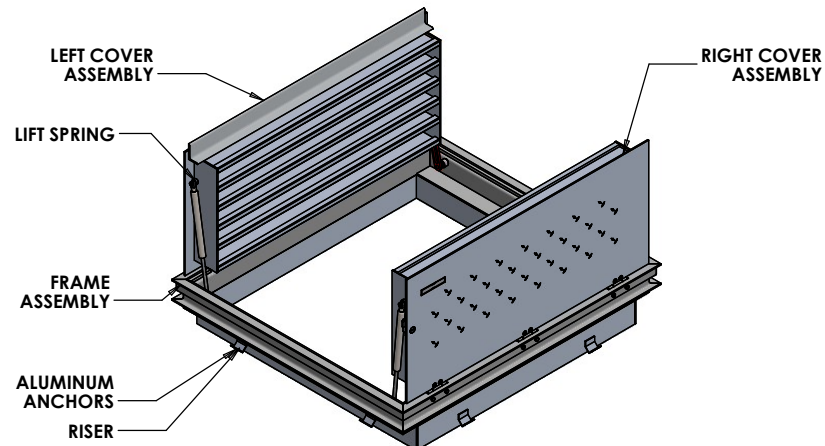

Product Number

H48481304

Design Features

- Materials
 - Aluminum
- Design Load
 - Heavy Duty (Not in Driving Lane)
- Open Area
- Coating
 - Mill Finish
- √ Designates Machined Surface

Certification

- 22-000409
- 202201-35010
- Estimated Weight: 285 LBS
- Country of Origin: USA
- Revision Level: +

Drawing Revision

2/2/2022 Designer: PJC
Revised By:

Disclaimer

Weights (lbs/kg), dimensions (inches/mm) and drawings provided for your guidance. We reserve the right to modify specifications without prior notice.

Quality is very important for EJ, and it includes compliance to measurements and features in this drawing. We are constantly looking at innovation with optimized designs and materials. Please check our website ejco.com for more information. Technical information contained in this drawing represents intellectual property of EJ. If you are using it in other documents please contact EJ, us.sales@ejco.com. Copyright © 2017 EJ GROUP, Inc. All rights reserved.

Contact

800 626 4653
ejco.com