

January 08, 2025  
Expires: January 08, 2027

LONNIE LESTER  
PORTLAND GOLF CLUB  
5900 SW SCHOLLS FERRY RD  
PORTLAND OR 97225

**Re: CWS File 24-002180 | Upland Brush Cutting at Portland Golf Club  
5900 SW Scholls Ferry Rd. Portland, OR 97223 (Tax map 1S12400 Tax lot 01700)**

Clean Water Services has received your Sensitive Area Certification for the above referenced site. Staff has reviewed the submitted materials including site conditions and the description of your project of cutting brush and woody vegetation using low impact methods limiting ground disturbance. Staff concurs that the above referenced project will not encroach into the existing Sensitive Areas and Vegetated Corridor found on the site. In light of this result, this document will serve as your Service Provider letter as required by Resolution and Order 19-5, Section 3.02.1, as amended by Resolution and Order 19-22. All required permits and approvals must be obtained and completed under applicable local, state, and federal law.

This letter does NOT eliminate the need to protect Sensitive Areas if they are subsequently identified within the project area.

Should final development plans differ significantly from those submitted for review by Clean Water Services, the applicant shall provide updated drawings, and if necessary, obtain a revised Service Provider Letter.

**This Service Provider Letter is not valid unless CWS-approved site plan is attached.**

Sincerely,



Lindsey Obermiller  
Environmental Plan Review

Attachment ( 2 )

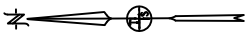

See Detail on Exhibits A & B.

**CWS FILE NO. 24-002180**  
 Approved  
 Clean Water Services  
**FOR ENVIRONMENTAL REVIEW**  
 By LD Date 01/08/2025  
 SPL ATTACHMENT 1 OF 2

**Terra Science, Inc.**  
 Soil, Water, & Wetland Consultants

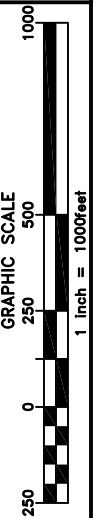

CLEAN WATER SERVICES EROSION CONTROL PERMIT  
 FOR PORTLAND GOLF CLUB BRUSH CLEARING & TRIMMING;  
 SOUTH PART OF TAX LOT 1700, T. 1S, R. 1W, Sec. 24 (BC)  
 Washington County, Oregon

December 2024 (Updated)

**VICINITY**

PORTLAND GOLF COURSE  
 AND BRUSH CLEARING AREA



- LEGEND**
- Delineated Wetland Boundaries
  - 1-Ft LIDAR Derived Topographic Contours (2014)
  - Culvert
  - Fence Location
  - Compost Berm/Straw Waddle (~~if needed~~)

CWS FILE NO. 24-002180  
 Approved  
 Clean Water Services  
 FOR ENVIRONMENTAL REVIEW  
 By Date 01/08/2025  
 SPL ATTACHMENT 2 OF 2

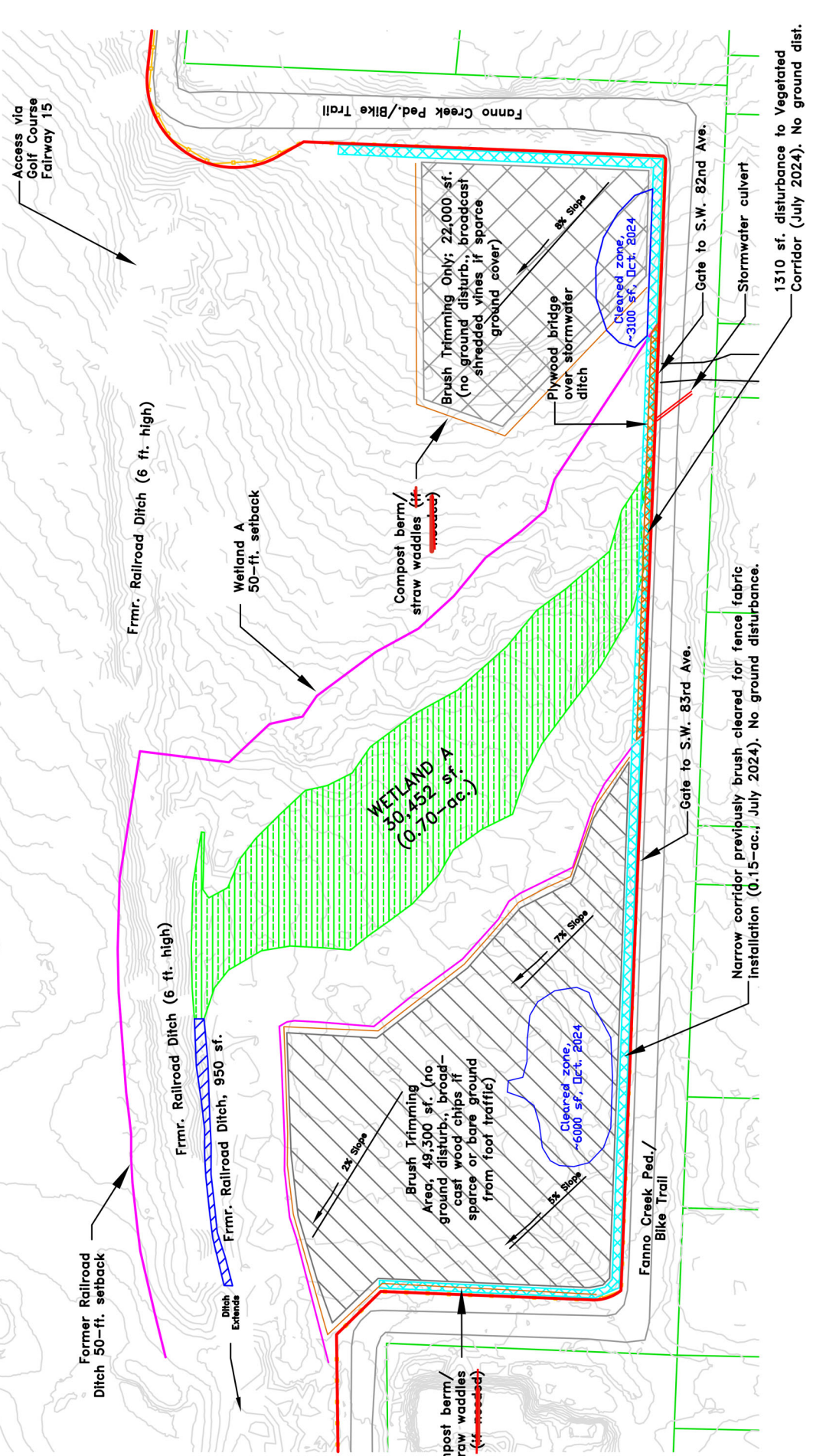

Terra Science, Inc.  
 Soil, Water, & Wetland Consultants

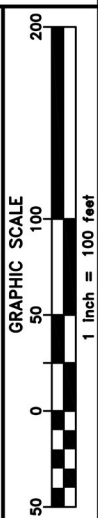

CLEAN WATER SERVICES EROSION CONTROL PERMIT  
 FOR PORTLAND GOLF CLUB BRUSH CLEARING & TRIMMING;  
 SOUTH PART of TAX LOT 1700, T. 1S, R. 1W, Sec. 24 (BC)  
 Washington County, Oregon

December 2024 (Revised)

SITE PLAN AND  
 EXISTING FEATURES

EXHIBIT A