

# OWNERS MANUAL



## PROFESSIONAL & RESIDENTIAL MODEL



[WWW.LUCKYDOGSLURECOURSING.COM](http://WWW.LUCKYDOGSLURECOURSING.COM)

# TABLE OF CONTENTS



1. CONTENTS OF SYSTEM
2. WELCOME TO LURE COURSING
- 3-4. SUGGESTIONS & TIPS
5. COURSE LAYOUTS
6. WARRANTY INFORMATION



# COMPONENTS

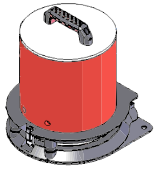

MACHINE X 1



FIELD STRING X 1



FIELD PULLEY X 5 (6 FOR PROFESSIONAL MODEL)



MACHINE STAKE X 2

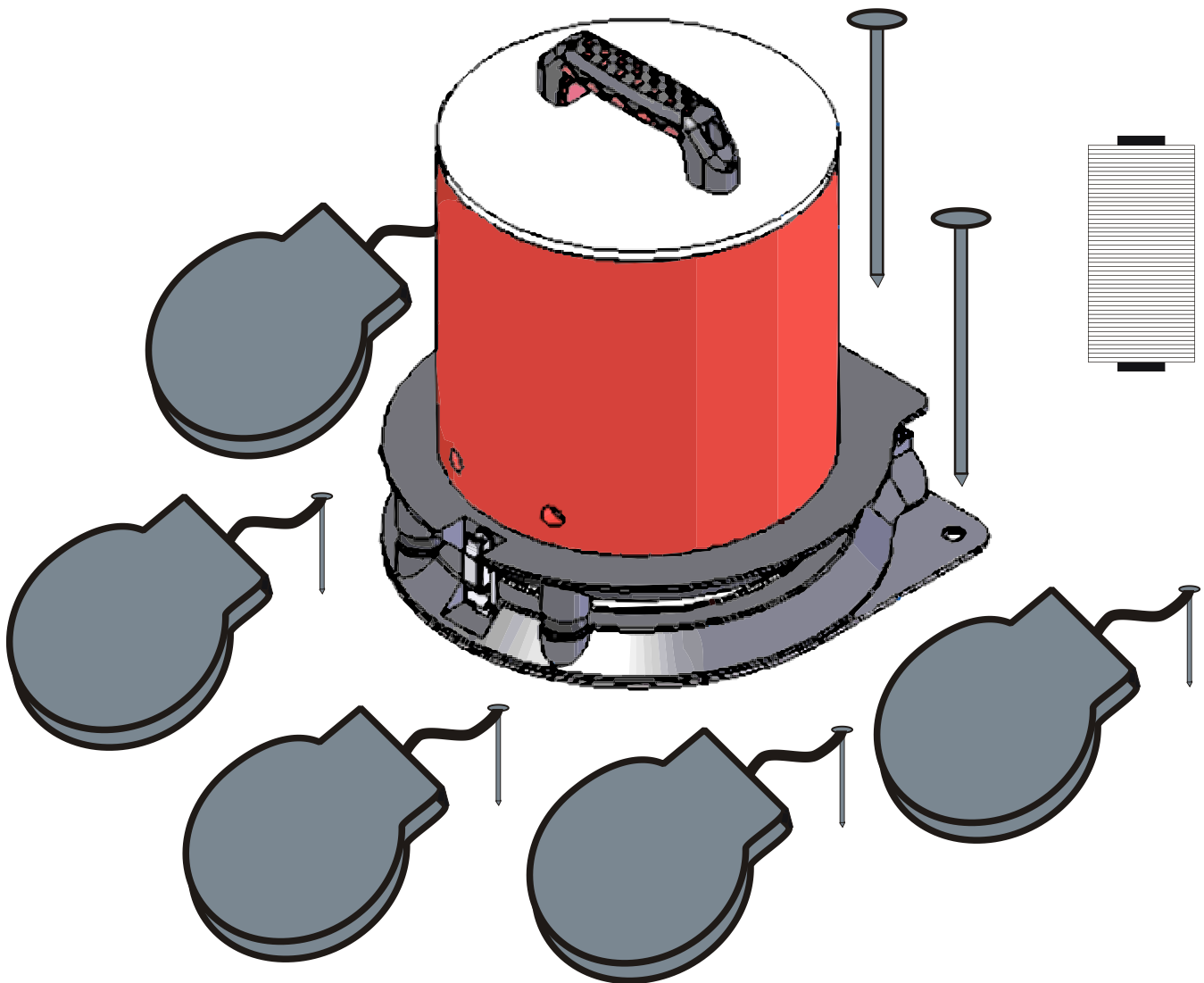

# CONGRATULATIONS!



LURE COURSING WILL PROVIDE TONS OF FUN FOR BOTH YOU AND YOUR DOG. BUT, NO YOUR DOG COULD NOT DO THIS ALL DAY. REALIZE THAT DOGS ARE USUALLY RUNNING FULL OUT IN THEIR EFFORT TO CHASE THE LURE AND CAN OVERDO QUICKLY IF THE OPERATOR IS NOT FULLY AWARE OF THE DOGS CONDITION.

THE VARIABLE SPEED CONTROL ALLOWS YOU TO ADJUST TO THE INDIVIDUAL DOGS AGE, SIZE AND ATHLETICISM, HOWEVER WE ENCOURAGE YOU TO USE CAUTION AND GOOD JUDGEMENT IN THE LENGTH OF EACH RUN AND THE LENGTH OF TIME BETWEEN RUNS. SOMETIMES IT'S HARD TO TELL HOW TIRED THE DOG IS UNTIL THEY STOP RUNNING SO AFTER A FEW TURNS PAUSE AND LOOK FOR SIGNS OF FATIGUE SUCH AS THE SIDEWAYS TONGUE, FROTHING, TREMBLING OF LEGS OR BUGGED OUT EYES. AS WITH ANY NEW EXERCISE START SLOWLY AND WORK UP TO PREVENT SORENESS AND OVEREXERTION ON THE PART OF YOUR PET. IF YOUR DOG HAS ANY HEALTH PROBLEMS YOU WILL WANT TO SPEAK TO YOUR VETERINARIAN PRIOR TO BEGINNING THIS ATHLETIC ACTIVITY.

WE RECOMMEND KEEPING NAILS TRIMMED AND TO MONITOR PAW PADS FOR SIGNS OF SEPARATION. IN CASE OF OVERHEATING SPLASH COOL WATER ON THEIR ARMPITS AND STOMACH AND DON'T LET THEM DRINK TOO MUCH WATER IMMEDIATELY AFTER RUNNING.

IF YOU KEEP IT SAFE AND EXERCISE COMMON SENSE  
THIS EXCITING ACTIVITY WILL PROVIDE YEARS OF  
HEALTHY EXERCISE AND THE STIMULATION YOUR DOG  
NEEDS. THE JOY YOU WILL SEE IN YOUR DOGS EYES IS  
PRICELESS.

# TIP'S & POINTERS



## GROUND CONDITIONS

BEFORE YOU PROCEED WITH SETTING UP THE COURSE, YOU FIRST NEED TO DO AN INSPECTION OF THE AREA WHERE THE DOGS WILL RUN. LOOK FOR ANY DEBRIS SUCH AS STICKS, LITTER, BOTTLE CAPS, ANYTHING THAT COULD CAUSE HARM TO THE ANIMAL. LOOK BOTH AT THE PATH THE LINE WILL TAKE, AND THE POSSIBLE ROUTES THE DOG WILL TAKE, SOME DOGS RUN ON THE INSIDE OF THE COURSE, SOME RUN ON THE OUTSIDE, ALL POSSIBLE PATHS NEED TO BE INSPECTED. YOU NEED TO AVOID ANY OBSTICALS SUCH AS TREES, LOGS, LAWN ART AND ESPECIALLY HOLES AND DEPRESSIONS. SINCE THE FIELD PULLEYS ARE MOVABLE, THERE IS NO REASON TO ENDANGER THE HEALTH OF THE ANIMAL. ONCE AGAIN, INSPECT THE AREA, WALK THE LINE!

THE PERFORMANCE OF THE MACHINE IS DIRECTLY RELATED TO THE CONDITIONS OF THE SURFACES YOU ARE RUNNING ON. SHORT, FLAT, WELL MOWED GRASS, OR DIRT IS IDEAL AND EASIEST ON THE MACHINE AND WHERE YOU WILL SEE THE QUICKEST THROTTLE RESPONSE AND DIRECTION CHANGES. IF THE CONDITIONS ARE LONG GRASS WITH A LOT OF ELEVATION CHANGES, THE MACHINE WILL RUN SLOWER.

## PULLEYS & LINE

OUR PULLEYS ARE THE BEST IN THE BUSINESS, BUT THEY DO NEED A LITTLE ATTENTION EVERY ONCE IN A WHILE. SPRAY THE BEARINGS OF THE PULLEYS FROM TIME TO TIME WITH A LUBRICANT SUCH WD40. LUBRICATION IS IMPORTANT BECAUSE IT LESSENS THE DRAG ON THE SYSTEM AND PROLONGS THE LIFE OF THE SYSTEM BY KEEPING THE PULLEYS WORKING SMOOTHLY.

THE LINE WE SUPPLY YOU WITH IS A #250 BRAIDED DACRON FOR OUR SYSTEM. THERE IS A FINE BALANCE BETWEEN STRENGTH AND SAFETY AND WE BELIEVE THIS IS THE BEST CHOICE. IT IS STRONG ENOUGH TO LAST UNDER A HEAVY WORK-LOAD, DURABLE ENOUGH TO REUSE MANY, MANY TIMES AND BREAKS IF THINGS GO WRONG. HEAVIER AND LIGHTER LINES ARE AVAILABLE FOR OTHER APPLICATIONS.

LINE TENSION IS CRUCIAL TO HOW THE SYSTEM WORKS, TOO MUCH TENSION AND THE LINE BREAKS, TOO LITTLE AND THE DRIVE WHEEL CANNOT GRIP THE LINE. THERE IS NO HARD AND FAST RULE OF HOW MUCH TENSION IS NEEDED BECAUSE THE COURSE SIZE, CONDITIONS AND LAYOUT ALL FACTOR INTO HOW MUCH TENSION IS REQUIRED. IF THE MACHINE IS SLOW TO PICK UP SPEED OR CHANGE DIRECTION, APPLY MORE TENSION TO THE LINE AND YOU SHOULD SEE THESE FACTORS IMPROVE. THIS IS AS EASY AS JUST MOVING ONE OF THE FIELD PULLEYS TO TIGHTEN. IF YOU INCREASE THE TENSION AND THE LINE BREAKS SEEMINGLY FOR NO REASON, LOOSEN THE TENSION ON THE LINE. IT IS SOMEWHERE IN THE MIDDLE THAT IS THE SWEET SPOT, AND ALSO KEEP IN MIND THAT THE LINE WILL STRETCH OVER TIME AND YOU WILL HAVE TO INCREASE LINE TENSION TO MAINTAIN PROPER OPERATION. WITH OPERATING EXPERIENCE, IT WILL QUICKLY BECOME EASIER TO ACHIEVE THE CORRECT TENSION FOR EACH COURSE.

WE SUGGEST USING THE BLOOD KNOT TO TIE THE LINE. BAD NAME, BUT A GOOD KNOT, IT HELPS SUPPORT THE LINE THROUGH THE SYSTEM THE BEST. IT ALSO PUTS THE FRAYED ENDS IN THE MIDDLE OF THE KNOT WHICH IS LESS LIKELY TO SNAG ON OBSTACLES.

The Blood Knot

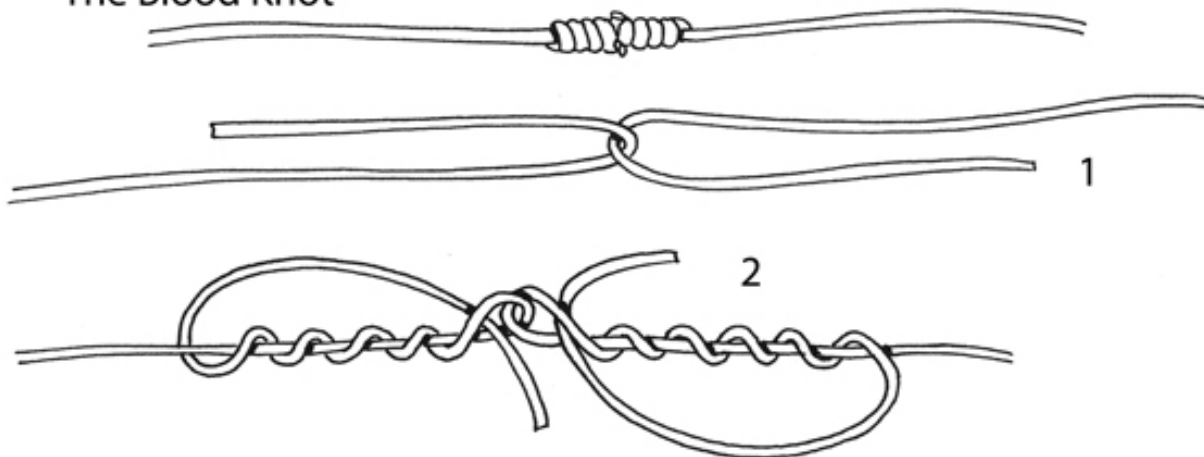

AT THE KNOT IS WHERE WE SUGGEST YOU LEAVE ONE OF THE ENDS OF THE LINE EXTRA LONG SO YOU HAVE A SPOT TO TIE IN LURE (PLASTIC BAG)..

TRIM ONE SIDE →

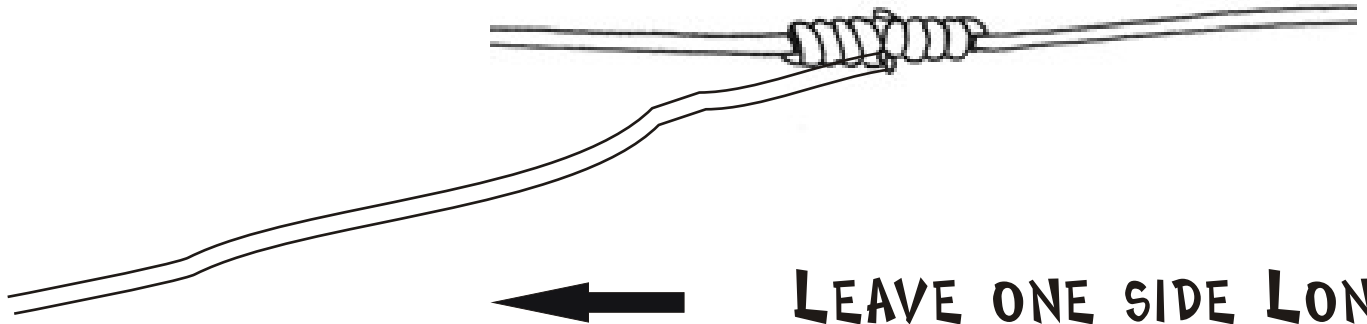

← LEAVE ONE SIDE LONG  
APPROXIMATELY 8-12 INCHES TO TIE IN THE LURE

TIE THIS END THROUGH THE HANDLES OF A  
PLASTIC GROCERY BAG USING A DOUBLE KNOT.



CUT BOTTOM OFF

DONT FORGET TO CUT  
THE BOTTOM OF THE  
BAG OFF. IF YOU  
FORGET, THE BAG  
WILL BALLOON OUT  
AND NOT PASS  
THROUGH THE PULLEYS  
OR THE MACHINE.

# MACHINE & CONTROLLER



THIS MACHINE IS THE ULTIMATE IN BACK-YARD ENTERTAINMENT FOR BOTH DOGS AND OWNERS ALIKE. WE HAVE DESIGNED IT TO BE SIMPLE TO SET-UP AND USE, WHILE BEING DURABLE ENOUGH TO PROVIDE YEARS OF FUN.

WE HAVE A SIMPLE ON/OFF SWITCH LOCATED IN THE BACK OF THE MACHINE, UP IS ON, DOWN IS OFF.

THIS SWITCH ALSO ACTIVATES THE COOLING FAN WHICH WILL RUN CONTINUOUSLY WHEN SWITCH IS IN THE ON POSITION AND WILL NOT SHUT OFF UNTIL THE SWITCH IS TURN TO THE OFF POSITION. THIS ALLOWS THE MACHINE TO COOL DOWN BETWEEN RUNS. ALSO PLEASE ALLOW THE FAN TO RUN FOR A FEW MINUTES AFTER EXTENDED USES BEFORE TURNING THE SWITCH TO THE OFF POSITION.

THE MACHINES COOLING FAN IS LOCATED IN THE TOP OF THE BACK OF THE UNIT. THIS PULLS COOL AIR IN AND FORCES THE COOL AIR OVER THE MACHINE AND EXHAUSTS IT OUT THE LOWER FRONT VENTS, MAKE SURE YOU KEEP BOTH THE FAN AND VENT HOLES FREE OF OBSTRUCTIONS FOR PROPER VENTILATION. BLOCKING EITHER OF THESE PATHS COULD RESULT IN EQUIPMENT OVERHEATING AND POSSIBLE FAILURE.

OUR CUSTOM CONTROL HANDLE IS EASY TO USE AND COMFORTABLE IN YOUR HANDS. OUR VARIABLE SPEED CONTROLLER IS CAPABLE OF SMOOTHLY OPERATING THE MACHINE AT LOW SPEED, BUT WITH A SQUEEZE OF THE TRIGGER, YOU'RE OFF TO THE RACES! SO DOGS OF ALL LEVELS OF ATHLETICISM CAN BE CHALLENGED SAFELY. OUR SYSTEM ALSO HAS THE ABILITY TO CHANGE DIRECTION. THE DIRECTION SWITCH IS LOCATED JUST ABOVE THE SPEED TRIGGER ON THE CONTROLLER, YOU MUST RELEASE THE SPEED TRIGGER BEFORE YOU CHANGE THE DIRECTION OF THE MACHINE, FAILING TO RELEASE THE SPEED TRIGGER WHEN CHANGING DIRECTION CAN RESULT IN SWITCH FAILURE. SIMPLY CHANGE THE DIRECTION SWITCH ON THE CONTROLLER AND WATCH YOUR DOG "RESET" ON THE COURSE, NEW DIRECTION=NEW COURSE IN A DOGS MIND.

## MACHINE BACK

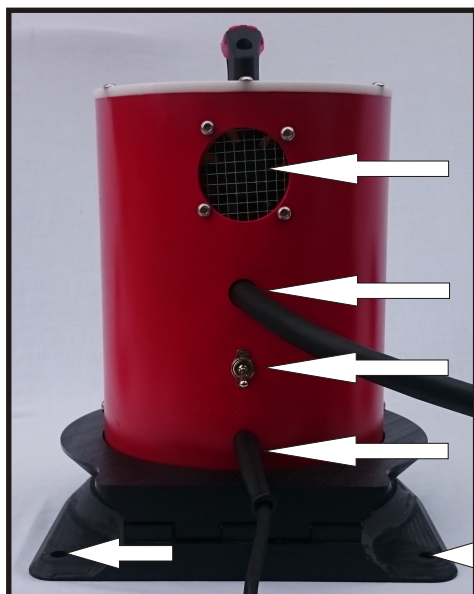

COOLING FAN

CONTROLLER CORD

POWER SWITCH ON/OFF

POWER CORD

STAKE HOLES

## CONTROLLER

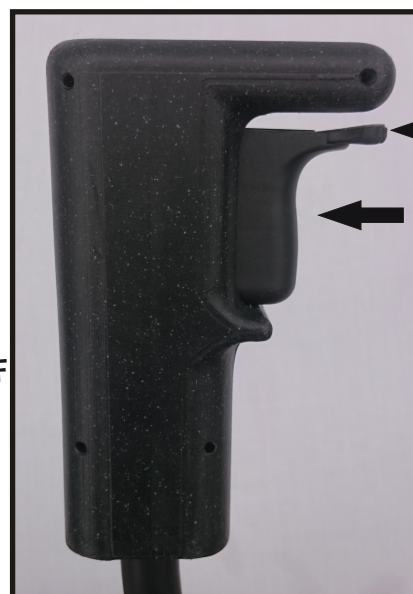

DIRECTION  
SWITCH

SPEED TRIGGER

# COURSE LAY-OUTS



## SMALL COURSE W/OUT PULLEY AS TENSIONER

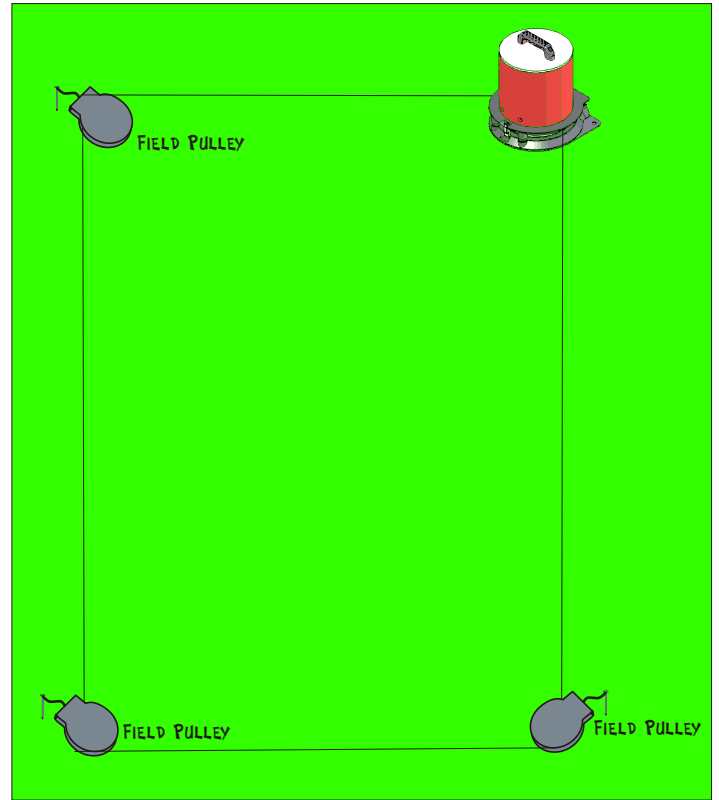
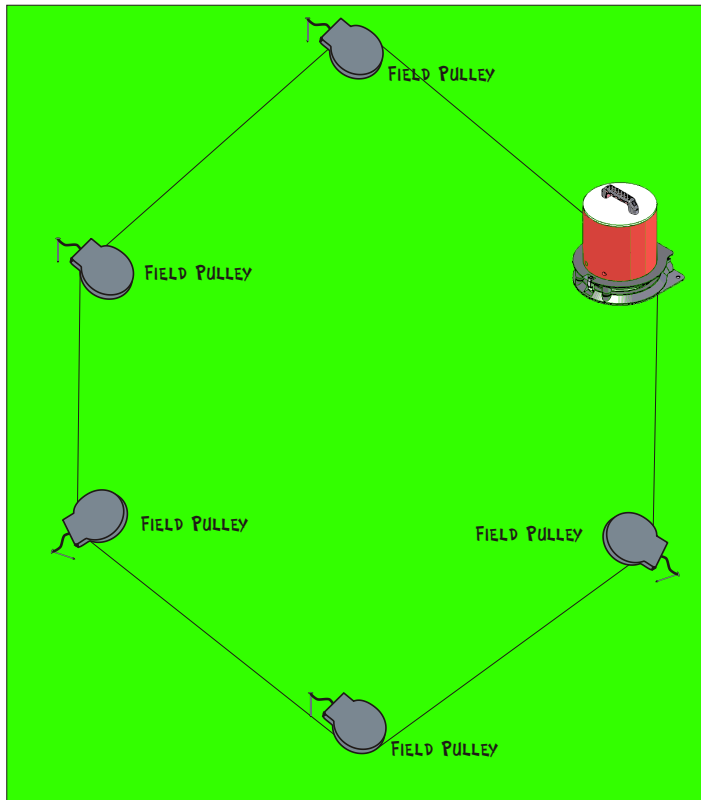

## LARGE COURSE WITH PULLEY AS TENSIONER

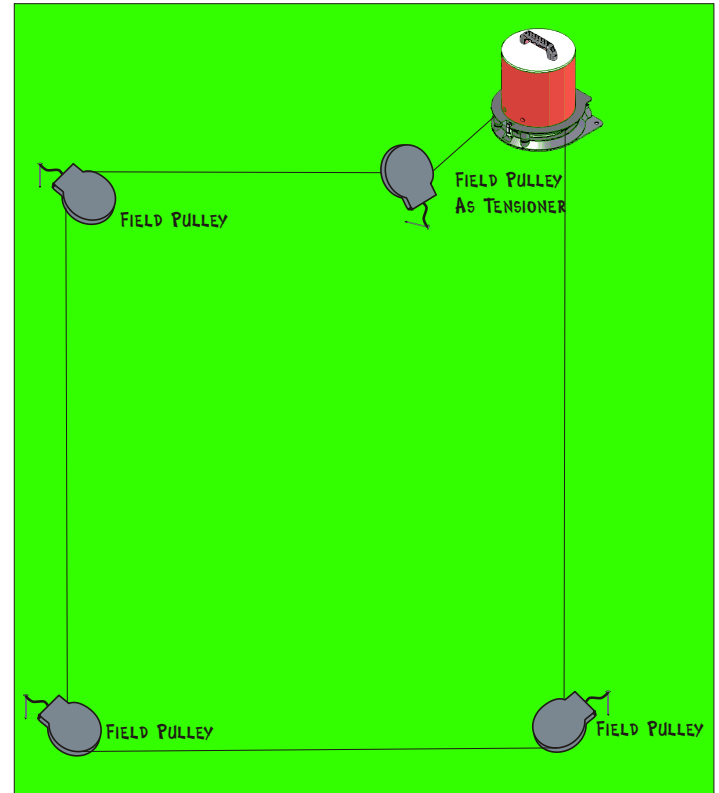
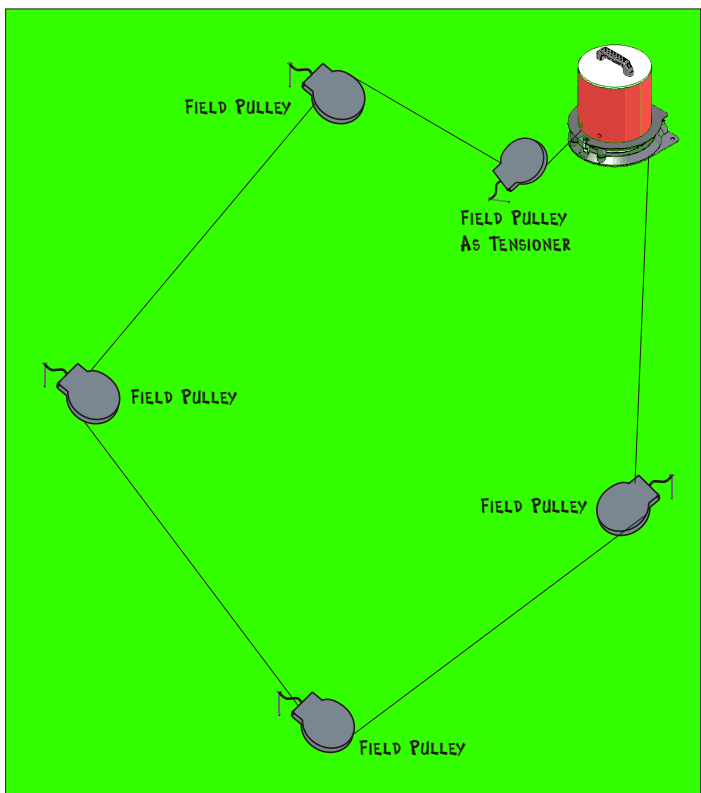

# WARRANTY INFORMATION



## WARRANTY AND RETURN POLICY.

WE WANT EVERYONE TO BE HAPPY WITH THEIR WHOLE PURCHASING EXPERIENCE AND IF YOUR MACHINE FAILS DUE TO MANUFACTURER DEFECTS WITHIN THE FIRST 90 DAYS FOR THE RESIDENTIAL VERSION OR 120 DAYS FOR THE LARGER VERSION WE WILL REPAIR IT FREE OF CHARGE. SHIPPING CHARGES THROUGH THAT PERIOD WILL ALSO BE PAID BY LUCKY DOGS LURE COURSING.

REPAIRS WILL BE AVAILABLE OUTSIDE OF WARRANTY BUT CHARGES SUCH AS PARTS, LABOR & SHIPPING WILL BE INCURRED BY THE EQUIPMENT PURCHASER.

WHILE THIS MACHINE DOES HAVE A COOLING FAN AND IS DESIGNED FOR REGULAR USAGE, IF RUNNING THIS MACHINE FULL OUT FOR HOURS, CONTINUE TO MONITOR THE HEAT LEVEL THROUGH THE CASE AND BRIEFLY PAUSE YOUR OPERATION IF IT FEELS HOT.

IF OVER TIME YOU FEEL YOU'RE NOT GETTING THE SPEED YOU USED TO GET, SQUIRT A LITTLE WD40 ON THE FIELD PULLEYS. IF YOU HAVE ANY PROBLEMS WITH MACHINE SETUP OR OPERATION LET US KNOW AT 859-447-0029 OR [LUCKYDOGSADVENTURES@GMAIL.COM](mailto:LUCKYDOGSADVENTURES@GMAIL.COM).

WE'RE HERE TO HELP.

**LUCKY DOGS LURE COURSING ASSUMES NO RESPONSIBILITY FOR ANY DAMAGES, INJURIES OR ANY OTHER OCCURRENCES TO MACHINE OPERATOR, ANIMALS OR SPECTATORS THAT MAY RESULT FROM THE OPERATION OF OUR EQUIPMENT. USE AT YOUR OWN RISK.**