

FRONT BRAKE CALIPER BRACKET



P/N 02-003

APPLICATION:

- 2015 and newer KX250 & KX450

⚠ CAUTION

This caliper bracket is designed for 270mm brake rotors. Ensure you have the proper sized rotor installed before using this bracket

BEFORE YOU BEGIN:

Read these instructions and check to be sure all parts and tools are accounted for.

⚠ WARNING

Always ensure service and maintenance on your motorcycle is performed by a professional mechanic

KIT CONTENTS:

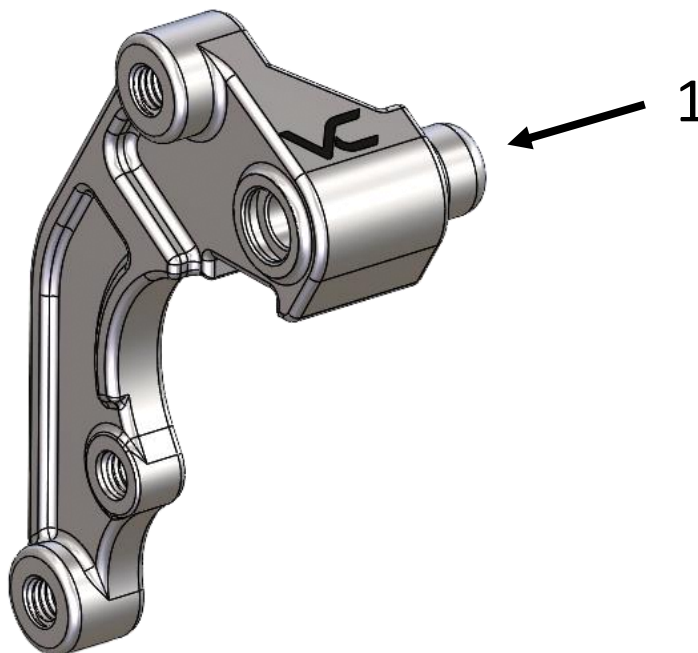

Ref	QTY.	PART DESCRIPTION	Part Number
1	1	KX-to-CRF Caliper Bracket	02-003

TOOLS REQUIRED

- 5mm & 6mm Hex Bit
- 8mm, 10mm & 12mm Wrench
- 8mm & 12mm Socket
- Ratchet
- JIS Screw Driver
- Brake Fluid Catch Can

FRONT BRAKE CALIPER BRACKET

INSTALLATION INSTRUCTIONS

1. Start by removing the brake fluid from the system through the bleed fitting



2. Once brake fluid is evacuated from the system, remove the brake banjo bolt from the caliper
3. Loosen the brake pad pin, for easier removal of the brake pads once the caliper is fully removed from the bike
4. Remove the caliper from the fork lug



5. Remove stock caliper bracket from caliper and remove caliper pin slider from the stock caliper bracket



6. Install caliper pin slider on the Velocity Components caliper bracket

⚠ WARNING

Apply Loctite 271 before installing into new caliper bracket

⚠ WARNING

Ensure threads are completely clean and free of debris before applying Loctite

7. Remove the caliper boot from the stock caliper bracket and install on the Velocity Components caliper bracket
8. Install retainer onto caliper bracket and spring pad onto caliper

⚠ WARNING

Kit is designed to use Honda retainers (45112-MKE-A71) and spring pads (45108-MKE-A71). Ensure these are used and not the original Kawasaki ones

9. Install caliper onto caliper bracket and install brake pads. Torque brake pad pin to manufacture's specification

FRONT BRAKE CALIPER BRACKET

⚠ CAUTION

Ensure caliper slide pin is lubricated before installing caliper onto bracket

10. Mount assembly onto fork lug and torque to manufacture's specifications



11. Reinstall the brake hose and bleed the brake system

⚠ WARNING

Always use new brake banjo bolt washers

⚠ WARNING

Assemble, torque, and bleed brake line per service manual

⚠ WARNING

Ensure proper function of your brake system before riding your motorcycle again