

STATE HIGHWAY NO 353

WABANK T. CEMETERY (NO. 19)

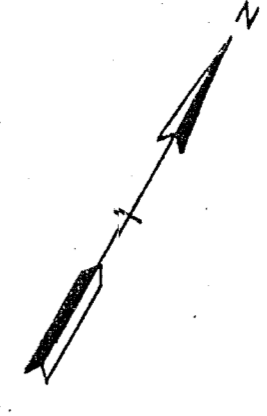
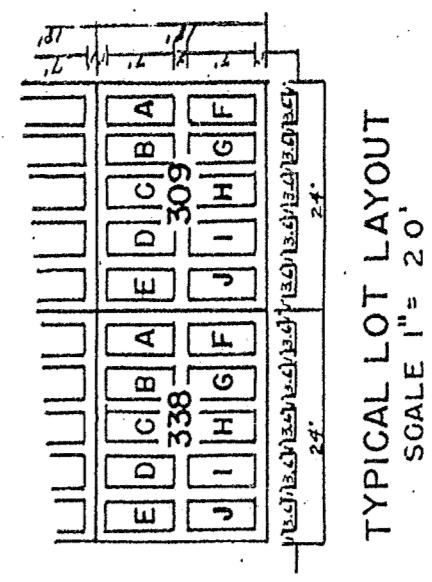

LEGEND

- ⊙ Live Oak
- ⊙ Cedar
- ⊙ Rose
- ⊙ Dwarf Asterias
- ⊙ Grape Myrtle

* NOTE: YORK CEMETERY NO. 20 INCLUDED WITH KIMBALL CEMETERY AS GRAVE NO. 51A IN LOT NO. 38

CONSOLIDATING THE FOLLOWING CEMETERIES
 CEDRON CREEK CEMETERY (NO. 15) 4 GRAVES
 ALLEN BEND CEMETERY (NO. 16) 40 GRAVES
 ALLEN BEND CEMETERY (NO. 16A) 7 GRAVES
 POWELL CEMETERY (NO. 18) 82 GRAVES
 KIMBALL CEMETERY (NO. 19) 647 GRAVES
 POGUE CEMETERIES (NOS. 10, 10A) 28 GRAVES

BRAZOS RIVER BASIN, TEXAS
 WHITNEY RESERVOIR
 BRAZOS RIVER, TEXAS
 LAYOUT MAP
 RELOCATION OF CEMETERIES
 SCALE 1" = 50'