

1967 Swift Map

FESW to U

Compare

1970 Brown Map

F'DR' to SW to U

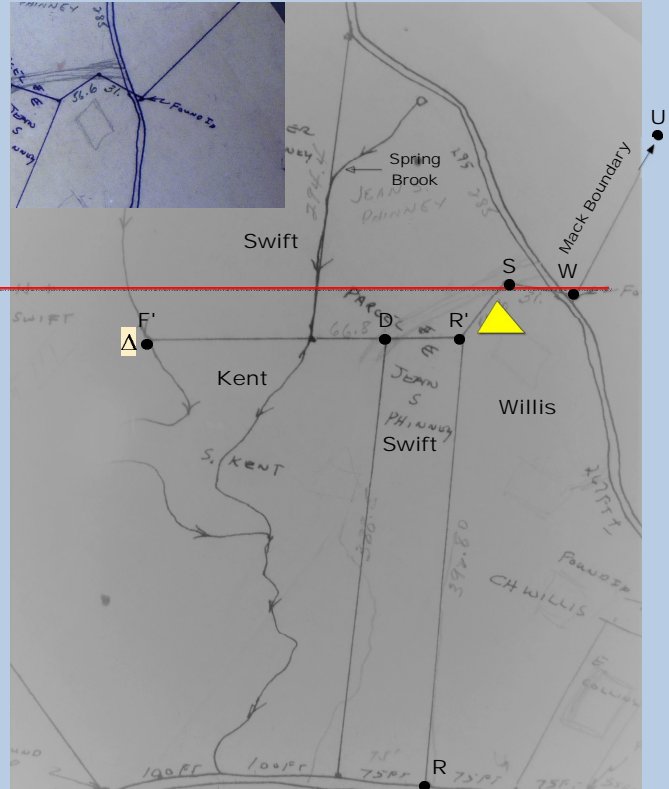
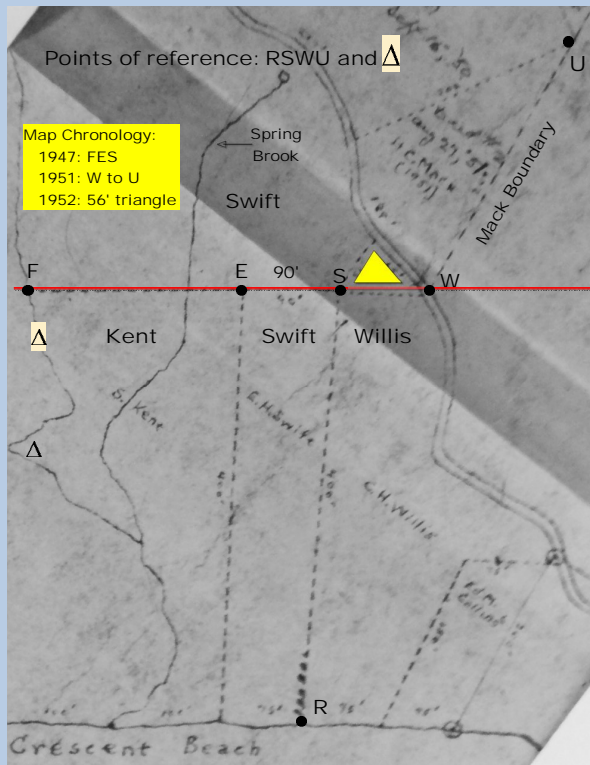

Significant Points:

- Triangle is above S
- 90' between E and S
- FESW to U [2 levels]
- Mack Boundary, RSWU, and Δ as reference points

Significant Points:

- Triangle is now below S
- 90' between E and S has disappeared
- F'DR' to SW to U [3 levels]
- Mack Boundary, RSWU, and Δ as reference points
- The Kent Back Border has been shortened from E to D

Note: the registered 1967 Swift map is identical to Emerson Swift's 1947 map which additionally shows the location of the Crescent Brook Cascade [Δ] the position of which is confirmed by the 2014 Horizons Survey.