

## The Deliberate Change of the Kent Back Boundary from FE to F'D

## The 1947 and 1967 Swift Maps Eliminate the 1970 Brown Map and all Truline Maps

### Category Maps

#### 1967 Swift Map

FESW to U

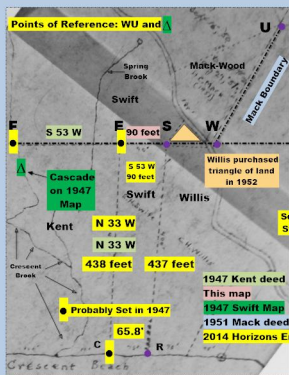

##### Reference Points:

- A triangle of land [56 feet on an edge] is above S.
- RSWU established between 1947 and 1951.
- Crescent Brook Cascade confirmed by Horizons Eng.

90 feet was recorded between E and S in 1947 & 1967, but E is missing in 1970.

The registered 1967 Swift map is identical to Emerson Swift's 1947 map which additionally shows the location of the Crescent Brook Cascade [A] the position of which is confirmed by the 2014 Horizons Engineering Survey.

#### 1970 Brown Map

F'DR' to SW to U

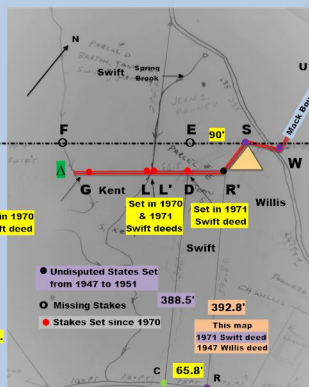

##### Reference Points:

- The triangle of land on the 1967 map is now below S.
- RSWU established between 1947 and 1951.

#### 2004 Truline Map

F'DR' to SW to U

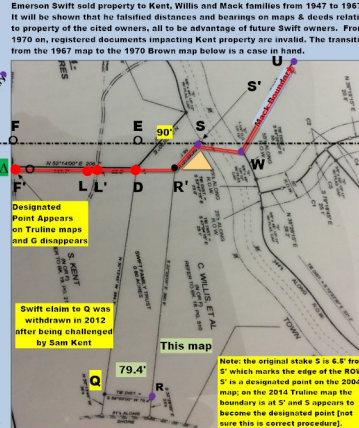

##### Reference Points:

- The triangle of land is below S.
- RSWU established between 1947 and 1951.
- Crescent Brook Cascade confirmed by Horizons Eng.

March 4, 2017

#### 2014 Truline Map

F'DR' to SW to U

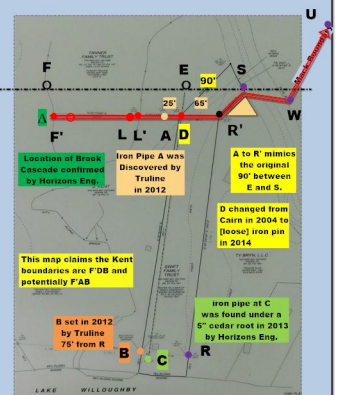

##### Reference Points:

- The triangle of land is below S.
- RSW confirmed [Horizons Eng. 2014 Survey]
- Crescent Brook Cascade [Horizons Eng. 2014 Survey]