

## Two Identical Maps 20 Years Apart

### 1947 Swift Map

Source: Emerson Swift's Notebook

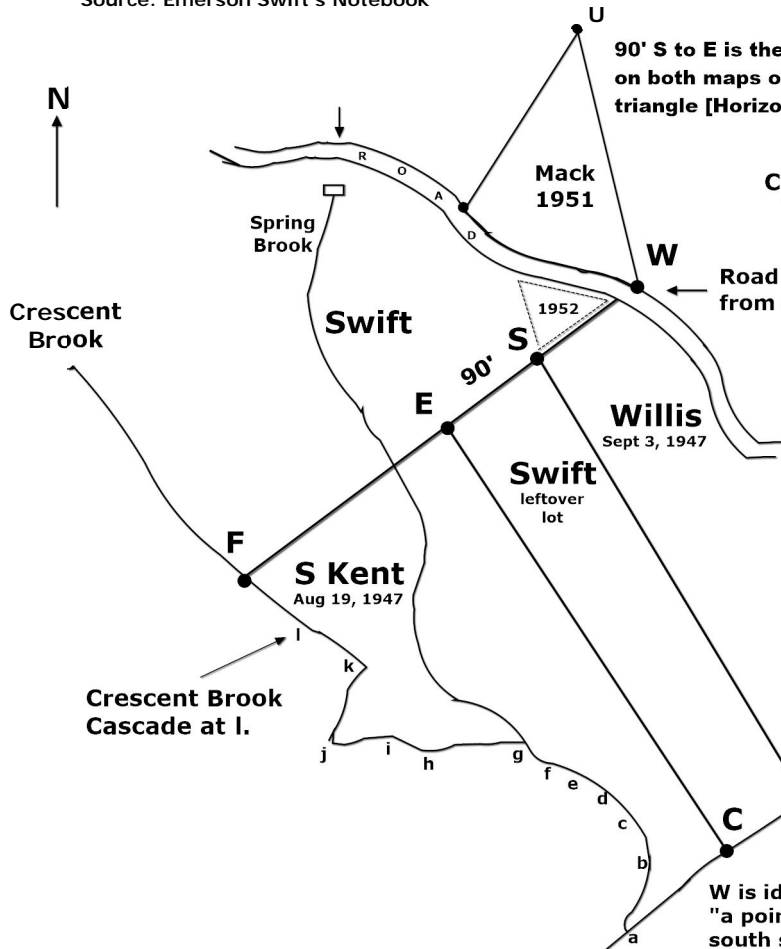

### 1967 Swift Map

Land Records, Town of Westmore

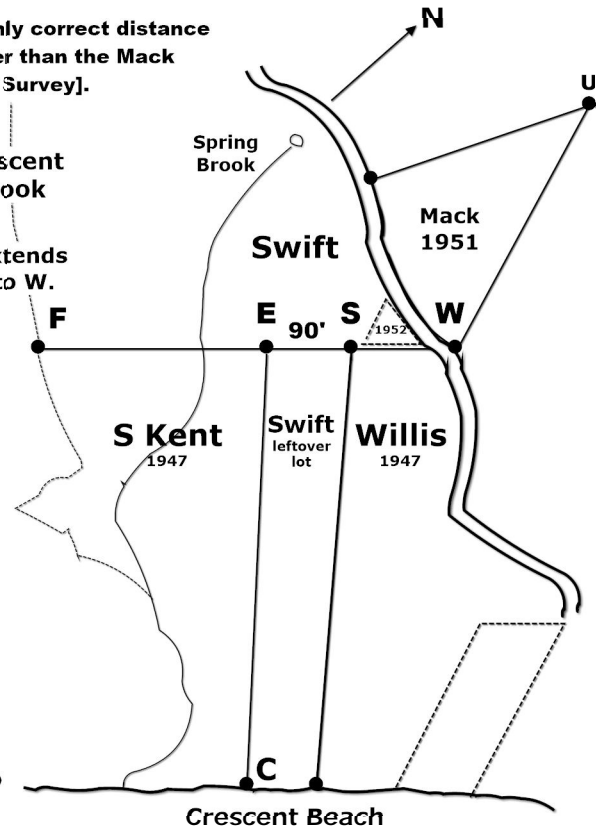

W is identified in the 1951 Mack deed [Book 19, Page 75] as "a point opposite the northernmost corner of the lot on the south side of the right-of-way now owned by Clodius H. Willis."

**An Irrefutable Conclusion:** The Identical and Original 1947 and 1967 Swift Maps Alone, with the Location of the Reference Mack Triangle as a Land Monument, Establish the FEC Kent Boundaries. All Subsequent Maps: the 1970 Brown Map and its Derivative 2004, 2008, 2012 and 2014 Truline Maps are False Reconstructions of Kent Property.