

265' Constraint on Beach Frontage

1967 Swift Map Outline

Land Records, Town of Westmore

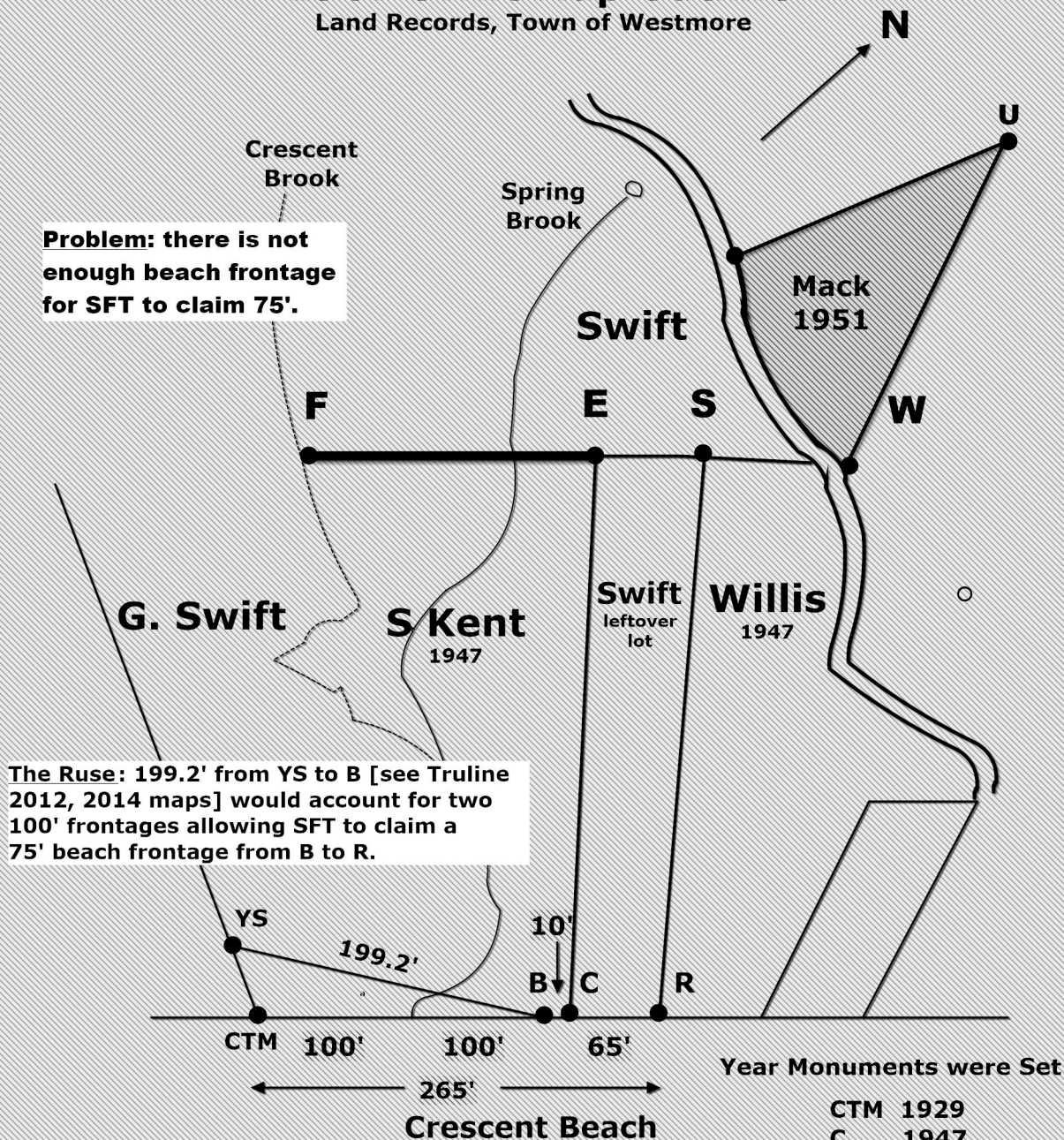

Explanation: The distance between R and CTM [Cedar Tree Marked] is 265' [see Horizons Survey]. Swifts created an illusory 10' in 1966 by moving CTM to YS [Yellow Stake]. Examination in the field reveals that there are no cedar trees or cedar tree remnants within 10-15 feet of YS, but there are numerous small cedars clustered at CTM. Details and references are provided on the Horizons Survey. Other Swift lots on the beach were shifted 10' to the southwest to buttress their claim of a 75' frontage.

Conclusion: the SFT beach frontage is 65' in agreement with the surveyed distance of 65.8' from C to R. SFT does not have a 75' frontage.