

# Intersection of N 33 W bearing from C with S 53 W Bearing from S

1947 Swift Map Outline

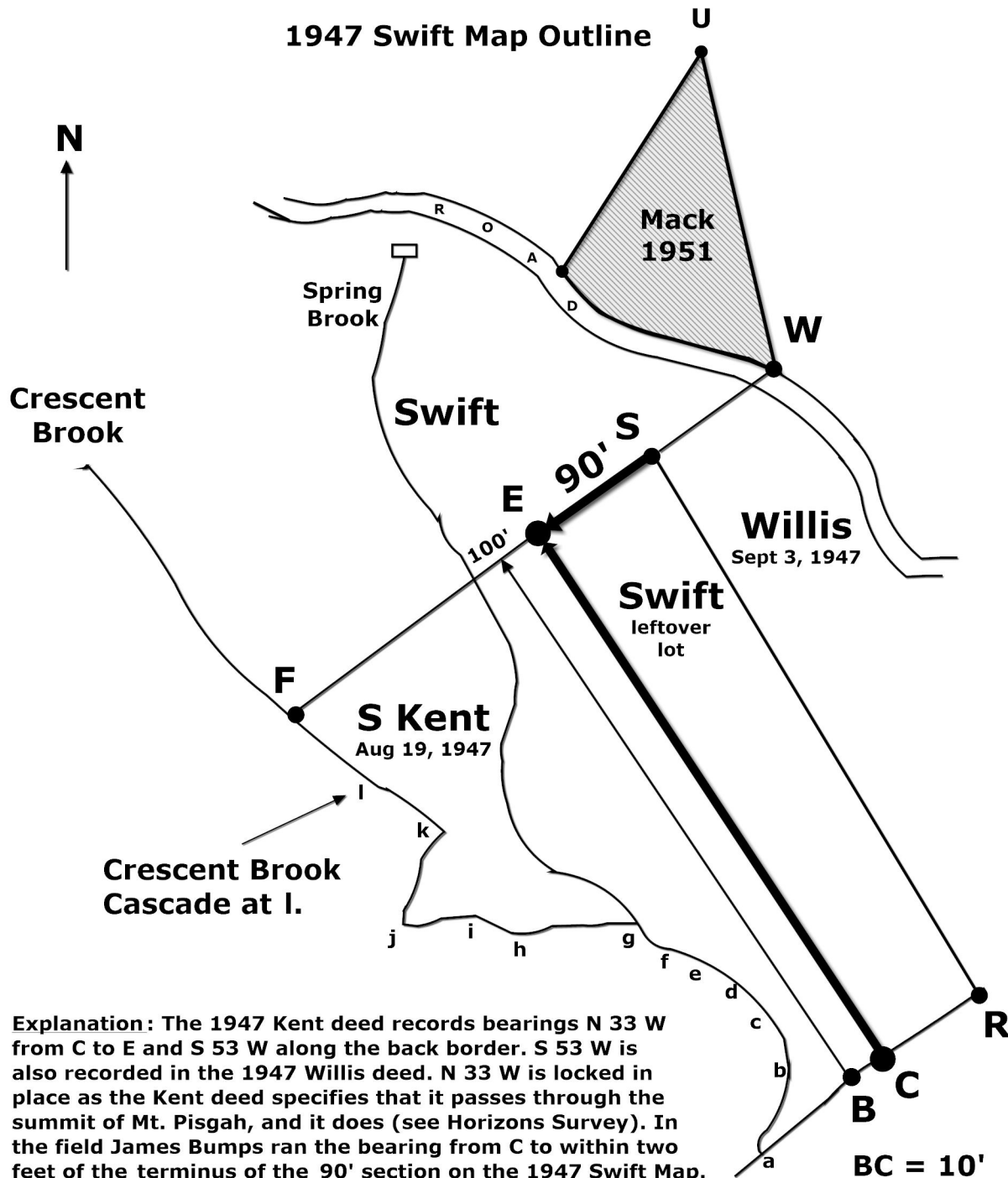

**Explanation:** The 1947 Kent deed records bearings N 33 W from C to E and S 53 W along the back border. S 53 W is also recorded in the 1947 Willis deed. N 33 W is locked in place as the Kent deed specifies that it passes through the summit of Mt. Pisgah, and it does (see Horizons Survey). In the field James Bumps ran the bearing from C to within two feet of the terminus of the 90' section on the 1947 Swift Map.

**Conclusion:** The intersection of the two bearings at E confirms that the Kent deed data and the location of Stake C at 65.8 feet from R agree precisely with the 1947 Swift Map. The intersection refutes the Swift claim to a 75' frontage from B to R (see Horizons Survey).

**Note:** Intersection from Swift Stake B on N 33 W would be 100' from S.

Diagram 11 -- Intersection of Bearings  
16. Collection of Beach Diagrams February 2018  
40. The Narrative