

The 1970 Swift Deed is the Counterpart of the 1970 Brown Map

The FE Kent Boundary is Moved to F'D

Paragraph Reveals New Boundary

"...thence from said iron pipe down the brook 258 feet and thence continuing in a straight line near and approximately parallel with said brook 59 and five-tenths feet to an iron pipe driven into the ground [Stake G], said iron pipe being South 59 degrees East from where said *last mentioned boundary line* [Stake F] leaves the brook" ... [parenthetical information and emphasis added]

1970 Swift deed [Book 22, Page 291]

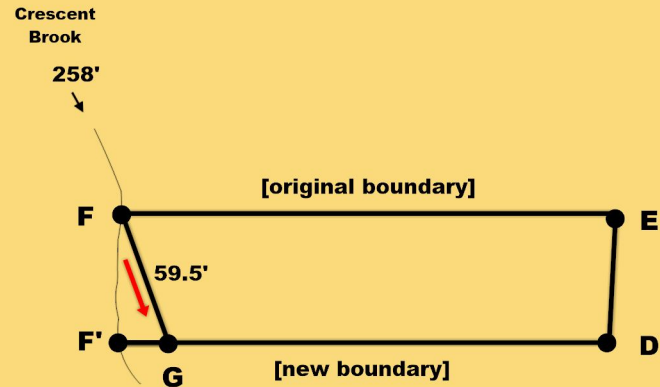

Outline of the 1967 Swift Map

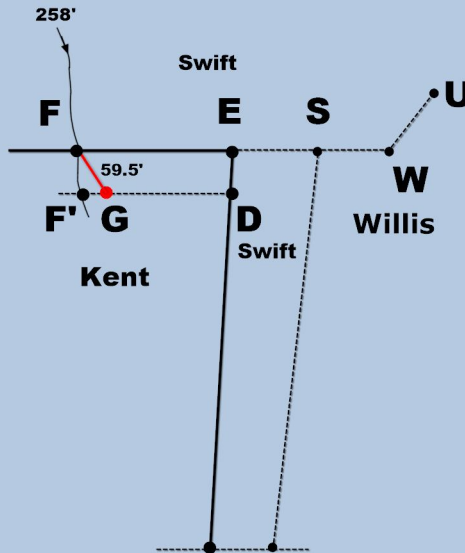

Creation of F'

The 1970 deed says that G "was set". Since the distance between F and G was 59.5 feet, F was probably present in 1970 to measure that distance to 3 significant figures, i.e. a tenth of a foot. Both F and G stakes were missing in 2014, and the paragraph referring to 59.5' is missing in the 2004 Tanner deed. F' appears is a designated point on Swift maps produced by Truline.

Creation of D

Stake D was added in the 1971 Swift deed [Book 22, Page 295]. Identical Land Descriptions are reported in 1973a, 1973b and 1988 deeds. Additional stakes were added between F' and D in future Swift deeds and maps.