

## 1967 Swift Map

## Compare

## 1970 Brown Map

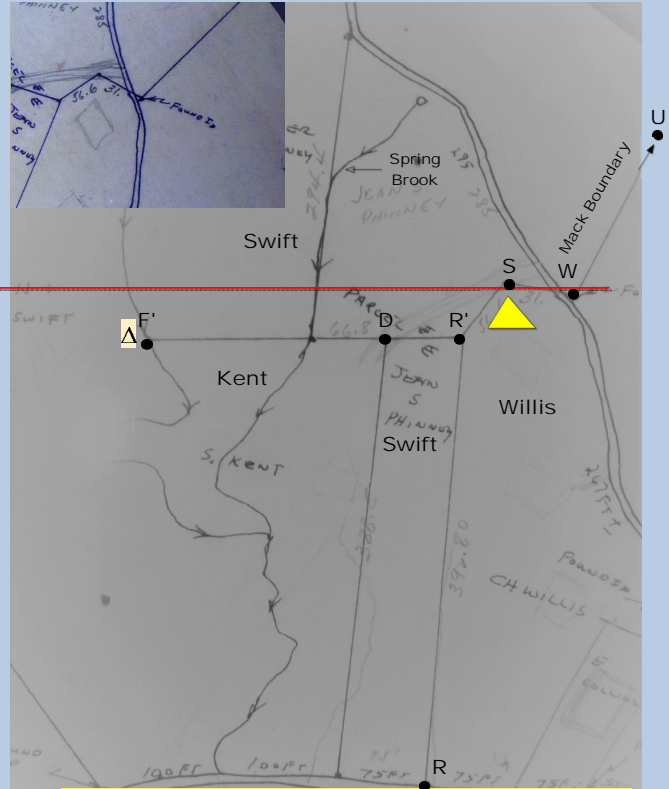
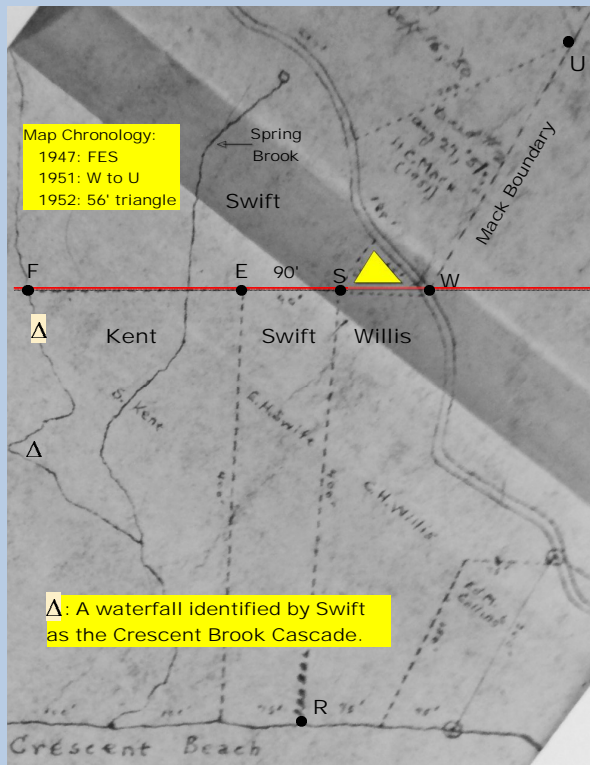

### Significant Points:

- Triangle is above S and W
- There are 90' between E and S [confirmed by survey]
- Northern Boundary is FESW
- Mack Boundary Line, WU, and Δ are reference points

### Significant Points:

- The peak of the Triangle is Pin S
- E and S have disappeared
- New Boundary is F'D R'
- Mack Boundary Line and Δ are reference points
- The Kent Back Border has been shortened from E to D

Explanation: In 1952 Swift sold Willis a small triangle of land [ 56x75x65'] and misplaced it in the 49.5'-wide public right-of-way (road). The Triangle and Boundary were moved together creating the 1970 Brown Map. There was no justification for moving the boundary.