

# 1947 Swift Map

## No Justification for Changing the Kent Back Border

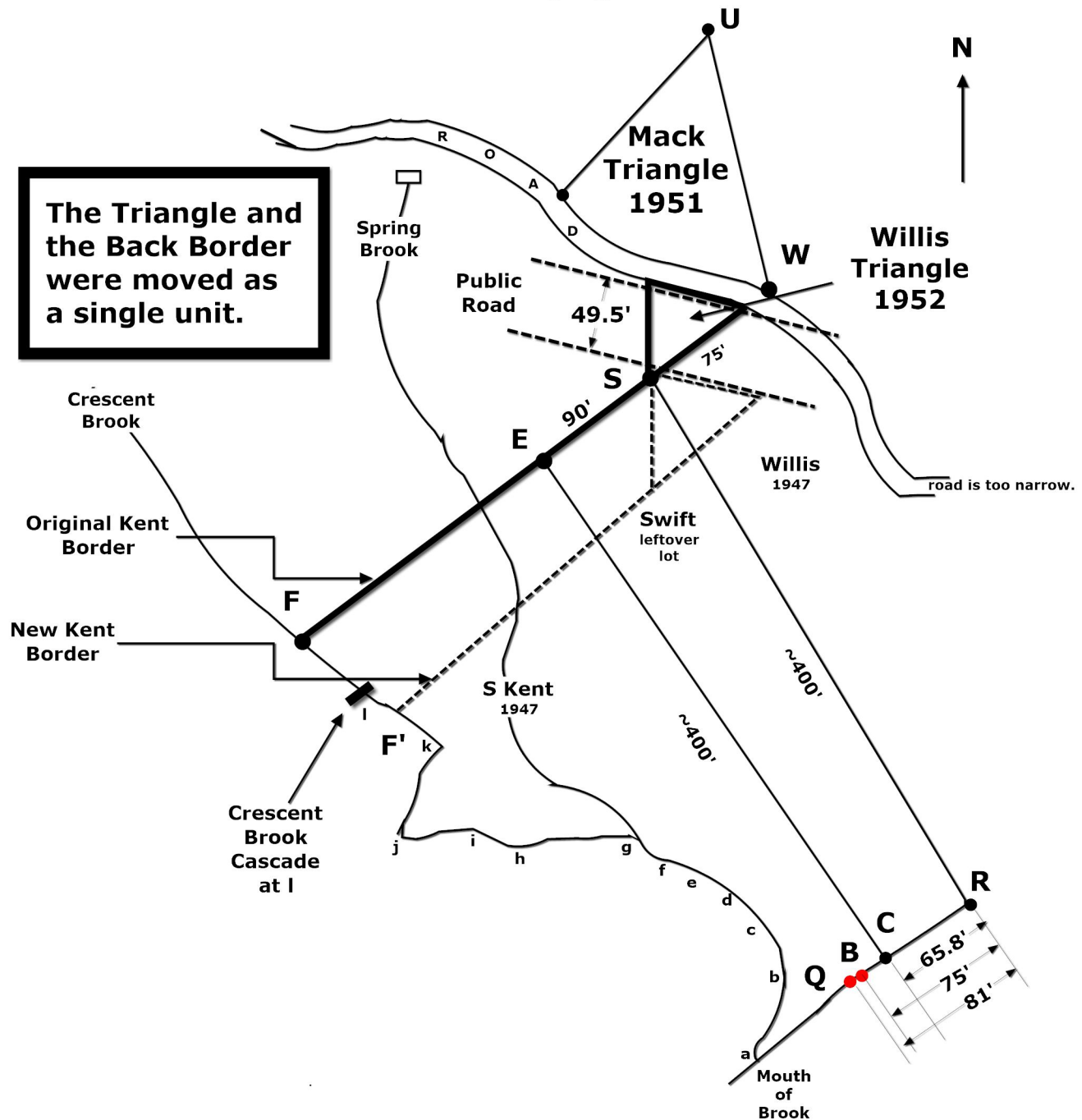

**Source of Dispute:** First, in 1952 Emerson Swift misplaced the Willis Triangle in the public road with the base between S and W. Next, on the 1970 Brown Map both the triangle and the back border were relocated with the peak of the triangle at Stake S. There was no justification for changing the location of the Kent back border. The relocation moved the Kent back border 60' closer to the beach. *The 1970 Brown Map and all Truline maps which are derivatives of the 1970 map are invalid.*