

How SFT Planned to Increase their Beach Frontage By 10 Feet

Diagram 5

- The 1921 Clough Map records 3 distances between "an Iron in a Boulder" and the brook: 169', 106' and 100'.
- It is mentioned in 3 Swift deeds: 1941 Book 18 Pages 33-34; 1988 Book 27 Page 322; 1990 Book 28 Page 378.
- The "Iron in a Boulder" disappeared from Swift property about 15-20 years ago; it served as a reference point.

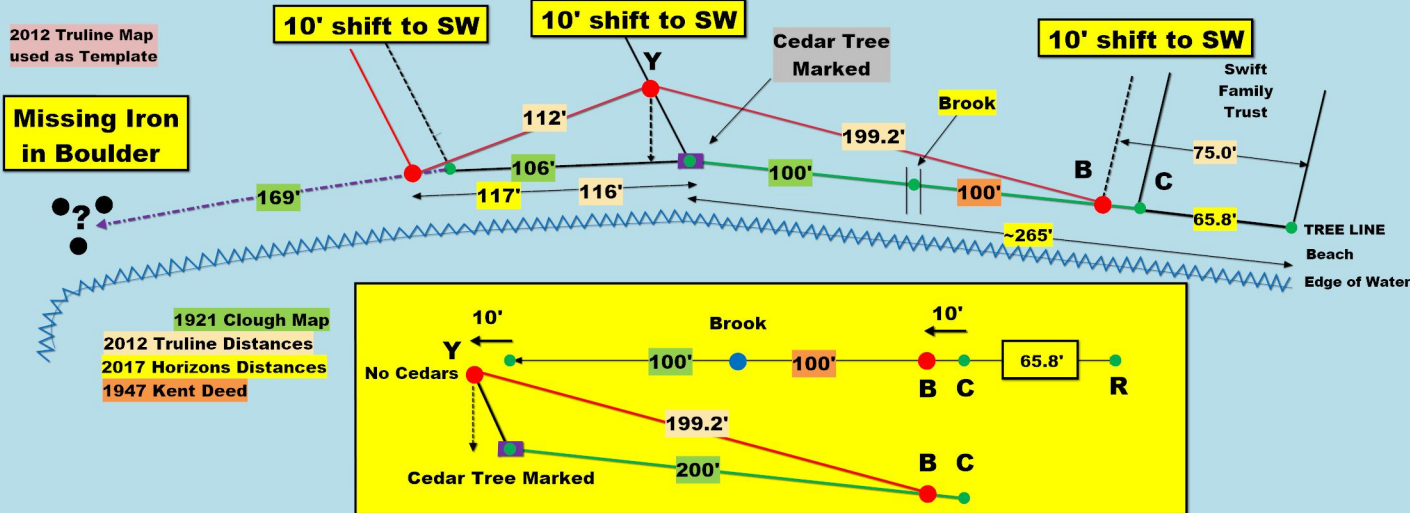

Transition from a Cedar Tree Marked to an Iron Stake

Deed Quotes: "along the sand beach 100 feet to a cedar tree, marked" changed in 1966 to an "iron stake." **Gavin Swift Family**

1941 Book 18 Pages 33-34 [cedar tree, marked]
 1966 Book 21 Page 325 [iron stake]
 1973 Book 23 Page 11 [iron stake]
 1973 Book 23 Page 12 [iron stake]
 1986 Book 27 Page 23 [iron stake] (painted yellow)

Deed Quotes: "along the shore 106 feet to a cedar tree, marked." **Other Swift Families**

1941 Book 18 Page 35 [cedar tree, marked]
 1964 Book 21 Page 184 [cedar tree, marked]
 1984 Book 26 Page 123 [cedar tree, marked]
 1995 Book 30 Page 212 [cedar tree, marked]

