

The Three Boundaries

1947 Swift Map

The Map Produces Two Sets of Boundary Lengths for FE and EC

Set I: approximated distances used in the 1947 Kent deed.

Set II: true distances confirmed by survey.

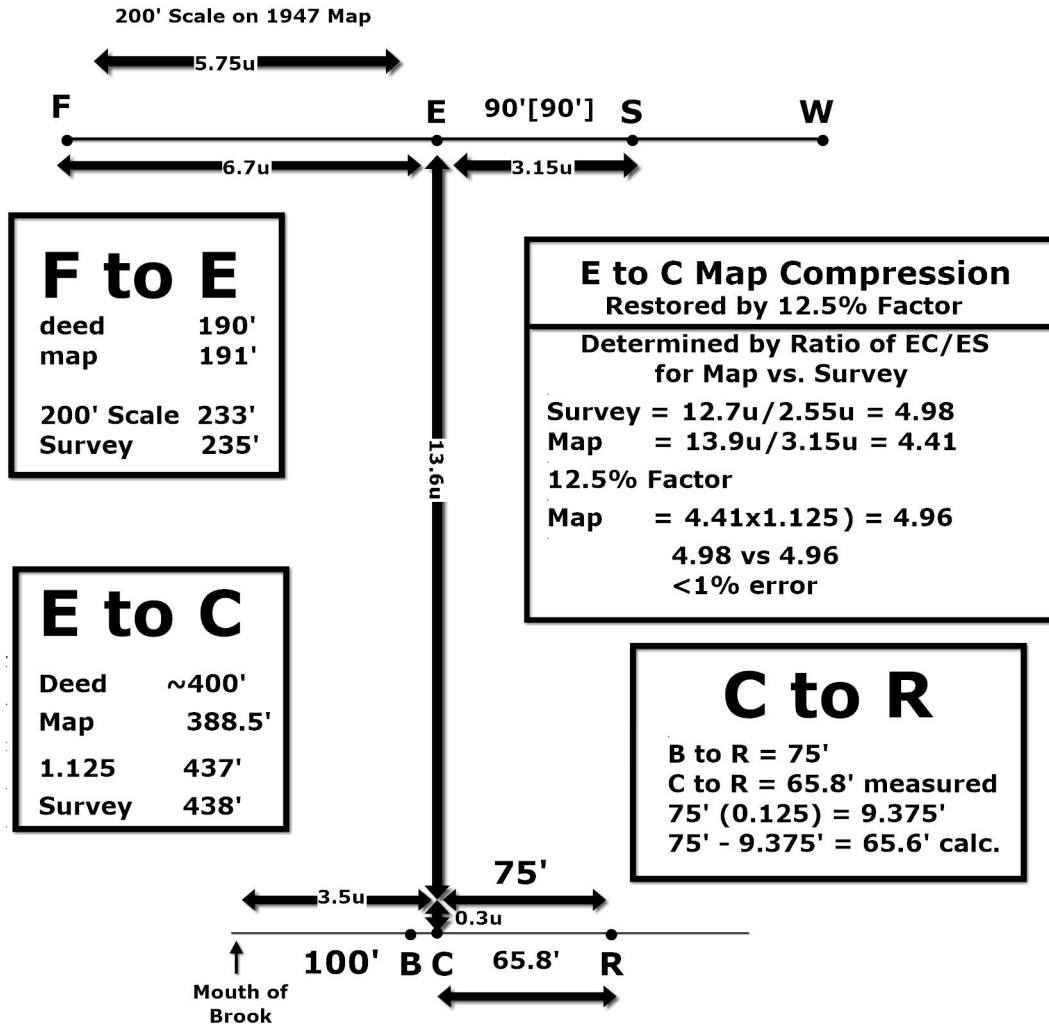

CALCULATIONS

| | | | |
|--------|----------------------------|---|---------|
| Beach | $[3.5/3.15][90']$ | = | 100' |
| E to F | $[6.7/3.15][90']$ | = | 191' |
| E to F | $[6.7/5.75][200']$ | = | 233' |
| C to D | $[13.6/3.15][90']$ | = | 388.56' |
| C to E | $[13.6/3.15][90'] [1.125]$ | = | 437' |

Diagram 8. The three Boundaries
16. Collection of Beach Diagrams 2-1947 Map
41- Court Arguments for Kent Property