

FOUR INDEPENDENT METHODS OF ANALYSIS THAT STAND ALONE TO ESTABLISH THE ORIGINAL KENT BACK BORDER AS FE

1. The Location of the Crescent Brook Cascade Establishes the Original Kent Back Boundary from F to E.

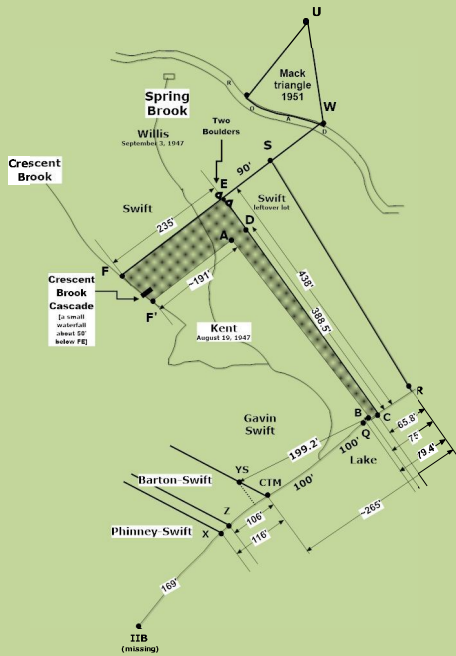

2. Distances from Above the Cascade Down the Brook to the Shoreline Pinpoint the Original Stake F.

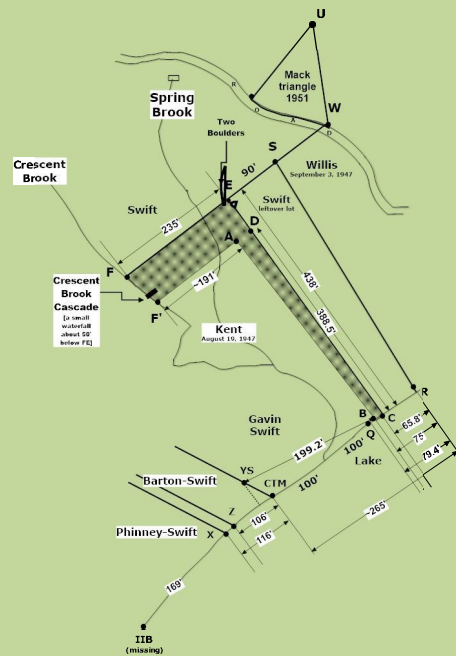

3. A Traverse from the 1970 Swift Deed Proves that the Kent Back Border was Deliberately Moved from FE to F'D

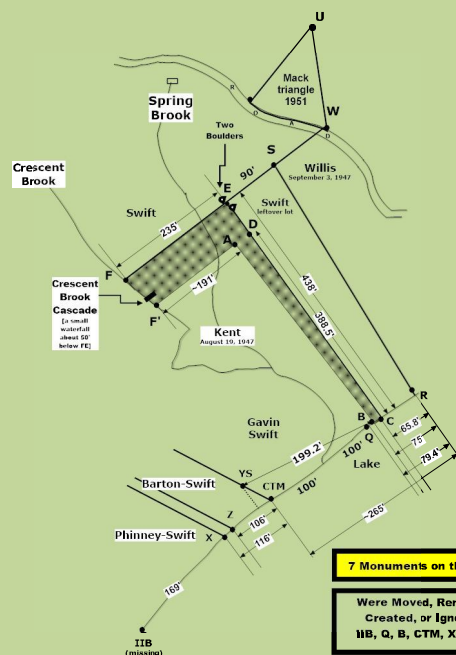

4. Emerson Swift knew the True Distances from F to E to C were 235' and 437' and Wrote False Distances in the Kent Deed.

