

## Bogus Monument G Reveals the Original Location of Stake F

### The Incriminating Paragraph

"...thence from said iron pipe down the brook 258 feet and thence continuing in a straight line near and approximately parallel with said brook 59 and five-tenths feet to an iron pipe driven into the ground [Stake G], said iron pipe being South 59 degrees East from where said *last mentioned boundary line* [Stake F] leaves the brook" ... [parenthetical information and emphasis added]

1970 Swift deed [Book 22, Page 291]

### 2017 Horizons Survey

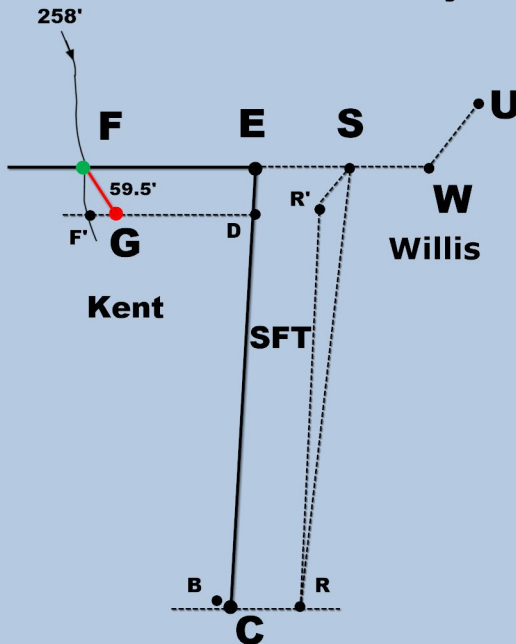

### Two independent paths localize the original stake F

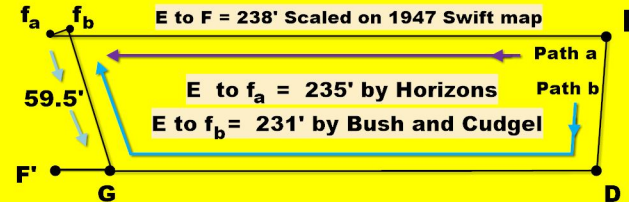

Using bearings and distances for ED [Horizons], DG and GF [Swift 1970 & 1971 deeds] the 1970 Swift deed [Book 22, 29'1] reveals that the Kent back border was deliberately lowered from EF to DF'.

2015 Traverse by Travis Sanders of Bush and Gudgell, Inc., St George, Utah

### Independent Measurements of F to E

EF = 235' from the 2014 Horizons Engineering Survey

EF = 238' scaled from the 1947 Swift map

EF = 231' from the 2015 Traverse by Bush and Gudgell, Inc. Travis Sanders  
In the 1947 Kent Deed Emerson Swift reported "approximately 190 feet".

EF = 235'  
Measured

EF = 238'  
Scaled

The 1970 deed says that G "was set". Since the distance between F and G was 59.5 feet, F was probably present in 1970 to measure that distance to a tenth of a foot. Both stakes are missing in 2014, and the section referring to the 59.5' is missing in the 2004 Tanner deed.