

Fiber Cement Rainscreens



Who is Eternit?

For over 100 years, Eternit has had a thriving legacy as the signature reference in fiber cement products. In the late 19th Century, Eternit's founder Ludwig Hatschek, succeeded in developing an entirely new material, which was destined to change the course of construction for generations. The new product was patented under the name "ETERNIT™" and served as the world's first light weight fiber cement format that combined water impermeability with high impact strength in a product that was both architectural and affordable.

Fiber cement is uniquely suited for a variety of exterior applications and most recently has been embraced as the ideal product for modern rainscreen design. From production to installation, Eternit is committed to providing natural, energy-efficient fiber cement products for contemporary rainscreen applications in North America and beyond.

As a category-leader, Eternit offers a varied and diverse collection of product series, colors, and format sizes for designers who hold a strong commitment to natural materials as the capstone of their architectural designs. From manufacture to delivery, the reputation of Eternit is one of reliability, product consistency and dependability.

CLADDING CORP



Eternit & Rainscreen

Made of natural raw materials, Eternit fiber cement rainscreens can be used in a variety of applications whether new construction or retrofit, commercial or residential. These non-flammable, frost resistant panels are both durable and workable in the field. When paired with a rainscreen wall design, Eternit fiber cement panels offer a maintenance-free system that is available at an exceptional value.



Inspired Sustainability

With the extensive Eternit product line, the demands of sustainable design are met in a fully engineered rainscreen package that is both architecturally inspiring and affordable.

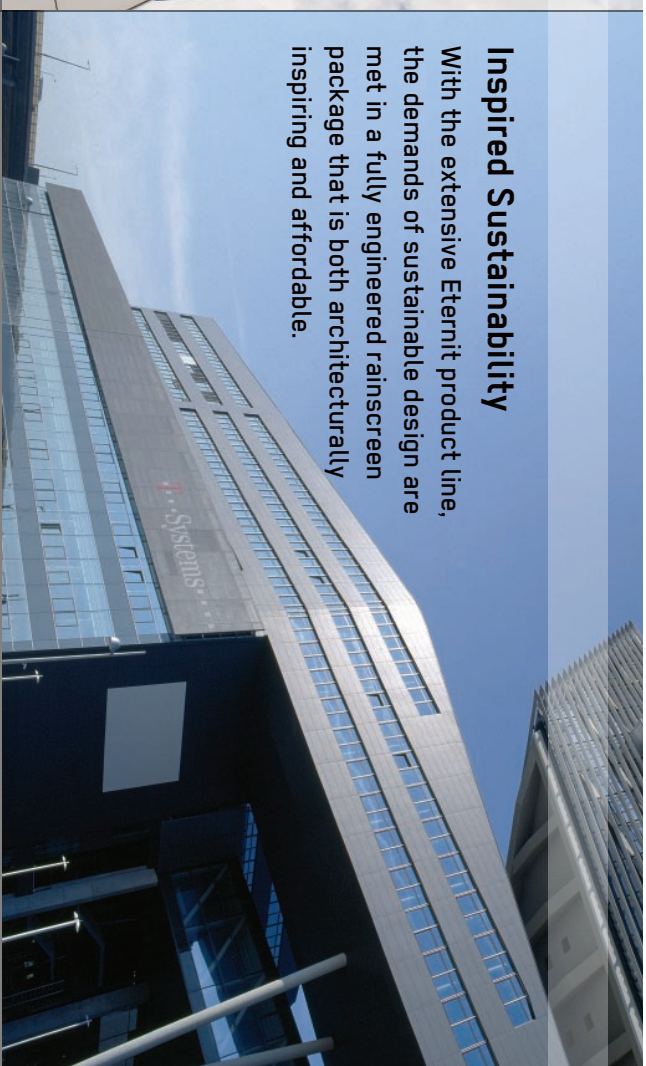

Why Eternit Rainscreens?

Light-Weight

Panels are less than 4 lbs per square foot

Frost Resistant

Ideal for a variety of climate locations

Fire Resistant

Uniquely suited for high-rise rainscreen applications

Impact Resistant

Tested and approved for high impact resistance

Workable

Panels are easily fabricated in the field

Maintenance-Free

There is no need for periodic maintenance or special coatings or sealants

Durable

Proven long-term durability in a variety of exterior cladding applications worldwide

Consistent

The reputation of Eternit is one of reliability, product consistency and dependability



Eternit

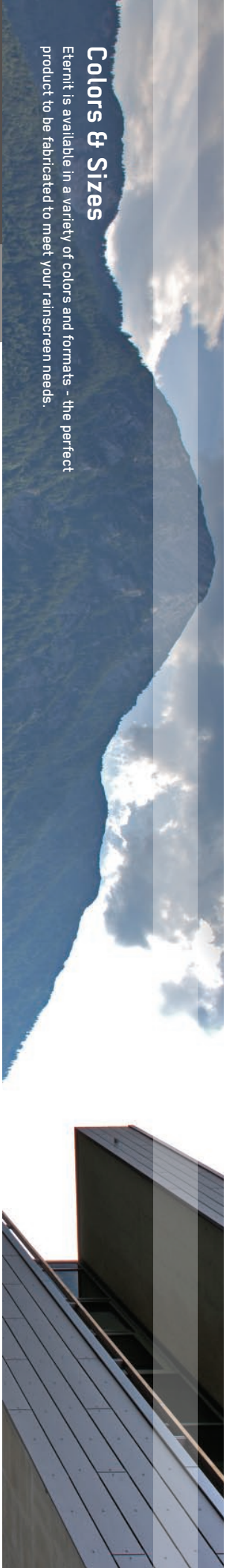

Colors & Sizes

Eternit is available in a variety of colors and formats - the perfect product to be fabricated to meet your rainscreen needs.

Classica

CLASSICA is Eternit's large format, full-bodied, through-color fiber cement cladding panel with either translucent or pigmented top layers. The pigment, which is matched to the natural character of the material, and the finely veined texture give the cladding panels different optical depths and vitality.

The living, structured nature and formal simplicity of these large format panels provides a high quality yet economical facade solution for designers who are committed to using natural materials for their rainscreen designs.

Choose your favorite combination from a multitude of formats and color variations and utilize the full creative potential of Classica's through-bodied product range.

CLADDING CORP

Core Colors

- Ivory
- Grey
- Black
- Red

Advanced Colors

- White
- Ivory
- Cream
- Buff
- Latte
- Light Grey
- Grey
- Stone
- Charcoal
- Black
- Volcano
- Sienna
- Red
- Deep Red

Natura

The NATURA series offers a high-quality, versatile fiber cement format in a wide variety of colors that is ideal for rainscreen design applications that call for a more modeled or natural fiber cement appearance. With a grey fiber cement inner core and a translucent stain on the outer surface, the NATURA format invites the natural fiber cement variation of the panel to be visible on the exterior surface. Given the fact that the panels are stained with a special laser color treatment, this series succeeds in boasting the living structure and creative depth unique to fiber cement.

ARKTIS	TUNDRA	SAHARA
1 2 3 4	1 2 3 4 5	1 2 3
HIMALAYA		
1 2 3 4 5		
SIENA		
1		

Tectura

The TECTURA series offers a wide range of modern colors for contemporary architectural design. These cladding panels serve as the most cost-effective fiber cement format available and are characterized by the striking statement of color that they make. With a grey inner core and an outer surface that is covered with a weather and light-resistant coating, the TECTURA series enhances modern rainscreen design with a full spectrum of vivid color.

TOPAS	SMARAGD	DIAMANT
A3 A4 B3 B4 C1 C2 C3 C4 E7	A2 A3 A4	C3 C4
RUBIN		
D4 D5 E4 E5		
AQUAMARIN		
B3 B4 C4 C5 E3 E5		

Please Note - For a true representation of any color from the Eternit color pallet, please request a sample.

Format Sizes

THICKNESS
8 mm (0.32")
12 mm (0.47")

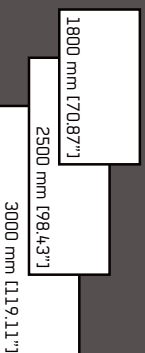

1210 mm (4'7.64")



For over 100 years, designers have been utilizing the creative potential of the unique properties of Eternit's fiber cement formats.



Composition of Fiber Cement

- A - 38.6% Binding Agents** - Portland cement
- B - 18.5% Air** - in the form of microscopic pores
- C - 16% Water** - serves to harden the cement paste even further (hydration) during the entire service life of the product
- D - 2.5% Reinforcement Fibers** - synthetic, organic fibers
- E - 11.4% Additives** - limestone particles, hardened and ground fiber cement (from the recycling process)
- F - 13% Process Fibers** - serve as filtering fibers during manufacture (primarily pulp fibers)

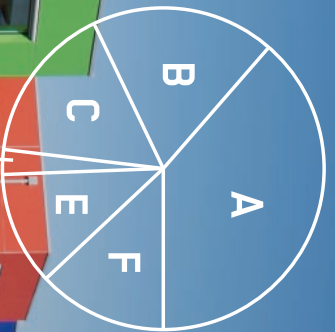

CLADDING CORP

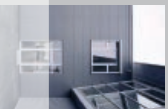
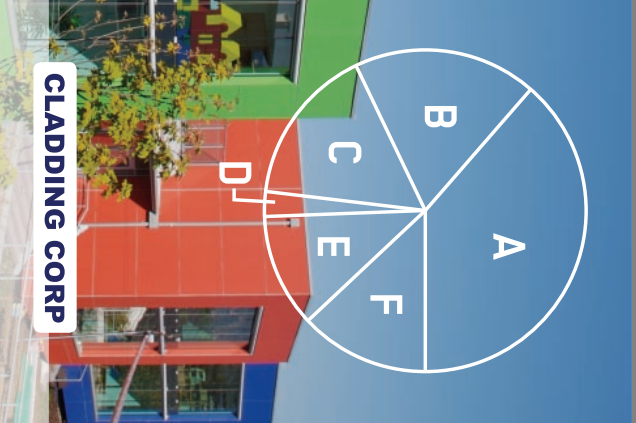

Attachment Systems



F2.10 SYSTEM

VISIBLE FIXING WITH RIVETS

Eternit panels can be installed efficiently using visible rivets or screws for vertical wall cladding applications. Installation is both straightforward and economical and the panels can come pre-drilled from the factory or can be fabricated on-site.

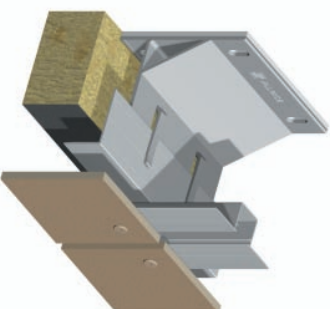

F1.40 SYSTEM

CONCEALED FIXING WITH UNDER-CUT ANCHORS

Eternit panels can also be fastened mechanically and concealed with the help of the KEL undercut anchoring system. Hanger elements are fastened to the back of the panels using the undercut anchors and the facade panel is fastened with at least four individual hanger elements. The hanger elements are then hung into place on a horizontal profile.

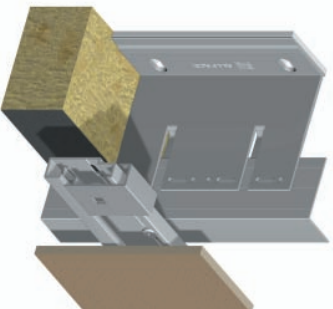

ALLFACE seeks to simplify the complexity of facade design and provide economical, technically efficient and intuitive fixing solutions for Eternit rainscreen cladding applications. Partnering with Cladding Corp in North America, the ALLFACE fixing solutions offer designers and contractors alike "project specific" support to facilitate modern architectural design with advanced engineered attachment solutions.



Eternit

About Us

Cladding Corp serves as North America's rainscreen solution provider. Our goal is to deliver the most innovative, sustainable and affordable European cladding materials to North America through our 'systems approach' to rainscreen cladding. We offer project-specific, fully-engineered attachment solutions that simplify the complexity of rainscreen design. This, coupled with our diverse portfolio of rainscreen façade products, enables us to provide you with one-stop-shopping for all your cladding needs.

WASHINGTON, DC
MIAMI, FL
SAN DIEGO, CA
WICHITA, KS

888.826.8453

info@claddingcorp.com
www.claddingcorp.com

CLADDING CORP

innovative rainscreen solutions

