



# COMMUNITY DENTAL CLINIC

*Dental Care for the Low-Income,  
Uninsured Adults of Pinellas County*



## *Your Smile. Your Health.* CAPITAL CAMPAIGN

The **Community Dental Clinic Capital Campaign** is an initiative to move the Clinic to a larger, easily accessible, expanded facility to further meet the dental health needs of our growing community. Our new facility will grow our urgent care program, expand dental specialty services, offer comprehensive dental services in house, provide continuum of care for those in need and host educational programs. The clinic will facilitate more doctors and staff through partnerships with institutions of higher learning, regional hospital systems and other community volunteers and programs. Our expansion is critical due to high costs of care, lack of dental coverage, and lack of integration between the health and dental health care systems. Those without dental health care suffering from active dental disease will have a pathway to better health.

*Join our campaign to support our move and continue to change  
thousands of lives in our community.*

# Our History

**2011**

- ▶ Collaboration of The Salvation Army, Clearwater Free Clinic and ARC launched plans for a no cost dental clinic

**2013**

- ▶ Opened for patients
- ▶ All volunteer staff
- ▶ \$19,896 in patient services
- ▶ 85 patient encounters

**2014**

- ▶ Partnership to provide hygiene staff and supplies

**2015**

- ▶ Pinellas County Health dentist 3 days per week

**2019**

- ▶ Grant funding for full time staff dentist
- ▶ Grant funding for staff members

**2020**

- ▶ Opened Carol's Corner soft food program

**2023**

- ▶ New Lab Technology
- ▶ Wounded Veterans Relief Fund Program

**10 YEARS**

**\$6.5 Million Patient Services**  
**14,865 Patient Encounters**

# “The Need”

## Oral Health is Critical to Overall Health and Well-Being

**#1 Unmet Need Nationwide**

Every 15 seconds in the US an individual visits the ER for dental care

**5,000+ Hospital ER Visits**

at local Pinellas County locations annually

**1 in 4 Adults**  
ages 20 to 64 currently have cavities

**46% of Florida Residents**  
have no dental insurance

**\$5 Million in Costs**  
for ER visits in Pinellas County annually

**Florida is #47 in the Nation**  
for access to dental care

**253,500 Residents Qualify\***

for services at the Community Dental Clinic out of a population of 956,615 in Pinellas County

\*Numbers are approximate and based on information from Florida Access to Dental & Pinellas County 2022

**45.8% of Floridians**  
over 18 years of age have permanent tooth loss

## Barriers to Dental Care

- ▶ Transportation
- ▶ No Insurance
- ▶ Ability to Pay
- ▶ Lack of Access to Dental Professionals

# Our Future

## Double the SPACE... Double the IMPACT!

- 1 Increase Urgent Care Program
- 2 Improved Patient Accessibility
- 3 Provide Dental Education & Community Programs
- 4 Expand Dental Lab & Sterilization Areas
- 5 Improve Health & Lifestyles

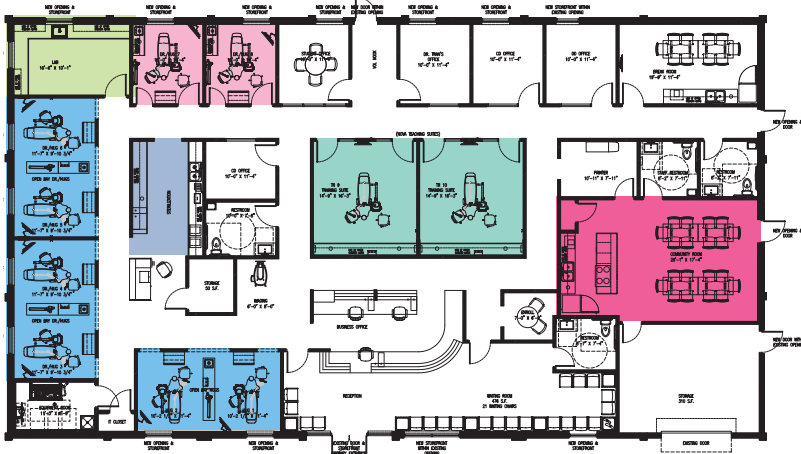

- Hygiene/Dental Treatment Rooms (6)
- Private Operator (2)
- Teaching/Specialty Dental Ops (2)
- Community Room
- Sterilization Area
- Lab Area



### CLINIC LEADERSHIP STAFF

Theresa White, Executive Director  
Boa-Tran Dao, DMD, Dental Director  
Annette Evans, Clinic Director

### BOARD OF TRUSTEES

Bruce Livingston, Chairman  
Rod Anthony, DMD, Vice Chairman  
John Fischer, Treasurer  
Linda Turley, Secretary  
Paul Umberg, Past President  
Patricia Barris  
Lee Ann Brown, DO, FAAPMR  
Lindsey Crown Hardee, CPS  
George Kostakis, DDS, PA  
William Layman, DMD, MBA  
David Rankin, Esq  
Jim Roble, CFP  
Dilshad Sumar-Lakhani, DMD, FASDC



## COMMUNITY DENTAL CLINIC

1008 Woodlawn St. North  
Clearwater, FL 33756

T: 727-216-6155 F: 727-216-6433  
[www.communitydentalclinic.net](http://www.communitydentalclinic.net)

