



LIBERTY COUNTY WATER CONTROL AND IMPROVEMENT DISTRICT NO. 1

**P.O BOX 1386
DAYTON, TX 77535
832-444-3935**

REQUEST FOR BID

March 16,2023 – April 14, 2023 @ 3:00 p.m.

**PROJECT: INSTALL AND WIDEN CULVERTS AT
CR 602 AND COFFEE SLEW DITCH, DAYTON, TX**

Liberty County Water Control & Improvement District #1 (LCWCIDI) will be accepting bid proposals for the above referenced project beginning March 16, 2023. Sealed bids must be received by no later than April 14, 2023, at 3:00 p.m. Bids received after this date and/or time will not be accepted and will not be opened. Project tentatively to start July 2023, after the Zaleski NS Ditch Project is complete and is expected to take approximately two weeks to complete depending on weather conditions and any other unforeseen issues.

The scope of this bid is to provide a quote for labor, material (*Note: Cost of material is to be included in quote but will be paid direct to supplier by LCWCID1 with their tax-exempt status*), and equipment to remove and dispose of the old culvert, replace with 10 — 6' x 8' 'x 8' concrete box culverts and widen the road to approximately forty feet as per the attached drawings.

Please note that all contractors/subcontractors/suppliers whose System for Award Management (SAM.gov) registration is not active or that are debarred, suspended, or otherwise excluded from or ineligible for participation on federal assistance programs may not undertake any activity in part or in full under this project.

Key components of this project are to include the following with labor, material, and equipment:

- 1.) Remove existing culvert and associate materials. Note: Disposal to be determined by LCWCIDI).
- 2.) Excavate to widen and install culverts per attached Drwg. No. 2022-1206-1.
Note: Disposal of spoils to be determined by LCWCIDI.
- 3.) Install Stabilized Bedding Material for box culverts.
- 4.) Install 10— 6' x 8' x 8' concrete box culverts. *Note: Culverts to be supplied by LCWCIDI.*
- 5.) Back fill culverts with compacted stabilized material (include in quote).
Note: Material will be paid direct to supplier by LCWCIDI.
- 6.) Install bulkheads reinforced with 5/8" rebar on 12" centers with weir plate on concrete pad (include in quote). *Note: Concrete to be paid direct to supplier by LCWCIDI.*
- 7.) Install compacted stabilized road base (include in quote).
Note: Material to be paid direct to supplier by LCWCIDI.
- 8.) Install 3" asphalt cap.

Proof of General Liability insurance is required at signing with an executed W-9. LCWCIDI is a **tax-exempt** organization and will provide tax information. If you are interested in submitting a bid, contact Leonard Vyoral, 832-444-3935 for Bid Package or access on the LCWCID1 website at lcwcid1@info.com under the forms tab.

Completed bids should be mailed in a sealed envelope before April 14, 2023, at 3:00 p.m. to:

Liberty County Water Control & Improvement District #1
P.O. Box 1386
Dayton, Texas 77535
Attn: Leonard Vyoral

Label envelope as follows:

BID SUBMISSION
PROPOSED COFFEE SLEW CULVERT REPLACEMENT AT CR 602

We appreciate your consideration of this bid and look forward to working with you. Please contact Leonard Vyoral, 832-444-3935, for any questions regarding the scope of the project, specs, location or concerns you may have.

Respectfully,

LEONARD VYORAL

Leonard Vyoral, President
Liberty County Water Control &
Improvement District No. 1

Attachment — 2 Pages Drawings

SCENARIO FOR BIDS

All bids must be received by the deadline indicated above. Bids should include all requested work items, conform to the project standards/specifications of the attached drawings follow the LCWCID1 DRAINAGE CRITERIA MANUAL located on the LCWCID1 website lcwcid1@info.com, and be responsive, accurate, and cost reasonable. Contractors, subcontractors, and vendors must have a SAMS number. Those whose System for Award Management (SAM.gov) registration is not active or have been debarred, suspended, or otherwise excluded from or ineligible for participation on federal assistance programs may not undertake any activity in part or in full under this project. Bids will be held for a period not to exceed 30 days from the date of the bid opening for the purpose of reviewing the bids and investigating the bidder's qualifications prior to the contract award. Bids will be reviewed by Leonard Vyoral and presented to the LCWCID1 Board of Directors for consideration and approval. LCWCIDI will select the contractor to perform all work required and upon approval a contract will be executed between LCWCIDI and the contractor. In the event additional or deletion of any work or material occurs these items shall be listed on a separate quote/document to be considered separately from the base bid and consideration of any changes will be negotiated with LCWCIDI at that time. Your bid should be inclusive of all fees, permits and all other applicable costs. Upon selection of a contractor and before any work can begin, LCWCIDI will contact you and will advise you of a date, time, and location for a pre-work meeting to take place with Leonard Vyoral and selected members of the Board of Directors to review the bid and the terms of the contract prior to the start of the project. At this meeting, it will be determined when the project will begin, the necessary prep for the location which, includes notification of local authorities of road closure and the proposed length of the work

TABLE OF DIMENSIONS AND REINFORCING STEEL
(Wings for one structure only)

Maximum Wingwall Height (Hw)	Dimensions			Variable Reinforcing			Estimated Quantities of wing length (2-wings)
	W	X	Y	Bars J1	Bars J2	Spa	
2'-0"	1'-0"	0"	7"	#4 1-0"	#4 1-0"	33.73	0.248
2'-5"	1'-0"	0"	7"	#4 1-0"	#4 1-0"	37.07	0.261
3'-0"	1'-0"	0"	7"	#4 1-0"	#4 1-0"	37.74	0.273
4'-0"	1'-0"	0"	7"	#4 1-0"	#4 1-0"	38.41	0.285
5'-0"	1'-0"	0"	7"	#4 1-0"	#4 1-0"	41.75	0.340
6'-0"	1'-0"	0"	7"	#4 1-0"	#4 1-0"	45.75	0.355
7'-0"	1'-0"	0"	7"	#4 1-0"	#4 1-0"	46.42	0.367
8'-0"	1'-0"	0"	7"	#4 1-0"	#4 1-0"	52.77	0.414
9'-0"	1'-0"	0"	7"	#4 1-0"	#4 1-0"	60.19	0.486
10'-0"	1'-0"	0"	7"	#4 1-0"	#4 1-0"	61.49	0.535
11'-0"	1'-0"	0"	7"	#4 1-0"	#4 1-0"	97.25	0.634
12'-0"	1'-0"	0"	7"	#4 1-0"	#4 1-0"	133.65	0.634
13'-0"	1'-0"	0"	7"	#4 1-0"	#4 1-0"	162.29	0.721
14'-0"	1'-0"	0"	7"	#4 1-0"	#4 1-0"	178.80	0.856
15'-0"	1'-0"	0"	7"	#4 1-0"	#4 1-0"	216.78	0.959
16'-0"	1'-0"	0"	7"	#4 1-0"	#4 1-0"	283.06	1.068
						297.02	1.234

TABLE OF ESTIMATED QUANTITIES
(2-wings)

Bar	Size	No.	Spa
D	#5	1	1-0"
E	#4	1	1-0"
F	#4	1	1-0"
G	#6	4	-
H	#4	4	-
I	#4	1	1-0"
J	#5	6	-
K	#4	1	1-0"
L	#4	1	1-0"
M	#4	1	1-0"
N	#4	1	1-0"
O	#4	1	1-0"
P	#4	1	1-0"
Q	#4	1	1-0"
R	#4	1	1-0"
S	#4	1	1-0"
T	#4	1	1-0"
U	#4	1	1-0"
V	#4	1	1-0"
W	#4	1	1-0"
X	#4	1	1-0"
Y	#4	1	1-0"
Z	#4	1	1-0"
AA	#4	1	1-0"
AB	#4	1	1-0"
AC	#4	1	1-0"
AD	#4	1	1-0"
AE	#4	1	1-0"
AF	#4	1	1-0"
AG	#4	1	1-0"
AH	#4	1	1-0"
AI	#4	1	1-0"
AJ	#4	1	1-0"
AK	#4	1	1-0"
AL	#4	1	1-0"
AM	#4	1	1-0"
AN	#4	1	1-0"
AO	#4	1	1-0"
AP	#4	1	1-0"
AQ	#4	1	1-0"
AR	#4	1	1-0"
AS	#4	1	1-0"
AT	#4	1	1-0"
AU	#4	1	1-0"
AV	#4	1	1-0"
AW	#4	1	1-0"
AX	#4	1	1-0"
AY	#4	1	1-0"
AZ	#4	1	1-0"
BA	#4	1	1-0"
BB	#4	1	1-0"
BC	#4	1	1-0"
BD	#4	1	1-0"
BE	#4	1	1-0"
BF	#4	1	1-0"
BG	#4	1	1-0"
BH	#4	1	1-0"
BI	#4	1	1-0"
BJ	#4	1	1-0"
BK	#4	1	1-0"
BL	#4	1	1-0"
BM	#4	1	1-0"
BN	#4	1	1-0"
BO	#4	1	1-0"
BP	#4	1	1-0"
BQ	#4	1	1-0"
BR	#4	1	1-0"
BS	#4	1	1-0"
BT	#4	1	1-0"
BU	#4	1	1-0"
BV	#4	1	1-0"
BW	#4	1	1-0"
BX	#4	1	1-0"
BY	#4	1	1-0"
BZ	#4	1	1-0"
CA	#4	1	1-0"
CB	#4	1	1-0"
CC	#4	1	1-0"
CD	#4	1	1-0"
CE	#4	1	1-0"
CF	#4	1	1-0"
CG	#4	1	1-0"
CH	#4	1	1-0"
CI	#4	1	1-0"
CJ	#4	1	1-0"
CK	#4	1	1-0"
CL	#4	1	1-0"
CM	#4	1	1-0"
CN	#4	1	1-0"
CO	#4	1	1-0"
CP	#4	1	1-0"
CQ	#4	1	1-0"
CR	#4	1	1-0"
CS	#4	1	1-0"
CT	#4	1	1-0"
CU	#4	1	1-0"
CV	#4	1	1-0"
CW	#4	1	1-0"
CX	#4	1	1-0"
CY	#4	1	1-0"
CZ	#4	1	1-0"
DA	#4	1	1-0"
DB	#4	1	1-0"
DC	#4	1	1-0"
DD	#4	1	1-0"
DE	#4	1	1-0"
DF	#4	1	1-0"
DG	#4	1	1-0"
DH	#4	1	1-0"
DI	#4	1	1-0"
DJ	#4	1	1-0"
DK	#4	1	1-0"
DL	#4	1	1-0"
DM	#4	1	1-0"
DN	#4	1	1-0"
DO	#4	1	1-0"
DP	#4	1	1-0"
DQ	#4	1	1-0"
DR	#4	1	1-0"
DS	#4	1	1-0"
DT	#4	1	1-0"
DU	#4	1	1-0"
DV	#4	1	1-0"
DW	#4	1	1-0"
DX	#4	1	1-0"
DY	#4	1	1-0"
DZ	#4	1	1-0"
EA	#4	1	1-0"
EB	#4	1	1-0"
EC	#4	1	1-0"
ED	#4	1	1-0"
EE	#4	1	1-0"
EF	#4	1	1-0"
EG	#4	1	1-0"
EH	#4	1	1-0"
EI	#4	1	1-0"
EJ	#4	1	1-0"
EK	#4	1	1-0"
EL	#4	1	1-0"
EM	#4	1	1-0"
EN	#4	1	1-0"
EO	#4	1	1-0"
EP	#4	1	1-0"
EQ	#4	1	1-0"
ER	#4	1	1-0"
ES	#4	1	1-0"
ET	#4	1	1-0"
EU	#4	1	1-0"
EV	#4	1	1-0"
EW	#4	1	1-0"
EX	#4	1	1-0"
EY	#4	1	1-0"
EZ	#4	1	1-0"
FA	#4	1	1-0"
FB	#4	1	1-0"
FC	#4	1	1-0"
FD	#4	1	1-0"
FE	#4	1	1-0"
FF	#4	1	1-0"
FG	#4	1	1-0"
FH	#4	1	1-0"
FI	#4	1	1-0"
FJ	#4	1	1-0"
FK	#4	1	1-0"
FL	#4	1	1-0"
FM	#4	1	1-0"
FN	#4	1	1-0"
FO	#4	1	1-0"
FP	#4	1	1-0"
FQ	#4	1	1-0"
FR	#4	1	1-0"
FS	#4	1	1-0"
FT	#4	1	1-0"
FU	#4	1	1-0"
FV	#4	1	1-0"
FW	#4	1	1-0"
FX	#4	1	1-0"
FY	#4	1	1-0"
FZ	#4	1	1-0"
GA	#4	1	1-0"
GB	#4	1	1-0"
GC	#4	1	1-0"
GD	#4	1	1-0"
GE	#4	1	1-0"
GF	#4	1	1-0"
GG	#4	1	1-0"
GH	#4	1	1-0"
GI	#4	1	1-0"
GJ	#4	1	1-0"
GK	#4	1	1-0"
GL	#4	1	1-0"
GM	#4	1	1-0"
GN	#4	1	1-0"
GO	#4	1	1-0"
GP	#4	1	1-0"
GQ	#4	1	1-0"
GR	#4	1	1-0"
GS	#4	1	1-0"
GT	#4	1	1-0"
GU	#4	1	1-0"
GV	#4	1	1-0"
GW	#4	1	1-0"
GX	#4	1	1-0"
GY	#4	1	1-0"
GA	#4	1	1-0"
GB	#4	1	1-0"
GC	#4	1	1-0"
GD	#4	1	1-0"
GE	#4	1	1-0"
GF	#4	1	1-0"
GG	#4	1	1-0"
GH	#4	1	1-0"
GI	#4	1	1-0"
GJ	#4	1	1-0"
GK	#4	1	1-0"
GL	#4	1	1-0"
GM	#4	1	1-0"
GN	#4	1	1-0"
GO	#4	1	1-0"
GP	#4	1	1-0"
GQ	#4	1	1-0"
GR	#4	1	1-0"
GS	#4	1	1-0"
GT	#4	1	1-0"
GU	#4	1	1-0"
GV	#4	1	1-0"
GW	#4	1	1-0"
GX	#4	1	1-0"
GY	#4	1	1-0"
GA	#4	1	1-0"
GB	#4	1	1-0"
GC	#4	1	1-0"
GD	#4	1	1-0"
GE	#4	1	1-0"
GF	#4	1	1-0"
GG	#4	1	1-0"
GH	#4	1	1-0"
GI	#4	1	1-0"
GJ	#4	1	1-0"
GK	#4	1	1-0"
GL	#4	1	1-0"
GM	#4	1	1-0"
GN	#4	1	1-0"
GO	#4	1	1-0"
GP	#4	1	1-0"
GQ	#4	1	1-0"
GR	#4	1	1-0"
GS	#4	1	1-0"
GT	#4	1	1-0"
GU	#4	1	1-0"
GV	#4	1	1-0"
GW	#4	1	1-0"
GX	#4	1	1-0"
GY	#4	1	1-0"
GA	#4	1	1-0"
GB	#4	1	1-0"
GC	#4	1	1-0"
GD	#4	1	1-0"
GE	#4	1	1-0"
GF	#4	1	1-0"
GG	#4	1	1-0"
GH	#4	1	1-0"
GI	#4	1	1-0"
GJ	#4	1	1-0"
GK	#4	1	1-0"
GL	#4	1	1-0"
GM	#4	1	1-0"
GN	#4	1	1-0"
GO	#4	1	1-0"
GP	#4	1	1-0"
GQ	#4	1	1-0"
GR	#4	1	1-0"
GS	#4	1	1-0"
GT	#4	1	1-0"
GU	#4	1	1-0"
GV	#4	1	1-0"
GW	#4	1	1-0"
GX	#4	1	1-0"
GY	#4	1	1-0"
GA	#4	1	1-0"
GB	#4	1	1-0"
GC	#4	1	1-0"
GD	#4	1	1-0"
GE	#4	1	1-0"
GF	#4	1	1-0"
GG	#4	1	1-0"
GH	#4	1	1-0"
GI	#4	1	

CULVERT REPLACEMENT PROPOSAL

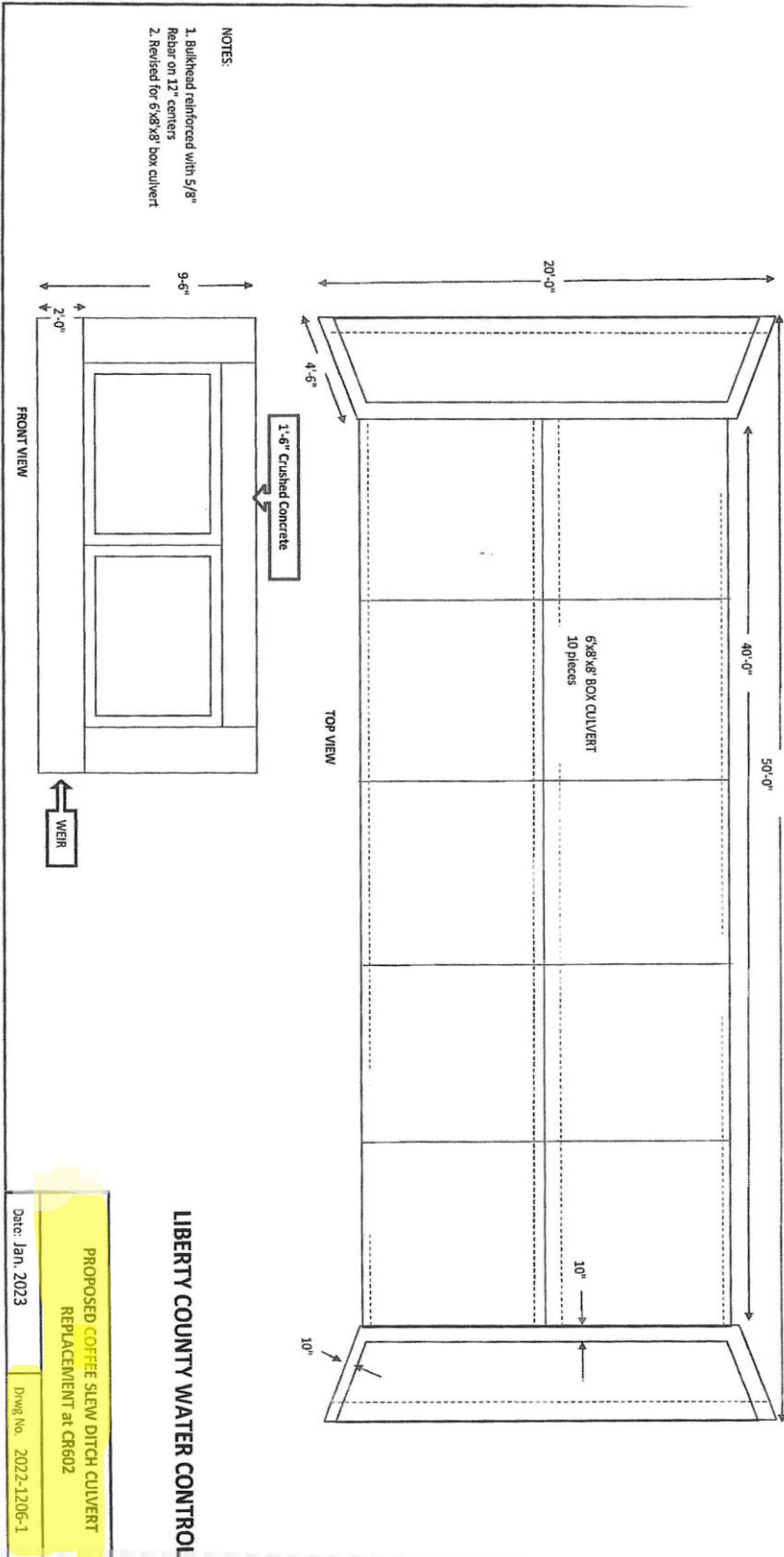
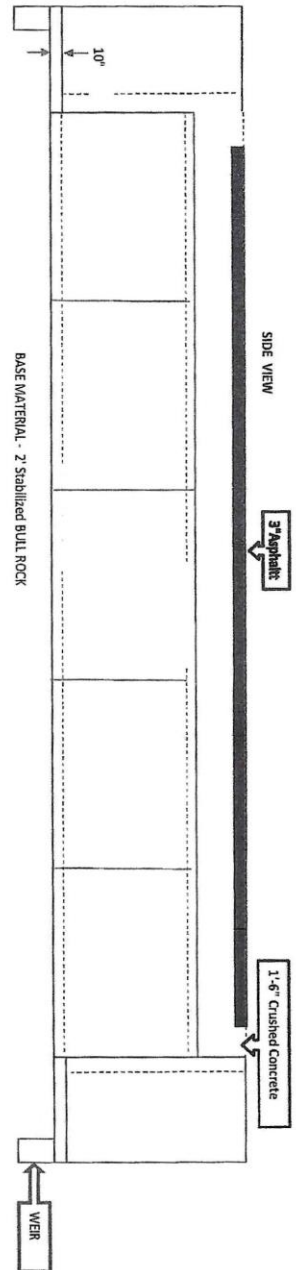
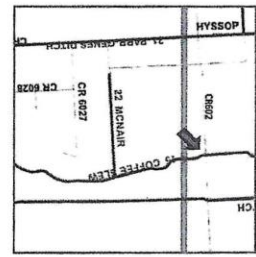

- NOTES:
1. Bulkhead reinforced with 5/8" Rebar on 12" centers
 2. Revised for 6'x8'x8" box culvert

LIBERTY COUNTY WATER CONTROL

PROPOSED COFFEE SLEW DITCH CULVERT REPLACEMENT at CR602

Date: Jan, 2023

Dwg No. 2022-1206-1