

Tribeca

C A B I N E T R Y

Brouchure 2024



Affordable Luxury



Tribeca

C A B I N E T R Y

Brochure 2024



■ About Our Company



- Door Collection
- Hudson Door Style Gallery
- Soho Door Style Gallery
- Southampton Door Style Gallery
- Our Advantage
- Construction

The kitchen is the heart of the home and it is our belief that kitchens should be fashion forward, stylish and contemporary while still being an excellent value. This is why every aspect of our products, from the design and engineering to the manufacturing process utilized at our state-of-the-art facility, was carefully considered. Our cabinetry features superior construction specifications, elevated furniture grade finishes and modern design flourishes all at an unbeatable price point and lightning-fast lead time. New for this year are our White Rift Oak products, which undergo wire-brushing for texture and warmth, and are a stellar example of the quality, style and design inherent in our brand.

Door Collection

Door Styles

Hudson Door Style



The Hudson door is polished, contemporary and sensible. Featuring classic shaker styling, the door comes in a variety of finishes that offer enduring appeal. Solid wood door frame with mortise and tenon assembly. MDF center panel. Cloud White & White Rift Oak feature an MDF door frame and center panel with mortise and tenon assembly.

Soho Door Style



Our Soho door is a modern take on classic shaker styling. The distinct bevel inside the door frame adds elegance and interest. Due to its clean lines and enduring appeal, it can utilized in traditional or contemporary settings. Solid wood door frame with mortise and tenon assembly. MDF center panel.

Southampton Door Style



The Southampton is minimalist and polished, with a slender frame and clean lines; Southampton is a shaker style re-imagined for modern spaces. Solid wood door frame with mortise and tenon assembly. MDF center panel.

Finishes

Hudson Door Style



Snow White Hearthstone White Rift Oak Cloud White

Soho Door Style



Snow White Empire Blue

Southampton Door Style



Snow White White Rift Oak

Hudson Door Style Gallery

Hudson Door Style Snow White

The Hudson Snow White line contributes to a chic and contemporary modern kitchen, highlighting its timeless appeal. Optimize the crisp lines and bright aesthetic by integrating metal accents and warm wood tones, further enhancing the overall design of your kitchen.



Hudson Door Style Gallery



Snow
White



Hudson Door Style Gallery

Hudson Door Style Heartstone



An understated and fashionable gray with just a hint of blue to add interest, Heartstone is a transitional neutral that creates expansive and fashion forward spaces. Pair with soft blues, grays and whites to perfect the look.

Hudson Door Style Gallery

Hudson Door Style Cloud White

Give your kitchen a modern refresh with Cloud White, our latest color. This soft white tone is an excellent choice for spaces adorned with neutral palettes, adding a touch of sophistication and versatility. To bring in warmth and character, consider pairing Cloud White with White Rift Oak to introduce beautiful wood tones into your kitchen cabinets.

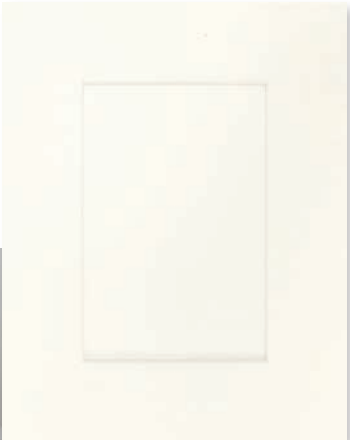



Hudson Door Style Gallery

Hudson Door Style White Rift Oak

White Rift Oak x Cloud White



Modern, natural and warm, our White Rift Oak cabinets on the Hudson door are the epitome of luxury. First, veneers are meticulously selected and then rift cut to accentuate the linear grain prevalent in the wood. Then the pieces are wire-brushed which involves hand-scraping the wood with a metal brush to reveal the soft grain from the growth ring of the tree.



Soho Door Style Gallery

Soho Door Style Snow White

Our Soho door is a contemporary masterpiece that breathes new life into classic shaker styling. Featuring a clean bevel on the inside of the door frame, the Soho door will make quite the impression in any space. Experience a perfect fusion of modern design and classic charm.



Soho Door Style Gallery



Soho Door Style Gallery



Soho Door Style Snow White x Empire Blue

Enhance your living space with the distinct appeal of our Soho Empire Blue and Snow White selections. The fusion of rich shades of blue and white results in a well-balanced and carefully crafted aesthetic for your kitchen. The interplay between these colors not only grabs attention but also infuses a feeling of harmony and style into the space. Thoughtfully curated, this combination guarantees that your kitchen exudes a fashionable and unified atmosphere, making it an outstanding choice for those seeking a classic and tasteful kitchen design.



White Rift Oak

■ Real American White Oak Hardwood and Veneer:

We exclusively use authentic North American White Oak lumber and veneers, and all our White Oak products are proudly FSC-certified. Sustainability is at the heart of what we do, making this certification a vital part of our commitment to the environment.



Southampton Door Style Gallery

Southampton Door Style Snow White

Minimalist and polished, with a slender frame and clean lines, Southampton is shaker style re-imagined for modern spaces.



Southampton Door Style Gallery



Southampton Door Style White Rift Oak



The inherent quality of our Southampton White Rift Oak is eloquently manifested in the meticulous design of this kitchen. The choice of light oak flooring ensures a judicious balance, complementing the door panels with a nuanced interplay of wood grain patterns, offering a visually captivating experience. The strategic arrangement of varied light sources orchestrates a layered narrative, guiding observers through the space seamlessly. The pendant light above the island serves as a focal point, establishing a refined ambiance that resonates with the subtle brown tones in the white marble countertop, creating a harmonious dialogue with the intricate veining patterns shared between the marble and the White Rift Oak. The deliberate positioning of small lights serves to illuminate every facet, unveiling the intricate details and tonal richness of the White Rift Oak. Notably, the discreet integration of White Rift Oak door panels conceals the hood, ensuring a harmonious aesthetic of visual discord.

Southampton Door Style Gallery

Southampton Door Style Snow White x White Rift Oak



The pairing of our Southampton Snow White and White Rift Oak is a natural synergy. The cool-toned metal accents against Snow White and the gold metal details within the White Rift Oak, grain harmonize every detail in the kitchen design, providing both individual coherence and overall richness. The Snow White door panels define a space with simplicity, while the White Rift Oak infuses a natural ambiance into the modern kitchen design, seamlessly blending with the outdoor scenery. In such a kitchen, one feels as if immersed in nature. The white ambient lighting imparts a sense of openness, while the pendant light above the island, with its yellow-veined interior, adds depth to the simple design, accentuating the warm wood grain of the White Rift Oak.



Southampton Door Style Gallery



Our Advantage



■ Quality Lumber

We select quality lumber specifically for our cabinets, ensuring that our products are dependable and can be enjoyed for many years to come. It provides a solid foundation for various kitchen projects, bathroom projects, and other crafting endeavors, ensuring long-lasting, visually pleasing, and reliable results. The precision milling and dimensioning of quality lumber make it easier to work with during cabinet construction or other relevant projects.

■ Uncompromising Finish

Once we select premium quality lumber, we meticulously match and sand each piece. The material then undergoes a multi-step finishing process that ends with the application of a catalyzed conversion topcoat to prevent scratching and improve longevity. During every stage of the manufacturing process, our products undergo a thorough evaluation to guarantee that the end product is immaculate.



■ Superior Construction

Every cabinet we produce features dovetail construction and is built to last. First, premium quality plywood side panels interlock with the solid wood face frame through matching dovetail grooves. Then, a solid half-inch piece of plywood is utilized for the back to ensure stability and a long-lasting structure. Finally, wood corner braces are screwed into plywood beams to tie the entire structure together.

■ Ever-lock Shelf

Our solid plywood shelves are designed with durability in mind and will never move from their desired location due to our ever-lock system. This system features stainless steel clips that lock into pre-drilled holes in the bottom of the shelf. This prevents movement and ensures the sturdiness of the shelf and overall structure of the cabinet.



■ Fluid Movements

Smooth-closing doors and drawers come standard on every cabinet we manufacture. Our compact hinges are adjustable and feature impeccable functionality while our full-extension drawers maximize storage and feature gentle but fluid motion.

■ Transitional Full Overlay Design

Our transitional full overlay doors almost completely cover the face frame and create a pristine and clean appearance.



Construction

Wall Cabinet Specifications

- 1. **Back** - 1/2" veneered plywood with UV natural finish.
- 2. **Top** - 1/2" veneered plywood with natural UV finish.
- 3. **Face Frame** - 3/4" solid wood.
- 4. **Door** - 3/4" five piece solid wood frame with MDF center panel based on selected style.
- 5. **Shelf** - 3/4" veneered plywood adjustable shelf with UV natural finish and edge banding. Stainless steel shelf clips lock into pre-drilled holes in the bottom of the shelf for support.
- 6. **Side Panel** - 1/2" veneered plywood with UV finish.
- 7. **Concealed Hinge** - 6 way adjustable soft close hinge.
- 8. **Bottom** - 1/2" veneered plywood with UV finish.

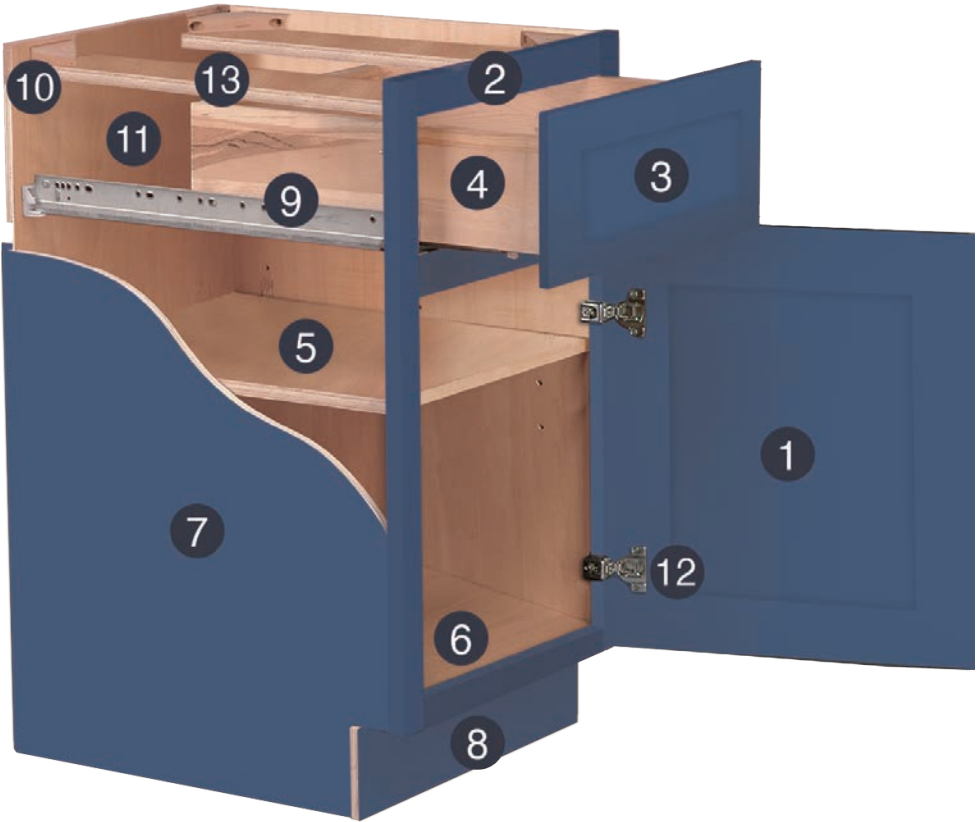
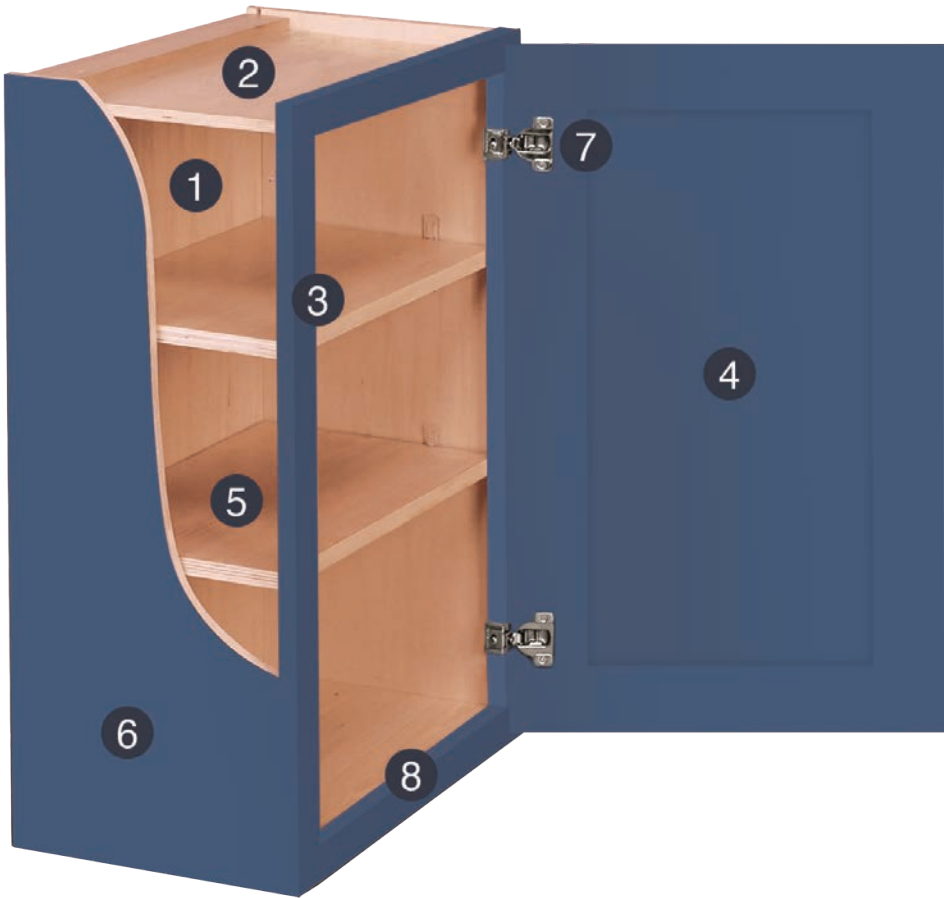

Base Cabinet Construction

- 1. **Door** - 3/4" five piece solid wood frame with MDF center panel based on selected style.
- 2. **Face Frame** - 3/4" solid wood face frame.
- 3. **Drawer Face** - 3/4" five piece solid wood frame with MDF center panel based on selected style.
- 4. **Drawer** - 3/4" dovetailed solid wood drawer with soft close slides.
- 5. **Shelf** - 3/4" full depth veneered shelves adjustable shelf with UV natural finish and edge banding. Stainless steel shelf clips lock into pre-drilled holes in the bottom of the shelf for support.
- 6. **Side Panel** - 1/2" veneered plywood with UV finish.
- 7. **Side Panel** - 1/2" veneered plywood with UV natural finish.
- 8. **Toe Kick** - 1/2" matching veneered plywood toe kick.
- 9. **Drawer Slide Options** - Undermount full extension soft close slides.
- 10. **Corner Support** - Wood corner supports for added stability and structural support.
- 11. **Back** - 1/2" veneered plywood with UV natural finish interior.
- 12. **Concealed Hinge** - 6 way adjustable soft close hinge.
- 13. **Plywood Support Beams** - 1/4" structural support beams are utilized for additional stability.

* Hudson Cloud White features unique construction. Please refer to our website or specifications book for more information.



Tribeca

95 Mayhill Street Suite B
Saddle Brook, NJ 07663
Tel. +1 732-902-6020
info@tribecacabinetry.com

www.tribecacabinetry.com



Tribeca

C A B I N E T R Y

95 Mayhill Street Suite B
Saddle Brook, NJ 07663
Tel. +1 732-902-6020
info@tribecacabinetry.com

www.tribecacabinetry.com

