

2020 Adonia 18 x 77 3.5 Deck with 2nd Master Suite

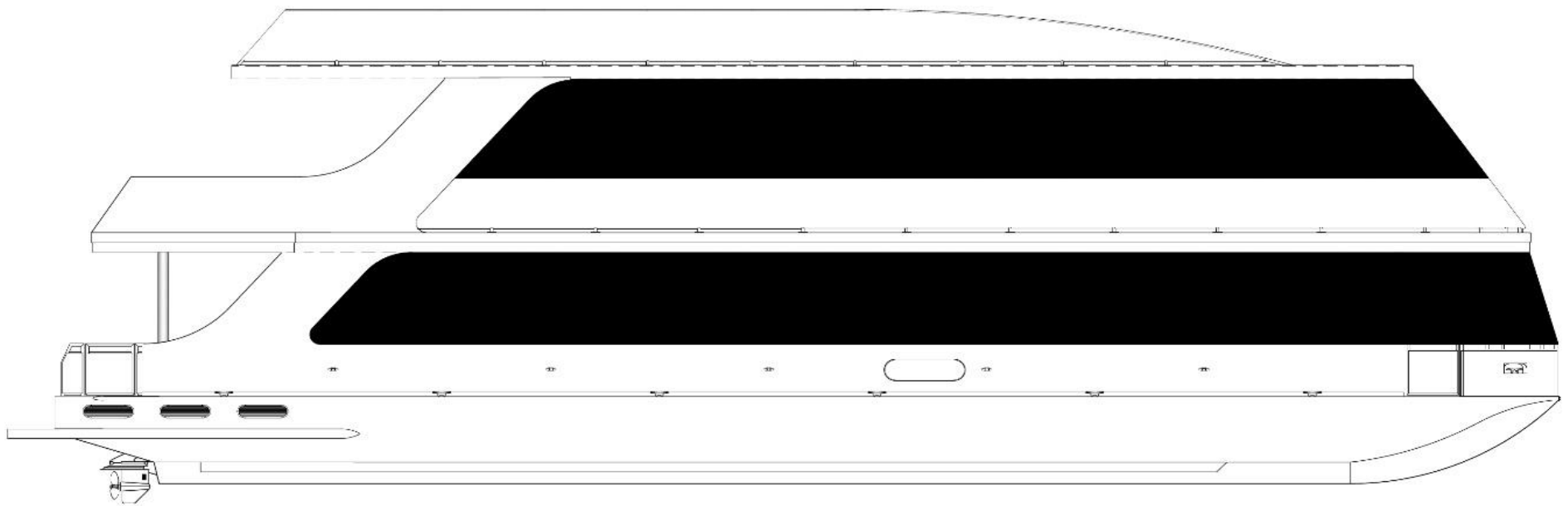

PROFILE - STANDARD ARCH - 30' PARTIAL STRUCTURAL TOP
5/8" = 1'-0"

CONTRACT NO. 1875-2
 THE USE OF THIS DOCUMENT IS LIMITED TO THE PROJECT AND VESSEL SPECIFICALLY IDENTIFIED IN THE CONTRACT. ANY REUSE OF THIS DOCUMENT FOR OTHER PROJECTS OR VESSELS WITHOUT THE WRITTEN PERMISSION OF ADONIA YACHTS IS STRICTLY PROHIBITED.

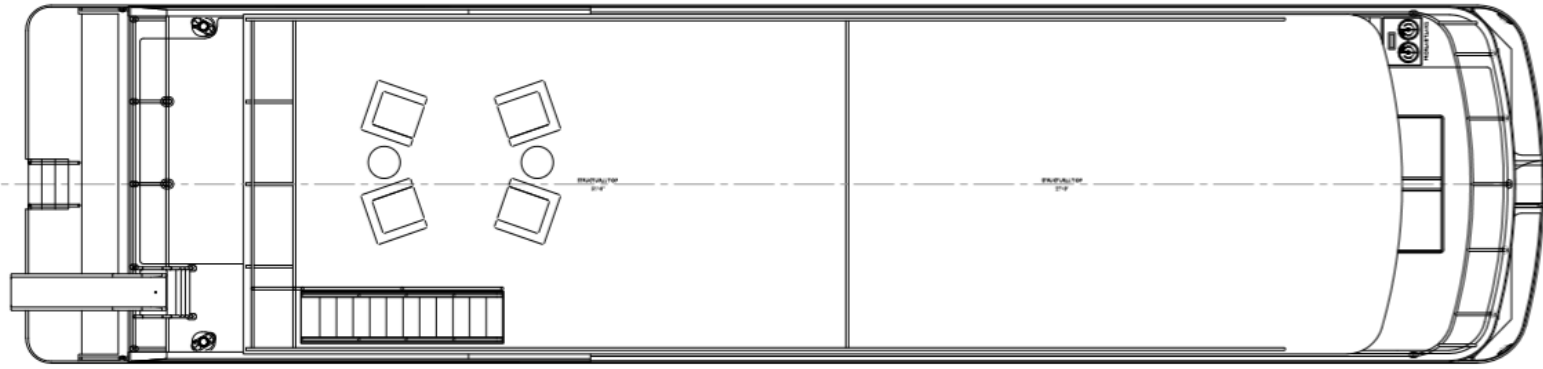

FLOORPLAN - UPPER LEVEL 2
 3/4" = 1'-0"

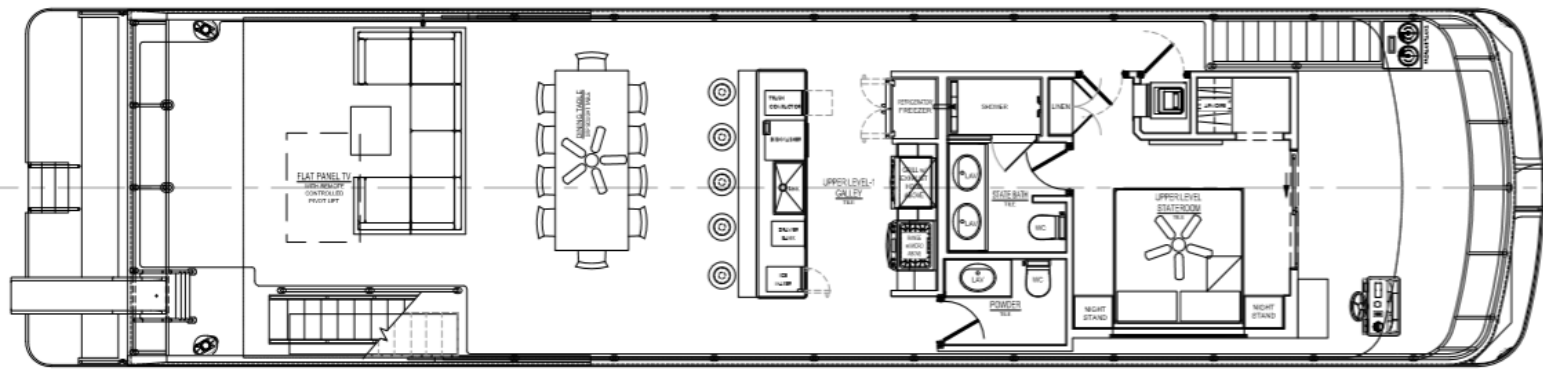

FLOORPLAN - UPPER LEVEL 1
 3/4" = 1'-0"

ADONIA YACHTS
 2020 MODEL - 1875 - 2 HARDTOP - MAXWELL
 Upper Level Floor Plans

THIS PLAN IS THE PROPERTY OF ADONIA YACHTS. IT IS TO BE USED ONLY FOR THE YACHT IT IS DESIGNED FOR. ANY REUSE OR MODIFICATION OF THIS PLAN WITHOUT THE WRITTEN PERMISSION OF ADONIA YACHTS IS STRICTLY PROHIBITED. ADONIA YACHTS ASSUMES NO LIABILITY FOR ANY DAMAGE OR LOSS OF LIFE OR PROPERTY ARISING FROM THE USE OF THIS PLAN.

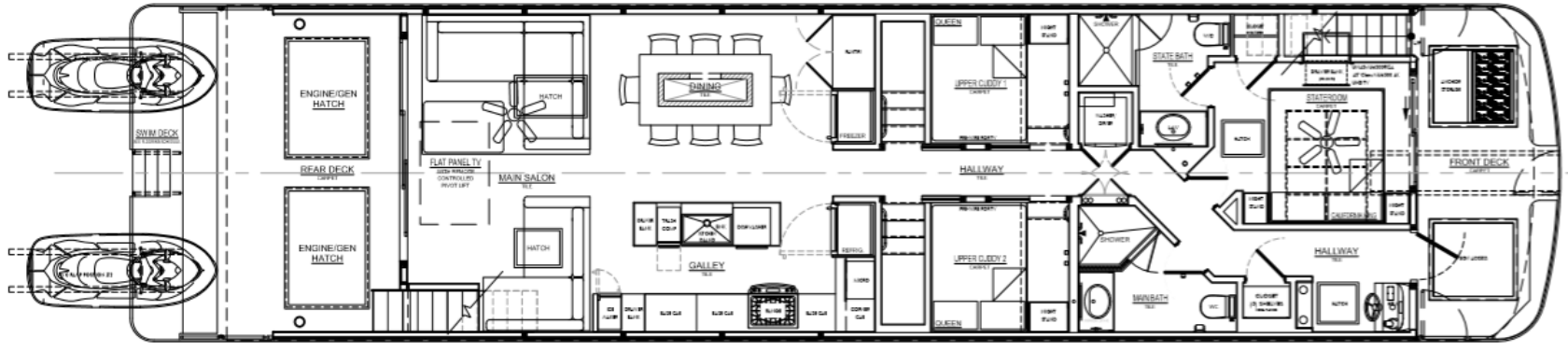

FLOORPLAN - MAIN LEVEL
3/4" = 1'-0"

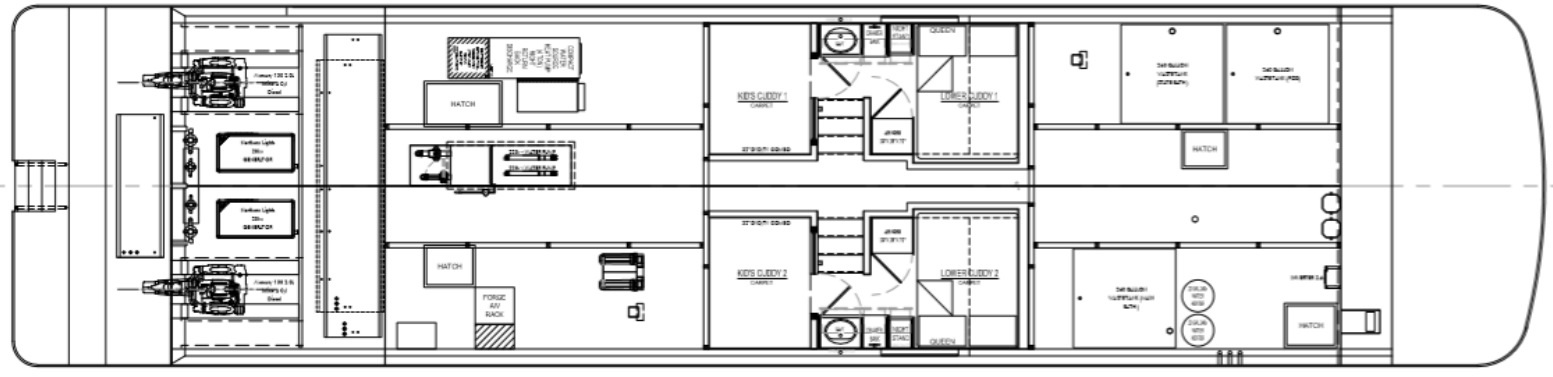

FLOORPLAN - LOWER LEVEL
3/4" = 1'-0"

Project: 1875-2 Hardtop - Maxwell
 Date: 10/15/2020
 Author: J. Maxwell
 Scale: 3/4" = 1'-0"

ADONIA YACHTS
 2020 MODEL - 1875-2 HARDTOP - MAXWELL
 Lower Level Floor Plans

A1.0

Amenities

2020/21 Adonia 1877 3.5 deck 18 x 77 foot

8 Rooms, 2 Master Suites, 4 Staterooms, 2 Kids Cuddies, 2 Salon Sofas, 2 Upper Deck Sofas w/8 Sleeping Pads, Boat easily Sleeps 20
Central Air Conditioning & Heating
Complete Instrument Panel & Captain's Chair, Upper Deck Hardtop Canopy with inset Lighting
Upper & Lower Safety Rail & Hardsides. Upper deck Breakfast Bar with Sink, Dishwasher, Microwave, Range & (5) Barstools on Upper Deck
Upper Deck Master Suite and Bathroom "Pod" with Refrigerator/Freezer w/Ice Maker
Rear Deck Slide with Water Pump
Electronic & Navigational Equipment, 2 Ship-to-Shore Marine Radios, Intellian In-motion Self Tracking Satellite TV
Custom Ceiling Drop down TV with 60" HD/LED TV and Surround Sound System in both Main Salon and Mid Deck With Custom Sofa
Entertainment lounge, LED TV/DVD Combo in both Master Suites,
Upper Deck Complete Helm & Controls, Running & Drive Lights, Spotlight
(2) PWC Ramps w/Winches on back deck, Long Range Main Fuel Tanks (700 gal - Diesel), Toy Tank with Electric Pump
Complete Galley with Service for 20, Custom Cabinets, Custom Counter tops in Galley , Coffee Maker/Toaster/Blender/Electric Skillet
Custom upgraded finishes throughout the boat
Private Master Suite with King Size Bed, under-bed storage and Full Bath
2 Private Upper -level Suites with Queen Size Beds
2 Private Cuddy Cabins with Queen Size Beds
2 "Kid's Cuddys" with Sunbrella pad and TV/DVD Combo
2nd Upstairs Private Master Suite with King Size Bed, under-bed storage and Full Bath
Outdoor Patio & Deck Furnishings, Tables/Chairs/Lounge Chairs, Front Deck BBQ Grill
Full 5-foot Extended Swim Platform with Customer Water Stairs
UVB Fresh Water Processing System, 780 Gallon Holding Tank Capacity
Life Jackets & Safety Equipment, Anchors, Lines, Docking & Mooring Equipment
Below Deck Storage, Back-up Camera on Main Helm, Back-up cameras on upper helm
Engines: Twin Diesel Mercruiser 180 HP with Bravo II Drives, 2 Generators: Diesel 25 KW
Battery System: 12V house system, 4000-Watt Inverter with easy access hatch
Full-size Stainless-Steel Range & Oven, Microwave & Dishwasher
66" Stainless Steel Refrigerator/Freezer Combo, Commercial Ice Maker in Galley, Trash Compactor
Washer/Dryer Combo, Windlass Anchoring System,Front Deck & Upper Deck Screening

		Share	Check On	Check Off	Days
		1	Memorial Weekend	3-Jun-21	10 days
Jeremy Blanck	Sold	2	4-Jun-21	10-Jun-21	7
Dave Kipp	Sold	3	11-Jun-21	17-Jun-21	7
Jeremy Clark	Sold	4	18-Jun-21	24-Jun-21	7
Lyle D Richins	Sold	5	25-Jun-21	1-Jul-21	7
Jordan Miller	Sold	6	2-Jul-20	11-Jul-20	10
Matt Goodman	Sold	7	12-Jul-20	21-Jul-20	10
Jeb Johnson	Sold	8A	22-Jul-20	28-Jul-20	7
Shawn Ritchie	Sold	9	29-Jul-20	4-Aug-20	7
Maxwell	Sold	10	5-Aug-20	7-Aug-20	3
Mark Stuber	Sold	11	8-Aug-20	18-Aug-20	11
	AVL	12	19-Aug-20	25-Aug-20	7
	AVL	13	26-Aug-20	1-Sep-20	7
Jeb Johnson	Sold	8B	2-Sep-20	8-Sep-20	7
Cyle Murry	Sold	14	9-Aug-20	16-Aug-20	8

Turns @ \$1,200. Per trip. Includes the following services:

Check on- Check Off

Pilot in and out of Marina

Fuel main tank and Toy tank, Fill Propane, (Plus cost of fuel)

Dump Black Tanks (restock chemicals and TP)

Clean boat inside and out, clean BBQ, , Change sheets and linens , Clean Windows, Trash removed from Dock

Annual Dues \$2,900.00 per year