

LOAD CALCULATION	
LOAD DESCRIPTION	WATTS
PROPOSED LOADS	
PROPOSED LED FIXTURES (ALL)	1258
+ 25% PER NEC	315
TOTAL PROPOSED LOAD	1573

KEYED LIGHTING CONSTRUCTION NOTES

GENERAL CONSTRUCTION NOTES

- COORDINATE SITE ELECTRICAL WORK WITH OWNER, SITE MANAGER AND ALL APPROPRIATE TRADES. EXISTING CONDUITS TO BE UNRAVELLED AND REUSED, REPLACE IF COLLAPSED OR BLOCKED. INTERCEPT AND EXTEND CONDUITS AND CONDUCTORS AS REQUIRED. RE-USE EXISTING SAME SIZE OR LARGER WIRE AFTER TESTING EXISTING WIRE AND INSULATION PER NEC STANDARDS.
- EXISTING SITE LIGHTING POLE, FIXTURES, AND FOUNDATION TO REMAIN. PROTECT IN PLACE.
- EXISTING ELECTRICAL SITE LIGHTING CONDUIT. FIELD VERIFY LOCATIONS AND PROTECT IN PLACE.
- FURNISH AND INSTALL 3/4" GRS CONDUIT FOR NEW CONDUCTOR PATHS TO PROPOSED POLE LOCATIONS. PENETRATE EXISTING POLE SIGNAL AND SHALL ALL PENETRATIONS UPON COMPLETION. SEE DETAIL E2 FOR ADDITIONAL INFORMATION.
- PROVIDE (1) 3/4" SCHEDULE 40 HPIRC CONDUIT VIA HAND DUG TRENCH. PROTECT IN PLACE ANY EXISTING UNDERGROUND UTILITIES ENCOUNTERED ALONG THE CONDUIT TRENCH ROUTE. PROVIDE (2) #10 AWG CU XHWY CONDUCTORS AND (1) #10 AWG CU GROUND FOR SITE LIGHTING AND CONNECT FOR A COMPLETE SYSTEM. ENSURE THAT ALL EXISTING CIRCUITS AND CONNECTIONS ARE MAINTAINED.
- FURNISH AND INSTALL NEW FOUNDATION FOR PROPOSED SITE LIGHTING POLE. CONTRACTOR SHALL PROVIDE SHOP DRAWINGS FOR NEW SITE LIGHTING POLE FOUNDATIONS. FOUNDATIONS SHALL PROVIDE MOUNTING HEIGHTS FOR FIXTURES AS SHOWN IN THE PLANS. FOUNDATIONS SHALL PROVIDE BOLT PATTERNS TO MATCH THE FLANGE BOLT PATTERN. SEE DETAIL E1.
- FURNISH AND INSTALL (2) NEW LED SITE LIGHTING FIXTURES COOPER GLEON LUMINAIRE LIGHT MODEL STAR-GLEON-SAB8-7408-T2P-DP-DIM-IP-RP7M-MSDC-L40-6A AT 42" MOUNTING HEIGHT WITH NEW MAST ARMS ON NEW POLE AND FOUNDATION. PROVIDE (2) #12 AWG CU CONDUCTORS AND (1) #12 AWG CU GROUND FROM POLE HAND HOLE TO EACH FIXTURE AND CONNECT FOR COMPLETE SYSTEM. COORDINATE WITH OWNER TO VERIFY ALL PREVIOUS CIRCUITS AND CONNECTIONS HAVE BEEN REESTABLISHED.
- SOLAR BEACON. SEE CIVIL DRAWINGS FOR ADDITIONAL INFORMATION.
- CONTRACTOR SHALL IDENTIFY EXISTING LIGHTING CIRCUIT TO UTILIZE FOR CONNECTING NEW SITE LIGHTING FIXTURES. IDENTIFY THE EXISTING LIGHTING CIRCUIT'S SOURCE PANEL, CIRCUIT NUMBER AND CIRCUIT BREAKER SIZE. VERIFY EXISTING CAPACITY BY PERFORMING 30DAY LOAD STUDY OR NEC 220.87 APPROVED METHOD. IF THE TOTAL NEW LOAD (EXISTING PLUS PROPOSED) EXCEEDS THE ALLOWABLE LOADS OF THE CIRCUIT BREAKER OR PANEL, DO NOT CONNECT THE NEW LOADS WITHOUT ADEQUATE CAPACITY. PROVIDE UNPAID PANEL SCHEDULES AS NEEDED.
- FURNISH AND INSTALL (2) NEW LED SITE LIGHTING FIXTURES COOPER GLEON LUMINAIRE LIGHT MODEL STAR-GLEON-SAB8-7408-T2P-DP-DIM-IP-RP7M-MSDC-L40-6A AT 42" MOUNTING HEIGHT WITH NEW MAST ARMS ON EXISTING POLE AND FOUNDATION. PROVIDE (2) #12 AWG CU CONDUCTORS AND (1) #12 AWG CU GROUND FROM POLE HAND HOLE TO EACH FIXTURE AND CONNECT FOR COMPLETE SYSTEM. COORDINATE WITH OWNER TO VERIFY ALL PREVIOUS CIRCUITS AND CONNECTIONS HAVE BEEN REESTABLISHED.
- PROVIDE NEW EXTENDED MAST ARMS FOR EXISTING FIXTURE(S). PROVIDE ANY NECESSARY CABLE/HARDWARE TO RELOCATE AND RE-CONNECT FIXTURE(S) AS INDICATED ON THE PROJECT PLANS.

- ALL EXISTING ELECTRICAL INFORMATION INCLUDING LUMINAIRE TYPES, PANEL NAMES, CIRCUIT NUMBERS, CONDUIT CONDUCTOR SIZES AND ROUTING, ETC. ARE UNKNOWN AND BASED ON EXISTING DOCUMENTS AND MAY NOT REFLECT ACTUAL FIELD CONDITIONS. CONTRACTOR SHALL VERIFY INFORMATION DURING CONSTRUCTION AND PROVIDE UPDATES AS RESULTS UPON COMPLETION.
- ALL CONDUIT ROUTING AND EQUIPMENT LOCATIONS ARE SCHEMATIC. ELECTRICAL CONTRACTOR SHALL DETERMINE BEST ROUTING PATH BASED ON FIELD CONDITIONS WITH OWNER APPROVAL.
- CONTRACTOR SHALL COORDINATE WITH EQUIPMENT MANUFACTURER(S) FOR DETAILED CONNECTIONS REQUIREMENTS AND PROVIDE MATERIALS AND INSTALLATION FOR A COMPLETE AND OPERATIONAL SYSTEM.
- THE CONTINUITY OF ALL EXISTING CIRCUITS TO REMAIN SHALL BE MAINTAINED.
- ALL NEW EQUIPMENT SHALL BE CONNECTED TO AN APPROPRIATELY SIZED CIRCUIT IN AN EXISTING PANEL AND/OR LIGHTING CONTROLLER. CONTRACTOR SHALL VERIFY CIRCUITING PRIOR TO BEGINNING ANY DISCREPANCIES SHALL BE BROUGHT TO THE ATTENTION OF THE OWNER/ENGINEER PRIOR TO ANY CONNECTIONS.
- CONTRACTOR SHALL VERIFY EXISTING CIRCUITS ARE ADEQUATELY SIZED FOR ANY EQUIPMENT THAT IS TO BE REPLACED PRIOR TO CONNECTING NEW EQUIPMENT.
- ALL CIRCUITING THAT IS INDICATED SHALL BE FIELD VERIFIED PRIOR TO BEGINNING. THE CONTRACTOR SHALL ENSURE THAT ALL EQUIPMENT IS CONNECTED TO ADEQUATELY SIZED CIRCUIT BREAKERS AND CONDUCTORS. ANY DISCREPANCIES SHALL BE BROUGHT TO THE ATTENTION OF THE OWNER/ENGINEER PRIOR TO ANY CONNECTIONS.
- CONTRACTOR SHALL ENSURE EXISTING PANEL LIGHTING CONTROLLERS HAVE ADEQUATE CAPACITY FOR NEW ELECTRICAL LOADS PRIOR TO ANY NEW OR REPLACED EQUIPMENT BEING CONNECTED. ANY DISCREPANCIES SHALL BE BROUGHT TO THE ATTENTION OF THE OWNER/ENGINEER PRIOR TO ANY CONNECTIONS.
- CONTRACTOR SHALL RESTORE AND REPAIR ALL DISTURBED LANDSCAPE, HARDSCAPE, ASPHALT, CURB AREAS ETC. TO ORIGINAL STATE OR BETTER.
- EXISTING UNDERGROUND UTILITY LOCATIONS ARE UNKNOWN. IT SHALL BE THE CONTRACTOR'S RESPONSIBILITY TO COORDINATE WITH OWNER AND FIELD VERIFY ALL EXISTING SITE CONDITIONS PRIOR TO BEGINNING WORK. ANY EXISTING SYSTEMS (E. IRRIGATION, WATER, GAS, SEWER, ETC.) IMPACTED, SHALL BE REPAIR/RESTORED TO ORIGINAL STATE OR BETTER.



Bore Path

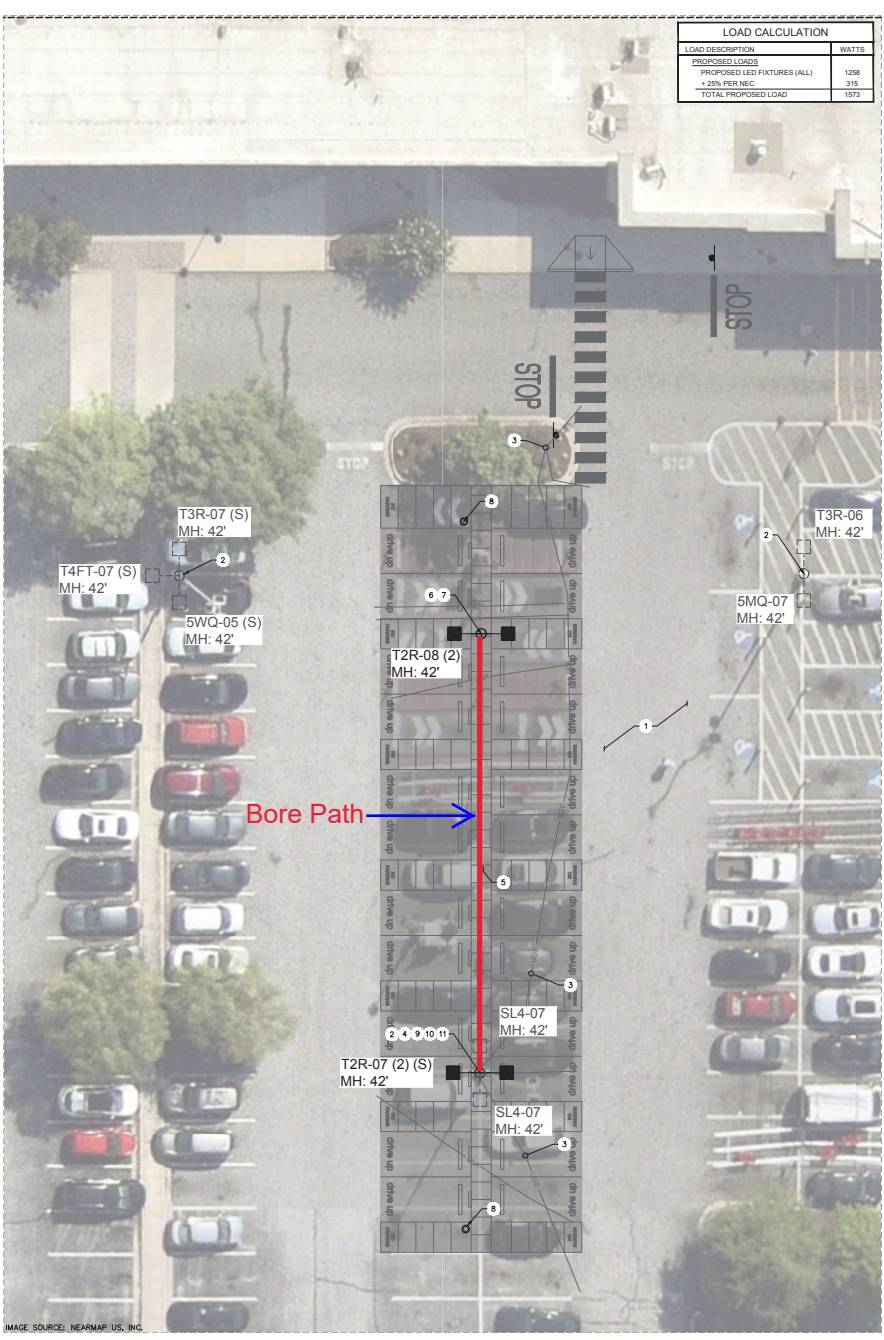
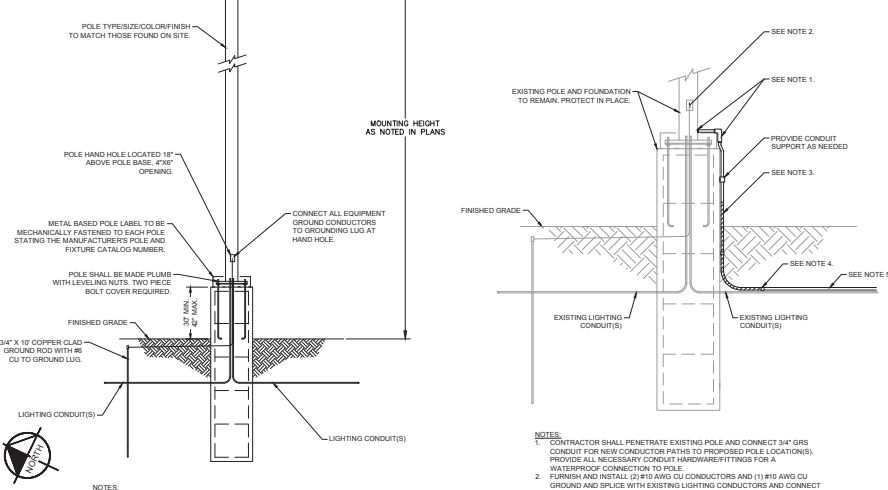

IMAGE SOURCE: NEARMAP US, INC.

PROPOSED DRIVE UP STALLS
1" = 10'



- NOTES:
- THIS DETAIL IS FOR REFERENCE ONLY. CONTRACTOR SHALL INSPECT EXISTING SITE POLES AND FOOTERS AND PROVIDE SIMILAR TYPES/SIZES TO MATCH.
 - POLE FOUNDATION SHALL BE PROVIDED IN DEFERRED SUBMITAL. CONTRACTOR SHALL PROVIDE SHOP DRAWINGS TO BE INCLUDED IN SUBMITALS. SHOP DRAWINGS SHALL BE STAMPED/SIGNED/SEALED BY STATE REGISTERED ENGINEER. IT SHALL BE THE CONTRACTOR'S RESPONSIBILITY TO OBTAIN ALL PERMITS AND ANCHOR BOLT DIMENSIONS (SIZE, BOLT CIRCLE, ETC.) WITH THE CONTRACTOR WHO WILL BE INSTALLING THE LIGHTING STANDARDS PRIOR TO INSTALLATION OF THE FOUNDATIONS.
 - POLES, FIXTURES, ARMS AND FIXTURE COMPONENTS TO BE FACTORY PAINTED TO MATCH THOSE FOUND ON SITE.



Kimley-Horn & Associates, Inc.
1000 WILMINGTON BLVD. SUITE 400
WILMINGTON, NC 27403
WWW.KIMLEY-HORN.COM

Date	No	Description

DATE: 7/6/2022

T-1546 EAST POINT
3660 MARKET PLACE BLVD
EAST POINT, GA 30344

Project Number: T-1546

Drawn by: GS
Checked by: JXXA

LIGHTING PLAN

E2.0

