

NURSE TANK OWNERS MANUAL

Since VAN'S EQUIPMENT'S beginnings we have used a generic owners manual. It was just too costly to have printed and keep on hand owner manuals specific to each size and type sprayer we manufacture.

We now have the technology in house to create sprayer specific manuals and to print them only as needed. We think we have made a good beginning, but these manuals are still in the development stage. At this point we would appreciate the input of our end user customer and our dealers as to how we can make these manuals more useful and user friendly.

This is the prototype manual. Please look over the manual and give us your input.

CALL VANS EQUIPMENT AT 1-800-765-1101 AND ASK FOR CRAIG

We appreciate your input on these manuals.

Thanks Vans Equipment

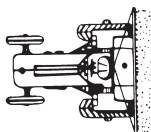

van's

EQUIPMENT COMPANY

We Appreciate You and Your Business!

(229) 985-1101
P.O. BOX 3157 • 2169 SYLVESTER HIGHWAY • MOULTRIE, GEORGIA 31776-3157

**VAN'S EQUIPMENT
BUILT FOR FARMING INTEGRITY**

WHEN SELECTING EQUIPMENT FOR FARMING THE NAME VAN'S means availability, reliability, and proven superiority. Maintaining a close association with farming customers has resulted in equipment design and manufacturing philosophy that reflects the exacting requirements of our customers.

Van's Equipment Company, Inc. appreciates your purchase of a new spray unit. This unit, is designed to give years of service with proper care. The following pages will be helpful in set-up and maintenance of your new unit.

PLEASE READ THIS MANUAL CAREFULLY BEFORE INITIAL START-UP IS ATTEMPTED.

**WE APPRECIATE YOU
AND YOUR BUSINESS**

INDEX

PAGE NO.....	DESCRIPTION
1.....	Operations Guide
2.....	Trouble Shooting
3-4.....	Main Breakdown W/ Mix & Fill
5.....	Sparger Tube Assembly
6.....	Axle Assembly

Your VAN'S NURSE TANK Requires Very Little in the Way of Setup to Be Ready For Use. You Will Find Manufacturer Manuals for the Pump and Motor.

There Are a Few Recommended Items to Do Before, During, and After Use.

- 1 Check Inside Tank To Be Sure It Is Clean.
- 2 Use Clean Water and Check For Leaks, as Transport Can Cause Items To Loosen.
- 3 Periodically Check Wheel Bearings.
- 4 Never Run Pump Dry.
- 5 Monitor Sight Gauge On Left Side Of Tank For Water Level.
- 6 Never Change From One Chemical To Another Without Thoroughly Cleaning Entire System.
- 7 Be Sure To Secure Nozzle Valve in Holder Before Transport.
- 8 The Suction Outlet May Not Remove All Water From Tank, Use The Drain In Bottom Of Tank To Remove All Water From Tank.
- 9 If Your Nurse Tank Comes With A Mix & Fill Option, Be Sure To Close Ball Valve After The Desired Amount Has Been Delivered. This Can Be Determined By Watching The Gallonage Markings On The Side Of Mix Tank.
- 10 If Your Nurse Tank Comes With A Sparger Tube Option, You Can Use The Ball Valve to Adjust For Proper Admittance.
- 11 At The End Of The Season, Drain Completely And Let Dry. Put A 50/50 Mix Of Anti Freeze and Water in Pump.
- 12 WHENEVER CHEMICAL ARE INVOLVED ALWAYS USE PROPER PRECAUTIONS AND FLUSH TANK AFTER USE.

PROBLEM	PROBABLE CAUSE	POSSIBLE REMEDY
Erratic pressure	air leaking into suction line	Tighten all fittings and hoses between pump and tank
	Trash in System	Remove and clean parts
	Suction line kinked or clogged	Remove suction line and clean-check tank and strainer
	Air leak in suction hose	Replace hose
Pump loses suction	Suction hose collapsed	Replace hose
	Pump air locked	Remove discharge line and pump liquid through pump
	Pump worn and clearances too great	Replace or repair pump
	Seals worn out or deteriorated	Replace pump seals
Pump does not draw water	Suction hose collapsed	Replace hose
	Suction line is plugged or collapsed	Examine suction line
Noisy pump	Excessive pump speed	Slow the pump
	Air leak in suction line	Replace suction hose
Pump shows decreased capacity	Air leak in suction hose	Rplace suction hose
	Moving parts worn	Replce worn parts
	Worn seal	Replace seal
		Clean pump inside

ITEM NO.	DESCRIPTION	PART NO.
1	1 1/2" Poly Nozzle Valve	VA-150
2	Hose Shank 1 1/2" MPTx Barb Nylon	A112
3	Hose Clamp 1 1/2"	28H
4	1 1/2" Black Ag. Hose	10041007
5	Elbow 1 1/2"MPT x Barb 90 Nylon	EL112
6	Reducer Bushing 2"x 1 1/2" Nylon	RB200112
7	Poly Pump 2" w/3.5 HP Briggs	200P-3
8	Bolt 5/16"x 1 3/4"	CS516134C
9	Nut 5/16"	HN516C
10	Lock Washer 5/16"	LW516
11	Nipple 2"x 2" Galvanized	GN2002
12	Tee 2"FPT Nylon	TT200
13	Elbow 2"MPT x Barb 90 Nylon	EL200
14	Hose Clamp 2"	32H
15	Hose Wire Coil 2"	12004001
16	Elbow 2"Barb x 2" Barb	EL200HB
17	Hose Wire Coil 2"	12004001
18	Hose Shank 2" MPTx Barb Nylon	A200
19	Ball Valve Poly 2"	V-200
20	Nipple 2"x Close Nylon	M200
21	Tank Fitting 2" Double Thread	67153
22	Tank Fitting 2" Siphon Assembly	67248
23	Tank Fitting Standard 1 1/4"	67114
24	Plug 1 1/4" Nylon	F114
25	Reducer Bushing 2"x 1 1/4" Nylon	RB200114
26	Elbow 1 1/4"MPT x Barb Nylon	EL114
27	Hose Clamp 1 1/4"	24H
28	Hose Wire Coil 1 1/4"	1200349
29	Hose Shank 1 1/4" MPTx Barb Nylon	A114
30	Ball Valve Poly 1 1/4"	V-125
31	N/A	
32	Nipple 1 1/4"x Close Galvanized	GN1141.75
33	Tank Fitting 1 1/4"	67114
34	Tank 15 Gallon Mix & Fill	41346
35	Tank 1000 Gallon Leg/Nurse Tank,(Black)	47382
36	Tank Fitting 1/2"	67158
37	Elbow 1/2"MPT x Barb 90 Nylon	EL12
38	Hose Clamp 1/2"	8H
39	Hose Clear 1/2"x 3/8" Clear Wall	V3500-1218
40	Pump Base	I90-047
41	Bolt 7/16"x 2 1/2"	CS716212C
42	Shock Cushion	TRW82123
43	Lock Nut 7/16"	HN716C
44	Frame 1000 Gallon Nurse/Leg Tank w/ Mix & Fill	T3 with 15TS-N
45	Tire and Rim Assembly	11-L-TR
46	Tank Strap,(Standard)	SPNT

47	Tank Strap,(With Handle)	SPNTA
48	Bolt 1/2"x 2 1/2"	CS12212C
49	Flat Washer 1/2"	FW12
50	Lock Nut 1/2"	HLN12C

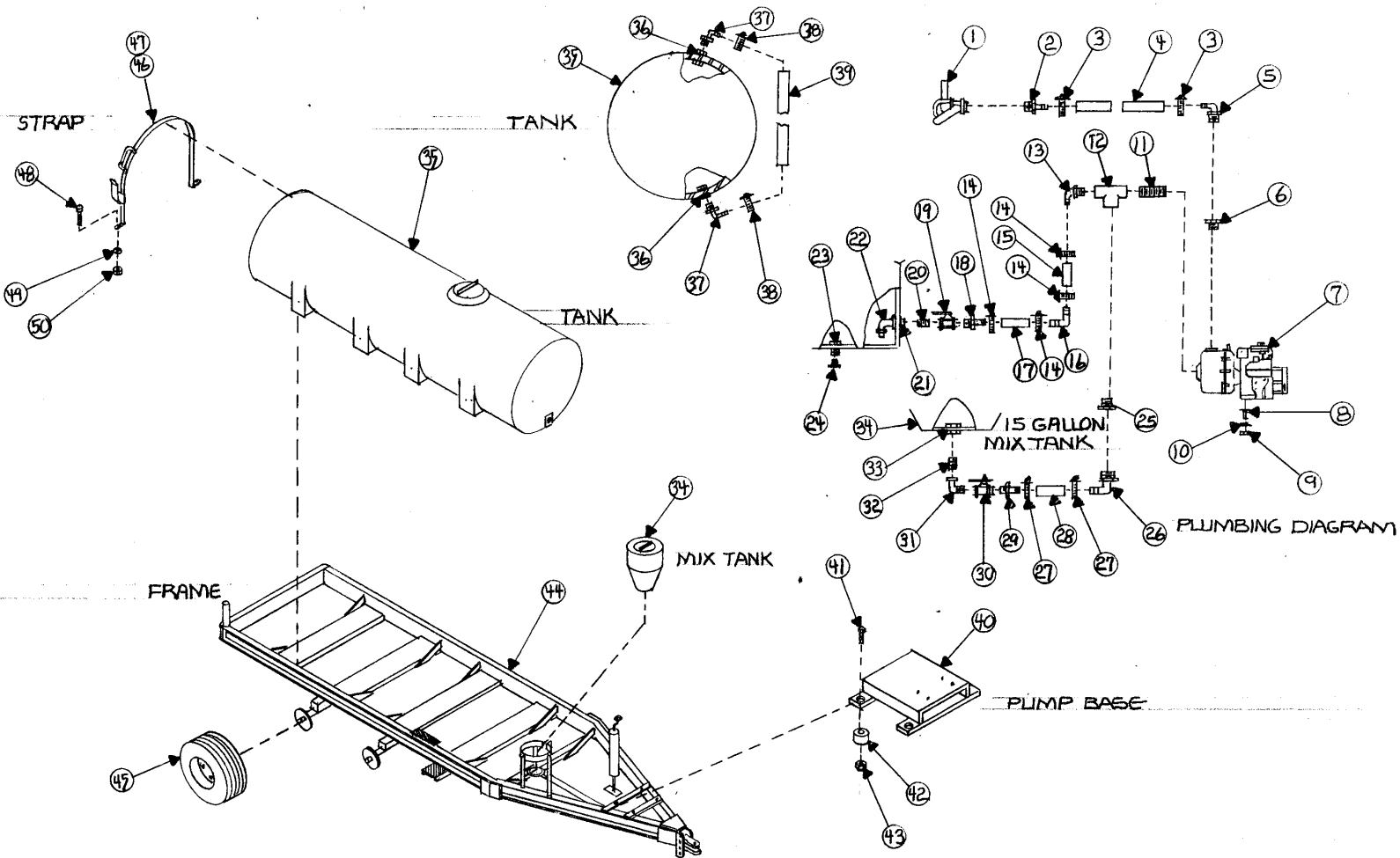

ITEM NO.	DESCRIPTION	PART NO.
1	Reducer Bushing 2"MPT x 1 1/2"FPT Nylon	RB200112
2	Nipple 1 1/2" x Close Nylon	M112
3	Tee 1 1/2"FPT Nylon	TT112
4	Reducer Bushing 1 1/2"MPT x 1 1/4"FPT Nylon	RB112114
5	Elbow 1 1/4"MPTx Barb 90 nylon	EL114
6	hose Clamp 1 1/4"	24H
7	Hose Black Ag. 1/1/4"	10040507
8	Hose Shank 1 1/4"MPTx Barb Nylon	A114
9	Ball Valve 1 1/4" Poly	V-125
10	Nipple 1 1/4" x Close Galvanized	GN1141.75
11	N/A	
12	Sparger Tube Assembly,(Nurse Tank)	ST-1000
13	Coupling 1/2" Stainless Steel	SSCP1200
14	Plug 1/2" Nylon	F12
15	Tank Fitting 1 1/4"	67114
16	Nipple 1 1/4" x Close Stainless Steel	SSN1141.75
17	Cap 1 1/4" PVC	448-012

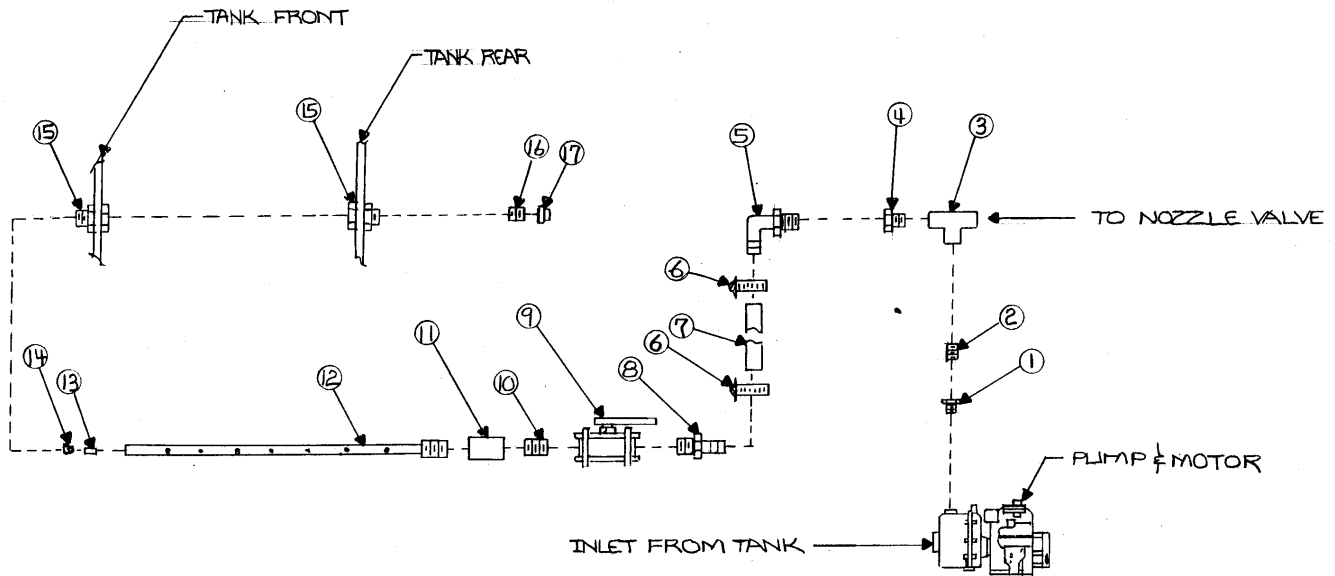

ITEM NO.	DESCRIPTION	PART NO.
1	Spindle for 888 Hub	280720
2	Race	910263
3	Inner Bearing	910264
4	Grease Seal	R2-CR16289
5	Hub 6 Bolt 6" Circle	280552
6	Grease Seal	R2-CR16289
7	Outer Bearing	910259
8	Spindle Washer	913683
9	Cotter Pin	9059368
10	Spindle Nut	912952
11	Hub Cap	909259
12	Tire and Rim Assembly	11-L-TR
13	Lug Bolt	913539
14	Spindle Assembly	SA-3560E
15	Hub Assembly	2-35660E-01-00

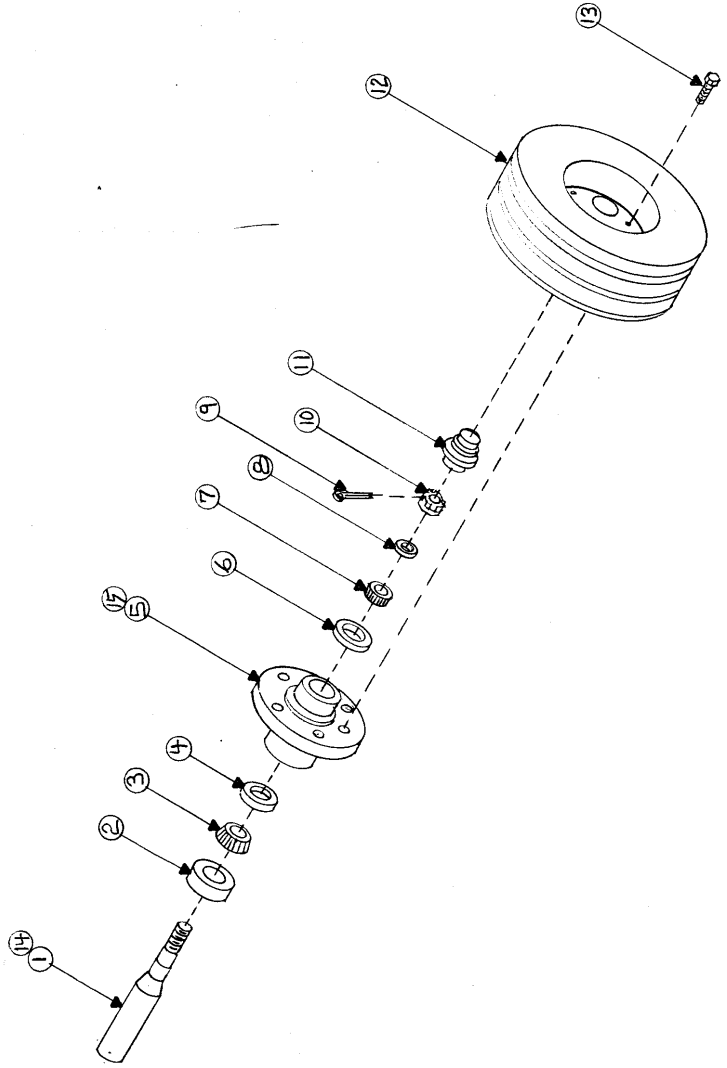

NOTES

NOTES



I GIVE THANKS TO THE LORD AND
A FARMER EACH TIME I EAT
DATE EQUIPMENT COMPANY, WINDYBROOK, GA