

797020

Document Number

Resolution

Document Title

DOCUMENT # 797020

Certified, Filed and or Recorded on  
JUNE 22, 2006 AT 09:30AM

KATHY F. HANSON

DOUGLAS COUNTY RECORDER

SUPERIOR, WI 54880-2765

Fee Amount: \$15.00

Recording Area

Name and Return Address

Mary L. Conley  
5026 E. County Rd B.  
South Range - WI 54874

19/ck

Parcel Identification Number (PIN)

June 13, 2006

RESOLUTION OF THE OAKLAND TOWN BOARD  
INITIATING THE PROCESS OF LAYING OUT A TOWN ROAD  
Pursuant to Section 82.10 of the Wisconsin Statutes

WHEREAS, the Oakland Town Board has received complaints from school bus drivers of the dangerous situation occurring at the east end of the Rice Farm Road: it being that this vehicle turn-around location is where children are dropped off and picked up by the school buses; and this also being the location where the town's waste hauler picks up residential garbage that provides a prime attractant for foraging bears; and

WHEREAS, both the vehicle turn-around and the residential driveway leading from the turn-around to the home of the referenced school children are located in a remote and wooded area, creating a vulnerable and potentially hazardous situation for children walking to, waiting for and walking home from the school buses, as bears can appear and confront them at any time and at any location along the said driveway.

NOW, THEREFORE, BE IT RESOLVED, that the Oakland Town Board intends to extend the town road system for Rice Farm Road as follows:

Beginning at the turn-around near the northwest corner of the southwest one-quarter (1/4) of the southwest one-quarter (1/4) of Section 11, Township 47 North, Range 13 West; and extending northeasterly along the present driveway location a distance of approximately one thousand (1,000) feet to a new vehicle turn-around in front of the residence, all within said Section 11, Township 47 North, Range 13 West, located in Douglas County, Wisconsin. The proposed town road is entirely contained within the 80-acre property owned by Lyle Kunert and Lyle Kunert, Jr. and the Kunerts have offered to convey the necessary property as a town road. There are no other abutting property owners to the proposed town road. A complete legal description and map prepared by Hugh C. McDonald, RLS are attached. All necessary ditching and town road construction to bring the location up to town road standards will be by town forces.

BY ORDER OF THE OAKLAND TOWN BOARD this 13<sup>th</sup> day of June, 2006.

Town Chairman [Signature]

Town Supervisor [Signature]

Town Supervisor [Signature]

Subscribed and sworn to before me  
this 13<sup>th</sup> day of June 2006  
Mary K. Conley  
Notary Public Douglas County, WI  
My Commission Expires  
September 30 2007

**Legal Description For Town Road:**

A parcel of land in the Northwest One-quarter of the Southwest One-quarter (NW -SW) and the Southwest One-quarter of the Southwest One-quarter (SW 1/4 - SW 1/4) of Section Eleven, (11), Township Forty-seven (47) North, Range Thirteen (13) West, Town of Oakland, Douglas County, Wisconsin, more particularly described as follows:

Commencing at the West One-quarter (W. 1/4) corner of said Section Eleven (11);

Thence S 02°08'23" W, 1363.84 feet along the West line of the Southwest One-quarter (SW 1/4) of said Section Eleven (11) to the place of beginning;

Thence N 42°06'10" E, 615.57 feet;

Thence N 24°15'09" E, 339.04 feet;

Thence S 65°44'51" E, 66.00 feet;

Thence S 24°15'09" W, 349.70 feet;

Thence S 42°36'10" W, 703.61 feet to a point on the west line of said Southwest One-quarter (SW 1/4) of said Section Eleven (11);

Thence N 02°08'23" E, 101.70 feet to the place of beginning.

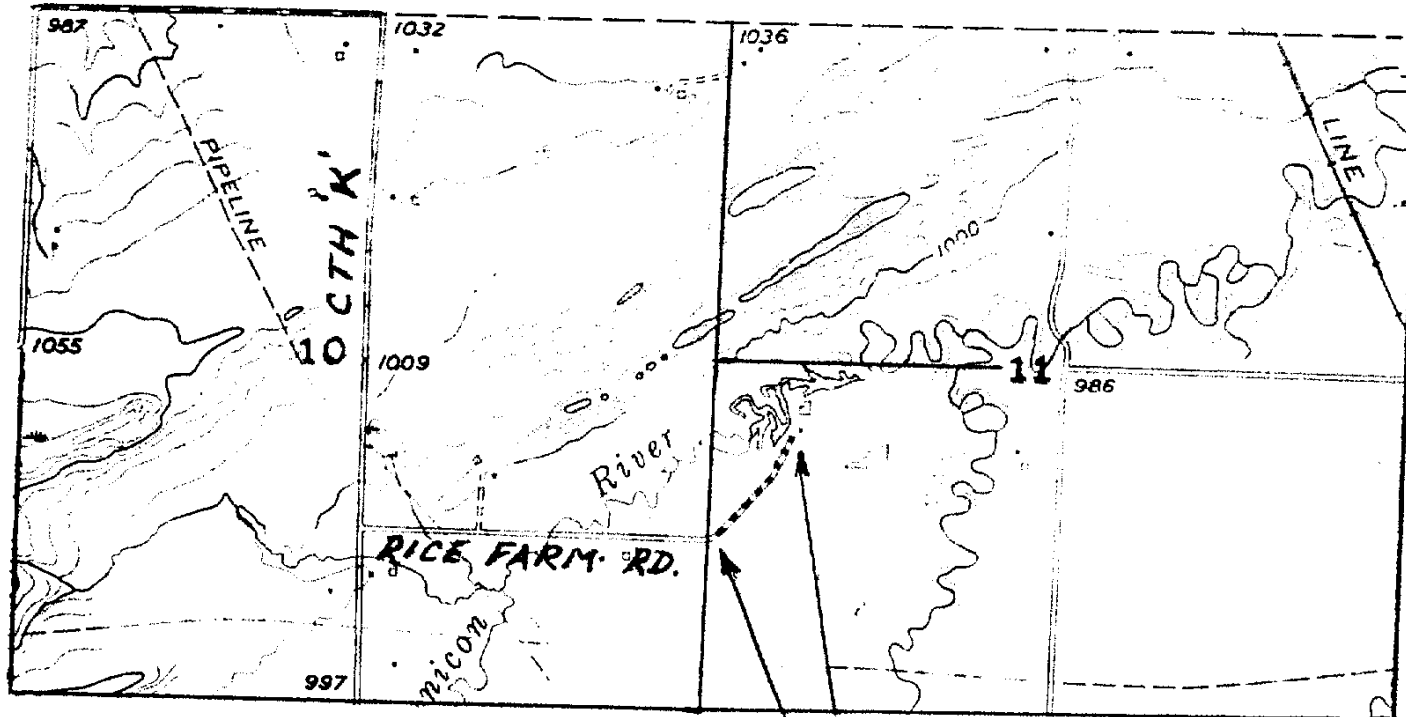

PROPOSED EXTENSION  
RICE FARM ROAD

SCALE 1:24 000

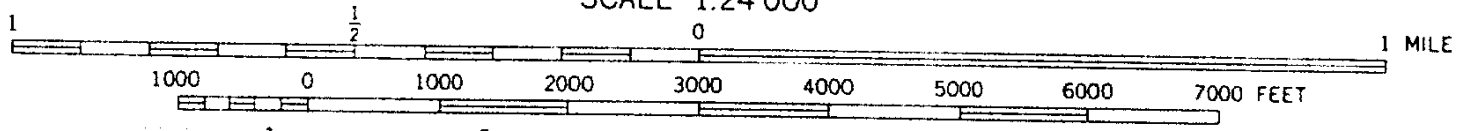

PROJECT NUMBER	SHEET NO
SURVEY FOR:	111
TOWN OF OAKLAND	
6288 S. PINE GROVE ROAD	
SOUTH PLAGE, WI. 53067	

SURVEY OF THE CENTERLINE OF A PROPOSED TOWN ROAD IN THE NW 1/4- SW 1/4 AND THE SW 1/4- SW 1/4 OF SECTION 11, T 47 N, R 13 W. TOWN OF OAKLAND, DOUGLAS COUNTY, WI.

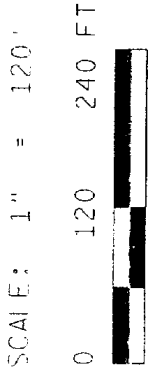

- LEGEND**
- DENOTES MONUMENT IN PLACE
  - SET 3/4" X 24" RE-BAR WEIGHING 1.50 LBS. / L.F.
  - △ SET P.K. NAIL
  - ⊙ SET RR SPIKE
  - ⊞ SET DOMETOP SURVEY NAIL
- DATE OF SURVEY: MAY 2006  
DRAFTED BY: HCM



**SURVEYORS CERTIFICATE:**  
I, HUGH C. McDONALD, WISCONSIN LAND SURVEYOR, HEREBY CERTIFY THAT THIS MAP IS TRUE AND CORRECT TO THE BEST OF MY KNOWLEDGE AND ABILITY AND THAT THIS SURVEY WAS PERFORMED BY ME OR UNDER MY DIRECT SUPERVISION.

DATED AT FOXBORO, WISCONSIN THIS 21<sup>ST</sup> DAY OF MAY 2006

*Hugh C. McDonald*  
HUGH C. McDONALD, RLS# 1348

RICE FARM ROAD

