

Warnings and Cautions

- Insert (4) AA batteries as directed (not included). Ensure batteries are installed properly with regard to polarity direction indicated on battery compartment (+and-).
 - Do NOT mix old and new batteries. DO NOT use lithium batteries. The use of standard batteries are recommended. DO NOT mix lithium, alkaline, carbon-zinc, nimhd or NiCad, or any other AA battery types.
 - Remove batteries from device when not used for extended periods of time.
 - Remove depleted or expired batteries.
 - DO NOT place or locate this device or any batteries used in this device directly into or nearby fire or expose directly to extreme elevated temperatures.
 - DO NOT expose, operate, or use this device adjacent to or near any combustible liquids, aerosols, or vapors, including but not limited to alcohol, benzene, acetone, gasoline type liquids, thinners, solvents, cleaners, or aerosol sprays.
 - DO NOT allow sand or small debris to enter air intake vent openings or air exit opening as damage may result.
 - DO NOT operate upside down or inverted with liquid inside. KEEP DEVICE UPRIGHT AT ALL TIMES.
 - DO NOT operate with a large volume of liquid inside. To remove melted ice water, turn off power switch, remove lid, and pour out liquid contents. Do not pour out liquid through Eyeball Valve.
 - DO NOT use dry ice or hot water with this device. Use of dry ice or hot water may cause personal injury and damage to this device.
 - DO NOT disassemble lid.
 - DO NOT microwave lid.
 - DO NOT freeze lid.
 - Hand wash base only. (Follow cleaning & maintenance instructions on the back)
 - DO NOT submerge, or expose lid to water as damage may occur.
 - Avoid lengthy exposure periods to direct sunlight.
 - Keep this device, and its contents, ice packs, and all packaging materials away from small children, unsupervised children and pets.
 - DO NOT drop this device as impact may cause damage to the lid, metal container, and its internal components.
 - DO NOT use this device for consumption of beverages, food, or any other ingestible items.
 - DO NOT direct air flow directly into the eyes, mouth, or ears as personal injury may result.
 - This device complies with Part 15 of the FCC Rules. Operation is subject to the following two conditions:
(1) this device may not cause harmful interference, and
(2) this device must accept any interference received, including interference that may cause undesired operation.
Changes or modifications not expressly approved by the party responsible for compliance could void the user's authority to operate this device.
- NOTE: This equipment has been tested and found to comply with the limits for a Class B digital device, pursuant to Part 15 of the FCC Rules. These limits are designed to provide reasonable protection against harmful interference in a residential installation. This equipment generates, uses and can radiate radio frequency energy and, if not installed and used in accordance with the instructions, may cause harmful interference to radio communications. However, there is no guarantee that interference will not occur in a particular installation. If this equipment does cause harmful interference to radio or television reception, which can be determined by turning the equipment off and on, the user is encouraged to try to correct the interference by one or more of the following measures:
- Reorient or relocate the receiving antenna.
 - Increase the separation between the equipment and receiver.
 - Connect the equipment into an outlet on a circuit different from that to which the receiver is connected.
 - Consult the dealer or an experienced radio/TV technician for help.

SHARPER IMAGE®

BREEZE BLAST™ ULTRA PERSONAL AIR COOLER

To Purchase Additional Blast Pack™
Ice Packs and Accessories,
Please Visit www.BreezeBlastTips.com

Thank You For Choosing

BREEZE BLAST™

By

SHARPER IMAGE®

For Tips, Instructional Videos,
Additional Accessories, And
The Latest Products News,
Please Visit www.BreezeBlastTips.com

Patent Pending
Made in China

Breeze Blast is a trademark of Allstar Innovations.
Sharper Image® name and logo are trademarks
or registered trademarks

© 2020 Allstar Innovations

**For Tips, Instructional Videos, and to Purchase Additional Accessories,
Please Visit www.BreezeBlastTips.com**

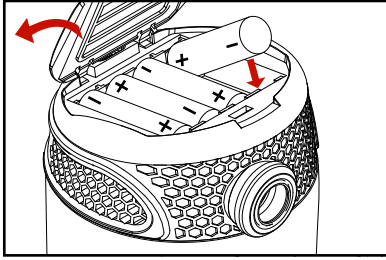

1. SETUP Requires (4) AA batteries installed as shown (not included). Open battery compartment by lifting on the locking tab. For best results, install new alkaline AA batteries. **DO NOT** mix battery types.

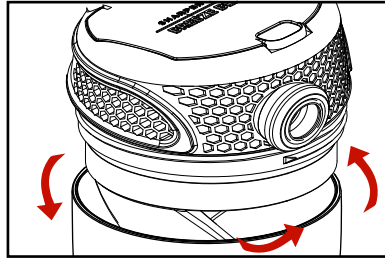

2. Twist off Breeze Blast™ lid counter clockwise to remove cap from Breeze Blast™ base.

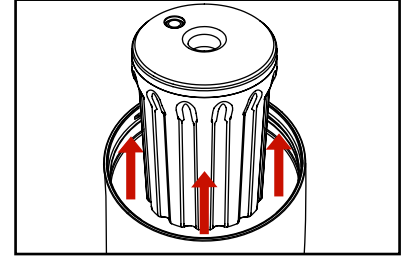

3. Remove Blast Pack™ ice pack from the Breeze Blast™ base (1 ice pack included).

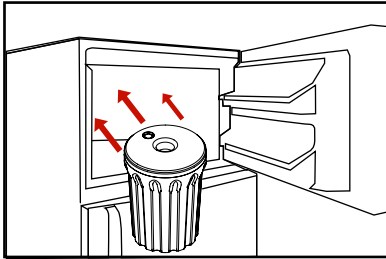

5. For optimal performance, place Blast Pack™ ice pack into the freezer for at least 8 hrs.

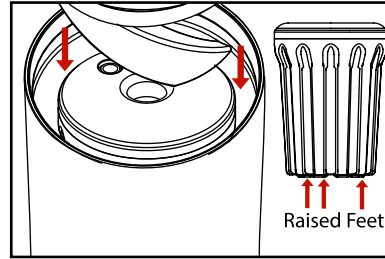

6. Once the Blast Pack™ ice pack is frozen, place it back into the Breeze Blast™ base. Install the Blast Pack™ ice pack with the raised feet, and the narrow portion of the ice pack facing downwards. Install lid by turning clockwise onto base.

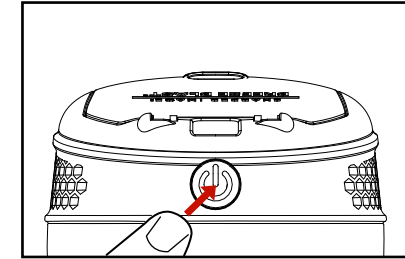

7. Press the power button once to turn on the system. Press power button twice to turn on low fan speed. Press for a third time to turn the system off. Auto shut-off timer turns unit off after 30 min. Simply push power button to reactivate air flow.

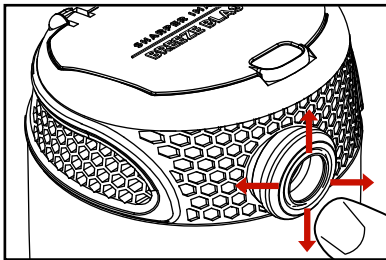

8. The Breeze Blast™ lid has a built-in, multi-directional eyeball valve. To use the eyeball valve, use your index finger to rotate nozzle in the desired direction of air flow.

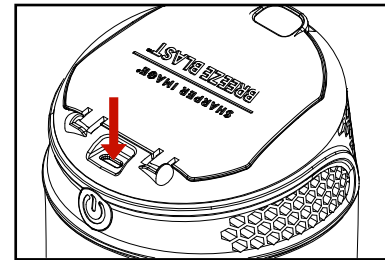

Optional USB power method: To power the device directly, connect a micro-USB power cord (included) into any USB powered port such as a computer, phone charger, or battery bank. **Use of power cord does not charge reusable batteries.**

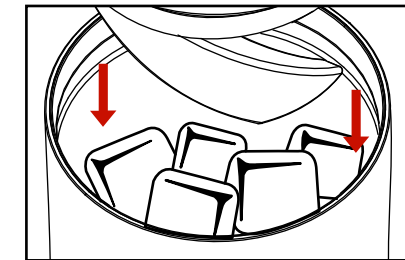

Optional cooling: The Breeze Blast™ cooling system works with ice as well. Add 2 cups of ice cubes (maximum). Remove excess ice if lid does not tighten properly. For best results, remove lid, pour out melted ice water, and replace ice as needed.

Cleaning & Maintenance

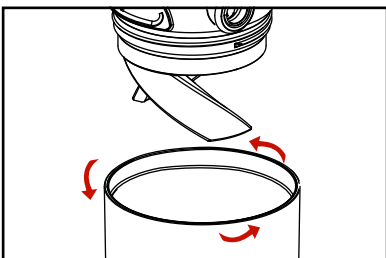

1. Rotate Breeze Blast™ lid counterclockwise to remove lid from body. Clean Breeze Blast™ base with a warm damp towel. **DO NOT WASH IN DISHWASHER.**

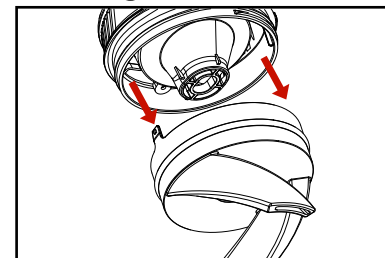

2. While holding on to the Breeze Blast™ lid, gently pull down on spiral to separate it from the Breeze Blast™ lid. Wipe with a warm damp towel.

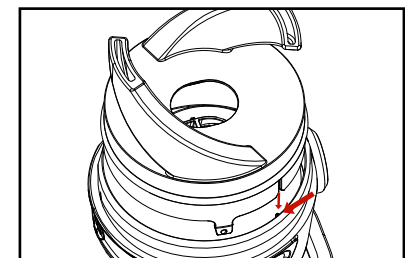

3. To reinstall the spiral vent, align the notch on the Breeze Blast™ lid with the groove on the spiral vent, and press down until flush.