

# WAY-FINDING+ ADDITIONAL FT.

NOSING- LIGHTS UP AS TRAVEL THROUGH THE STEPS

MUSICAL NOTES ON THE START OF EACH LEVEL.

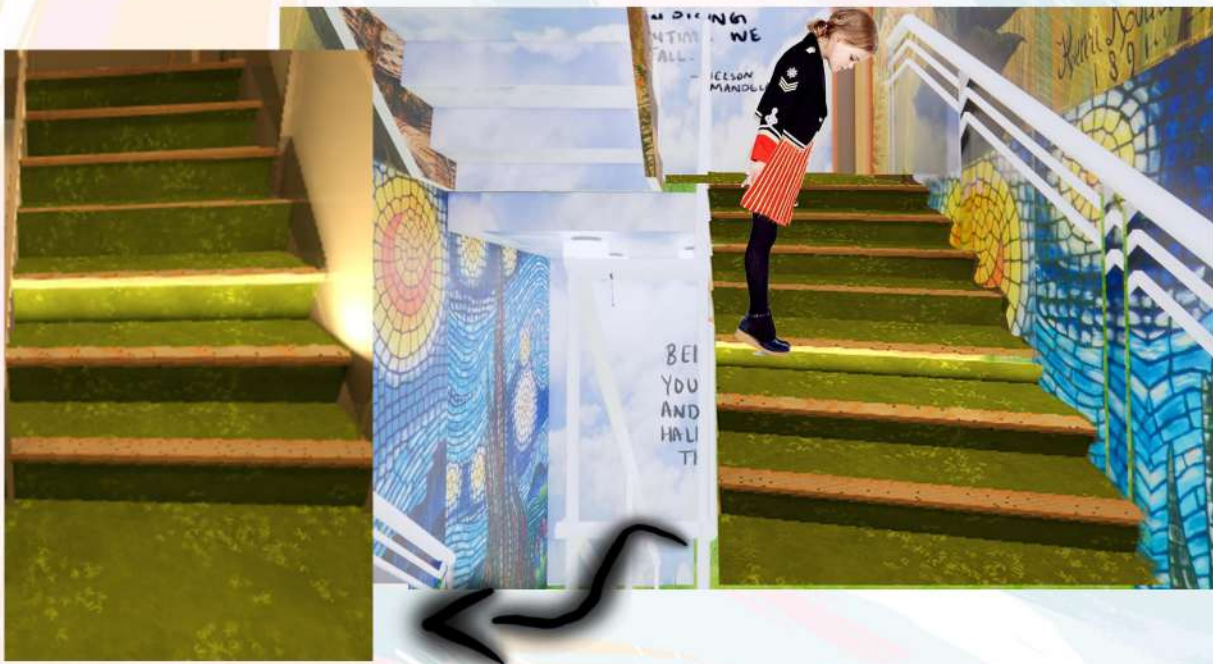

NEON  
SIGNAGE  
INDICATING  
FLOOR NO.



BRAILLE  
SIGNAGE

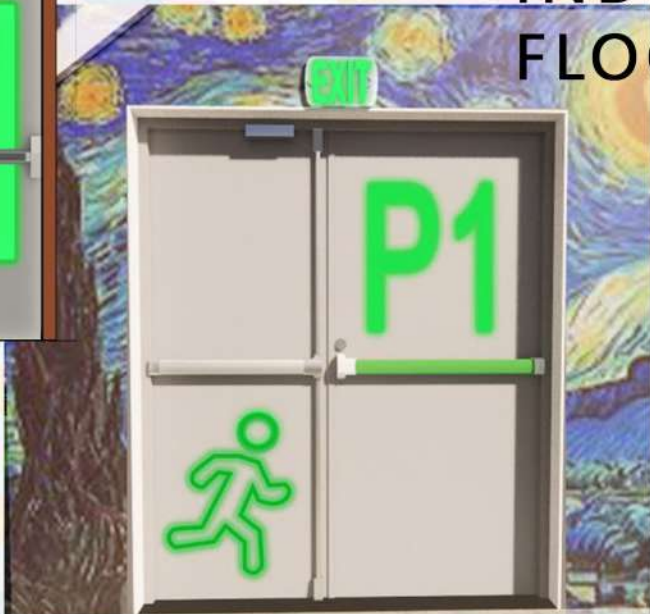

CROSS  
SECTION  
NO. 2

## OBC REQUIREMENTS

- Every exit door have an exit sign placed over it (9.9.11.3.(1))
- In a building more than 2 storeys in building height, any part of an exit stair that continues up or down past the lowest exit level is clearly marked by a sign indicating
- Emergency lighting will be provided in Exits
- The illumination will be not less than 50lx at the Exit (3.2.7.1.)
- Every exit is installed from the remainder of the building by a fire separation having a fire-resistance rating not less than 2 hours.
- (3.4.4.1.(1) , 3.4.4.1(2))- A fire-alarm system is installed in Exits
- A fire alarm system is installed in a building (3.2.4.1.(2))
- Smoke detectors is installed in each corridor serving as part of a means of egress and each public corridor and each exit stair shaft (3.2.4.12.(1))
- If a fire alarm system is required, heat detectors are installed (3.2.4.12.(2))
- Exits within scissors stairs and other contiguous exit stairways shall be separated from each other by a smoke-tight fire separation having a fire-resistance rating not less than that required for the floor assembly through which they pass. (3.4.4.4.(2))

## EMERGENCY EXIT LIGHTS



## POTLIGHTS



## CO2 DETECTOR





# DESIGN + MESSAGING



FEATURING FAMOUS ARTWORK  
THROUGH THE USE OF RECYCLED  
TILES IN A MOSAIC



NATURE- BASED  
PAINTED  
INCENTIVE  
LEVEL SYSTEM

LEVEL 1- GRASSY  
LEVEL 2- MOUNTAIN  
LEVEL 3- SKY

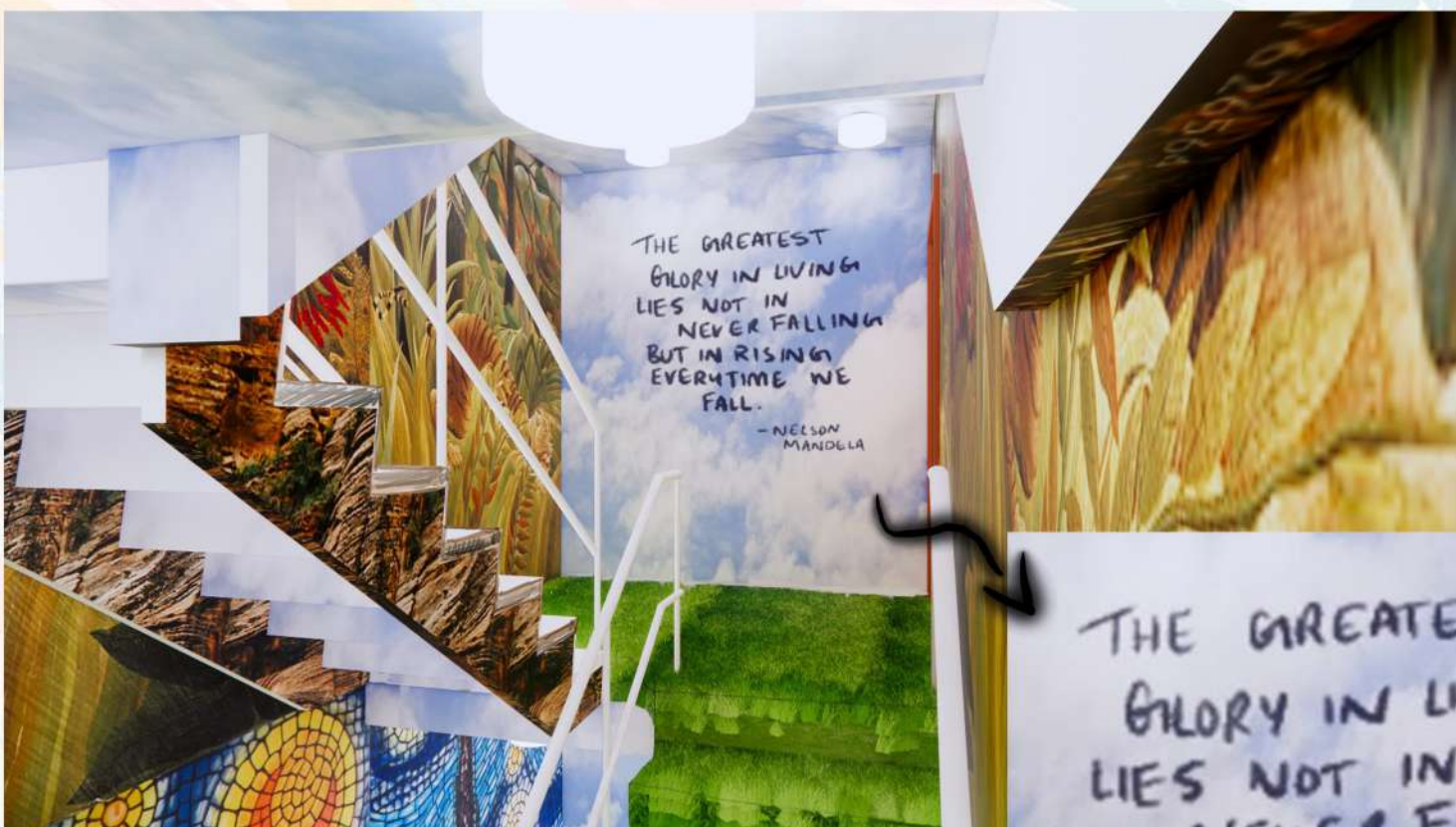

MOTIVATIONAL  
MESSAGES FROM  
FAMOUS FIGURES ON  
EVERY FLOOR

THE GREATEST  
GLORY IN LIVING  
LIES NOT IN  
NEVER FALLING  
BUT IN RISING  
EVERYTIME WE  
FALL.  
- NELSON  
MANDELA



# ACTIVE STAIRS TRAVEL GALLERY EDITION

LOCATED AT  
150 RIVER ST.

CROSS  
SECTION  
NO. 1

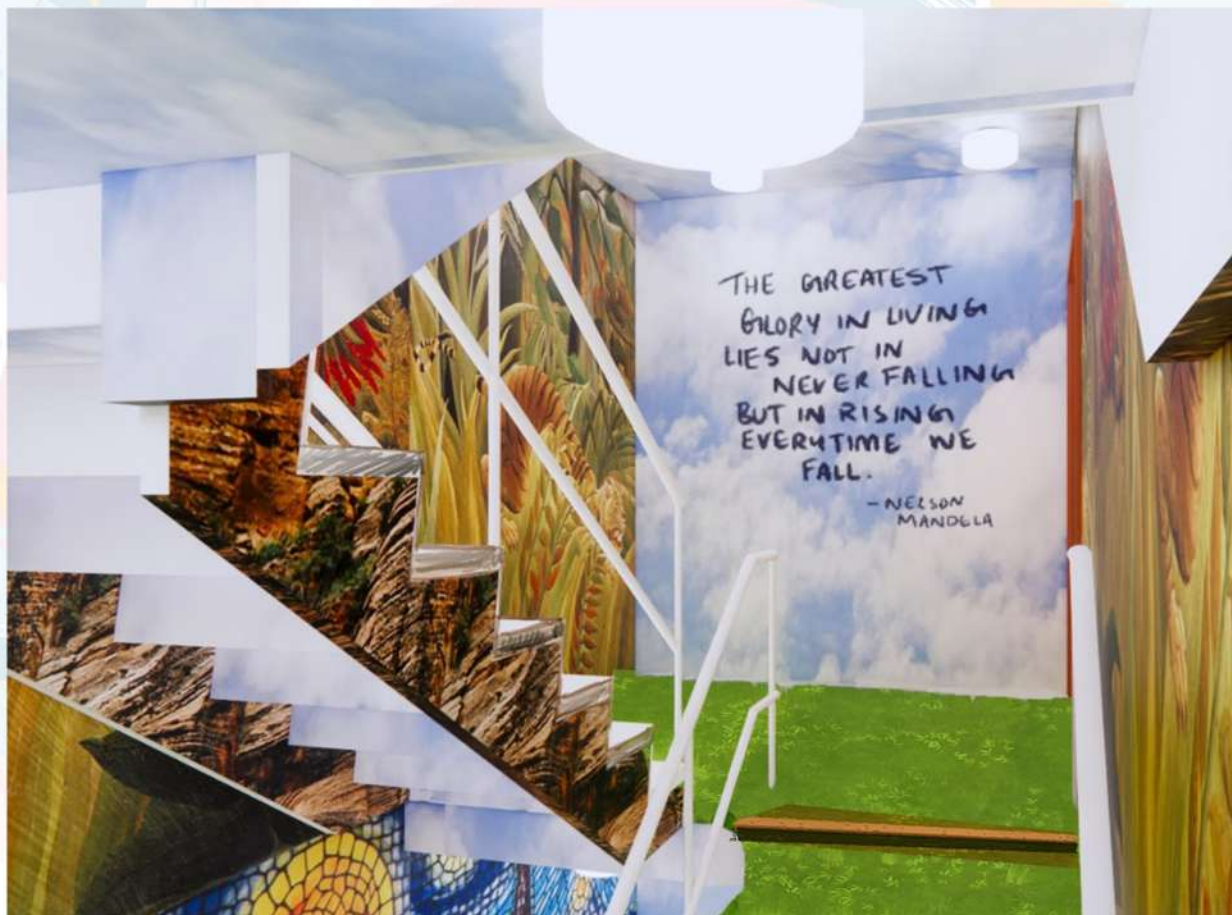

INSPIRED TO EXPLORE HISTORY &  
ART WHILST CLIMBING TO THE  
CLOUDS. #UP4COMMUNITY

**FEATURES:**  
SUSTAINABLE ART DECO  
NATURE- INSPIRED  
TRENDY WAY-FINDING PROMPTS  
MOTIVATIONAL DESIGN FEATURES  
CULTURALLY RICH  
FIRE SAFETY FEATURES

DSGN 3007  
PROF: VIZ SARABY  
PREPARED BY:  
BRITNEY ALI 101190100  
SADUF KHATRI 101208801  
YOONHA LEE 101199765

