

SOUTH ALABAMA REGIONAL AIRPORT (79J)

COVINGTON COUNTY, AL FOUR-UNIT HANGAR ALDOT PROJECT NO 79J-XXX GMC PROJECT NO TMGM220026 NOVEMBER 2022

INDEX

SHEET NO.	DESCRIPTION
Sheet 1	TITLE SHEET
Sheet 2	PROJECT LAYOUT AND CONSTRUCTION SAFETY PLAN
Sheet 3	TYPICAL SECTIONS
Sheet 4	SUMMARY OF QUANTITIES AND GENERAL NOTES
Sheet 5	EXISTING CONDITIONS
Sheet 6	DEMO PLAN
Sheet 7	LAYOUT PLAN
Sheet 8	GRADING PLAN
Sheet 9	T-HANGAR DETAILS
Sheet 10	MARKING PLAN
Sheet 11	ELECTRICAL PLAN

SOUTH ALABAMA REGIONAL AIRPORT



VICINITY MAP
N.T.S.

SOUTH ALABAMA REGIONAL AIRPORT

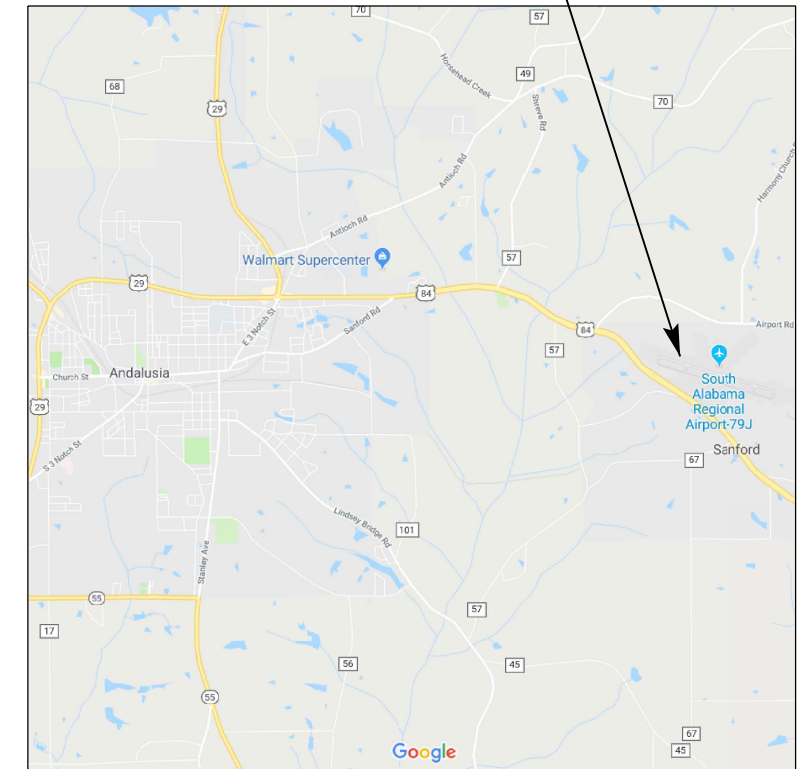

LOCATION MAP
N.T.S.

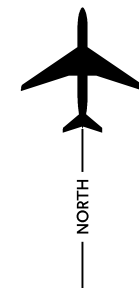

STATE MAP
N.T.S.

SOUTH ALABAMA REGIONAL AIRPORT

PLANS PREPARED BY:

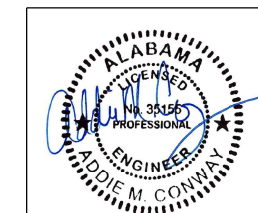

DATE: 10/12/2022

GMC

1906 East Three Notch Street
Andalusia, AL 36421
T 334.222.2699
GMCNETWORK.COM

REGISTERED ENGINEER
STATE OF ALABAMA

ADDIE M. CONWAY
LICENSE NO. 35155

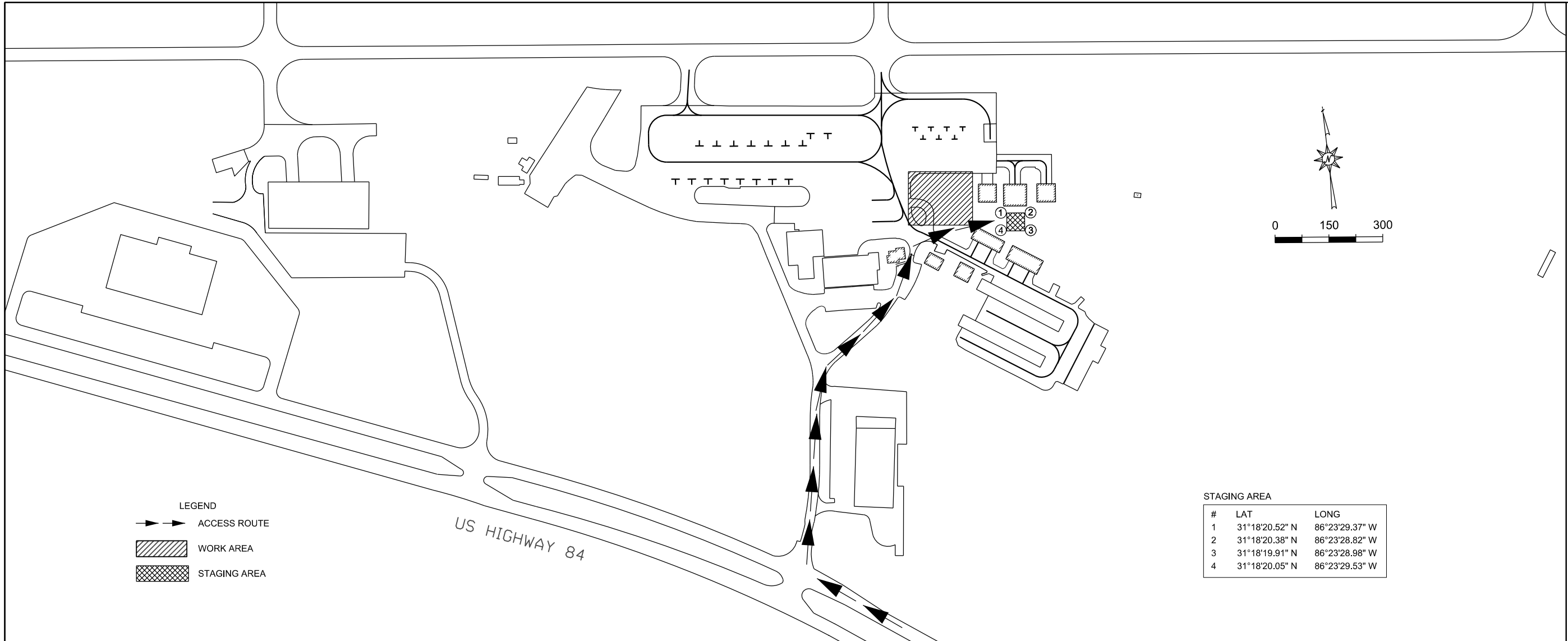

LEGEND

	ACCESS ROUTE
	WORK AREA
	STAGING AREA

GENERAL NOTES

1. THE PROJECT IS SUBJECT TO ALL INSPECTIONS PROVIDED IN THE CONTRACT DOCUMENTS AND TO INSPECTIONS BY REPRESENTATIVES OF THE AIRPORT, THE FEDERAL AVIATION ADMINISTRATION (FAA), THE ALABAMA DEPARTMENT OF ENVIRONMENTAL MANAGEMENT (ADEM), AND THE ALABAMA DEPARTMENT OF TRANSPORTATION (ALDOT).
2. THE CONTRACTOR SHALL COORDINATE ALL CONSTRUCTION ACTIVITIES WITH THE ENGINEER, AND OTHER CONTRACTORS AND UTILITY COMPANIES AT, OR IN CLOSE PROXIMITY TO THE SITE.
3. THE CONSTRUCTION EQUIPMENT STORAGE/STAGING AREAS ARE AS SHOWN. ANY DAMAGES CAUSED BY THE CONTRACTOR'S USE OF THESE AREAS MUST BE REPAIRED TO THE SATISFACTION OF THE OWNER.
4. SUFFICIENT VACUUM TYPE SWEEPERS AND CLEANING EQUIPMENT SHALL BE PROVIDED IN ORDER THAT ALL WASTE, LOOSE MATERIAL, AND DEBRIS CAN BE REMOVED FROM ALL AIRPORT OPERATIONS AREAS. ALL LOOSE MATERIAL SHALL BE COMPLETELY REMOVED FROM PAVED AND TURFED AREAS WITHIN SAFETY AREAS. PAVEMENT CLEANING EQUIPMENT SHALL BE MAINTAINED ON SITE AT ALL TIMES IN SUFFICIENT QUANTITY AND CAPACITY TO CLEAN ALL PAVEMENTS.
5. THE CONTRACTOR MUST VERIFY THE EXACT LOCATION OF EXISTING UNDERGROUND ELECTRICAL CABLES. IN THE EVENT THAT THE CONTRACTOR DAMAGES A CABLE, THE ENGINEER AND THE CITY MUST BE NOTIFIED IMMEDIATELY. THE REPAIR MUST BE STARTED IMMEDIATELY AND CONTINUE UNTIL COMPLETED. ALL SUCH REPAIRS SHALL BE AT THE CONTRACTOR'S EXPENSE AND SHALL BE INSPECTED AND APPROVED BY THE OWNER PRIOR TO BACKFILLING BY THE CONTRACTOR. IF REQUIRED BY THE ENGINEER, THE CONTRACTOR SHALL SUPPLY AND INSTALL A CONCRETE SPLICE MARKER AT ALL APPLICABLE LOCATIONS.

6. THE LOCATION OF ACCESS ROUTES ON THE AIRPORT SITE ARE AS SHOWN AND ARE SUBJECT TO CHANGE. IT SHALL BE THE CONTRACTOR'S RESPONSIBILITY TO COORDINATE OFF-SITE ACCESS ROUTES (STATE HIGHWAYS, LOCAL ROADS, OR CITY STREETS) WITH THE APPROPRIATE OWNER HAVING JURISDICTION OVER THE AFFECTED ROUTE. CONTRACTOR PERMISSION TO USE PUBLIC ROADS FOR HAULING AND ACCESS MUST BE OBTAINED FROM THE APPROPRIATE PUBLIC ENTITIES. IT IS THE SOLE RESPONSIBILITY OF THE CONTRACTOR TO OBTAIN ALL NECESSARY PERMITS, APPROVALS, AND BONDING. THE CONTRACTOR MUST DETERMINE WHICH NON-AIRPORT ROADS MUST BE BONDED, AND MUST BOND SUCH ROADS.
7. THE BEFORE AND AFTER CONDITION OF ON-SITE ACCESS ROUTES SHALL BE JOINTLY INSPECTED AND PHOTOGRAPHED BY THE CONTRACTOR AND THE ENGINEER. ON-SITE ACCESS ROUTES SHALL BE MAINTAINED BY THE CONTRACTOR THROUGHOUT CONSTRUCTION AND RESTORED UPON COMPLETION OF CONSTRUCTION IN ACCORDANCE WITH THE CONTRACT DOCUMENTS. FENCING, DRAINAGE, GRADING, E&S CONTROLS, AND OTHER MISCELLANEOUS CONSTRUCTION REQUIRED TO CONSTRUCT ADDITIONAL HAUL ROUTES OR ACCESS POINTS ON THE AIRPORT WILL BE THE CONTRACTOR'S RESPONSIBILITY, AND SHALL BE APPROVED BY THE ENGINEER PRIOR TO THE COMMENCEMENT OF WORK. ALL ROADS TO AIRPORT FACILITIES SHALL REMAIN OPEN AND MAINTAINED AT ALL TIMES. ALL CONTRACTOR VEHICLES AND CONSTRUCTION TRAFFIC SHALL REMAIN WITHIN THE DESIGNATED CONSTRUCTION LIMITS OR HAUL ROUTES UNLESS OTHERWISE AUTHORIZED.
8. THE CONTRACTOR IS RESPONSIBLE FOR THE PROTECTION OF AIRPORT PAVEMENT AND LIGHTING DURING CONSTRUCTION. ALL DAMAGE RESULTING FROM THE CONTRACTOR'S ACTIONS SHALL BE REPAIRED IMMEDIATELY AT THE CONTRACTOR'S EXPENSE. ANY DELAYS IN REOPENING PORTIONS OF THE AIRPORT DUE TO THIS DAMAGE WILL RESULT IN THE ASSESSMENT OF LIQUIDATED DAMAGES AS SET FORTH IN THE CONTRACT DOCUMENTS.

SAFETY NOTES

1. ALL CONSTRUCTION VEHICLES AND EQUIPMENT OPERATING ON THE AIRPORT PROPERTY SHALL BE MARKED WITH STANDARD FAA WARNING FLAGS OR BEACONS. VEHICLES AND EQUIPMENT OPERATING DURING HOURS OF DARKNESS OR REDUCED VISIBILITY SHALL BE LIGHTED WITH A FLASHING CIRCULAR AMBER EMERGENCY WARNING LIGHT, ACCORDING TO FAA ADVISORY CIRCULAR 150/5370-2G.
2. ALL FOREMAN'S AND SUPERINTENDENT'S VEHICLES SHALL CONTAIN RADIOS CAPABLE OF TRANSMITTING AND RECEIVING THE UNICOM FREQUENCY OF 122.8 MHZ. NORMAL RADIO COMMUNICATIONS BETWEEN CONTRACTOR PERSONNEL WILL NOT BE ALLOWED ON THE UNICOM CONTROL OR ANY OTHER FAA FREQUENCY.
3. THE CONTRACTOR SHALL GIVE A 3 WEEK NOTICE BEFORE CONSTRUCTION SO A NOTAM CAN BE ISSUED.
4. ALL OPEN EXCAVATIONS SHALL BE ADEQUATELY MARKED AND SIGNED.
5. THE CONTRACTOR SHALL NOT AT ANY TIME BE ON THE RUNWAY OR THE RUNWAY SAFETY AREA UNLESS THE ENGINEER OR AIRPORT PERSONNEL GIVES PRIOR APPROVAL.
6. THE CONTRACTOR IS RESPONSIBLE FOR ALL CONSTRUCTION, MAINTENANCE, REMOVAL AND CLEANUP OF ALL HAUL ROUTES (ON AND OFF AIRPORT PROPERTY).
7. RUNWAY WILL BE CLOSED FOR ANY WORK PERFORMED IN THE RSA.
8. NO EQUIPMENT OR VEHICLES SHALL BE STAGED IN THE OFA DURING NON WORKING HOURS.



1906 East Three Notch Street
 Andalusia, AL 36421
 T 334.222.2699
 GMCNETWORK.COM

	ISSUE DATE
90%	09/14/2022
100%	10/12/2022
drawn by:	EDW
checked by:	AMC

**SOUTH ALABAMA REGIONAL AIRPORT
 FOUR-UNIT HANGAR**
 COVINGTON COUNTY, ALABAMA

79J-XXX

TMGM220026

SCALE: 1" = 150'

**PROJECT LAYOUT AND
 CONSTRUCTION SAFETY PLAN**

2

sheet 2 of 11

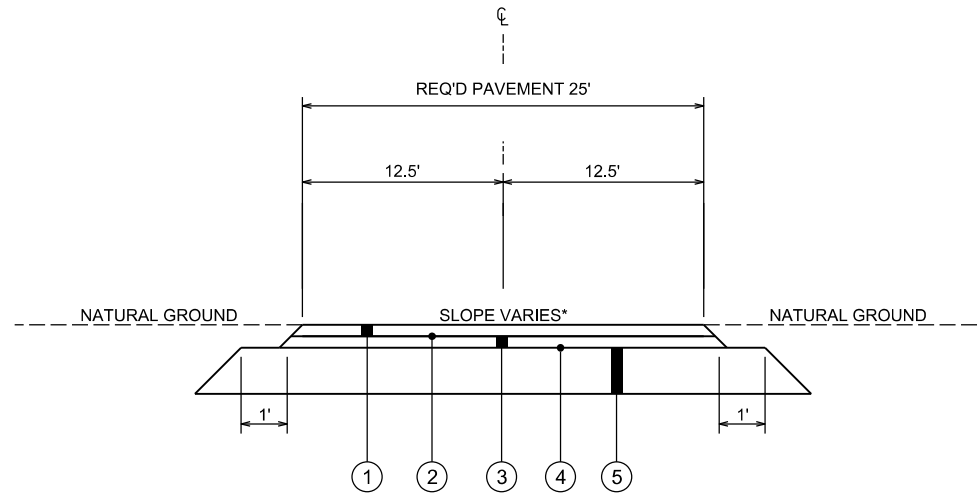

**TYPICAL SECTION TO BE USED FOR:
TAXILANE CONNECTOR**

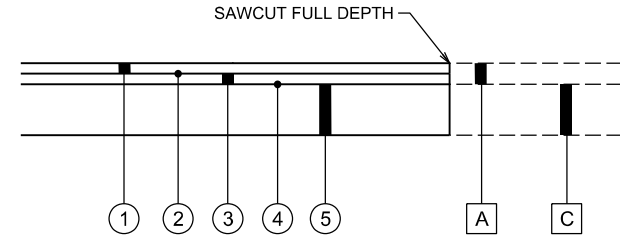

PROJECT TIE IN DETAIL

NOTE:
WHERE PORTIONS OF EXISTING PAVEMENT ARE TO REMAIN AND JOIN THE SURFACE OF THE NEW WORK, THEY SHALL BE CUT OFF TO A NEAT LINE WITH VERTICAL FACE USING SAWS OR OTHER APPROVED EQUIPMENT THAT WILL NOT DAMAGE THE RETAINED PORTION OF WORK. THIS WORK SHALL BE A SUBSIDIARY OBLIGATION OF ITEM 210A-000, UNCLASSIFIED EXCAVATION. ANY DAMAGE PAVEMENT WILL BE REPAIRED AT THE CONTRACTOR'S EXPENSE AS DIRECTED BY THE RPR.

* SEE GRADING PLAN FOR SLOPES

REQUIRED PAVEMENT SCHEDULE LEGEND

LEGEND	ITEM NO.	DESCRIPTION
1	424A-360	SUPERPAVE BITUMINOUS CONCRETE WEARING SURFACE LAYER, 1/2" MAXIMUM AGGREGATE SIZE MIX, ESAL RANGE C/D (APPROXIMATELY 165 LBS/SQ YD)
2	405A-000	TACK COAT
3	424B-002	SUPERPAVE BITUMINOUS CONCRETE UPPER BINDER LAYER, 1/2" MAXIMUM AGGREGATE SIZE MIX, ESAL RANGE C/D (APPROXIMATELY 165 LBS/SQ YD)
4	401A-000	BITUMINOUS TREATMENT A
5	301A-012	CRUSHED AGGREGATE BASE COURSE, TYPE B, PLANT MIXED, 6" COMPACTED THICKNESS
A	----	EXISTING PAVEMENT (RETAIN)
B	----	EXISTING BASE (RETAIN)



1906 East Three Notch Street
Andalusia, AL 36421
T 334.222.2699
GMCNETWORK.COM

ISSUE DATE	
90%	09/14/2022
100%	10/12/2022
drawn by:	EDW
checked by:	AMC

SOUTH ALABAMA REGIONAL AIRPORT
FOUR-UNIT HANGAR
COVINGTON COUNTY, ALABAMA

79J-XXX
TMGM220026
SCALE: NOT TO SCALE

TYPICAL SECTIONS

BASE BID

TOTAL	ITEM NO.	UNIT	DESCRIPTION
1	H-100	LS	T-Hangar Building with Rolling Doors, Complete in Place (Includes Foundation, Building, Utilities, etc.)

ADD ALT #1

TOTAL	ITEM NO.	UNIT	DESCRIPTION
131	206D-011	LF	Removing Fence
1,200	210A-000	CU YD	Unclassified Excavation
200	210D-021	CU YD	Borrow Excavation (Loose Truckbed Measurement) (A4 or Better)
810	301A-012	SQ YD	Crushed Aggregate Base Course, Type B, Plant Mixed, 6" Compacted Thickness
810	401A-000	SQ YD	Bituminous Treatment A
80	405A-000	GAL	Tack Coat
75	424A-360	TON	Superpave Bituminous Concrete Wearing Surface Layer, 1/2" Maximum Aggregate Size, ESAL Range C/D (Approximately 165 lbs/sy)
75	424B-002	TON	Superpave Bituminous Concrete Upper Binder Layer, 1/2" Maximum Aggregate Size, ESAL Range C/D (Approximately 165 lbs/sy)
200	650B-000	CU YD	Topsoil From Stockpiles
1	652A-100	ACRE	Seeding
1	656A-010	ACRE	Mulching
60	665Q-002	LF	Wattle
1	C-105	LS	Mobilization
500	P-620-5.2a	SQ FT	Marking (Includes Reflective Media)
500	P-620-5.2b	SQ FT	Temporary Runway and Taxiway Marking

GENERAL NOTES

100. THE CONTRACTOR SHALL BE RESPONSIBLE FOR OBTAINING ANY AND ALL PERMITS REQUIRED AND BE IN POSSESSION OF ALL REQUIRED PERMITS PRIOR TO ANY CONSTRUCTION EFFORTS.
101. ANY CHANGES OR REVISIONS MADE TO THE PLANS SHALL BE APPROVED BY THE ENGINEER PRIOR TO MAKING REVISIONS IN THE FIELD.
102. ALL DIMENSIONS SHOWN ARE TO EDGE OF PAVEMENT, CENTER OF STRIPE, CENTER OF RUNWAY/TAXIWAY LIGHT, OR AS CALLED OUT IN THE PLANS. DIMENSIONS GIVEN TO EXISTING IMPROVEMENTS ARE TO BE CONSIDERED APPROXIMATE AND ARE TO CONVEY INTENT, SIGNIFICANT DISCREPANCIES SHOULD BE BROUGHT TO THE ATTENTION OF THE PROJECT ENGINEER IMMEDIATELY.
103. ALL WATERBORNE PAINT SHALL CONTAIN A MICROBICIDE THAT PROVIDES MICROBIAL EFFICACY FOR A PERIOD OF NO LESS THAN 3 YEARS. THE MICROBICIDE SHALL BE BLENDED HOMOGENEOUSLY WITH THE PAINT UNDER HIGH SPEED DISPERSION DURING PRODUCTION BY THE SUPPLIER/MANUFACTURER. THE FINAL HOMOGENOUS BLEND OF MICROBICIDE TREATED PAINT SHALL CONFORM TO THE SAME VISCOSITY STABILITY STANDARDS AS SPECIFIED IN TT-P-1952 F.
 - A. DOW (FORMERLY ROHM AND HASS) ROCIMA 63 MICROBICIDE (OR OTHER APPROVED EQUIVALENT) SHALL BE ADDED AT A RATE OF 10 POUNDS PER 100 GALLONS OF PAINT.
 - B. OTHER PRODUCTS MAY BE AVAILABLE THAT MEET OR EXCEED THESE SPECIFICATIONS.
104. ALL MARKINGS SHALL CONFORM TO FAA ADVISORY CIRCULAR 150/5340-1M FOR AIRPORT MARKINGS.
105. REMOVAL OF PAVMENT AND BUSHES/SHRUBS SHALL BE A SUBSIDIARY OBLIGATION OF ITEM 210A-000, UNCLASSIFIED EXCAVATION.
106. ITEM H-100-11.1 T-HANGAR BUILDING WITH ROLLING DOORS, COMPLETE IN PLACE, SHALL INCLUDE THE FURNISHING OF ALL MATERIALS NEEDED FOR CONSTRUCTION OF THE T-HANGAR BUILDING, THE FOUNDATION, THE CONSTRUCTION AND/OR INSTALLATION OF THE MATERIALS INTO COMPLETE, OPERATIONAL UNITS, AND SHALL INCLUDE ALL EQUIPMENT, TOOLS, LABOR, AND INCIDENTALS NECESSARY TO COMPLETE THE WORK
107. ALL MATERIALS AND WORK SHOWN ON THE ELECTRICAL PLAN SHEETS SHALL BE A SUBSIDIARY OBLIGATION OF ITEM H-100-11.1 T-HANGAR BUILDING WITH ROLLING DOORS, COMPLETE IN PLACE.



1906 East Three Notch Street
 Andalusia, AL 36421
 T 334.222.2699
 GMCNETWORK.COM

ISSUE DATE	90%	100%	drawn by:	checked by:
09/14/2022			EDW	AMC
10/12/2022				

**SOUTH ALABAMA REGIONAL AIRPORT
 FOUR-UNIT HANGAR**
 COVINGTON COUNTY, ALABAMA





79J-XXX
 TMGM220026

SCALE: NOT TO SCALE

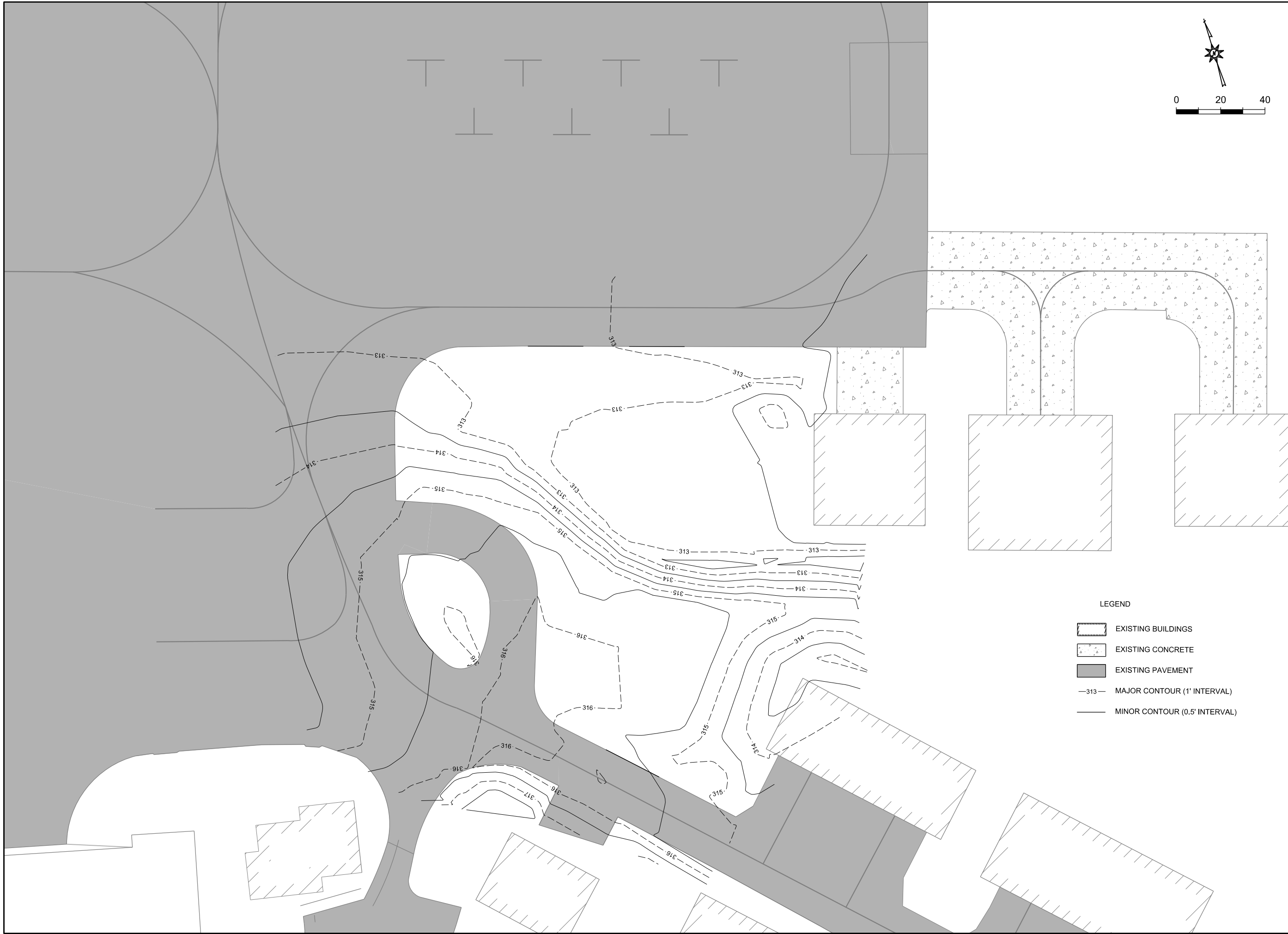
**SUMMARY OF QUANTITIES
 AND PROJECT NOTES**

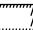
4
 sheet 4 of 11

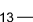

- LEGEND**
-  EXISTING BUILDINGS
 -  EXISTING CONCRETE
 -  EXISTING PAVEMENT
 -  -313- MAJOR CONTOUR (1' INTERVAL)
 -  MINOR CONTOUR (0.5' INTERVAL)

EXISTING CONDITIONS

**SOUTH ALABAMA REGIONAL AIRPORT
FOUR-UNIT HANGAR**
COVINGTON COUNTY, ALABAMA

**79J-XXX
TMGM220026
SCALE: 1" = 20'**

5
sheet 5 of 11

ISSUE DATE	ISSUE DATE
90% 09/14/2022	
100% 10/12/2022	
drawn by: EDW	
checked by: AMC	

GMC
1906 East Three Notch Street
Andalusia, AL 36421
T 334.222.2699
GMCNETWORK.COM

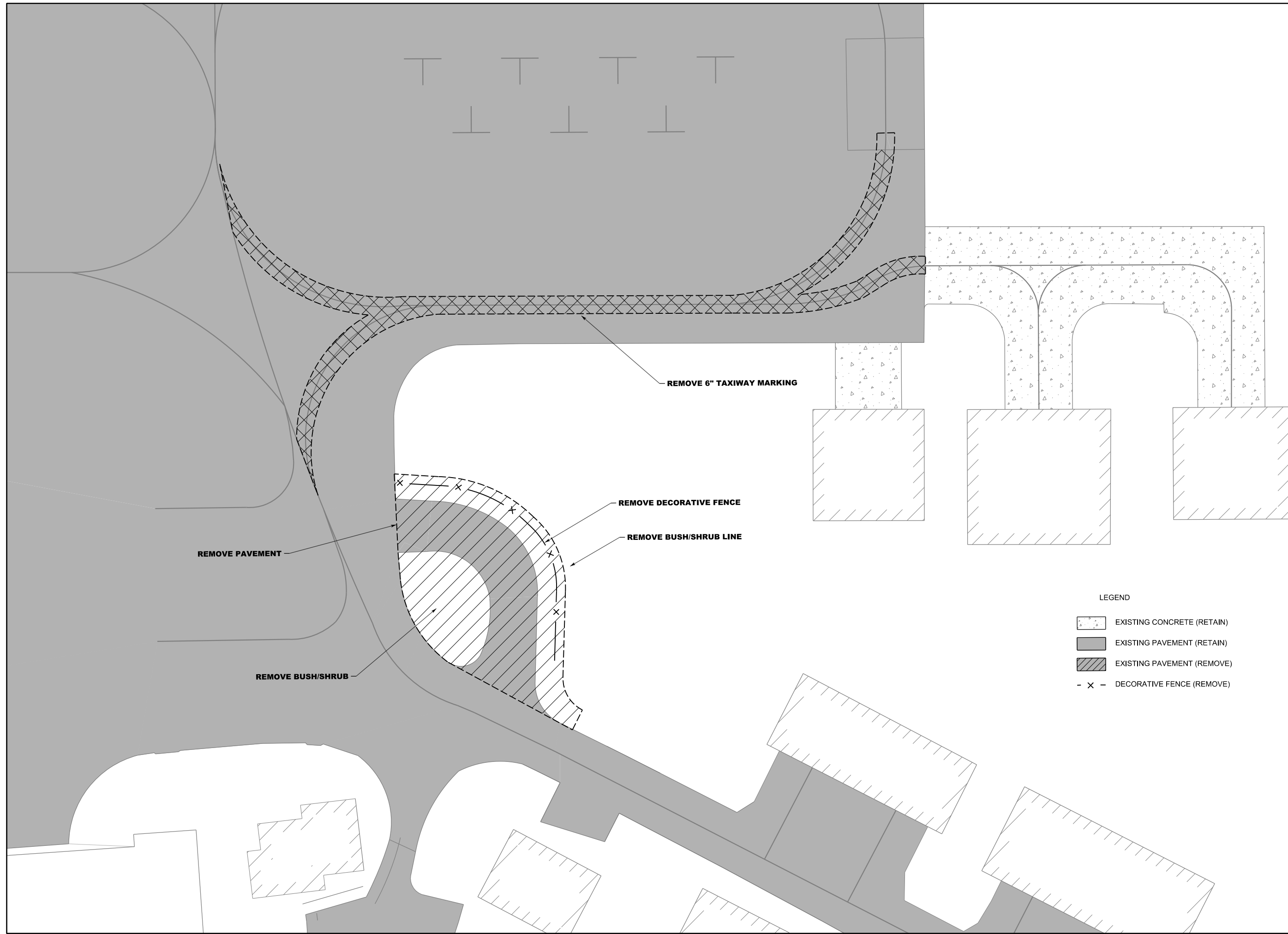

- LEGEND
- [Pattern] EXISTING CONCRETE (RETAIN)
 - [Pattern] EXISTING PAVEMENT (RETAIN)
 - [Pattern] EXISTING PAVEMENT (REMOVE)
 - x - DECORATIVE FENCE (REMOVE)

DEMO PLAN

SOUTH ALABAMA REGIONAL AIRPORT
FOUR-UNIT HANGAR
COVINGTON COUNTY, ALABAMA

ISSUE DATE

90%	09/14/2022
100%	10/12/2022
drawn by:	EDW
checked by:	AMC

1906 East Three Notch Street
Andalusia, AL 36421
T 334.222.2699
GMCNETWORK.COM



79J-XXX
TMGM220026

SCALE: 1" = 20'

6
sheet 6 of 11

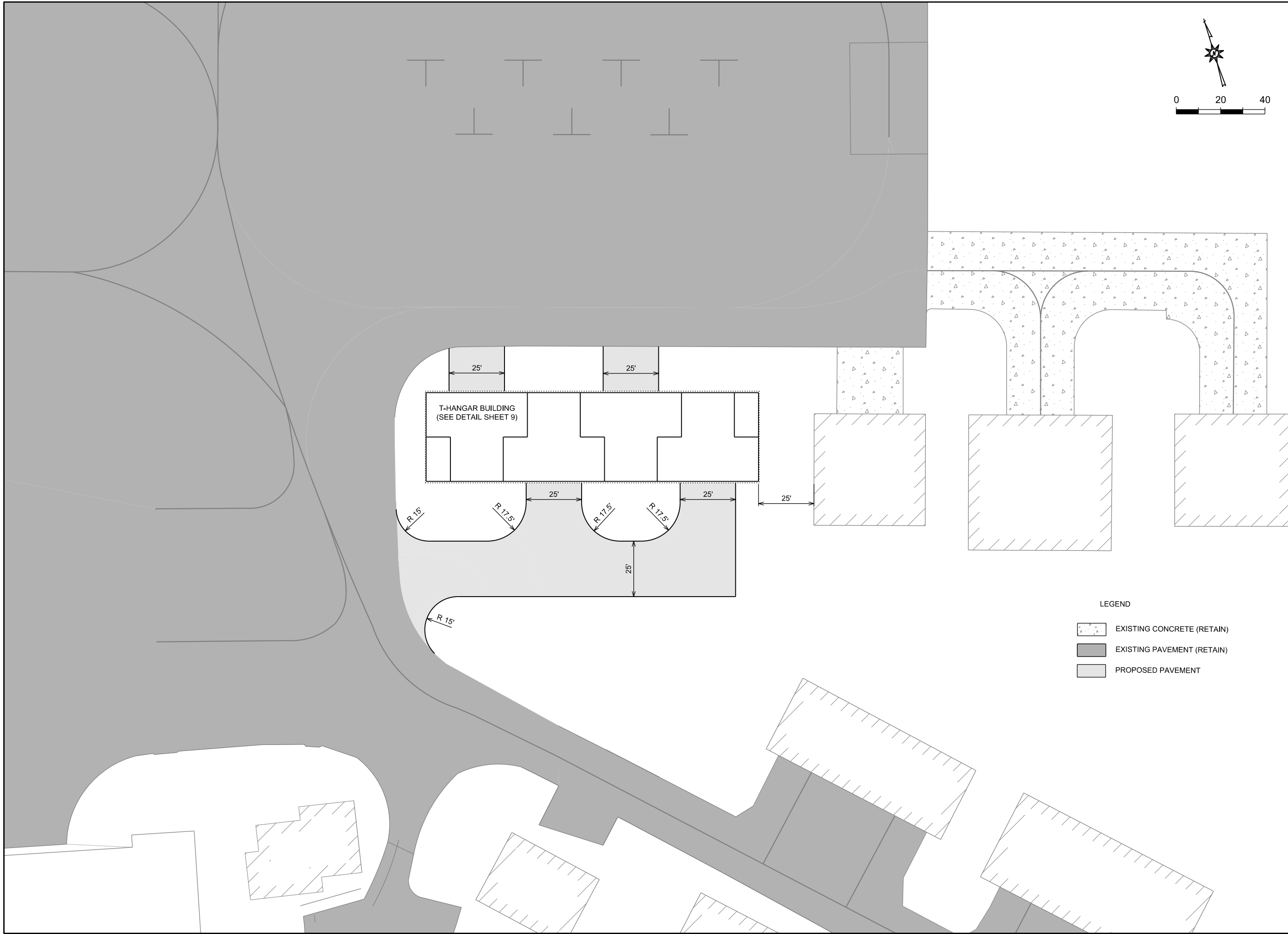

- LEGEND
- EXISTING CONCRETE (RETAIN)
 - EXISTING PAVEMENT (RETAIN)
 - PROPOSED PAVEMENT

SITE LAYOUT

SOUTH ALABAMA REGIONAL AIRPORT
FOUR-UNIT HANGAR
 COVINGTON COUNTY, ALABAMA

79J-XXX
 TMGM220026
 SCALE: 1" = 20'

7

sheet 7 of 11

ISSUE DATE

90%	09/14/2022
100%	10/12/2022

drawn by: EDW







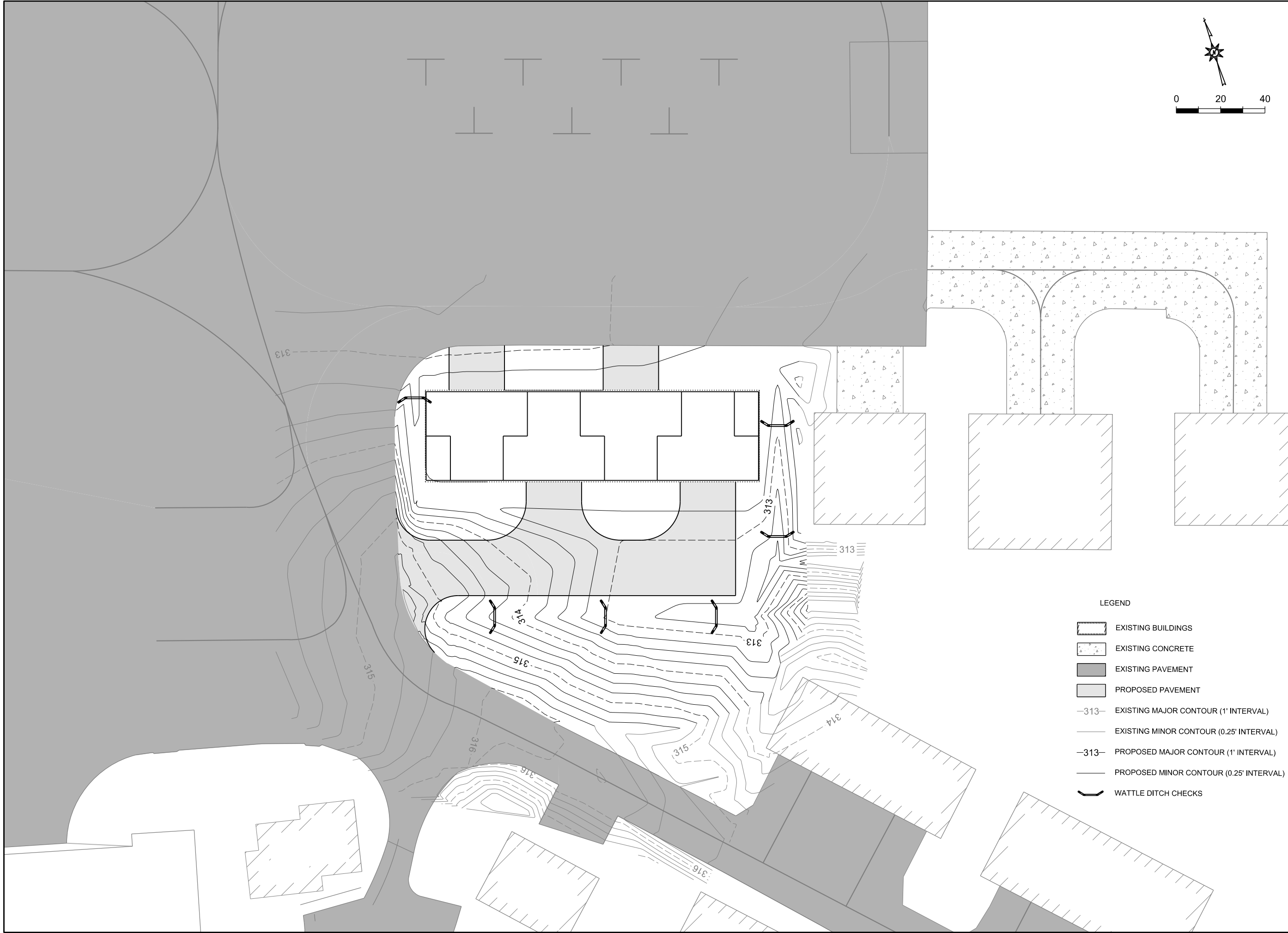

checked by: AMC

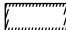
1906 East Three Notch Street
 Andalusia, AL 36421
 T 334.222.2699
 GMCNETWORK.COM





LEGEND

	EXISTING BUILDINGS
	EXISTING CONCRETE
	EXISTING PAVEMENT
	PROPOSED PAVEMENT
	-313- EXISTING MAJOR CONTOUR (1' INTERVAL)
	EXISTING MINOR CONTOUR (0.25' INTERVAL)
	-313- PROPOSED MAJOR CONTOUR (1' INTERVAL)
	PROPOSED MINOR CONTOUR (0.25' INTERVAL)
	WATTLE DITCH CHECKS

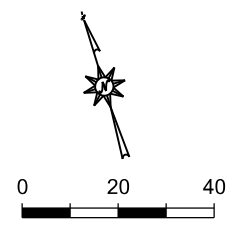

GRADING PLAN

**SOUTH ALABAMA REGIONAL AIRPORT
FOUR-UNIT HANGAR**
COVINGTON COUNTY, ALABAMA

**79J-XXX
TMGM220026
SCALE: 1" = 20'**

ISSUE DATE	ISSUE DATE
90% 09/14/2022	
100% 10/12/2022	
drawn by: EDW	
checked by: AMC	

GMC
1906 East Three Notch Street
Andalusia, AL 36421
T 334.222.2699
GMCNETWORK.COM



1906 East Three Notch Street
 Andalusia, AL 36421
 T 334.222.2699
 GMCNETWORK.COM

ISSUE DATE	
90%	09/14/2022
100%	10/12/2022
drawn by:	EDW
checked by:	AMC

SOUTH ALABAMA REGIONAL AIRPORT
 FOUR-UNIT HANGAR
 COVINGTON COUNTY, ALABAMA

79J-XXX
 TMGM220026
 SCALE: NOT TO SCALE

T-HANGAR DETAILS

9
 sheet 9 of 11

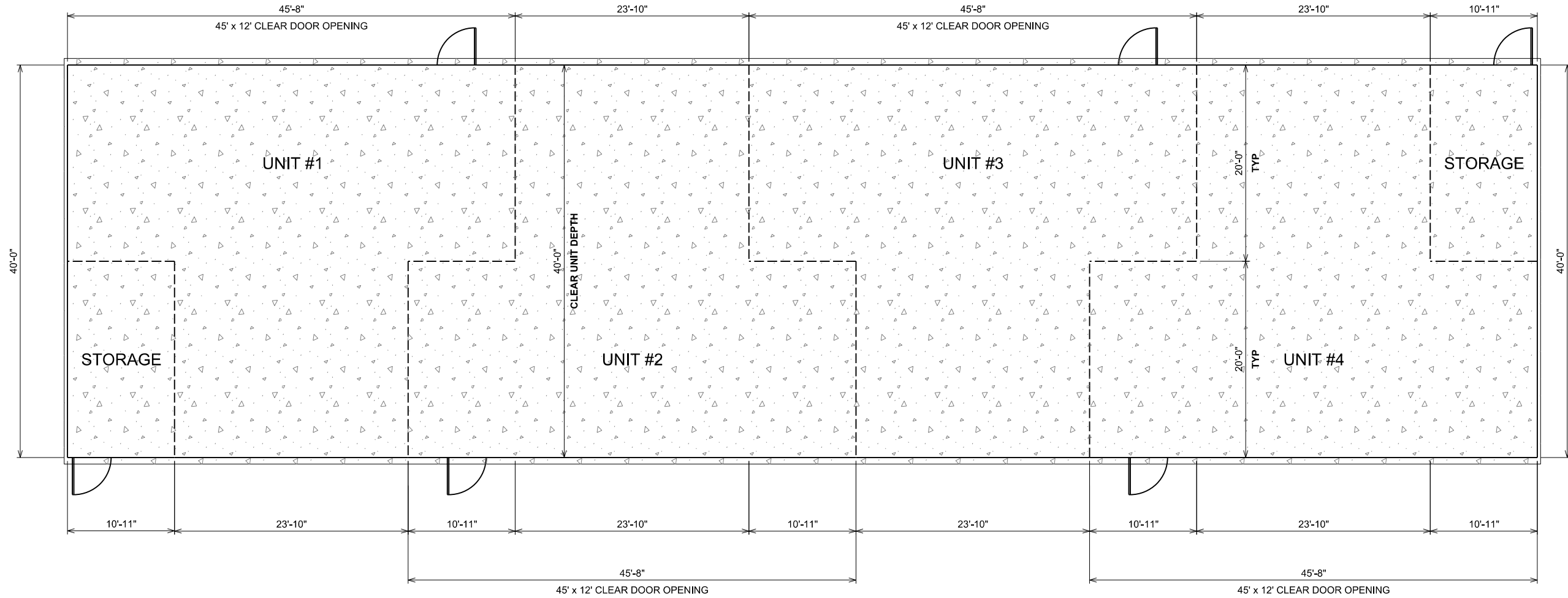

NOTES:

1. A STANDARDIZED FOUNDATION PLAN WILL NOT BE PROVIDED FOR THIS BID AS THIS MAY LIMIT THE PROJECT TO CERTAIN BUILDING MODELS AND/OR MANUFACTURERS. IN ORDER TO PROVIDE THE MOST ECONOMICAL PRODUCT FOR THE OWNER, THE CONTRACTOR IS TO PROVIDE A FOUNDATION AND BUILDING DESIGN SUFFICIENT TO OBTAIN THE MINIMUM CLEAR WIDTHS, HEIGHTS, AND DEPTHS AS SPECIFIED IN THE PLAN SET.
2. NO WATER/SEWER WILL BE REQUIRED FOR THE T-HANGAR BUILDING.
3. SPRAY FOAM INSULATION WILL BE REQUIRED FOR THE ROOF OF THE T-HANGAR BUILDING.

- KEYED NOTES (#):**
- INTERCONNECT EACH OCCUPANCY SENSOR IN THIS AREA SO EACH SENSOR WILL OPERATE AS ONE.
 - CONNECT TO UNSWITCHED HOTLEG SO THAT UNIT WILL OPERATE UPON POWER FAILURE.
 - ALL RECEPTACLES IN HANGAR ARE TO BE GFCI RATED AND MOUNTED AT 48" AFF.
 - VERIFY FINAL LOCATION OF HANGAR RECEPTACLES WITH OWNER PRIOR TO ROUGH-IN.
 - PROVIDE 3 #2 - 1-1/2" C FROM NEW PANEL 'LA' TO UTILITY RISER POLE THROUGH UTILITY METER. CONTRACTOR TO COORDINATE WITH OWNER AND LOCAL UTILITY COMPANY FOR NEW ELECTRICAL SERVICE TO BUILDING AND ALL ASSOCIATED FEES PRIOR TO BID.
 - UTILITY METER - COORDINATE WITH UTILITY COMPANY.
 - GROUND NEW PANEL 'LA' AS PER NEC REQUIREMENTS.

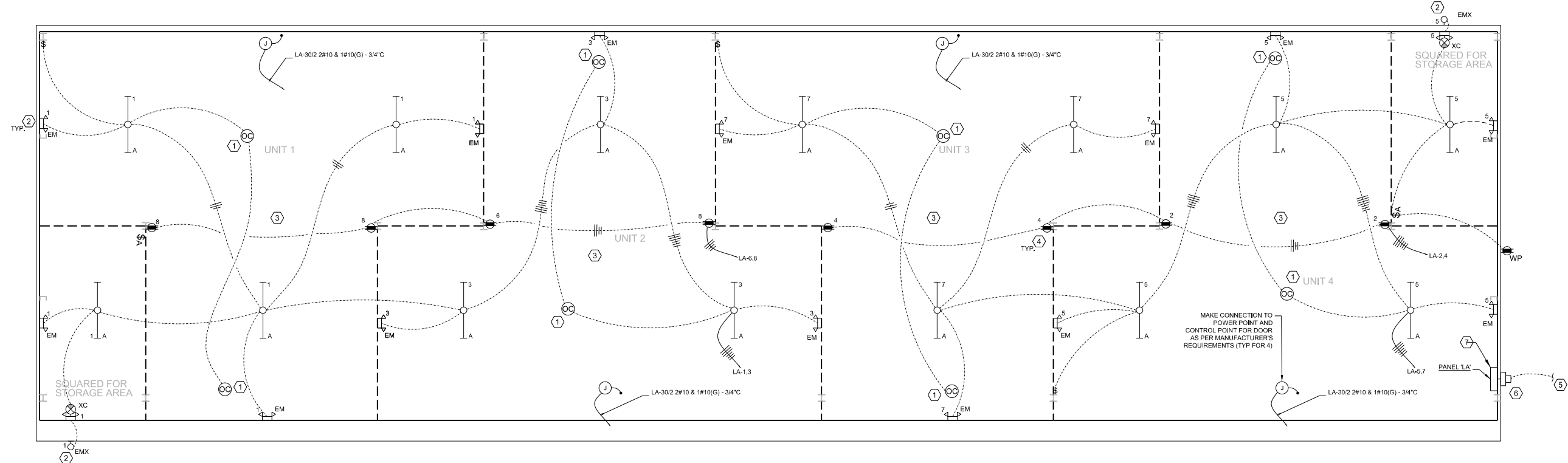

PANELBOARD LA SCHEDULE

LOCATION: HANGER		MAIN: 100 A MCB		SERVICE ENTRANCE RATED					
VOLTAGE: 120/240		SYSTEM: 1Ø, 3 WIRE							
INTERRUPTING RATING: 10K AIC									
CKT #	LOAD DESCRIPTION	BREAKER		PHASE (KW)		BREAKER		LOAD DESCRIPTION	CKT #
		P	TRIP	A	B	A	B		
1	LIGHTING	1	20	1.2	0.6	20	1	UNIT 4 RECEPTACLES	2
3	LIGHTING	1	20	1.2	0.4	20	1	UNIT 3 RECEPTACLES	4
5	LIGHTING	1	20	1.2	0.4	20	1	UNIT 2 RECEPTACLES	6
7	LIGHTING	1	20	1.2	0.4	20	1	UNIT 1 RECEPTACLES	8
9	BUSSED SPACE							BUSSED SPACE	10
11	BUSSED SPACE							BUSSED SPACE	12
13	BUSSED SPACE							BUSSED SPACE	14
15	BUSSED SPACE							BUSSED SPACE	16
17	HANGAR DOOR - UNIT 1	2	30	0.9	0.9	30	2	HANGAR DOOR - UNIT 2	18
19				0.9	0.9				20
21	HANGAR DOOR - UNIT 3	2	30	0.9	0.9	30	2	HANGAR DOOR - UNIT 4	22
23				0.9	0.9				24

ELECTRICAL LEGEND

	CONDUIT OR RACEWAY CONCEALED IN WALLS OR CEILINGS.
	CONDUIT OR RACEWAY EXPOSED TO VIEW, RUN PARALLEL OR PERPENDICULAR TO STRUCTURE.
	JUNCTION BOX WALL/CEILING MOUNTED AS REQUIRED WITH FLEXIBLE CONNECTION TO DOOR AS PER MANUFACTURER'S REQUIREMENTS.
	EXPOSED HOMERUN TICKS INDICATE NUMBER OF CONDUCTORS NO TICKS INDICATE HOT, NEUTRAL, AND GROUND.
	4' LED STRIP SURFACE MOUNTED METALLIX #4SLSTP4040DD-120V OR APPROVED EQUIVALENT.
	WALL SWITCH, SPST 48" A.F.F. TO CENTER UNO 120/277V.
	DUPLEX GROUND FAULT CIRCUIT INTERRUPTER RECEPTACLE WALL MOUNTED 18" AFF TO CENTER UNO. "WP" INDICATES WEATHERPROOF "IN-USE" HEAVY DUTY METAL COVER.
	WALL MOUNTED OCCUPANCY SENSOR SWITCH. LOCATE AS PER MANUFACTURER'S REQUIREMENTS.
	CEILING MOUNTED LINE VOLTAGE OCCUPANCY SENSOR WITH EXTENDED RANGE. LOCATE AS PER MANUFACTURER'S RECOMMENDATIONS. SENSOR TO CONTROL "ON-OFF" OPERATION OF ALL LIGHTS IN DESIGNATED AREAS.
	TWO HEAD EMERGENCY LIGHT, WALL MOUNTED BY 9'-0" AFF. SURE-LITE #AP2SQLED OR APPROVED EQUAL.
	EXIT / EMERGENCY FIXTURE, SURFACE MOUNTED AT 1'-0" ABOVE DOOR. SURE-LITE #APC7RSQ OR APPROVED EQUAL.
	EXTERIOR EMERGENCY FIXTURE, SURFACE MOUNTED AT 1'-0" ABOVE DOOR. PATHWAY #FBAC-B-SDT OR APPROVED EQUAL.

ELECTRICAL PLAN

SOUTH ALABAMA REGIONAL AIRPORT
FOUR-UNIT HANGAR
COVINGTON COUNTY, ALABAMA

79J-XXX
TMGM220026

SCALE: NOT TO SCALE

11
sheet 11 of 11

ISSUE DATE

90% 09/14/2022
100% 10/12/2022

drawn by: EDW
checked by: AMC

1906 East Three Notch Street
Andalusia, AL 36421
T 334.222.2699
GMCNETWORK.COM

GMC