



Mimari + Metal Architecture + Metal

VOL.1

Tecrübemiz avantajınız

Our experience is your advantage

45 YEARS

Faaliyetlerine 1975 yılında metal işlemeyle başlayan üretim ve mühendislik firması Kasso, 1986 yılında genişletilmiş metal levha üretimini de bünyesine katarak Tekşan-Kasso ortaklığını kurmuştur.

Kasso Mühendislik, bugün İstanbul Anadolu Yakası Organize Sanayii bölgesinde yer alan fabrikasında, ileri teknolojiye sahip patentli makineleri ile müşterilerine yenilikçi çözümler sunabilen ve proje teslimi ürünler geliştirebilen tam teçhizatlı bir metal işleme tesisi niteliğindedir.

Tüm imalat konularını tek bir çatı altında toplayan Kasso Mühendislik, tek noktadan yönetim ve işletme felsefesiyle faaliyetlerine devam etmektedir. "Mimaride Metal Kabuklar" kavramını yapı sektöründe oturtmuş olan markanın ürünleri, endüstriyel uygulamaların yanı sıra mimari projelerde de önemli bir yer edinmiştir. Kasso, yıllar içinde edindiği deneyim ve birikimin neticesinde kendi sektöründe bir ilke imza atarak Türkiye'nin 71. tasarım merkezini açmaya hak kazanmıştır.

Kasso is an engineering and manufacturing firm that has specialized in metalworking since its foundation in 1975. In 1986, the company extended its activities by embarking on expanded mesh metal sheet manufacturing through the Tekşan-Kasso partnership. Today, Kasso Engineering boasts a fully equipped metalworking plant in its headquarters in the Istanbul Anadolu Yakasi Organized Industrial Zone. Here, the company operates patented high-technology machinery that enables to offer innovative solutions and turnkey projects for its clients.

Kasso Engineering continues to grow with the philosophy of becoming a one-stop-shop for its clients' metalworking needs. As the innovator of "Architectural Metal Cladding" in the construction industry, the brand's products are widely used in industrial applications, as well as architectural projects. Empowered by its extensive experience and know-how gained over the years, Kasso is registered as the 71st Design Center in Turkey and very 1st in its industry.

Kasso, ürün ve hizmetlerinin müşteri gereksinimlerini tutarlı bir şekilde karşılanmasını sağlamak ve sunulan kaliteyi sürekli olarak iyileştirmek adına 2004 yılında ISO 9001:2015 sertifikasını almaya hak kazanarak kendi sektöründe kalite belgesi alan ilk şirket olmuştur. Farklılık yaratmak isteyen, müşterilerinin görüş ve düşüncelerine önem veren ve bu görüşleri sürekli geliştirmek adına ISO 10002 : 2004 Müşteri Memnuniyeti Yönetim Sistemi belgesine, Çevre Yönetim Sistemi'ne yönelik ISO 14001 : 2015 ve İş Sağlığı ve Güvenliği konusunda OHSAS 18001 : 2007 belgesine sahiptir. Kasso, çelik ve alüminyum yapıların imalatını ve montajını düzenleyen ve Yapı Ürünleri Yönetmeliği tarafından tanınan Avrupa standartlarına uygun üretime dair ISO EN 1090 belgesine sahiptir.



Kasso became the first company in its industry to receive ISO 9001:2015 certification in 2004 in order to ensure that its products and services meet customer requirements consistently and to continuously improve the quality offered. As a corporation in quest of making a difference, which cares the opinions and thoughts of its customers, it has ISO 10002:2004 Customer Satisfaction Management System certificate, ISO 14001:2015 Environmental Management System certificate and OHSAS 18001:2007 certificate for Occupational Health and Safety, in order to enhance these opinions constantly. Kasso, has the certification of ISO EN 1090 for execution of steel structures and aluminium structures for European Norms.



Kasso, 2010 yılında Türk Standartları Enstitüsü'ne (TSE) başvurarak 2013 yılında Türk Standartlarına Uygunluk Belgesi (TSE Markası) almıştır.

Kasso applied for certification with the Turkish Standards Institution (TSE) in 2010 and received its TSE certification in 2013.



Kasso, ürünlerinin Avrupa Birliği içerisinde serbest dolaşımını sağlayan ve Avrupa güvenlik standartlarına uygunluğunu gösteren CE belgesini 2017 yılında almıştır.

In 2017, Kasso received the CE certification indicating that its products comply with the European standards and can be traded freely in the European Union.



Kasso, Robotik Toz Boya Tesisi yatırımı ile 2017 yılında Avrupa merkezli alüminyum boyama kalite sertifikası olan Qualicoat ve Qualicoat Seaside belgelerini almaya hak kazanmıştır.

In 2017, Kasso received the European aluminum paint quality certifications Qualicoat and Qualicoat Seaside for its Robotic Powder Coating Plant investment.



Kasso, 2017 yılında kendi sektöründe ilk, Türkiye'de ise 71. tasarım merkezini açmıştır.

In 2017, Kasso opened the first design center in its industry and the 71st in Turkey.



44'Ü AŞKIN ÜLKEYE
İHRACAT
EXPORTS MORE THAN
44 COUNTRIES



YILLIK ÜRETİM KAPASİTESİ
48.869 TON
ANNUAL PRODUCTION
CAPACITY 48.869 TONS



BOYAHANE YILLIK
KAPASİTESİ
520.000 M²/YIL
PAINTSHOP ANNUAL
CAPACITY 520.000 M²



TOPLAM 7 ADET FAYDALI
MODEL BELGESİ
A TOTAL OF
7 UTILITY MODELS



TOPLAM 5 ADET
PATENT
A TOTAL OF
5 PATENTS

Sektör / Sectors

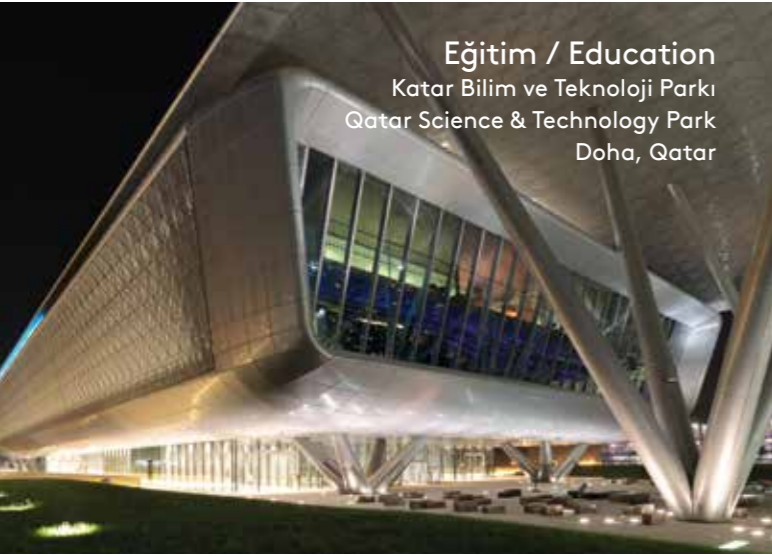

Eğitim / Education
Katar Bilim ve Teknoloji Parkı
Qatar Science & Technology Park
Doha, Qatar



Kültürel / Cultural
Raif Dinçkok Kültür Merkezi
Raif Dinçkok Cultural Center
Yalova, Türkiye



Endüstriyel / Industrial
BZJ Tekstil Fabrika ve Ofis
BZJ Textile Factory and Office
Bursa, Türkiye



Ticari / Commercial
Selçuk Ecza Genel Müdürlük
Selçuk Ecza Headquarters
İstanbul, Türkiye



Ofis / Office
Ford Otosan AR-GE Merkezi
Ford Otosan R&D Center
İstanbul, Türkiye



Alışveriş Merkezi / Shopping Mall
Kanyon
İstanbul, Türkiye

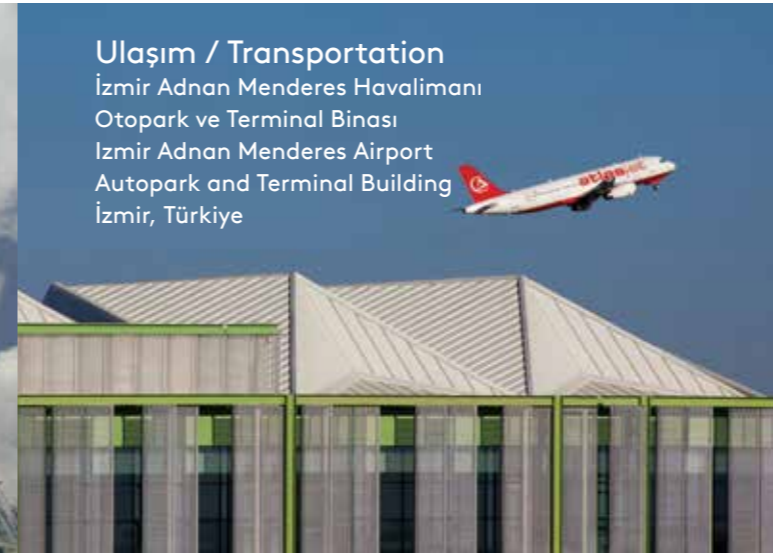

Ulaşım / Transportation
İzmir Adnan Menderes Havalimanı
Otopark ve Terminal Binası
İzmir Adnan Menderes Airport
Autopark and Terminal Building
İzmir, Türkiye



Kongre Merkezi / Convention Center
Bakü Kongre Merkezi / Baku Convention Center
Baku, Azerbaijan



Konut / Residential
Le Toison D'or
Brussels, Belgium



Sağlık / Healthcare
Acıbadem Hastanesi / Acıbadem Hospital
İstanbul, Türkiye

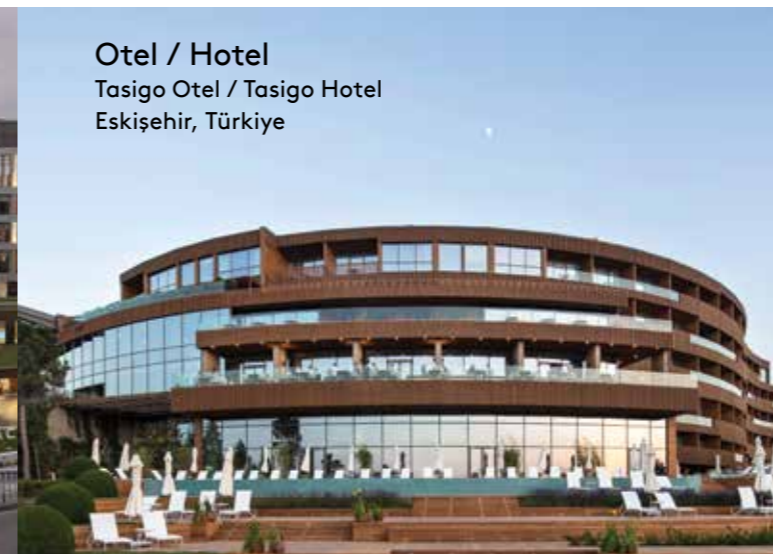

Otel / Hotel
Tasigo Otel / Tasigo Hotel
Eskişehir, Türkiye



Spor Kompleksi / Sports Complex
Türk Telekom Stadyumu / Türk Telekom Stadium
İstanbul, Türkiye

Hizmetlerimiz / Our Services

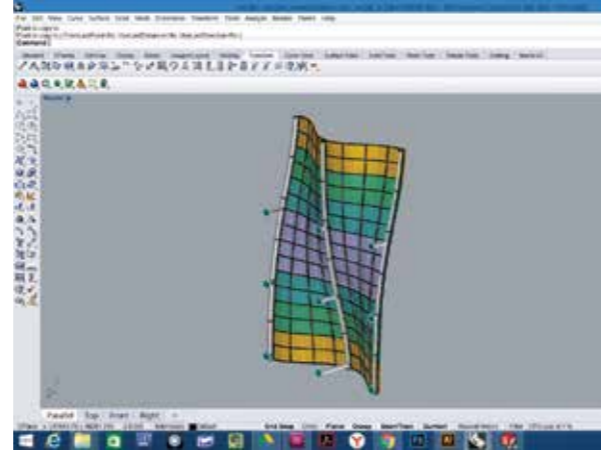

Tasarım Hizmetleri ve Destek

KASSO, mimari uygulamalar için ürettiği işlenmiş metal levhaların sabitlenmesi için sistemler geliştirerek müşterilerine çeşitli çözümler ve teknik destek sağlamaktadır. Şirketin uzmanlık alanları arasında cephe montaj sistemleri, asma tavan montaj sistemleri, çeşitli materyalleri barındıran alt yapılar, ses ve ısı izolasyonunu destekleyici ürünler ve mimari açıdan dekoratif duran sabitleme öğelerinin tasarımı yer almaktadır.

Design Services & Assistance

KASSO offers solutions and technical assistance in the development of fixing systems for processed sheet metal works in architectural applications. The company's areas of expertise include designing of façade mounting systems, suspended ceiling installation systems, sub-structures accommodating various materials, supporting products for acoustic and thermal insulation, as well as architecturally decorative fixing elements.

Mühendislik

KASSO'da, malzeme seçimi ve mimari estetiği, malzeme işlenmesi ve oryantasyonu dahil olmak üzere tasarımlar için kapsamlı mühendislik hizmetleri sunmaktayız. Değer mühendisliğine önem veren Kasso, hem imalat hem montaj aşamasında maliyetlerin düşürülmesi ve israfın önüne geçilmesi amacıyla fizibilite çalışmaları yaparak tasarım optimizasyon konusunda destek olmaktadır.

Engineering

KASSO provides comprehensive engineering services for desings, including material selection and architectural aesthetics, material processing and orientation. As a company that prioritize the value engineering, KASSO renders assistance for design optimization by making feasibility studies in order to reduce the costs and prevent wastage.



Üretim

KASSO olarak genişletilmiş ve perfore metal levhalar kullanarak cephe ve asma tavan projeleri gerçekleştirme konusundaki uzun yıllara dayanan deneyimimizi müşterilerimizle paylaşmaktan gurur duyuyoruz. Montaj maliyetlerini düşüren hızlı bağlantı sistemleri gibi sektöre öncülük eden uygulamaların yanı sıra ürünlerimizin performansını daha da iyileştirmek amacıyla inovatif malzemelerin kullanımı ve üretim süreçleri üzerine uzmanlığımızı kullanıyoruz. Panellerimizin değer mühendisliğine önem veren bir şirket olarak KASSO'da ayrıca müşterilerimize modülasyon konusunda destek olarak hem imalat, hem de montaj aşamasında malzeme israfının önüne geçmeye ve maliyetleri azaltmaya özen gösteriyoruz.

Production

As KASSO, we are proud to offer our vast experience in facade and suspended ceiling projects using expanded and perforated metal. In addition to industry-leading applications such as quick coupling systems that reduce the cost of installation, KASSO also has expertise in using innovative materials and manufacturing processes to improve the performance of its products. As a company that prioritize the value engineering of panels, we provide assistance in modulation issues to our clients in order to reduce waste and lower the costs, during both production and installation.

Montaj

KASSO, tasarımlara sağladığı üstün kaliteli bitiş ve detay imkanları ile montaj destek hizmeti vermektedir. Mühendislik ekiplerince optimize edilen birleşim detayları, doğru sistemler ile montajın hızlı ve kolay tamamlanması hedeflemektedir. KASSO ayrıca dünyanın dört bir yanında bulunan iş ortakları sayesinde montaj işleminin hızlı, kolay ve doğru bir şekilde gerçekleştirilmesini sağlamaktadır.

Installation

KASSO provides installation assistance service by ensuring high-quality edges and details for the designs. The connection details optimized by the engineering teams, aim for easy and fast completion of installations with the appropriate systems. Thanks to its business partners all over the world KASSO also assures fast, easy and accurate installation operations.



KASSO Mühendislik 44'ü aşkın ülkeye dünya standartlarında üretilen ürünlerimiz, yüksek kalite ve üst düzey hizmet anlayışımızla ülkemiz ihracatına katkı yapmaya devam ediyor.

KASSO Engineering continues to contribute to our national economy by exporting its world-class products to more than 44 countries with exemplary customer service.

Dünya çapında sayısız mimari proje için sofistike yapılar yaratıyoruz.

We create sophisticated structures for numerous architectural projects all over the world.



Katar Bilim ve Teknoloji Parkı
Qatar Science & Technology Park
Doha, Qatar



Kuveyt Uluslararası Havalimanı
Kuwait International Airport
Kuwait City, Kuwait



Médiathèque Du Kremlin - Bicêtre - L'écho
Paris, France

Temeller

KASSO, kırk yılı aşkın deneyime sahip olan kurucularının vizyonu ile, müşterilerin gereksinimlerini dinleyip anlayabilme ve ilk fikir noktasından montaja kadar projenin tüm aşamalarında destek sağlayabilme kapasitesi sayesinde ilk günden beri öne çıkmaktadır.

Foundations

With the vision of the founders of more than 40 years' experience and thanks to its ability to listen and understand the customer needs and to provide assistance at all stages of a project, from the initial idea to the final installation, KASSO holds the leading position.

İnovasyon

Sürekli gelişim ve inovasyonu hedefleyen Tasarım Merkezimiz ihtiyaca yönelik tasarlanmış ürün ve sistem gerektiren projeler için özelleştirilmiş çözümler sunabilmektedir. Mühendislerimizin uzmanlık seviyesi, makine parkımızın yüksek entegrasyonu ve yüksek teknolojimiz sayesinde üretim süreçlerimizin uyarlanabilirliği ile proje bazlı nitelikli ve inovatif yaklaşımlar yapmaktadır.

Innovation

Our innovation and improvement centered Design Center offers customized solutions that specifically designed for project's product and system requirements. With the expertise of engineering team, high integration of machinery park with high technology and the adaptability of our production processes, Kasso offers project-based, qualified and innovative approaches.

KATAR BİLİM VE TEKNOLOJİ PARKI

QATAR SCIENCE & TECHNOLOGY PARK

Yer / Location Doha, Qatar

Tarih / Date 2012

Mimar / Architect Woods Bagot

Tip / Type Eğitim / Education

Fotoğraf / Photo Meinphoto



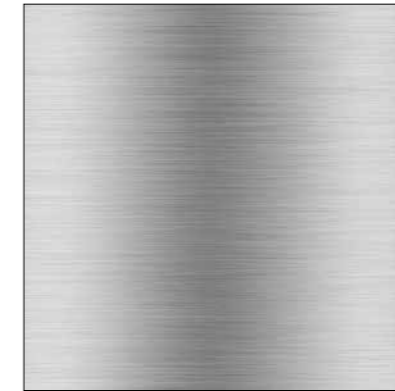
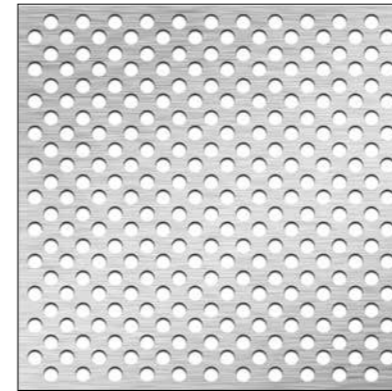
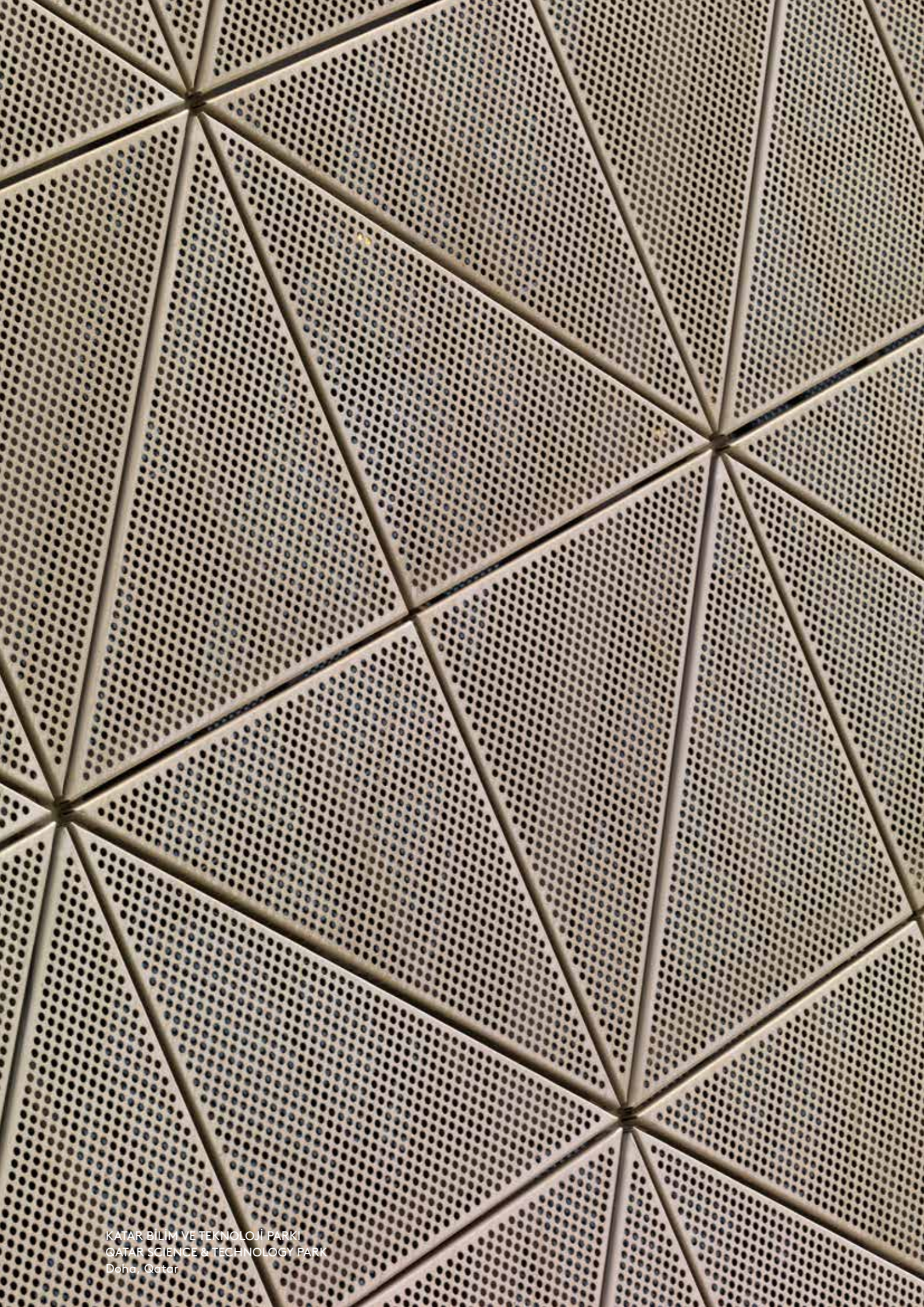

Uygulama / Application
Cephe / Facade

Ürün / Product
Ø19-D40mm delikli metal
Ø19-P40mm perforated metal

Malzeme / Material
Paslanmaz çelik / Stainless steel

Uygulama / Application
Cephe / Facade

Ürün / Product
Solid

Malzeme / Material
Paslanmaz çelik / Stainless steel

GREYDER AYAKKABI FABRİKASI

GREYDER SHOE FACTORY

Yer / Location	Çorum, Türkiye
Tarih / Date	2016
Mimar / Architect	Çırakoğlu Architecture
Tip / Type	Endüstriyel / Industrial
Fotoğraf / Photo	Cemal Emden

Ödül / Award National Architecture Awards 2016, Finalist

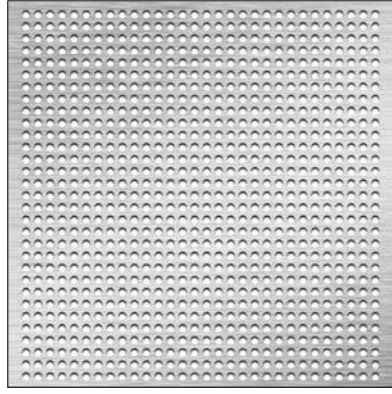

**Uygulama / Application**

Cephe / Facade

Ürün / ProductØ10-D15mm delikli metal
Ø10-P15mm perforated metal**Malzeme / Material**

Alüminyum / Aluminum

Yüzey / Surface

Eloksal / Anodized

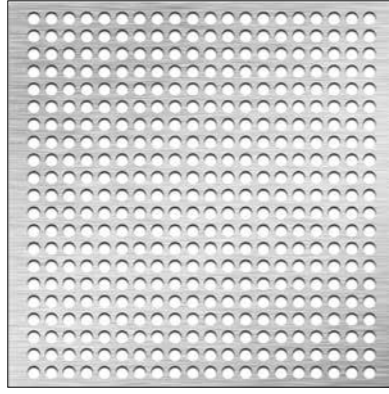
**Uygulama / Application**

Cephe / Facade

Ürün / ProductØ16-D22mm delikli metal
Ø16-P22mm perforated metal**Malzeme / Material**

Alüminyum / Aluminum

Yüzey / Surface

Eloksal / Anodized

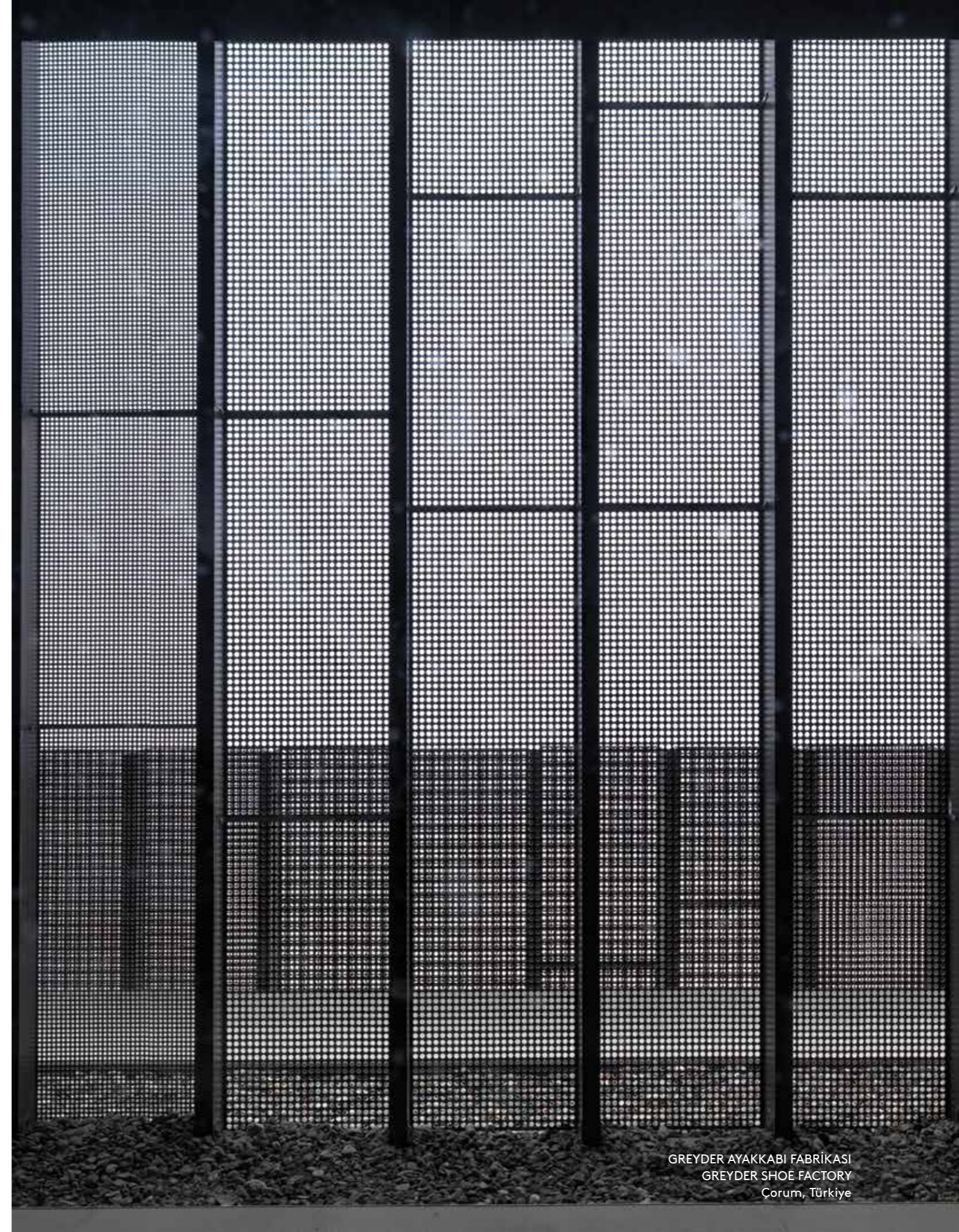
GREYDER AYAKKABI FABRİKASI
GREYDER SHOE FACTORY
Corum, TürkiyeGREYDER AYAKKABI FABRİKASI
GREYDER SHOE FACTORY
Corum, Türkiye

RAİF DİNÇKÖK KÜLTÜR MERKEZİ

RAİF DİNÇKÖK CULTURAL CENTER

Yer / Location	Yalova, Türkiye
Tarih / Date	2011
Mimar / Architect	(EAA) - Emre Arolat Architecture
Tip / Type	Kültür / Cultural
Fotoğraf / Photo	Cemal Emden

Ödül / Award

2011 Cityscape Dubai Awards, Leisure Built, Winner
2010 European Commercial Property Awards, Leisure and Hospitality, Highly Commended

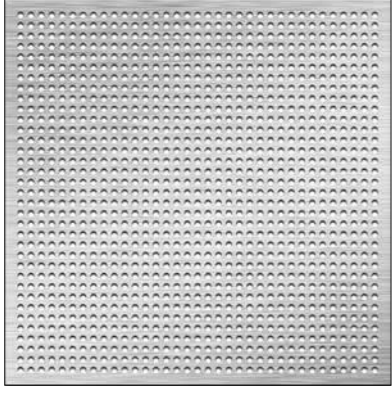

**Uygulama / Application**

Cephe / Facade

Ürün / Product

Ø5-D8mm delikli metal

Ø5-P8mm perforated metal

Malzeme / Material

Cor-ten çelik / Cor-ten steel

Yüzey / Surface

Kaplamsız / Mill finish

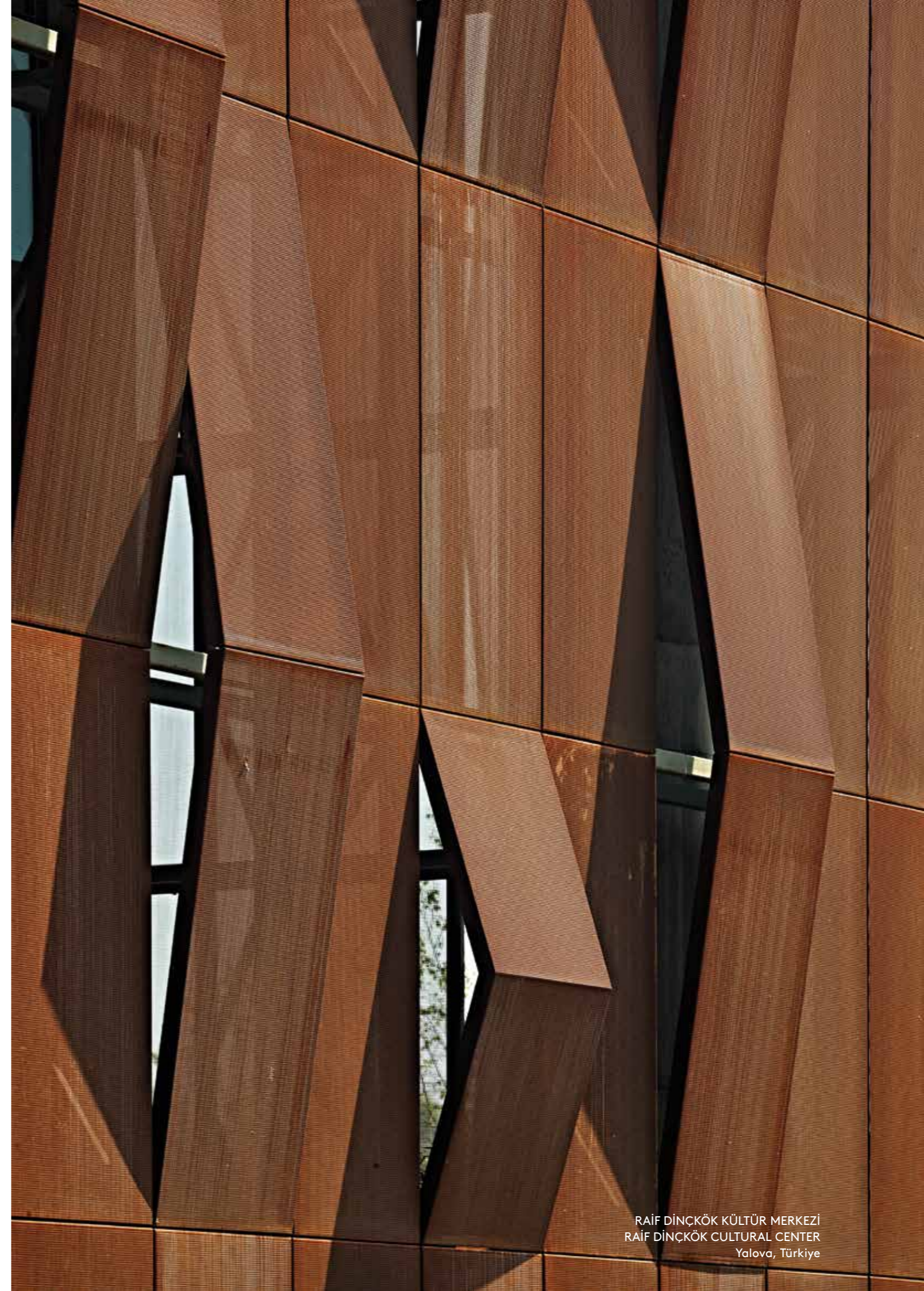
RAİF DİNÇKÖK KÜLTÜR MERKEZİ
RAİF DİNÇKÖK CULTURAL CENTER
Yalova, TürkiyeRAİF DİNÇKÖK KÜLTÜR MERKEZİ
RAİF DİNÇKÖK CULTURAL CENTER
Yalova, Türkiye

S2OSB YÖNETİM MERKEZİ

S2OSB HEADQUARTERS

Yer / Location	Sakarya, Türkiye
Tarih / Date	2016
Mimar / Architect	BINAA Building Innovation Arts Architecture
Tip / Type	Ofis / Office
Fotoğraf / Photo	Cemal Emden

Ödül / Award Architizer A+Awards Winner, Architecture+Metal Turkey Architectural Annual 2016

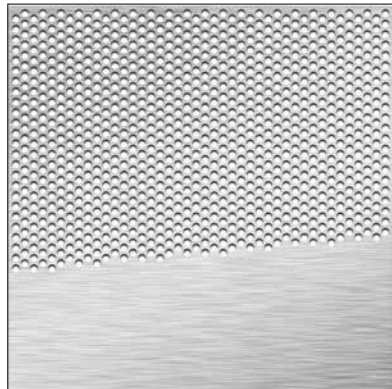

**Uygulama / Application**

3B cephe / 3D facade

Ürün / ProductØ10mm delikli metal
Ø10mm perforated metal**Malzeme / Material**

Alüminyum / Aluminum

Yüzey / Surface

Satine eloksal / Satin anodized

S205B YÖNETİM MERKEZİ
S205B HEADQUARTERS
Sakarya, Türkiye

SELÇUK ECZA GENEL MÜDÜRLÜK

SELÇUK ECZA HEADQUARTERS

Yer / Location	İstanbul, Türkiye
Tarih / Date	2013
Mimar / Architect	Tabanlıoğlu Architecture
Tip / Type	Ofis / Office
Fotoğraf / Photo	Thomas Mayer Photography

Ödül / Award World Architecture Community News, WAF 2013 Future Projects Office Winner





SELÇUK ECZA GENEL MÜDÜRLÜK
SELÇUK ECZA HEADQUARTERS
İstanbul, Türkiye

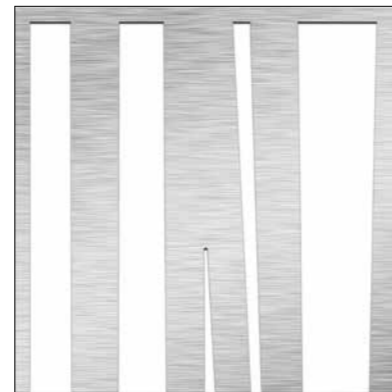

Uygulama / Application

Cephe / Facade

Ürün / Product

Desen kesim / Pattern cut

Malzeme / Material

Alüminyum / Aluminum

Yüzey / Surface

Elektrostatik toz boya

Electrostatic powder coating



SELÇUK ECZA GENEL MÜDÜRLÜK
SELÇUK ECZA HEADQUARTERS
İstanbul, Türkiye

MURAT KARAMANCI ÖĞRENCİ MERKEZİ

MURAT KARAMANCI STUDENT CENTER

Yer / Location	İstanbul, Türkiye
Tarih / Date	2016
Mimar / Architect	Alataş Architecture & Consulting
Tip / Type	Eğitim / Education
Fotoğraf / Photo	Ali Bekman

Ödül / Award

2017 MIES Awards Nominee
Turkey Architectural Annual 2016 Enlisted
European Steel Design Awards of Excellence 2017



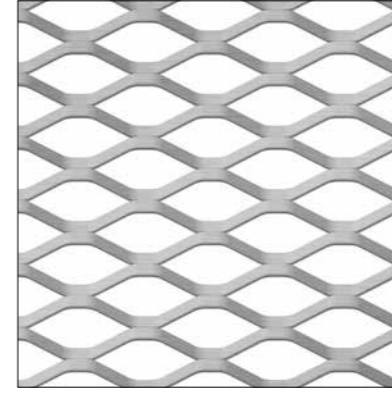

Uygulama / Application

Cephe, Çatı / Facade, Roof

Ürün / Product

160x60x20mm genişletilmiş metal
160x60x20mm expanded mesh metal

Malzeme / Material

Alüminyum / Aluminum

Yüzey / Surface

Elektrostatik toz boya
Electrostatic powder coating

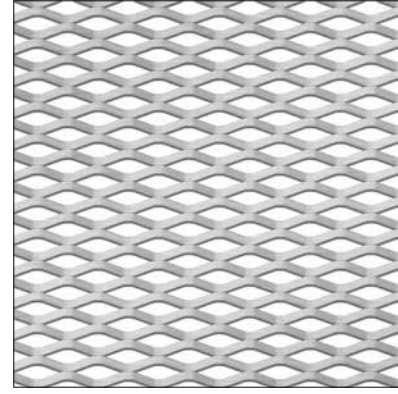

**Uygulama / Application**

Otopark, Çatı / Carpark, Roof

Ürün / Product

75x25x12mm genişletilmiş metal

75x25x12mm expanded mesh metal

Malzeme / Material

Alüminyum / Aluminum

Yüzey / Surface

Elektrostatik toz boya

Electrostatic powder coating

ACIBADEM ALTUNİZADE HASTANESİ

ACIBADEM ALTUNİZADE HOSPITAL

Yer / Location İstanbul, Türkiye**Tarih / Date** 2017**Mimar / Architect** Forum Studio**Tip / Type** Sağlık / Healthcare**Fotoğraf / Photo** Cemal Emden

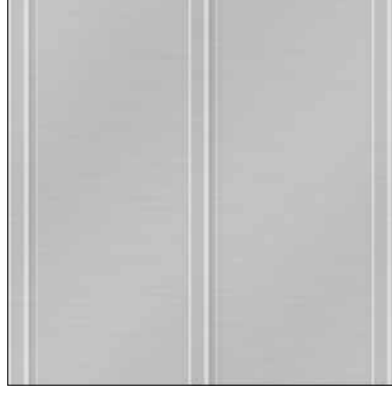
**Uygulama / Application**

Cephe / Facade

Ürün / Product

Cephe / Facade

Malzeme / Material

Kenet sistem / Standing seam

Yüzey / Surface

Bakır / Copper

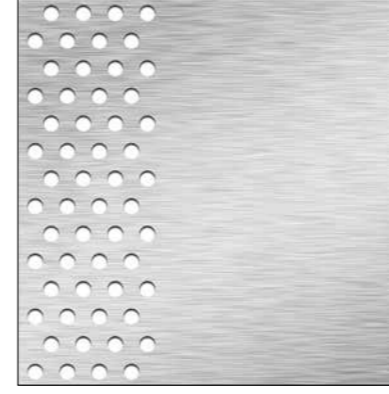
**Uygulama / Application**

Asma tavan / Suspended ceiling

Ürün / Product

Müperfore metal

Multiperforated metal

Malzeme / Material

Alüminyum / Aluminum

Yüzey / Surface

Vinil kaplama / Vinyl cladding



ACIBADEM ALTUNİZADE HASTANESİ
ACIBADEM ALTUNİZADE HOSPITAL
İstanbul, Türkiye



ACIBADEM ALTUNİZADE HASTANESİ
ACIBADEM ALTUNİZADE HOSPITAL
İstanbul, Türkiye

ALLIANZ TOWER

Yer / Location	İstanbul, Türkiye
Tarih / Date	2014
Mimar / Architect	Fehmi Kocal Design Architects & FX Fowle Architects
Tip / Type	Ofis / Office
Fotoğraf / Photo	Gürkan Akay, Yunus Özkazanç

Ödül / Award Leed Platinum Certified, Turkey Architectural Annual 2016 Enlisted

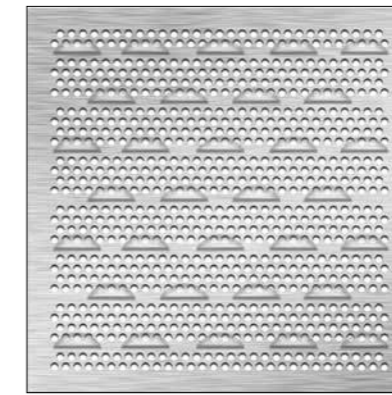
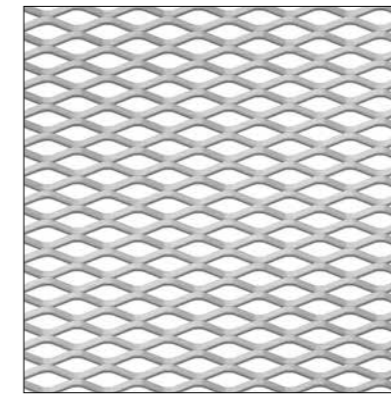

Uygulama / Application
Soğutma kulesi / Cooling tower

Ürün / Product
75x25x9mm genişletilmiş metal
75x25x9mm expanded mesh metal

Malzeme / Material
Alüminyum / Aluminum

Yüzey / Surface
Elektrostatik toz boya
Electrostatic powder coating

Uygulama / Application
Cephe / Facade

Ürün / Product
Özel delikli ve kabartmalı metal
Custom design perforated &
embossed metal

Malzeme / Material
Alüminyum / Aluminum

Yüzey / Surface
Elektrostatik toz boya
Electrostatic powder coating

LE TOISON D'OR

Yer / Location	Brussels, Belgium
Tarih / Date	2016
Mimar / Architect	UNStudio
Tip / Type	Konut / Residential
Fotoğraf / Photo	Hufton+Crow, Eva Bloem



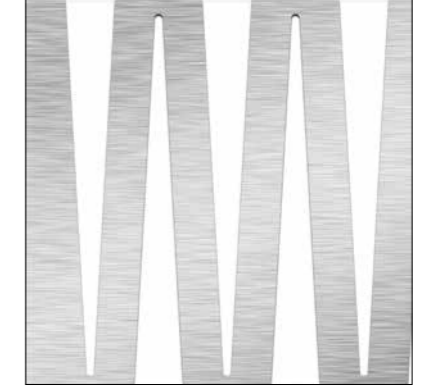
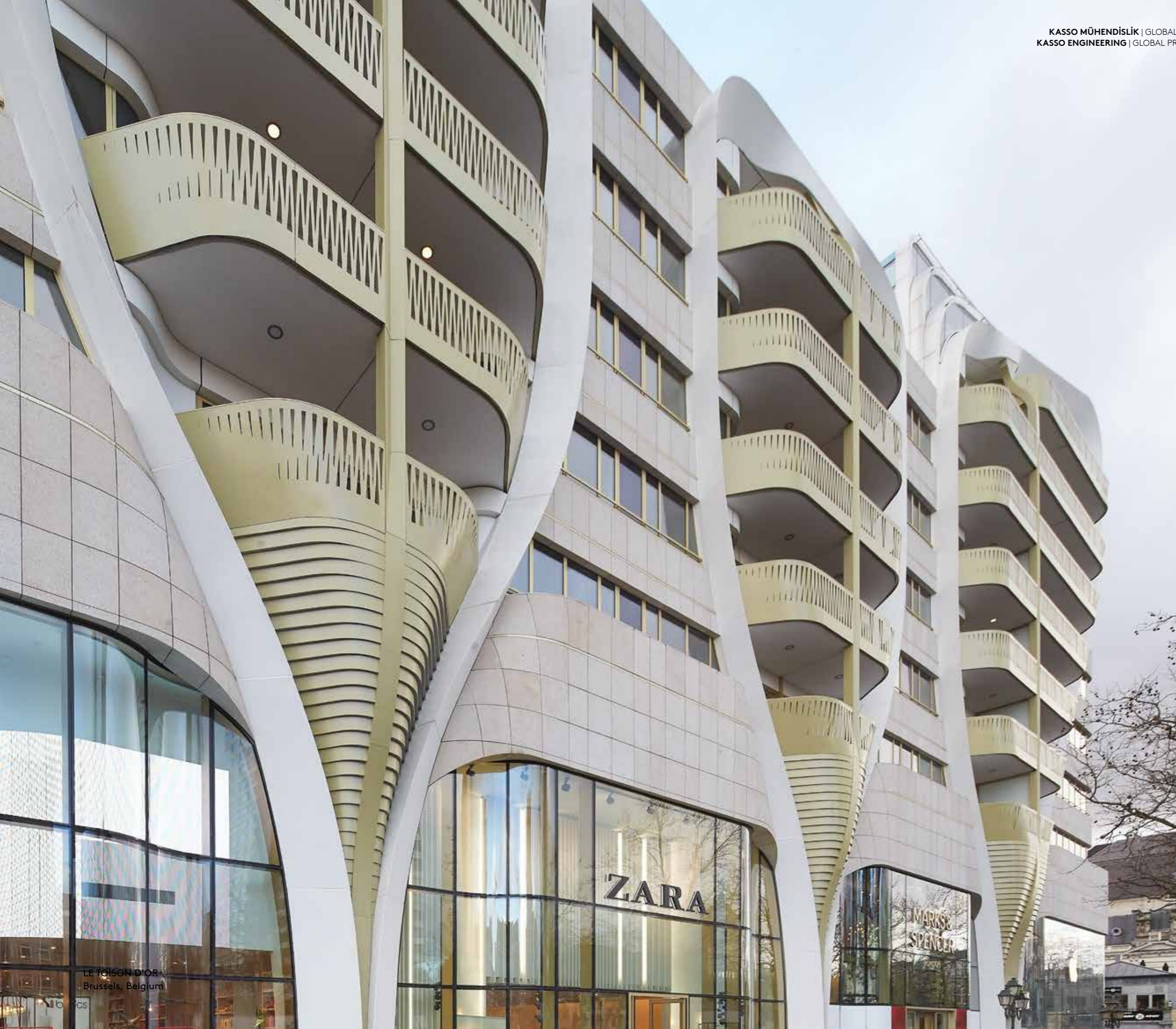

Uygulama / Application

Korkuluk / Railing

Ürün / Product

Desen kesim / Pattern cut

Malzeme / Material

Alüminyum / Aluminium

Yüzey / Surface

Elektrostatik toz boya

Electrostatical powder coating

BZJ TEKSTİL FABRİKA VE OFİS

BZJ TEXTILE FACTORY AND OFFICE

Yer / Location	Bursa, Türkiye
Tarih / Date	2015
Mimar / Architect	StudioKA
Tip / Type	Endüstriyel / Industrial, Ofis / Office
Fotoğraf / Photo	Ali Bekman

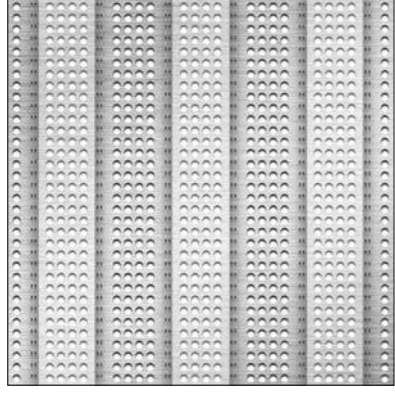

**Uygulama / Application**

Çephe / Facade

Ürün / ProductØ10-D14mm delikli metal ve trapez form
Ø10-P14mm perforated metal &
trapezoid form**Malzeme / Material**

Alüminyum / Aluminum

Yüzey / Surface

Eloksal / Anodized

BZJ TEKSTİL FABRİKA VE OFİS
BZJ TEXTILE FACTORY AND OFFICE
Bursa, TürkiyeBZJ TEKSTİL FABRİKA VE OFİS
BZJ TEXTILE FACTORY AND OFFICE
Bursa, Türkiye

FORD OTOSAN AR-GE MERKEZİ

FORD OTOSAN R&D CENTER

Yer / Location	İstanbul, Türkiye
Tarih / Date	2015
Mimar / Architect	Tece Architecture
Tip / Type	Ofis / Office
Fotoğraf / Photo	Murat Germen

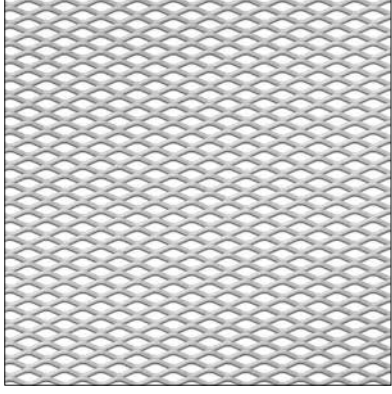

**Uygulama / Application**

Saçak altı, Asma tavan
Canopy, Suspended ceiling

Ürün / Product

45x15x3mm genişletilmiş metal
45x15x3mm expanded mesh metal

Malzeme / Material

Alüminyum / Aluminum

Yüzey / Surface

Eloksal / Anodized

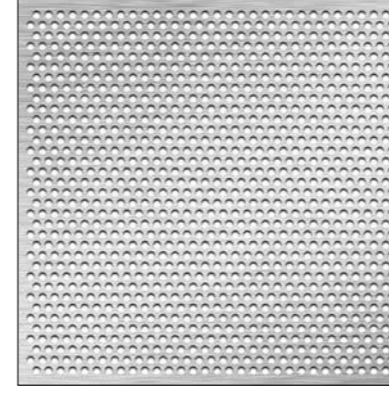
**Uygulama / Application**

Cephe / Facade

Ürün / Product

Ø10-D13mm delikli formlu metal
Ø10-P13mm perforated formed metal

Malzeme / Material

Alüminyum / Aluminum

Yüzey / Surface

Elektrostatik toz boya
Electrostatic powder coating

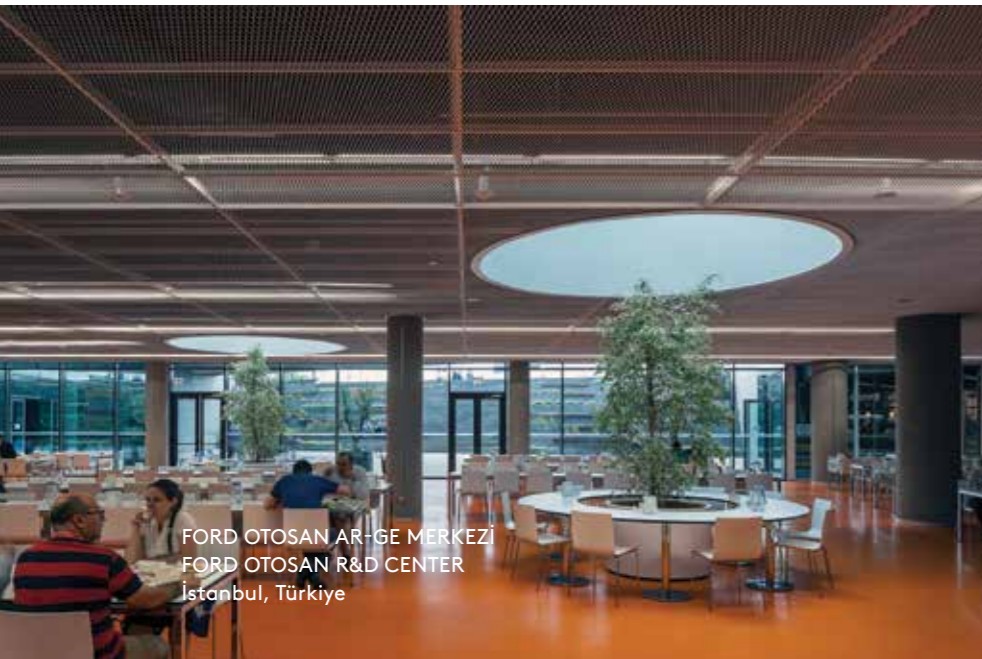

FORD OTOSAN AR-GE MERKEZİ
FORD OTOSAN R&D CENTER
İstanbul, Türkiye



FORD OTOSAN AR-GE MERKEZİ
FORD OTOSAN R&D CENTER
İstanbul, Türkiye

PİRİ REİS ÜNİVERSİTESİ

PİRİ REİS UNIVERSITY

Yer / Location	İstanbul, Türkiye
Tarih / Date	2014
Mimar / Architect	Kreatif Architecture
Tip / Type	Eğitim / Education
Fotograf / Photo	Cemal Emden

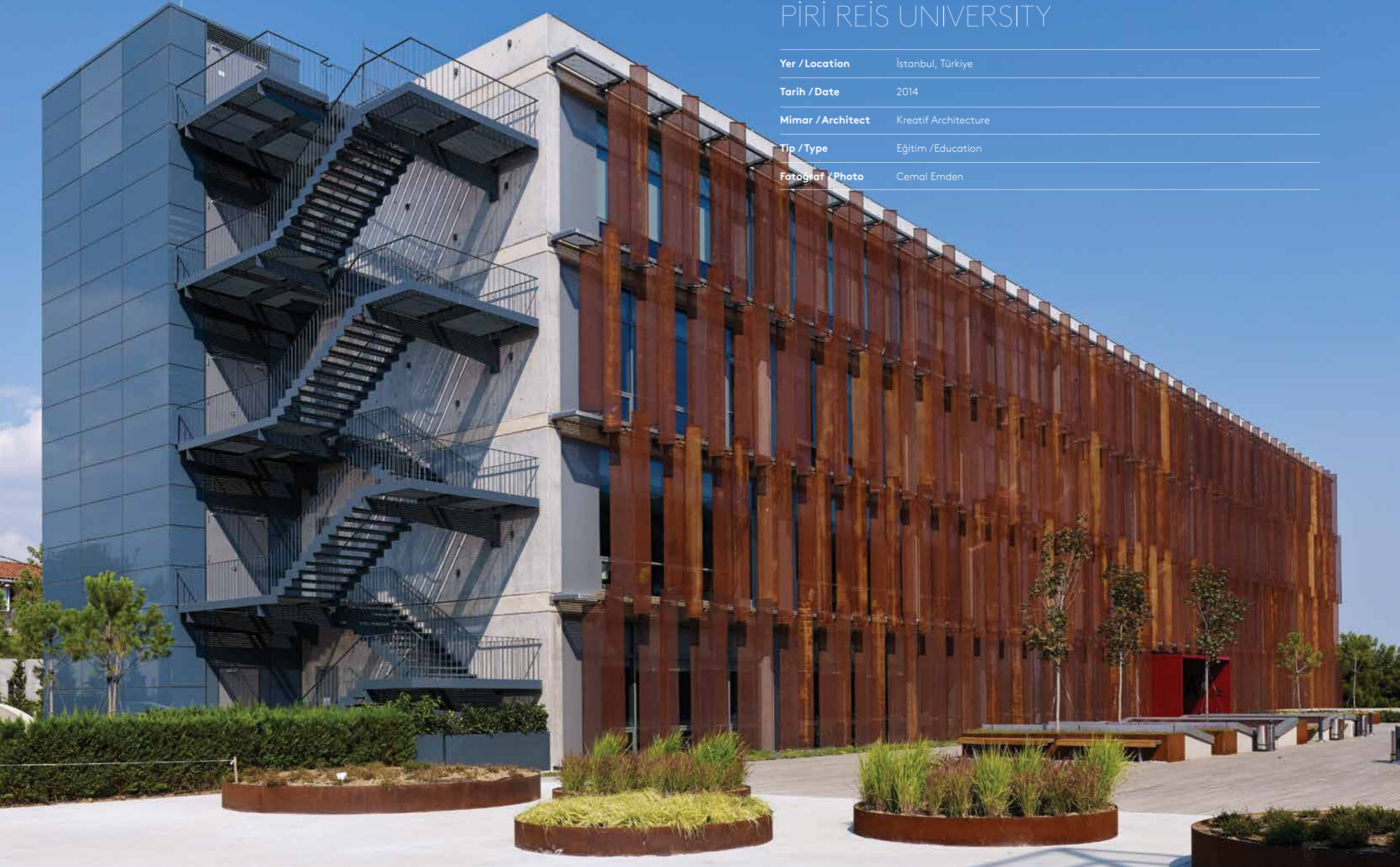

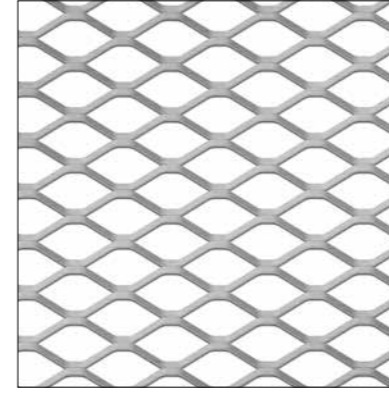
**Uygulama / Application**

Cephe / Facade

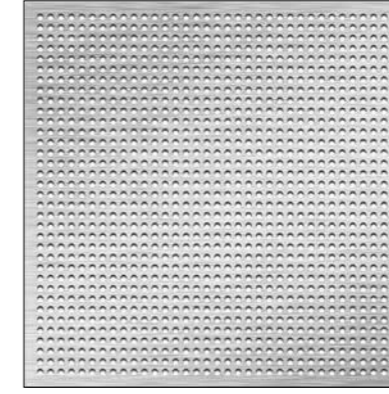
Ürün / Product115x50x12mm genişletilmiş metal
115x50x12mm expanded mesh metal**Malzeme / Material**Alüminyum / Aluminum
Cor-ten çelik / Cor-ten steel***Yüzey / Surface**Elektrostatik toz boya
Electrostatic powder coating
*Kaplama / Mill finish**Uygulama / Application**

Cephe / Facade

Ürün / ProductØ5-D8mm delikli metal
Ø5-P8mm perforated metal**Malzeme / Material**

Alüminyum / Aluminum

Yüzey / Surface

Kaplama / Mill finish

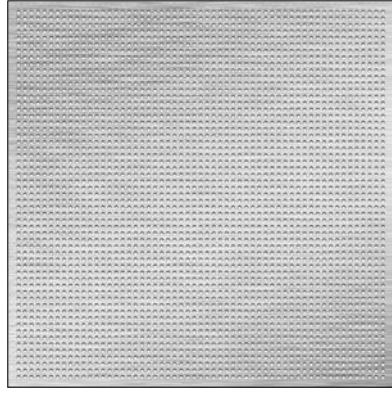

**Uygulama / Application**

Güneş kırıcı / Sun shading louvre

Ürün / ProductØ5-D8mm delikli metal
Ø5-P8mm perforated metal**Malzeme / Material**

Corten çelik / Corten steel

Yüzey / Surface

Kaplama / Mill finish

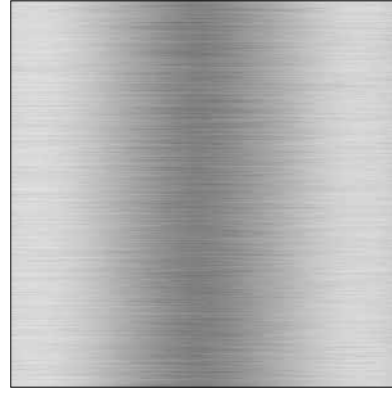
**Uygulama / Application**

Kanopi / Canopy

Ürün / Product

Solid

Malzeme / Material

Alüminyum / Aluminum

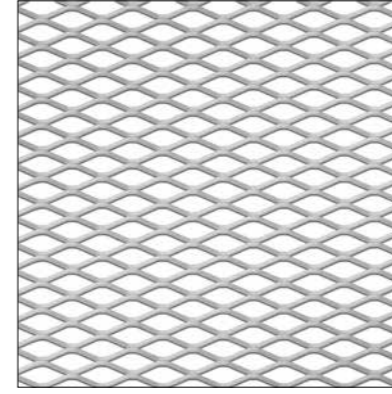
Yüzey / SurfaceElektrostatik toz boya
Electrostatic powder coating**Uygulama / Application**

Asma tavan / Suspended ceiling

Ürün / Product75x25x5mm genişletilmiş metal
75x25x5mm expanded mesh metal**Malzeme / Material**

Alüminyum / Aluminum

Yüzey / SurfaceElektrostatik toz boya
Electrostatic powder coating

PIRİ REİS ÜNİVERSİTESİ
PIRİ REİS UNIVERSITY
İstanbul, Türkiye



PIRİ REİS ÜNİVERSİTESİ
PIRİ REİS UNIVERSITY
İstanbul, Türkiye

MÉDIATHÈQUE DU KREMLIN - BICÊTRE - L'ECHO

Yer / Location Paris, France

Tarih / Date 2012

Mimar / Architect K-Architectures

Tip / Type Kültür/Culture

Fotoğraf / Photo Luc Boegly



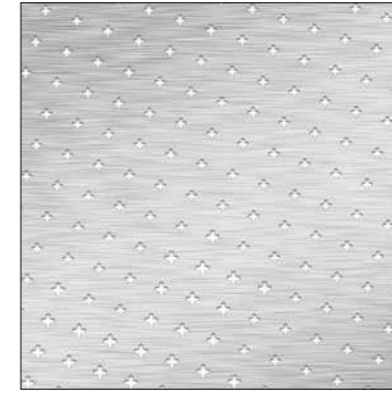

Uygulama / Application
Cephe / Facade

Ürün / Product
Özel delikli metal
Custom design perforated metal

Malzeme / Material
Alüminyum / Aluminum

Yüzey / Surface
Elektrostatik toz boya
Electrostatic powder coating



MÉDIATHÈQUE DU KREMLIN - BICÊTRE - L'ÉCHO
Paris, France

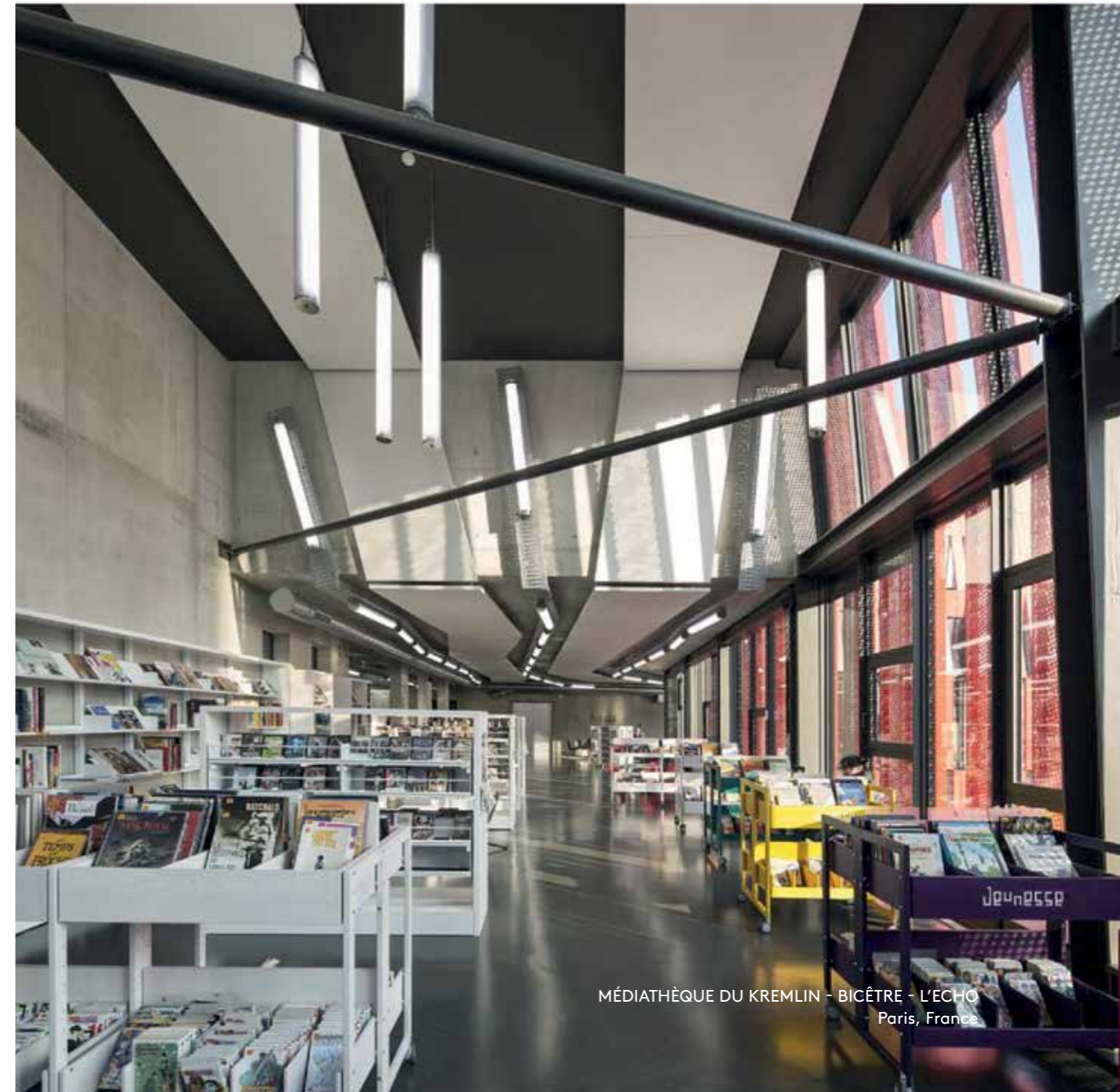

MÉDIATHÈQUE DU KREMLIN - BICÊTRE - L'ÉCHO
Paris, France

Ödül / AwardArkitera Awards Winner, Turkey
Architectural Annual 2016 Enlisted**Uygulama / Application**

Totem

Ürün / Product

Solid

Malzeme / Material

Cor-ten çelik / Cor-ten steel

LÜLEBURGAZ TERMİNALİ

LÜLEBURGAZ TERMINAL

Yer / Location Kırklareli, Türkiye**Tarih / Date** 2016**Mimar / Architect** Kolektif Architecture**Tip / Type** Ulaşım / Transportation**Fotoğraf / Photo** Engin Gerçek

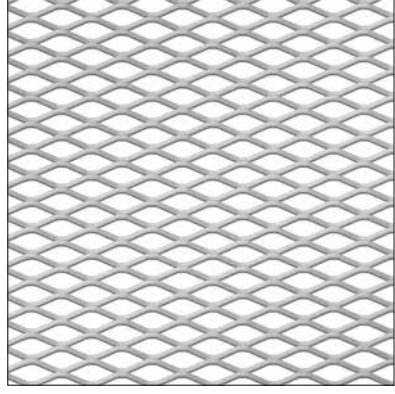
**Uygulama / Application**

Çatı / Roof

Ürün / Product75x25x5mm genişletilmiş metal
75x25x5mm expanded mesh metal**Malzeme / Material**

Alüminyum / Aluminum

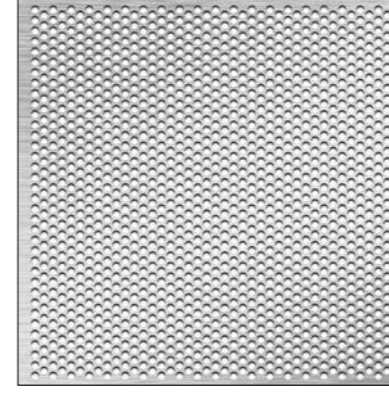
Yüzey / SurfaceElektrostatik toz boya
Electrostatic powder coating**Uygulama / Application**

Çephe, Separatör / Facade, Separator

Ürün / ProductØ10-D13mm delikli metal
Ø10-P13mm perforated metal**Malzeme / Material**

Alüminyum / Aluminum

Yüzey / SurfaceElektrostatik toz boya
Electrostatic powder coatingLÜLEBURGAZ TERMINAL
LÜLEBURGAZ TERMINAL
Kırklareli, TürkiyeLÜLEBURGAZ TERMINAL
LÜLEBURGAZ TERMINAL
Kırklareli, Türkiye

MERMERLER PLAZA

Yer / Location	İstanbul, Türkiye
Tarih / Date	2016
Mimar / Architect	Ergün Architecture
Tip / Type	Karma kullanım / Mixed used
Fotoğraf / Photo	Cemal Emden



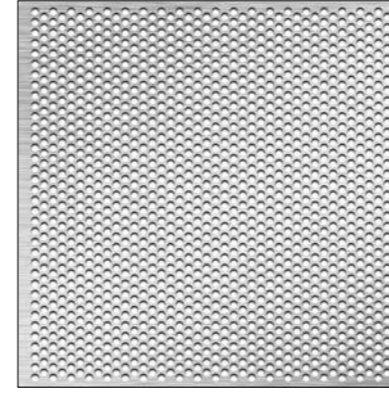

Uygulama / Application

Cephe / Facade

Ürün / Product

Ø10-D12mm delikli metal

Ø10-P12mm perforated metal

Malzeme / Material

Alüminyum / Aluminum

Yüzey / Surface

Elektrostatik toz boya

Electrostatic powder coating



MERMERLER PLAZA
İstanbul, Türkiye

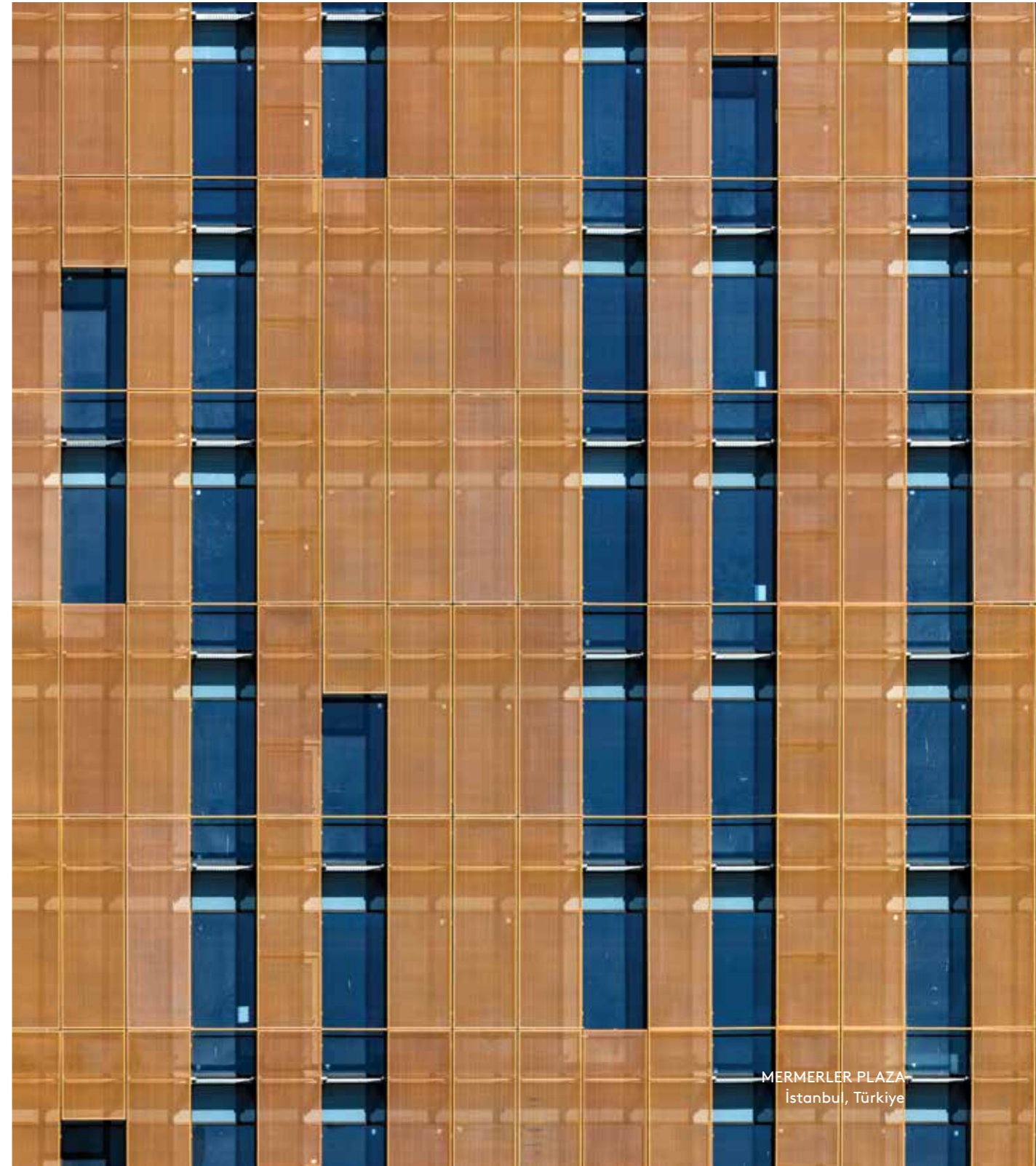

MERMERLER PLAZA
İstanbul, Türkiye

WATERGARDEN İSTANBUL

Yer / Location	İstanbul, Türkiye
Tarih / Date	2016
Mimar / Architect	Görkem Volkan Design Studio (GVDS)
Tip / Type	Karma Kullanım / Mixed Use
Fotoğraf / Photo	Ali Bekman

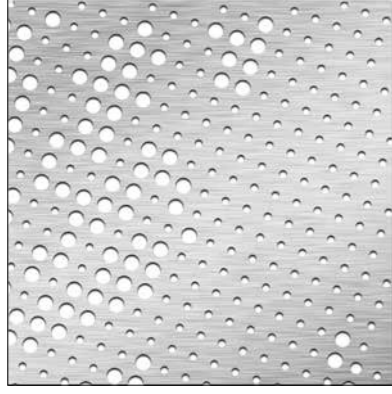

**Uygulama / Application**

Asma tavan / Suspended ceiling

Ürün / ProductØ10mm, Ø20mm multiperfore metal
Ø10mm, Ø20mm multiperforated metal**Malzeme / Material**

Alüminyum / Aluminum

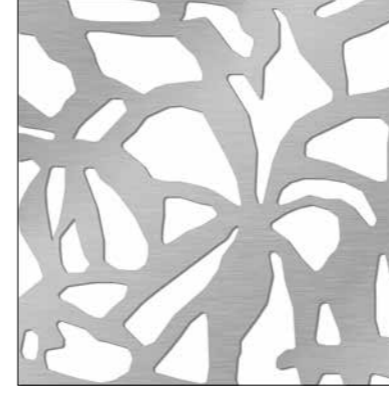
Yüzey / SurfaceElektrostatik toz boya
Electrostatic powder coatingWATERGARDEN İSTANBUL
İstanbul, Türkiye**Uygulama / Application**

Kanopi / Canopy

Ürün / Product

Desen kesim / Pattern cut

Malzeme / Material

Alüminyum / Aluminum

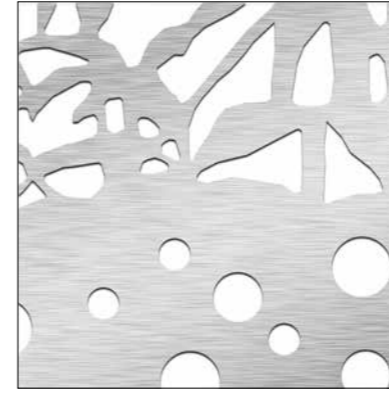
Yüzey / SurfaceElektrostatik toz boya
Electrostatic powder coating**Uygulama / Application**

Asma tavan / Suspended ceiling

Ürün / ProductMultiperfore metal ve desen kesim
Multiperforated metal & pattern cut**Malzeme / Material**

Alüminyum / Aluminum

Yüzey / SurfaceElektrostatik toz boya
Electrostatic powder coatingWATERGARDEN İSTANBUL
İstanbul, Türkiye



TASIGO OTEL

TASIGO HOTEL

Yer / Location Eskişehir, Türkiye

Tarih / Date 2014

Mimar / Architect Global Architectural Development (GAD)

Tip / Type Otel / Hotel

Fotoğraf / Photo Altkat Architectural Photography

Ödül / Award

2012 Highly Commended Hotel Architecture International Hotel and Property Awards
2013 Green Good Design Award, 2015 WAF shortlisted, Leed Gold Certified

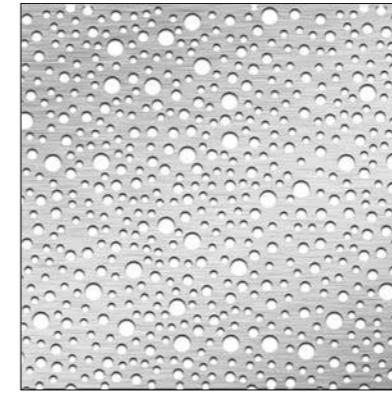

Uygulama / Application

Asma tavan / Suspended ceiling

Ürün / Product

Ø10mm, Ø20mm multiperfore metal
Ø10mm, Ø20mm multiperforated metal

Malzeme / Material

Alüminyum / Aluminum

Yüzey / Surface

Elektrostatik toz boya
Electrostatic powder coating





PROTEL YÖNETİM BİNASI PROTEL HEADQUARTERS

Yer / Location İstanbul, Türkiye

Tarih / Date 2015

Mimar / Architect HS Architecture

Tip / Type Ofis / Office

Fotoğraf / Photo Yerçekim

Ödül / Award 2017 MIES Awards Nominee

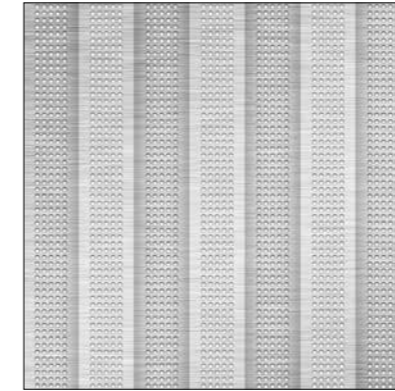

Uygulama / Application

Otomasyonlu pivot hareketli ekstrüzyon güneş kırıcı
Automated rotatable pivot extruded sun shading louvre

Ürün / Product

Ø10-D12mm delikli metal
Ø10-P12mm perforated metal

Malzeme / Material

Alüminyum / Aluminum

Yüzey / Surface

Elektrostatik toz boya
Electrostatic powder coating

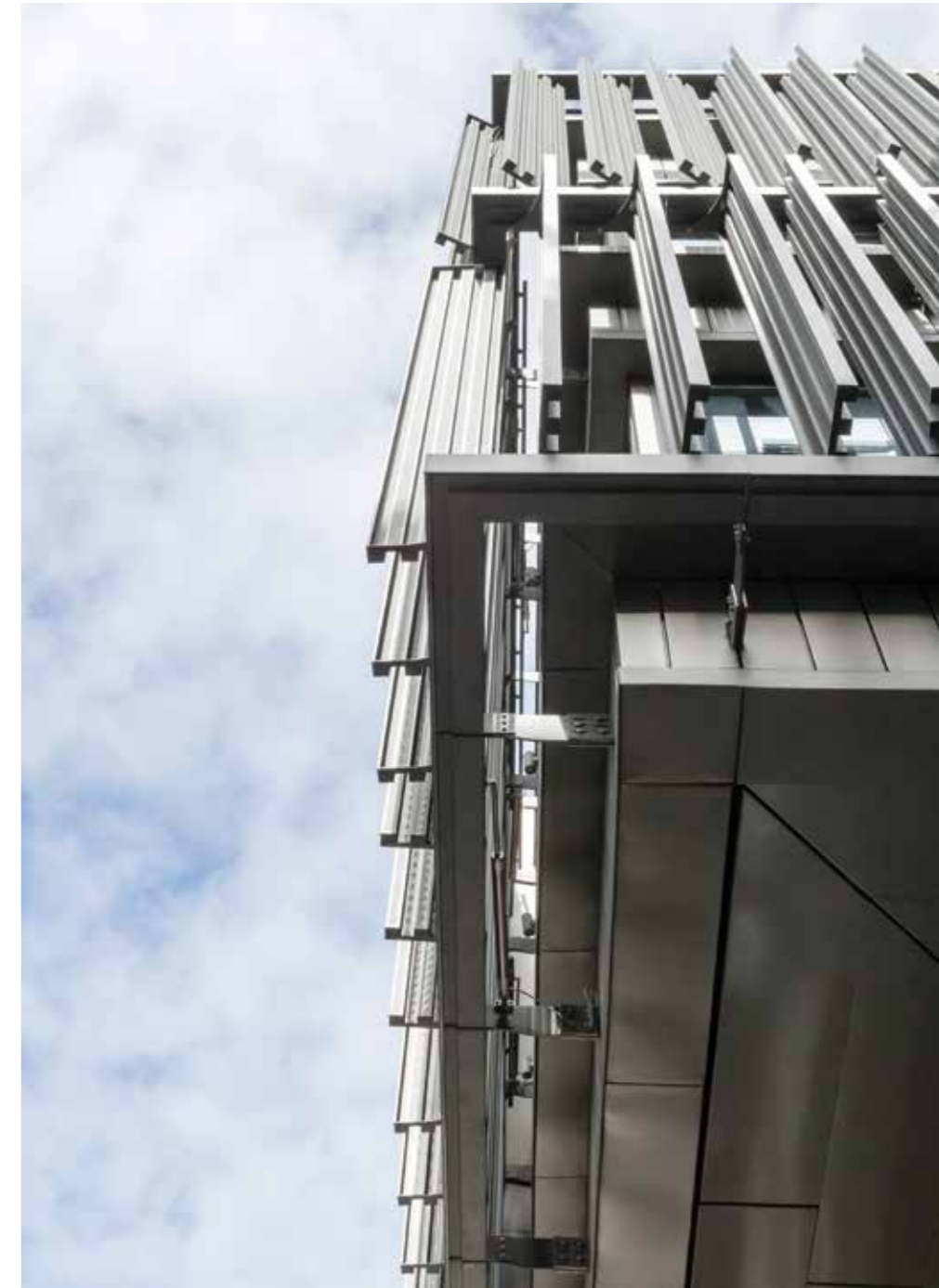

ODEABANK GENEL MÜDÜRLÜK ODEABANK HEADQUARTERS

Yer / Location İstanbul, Türkiye

Tarih / Date 2016

Mimar / Architect GMW Architecture

Tip / Type Ofis / Office

Fotoğraf / Photo Gürkan Akay

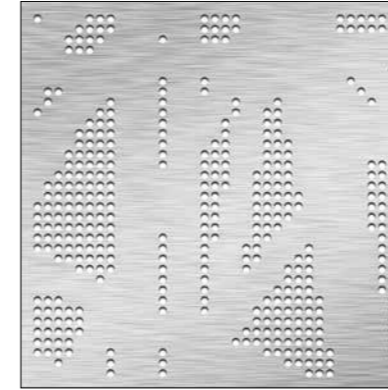

Uygulama / Application

Asma tavan / Suspended ceiling

Ürün / Product

Ø10mm multiperfore metal
Ø10mm multiperforated metal

Malzeme / Material

Alüminyum / Aluminum

Yüzey / Surface

Elektrostatik toz boya
Electrostatic powder coating





YAPI KREDİ BANKACILIK ÜSSÜ

YAPI KREDİ BANKING BASE

Yer / Location Kocaeli, Türkiye

Tarih / Date 2015

Mimar / Architect Teğet Architecture

Tip / Type Ofis / Office

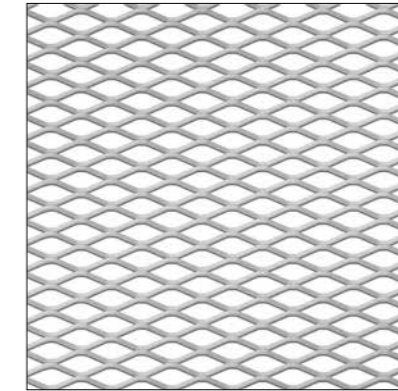
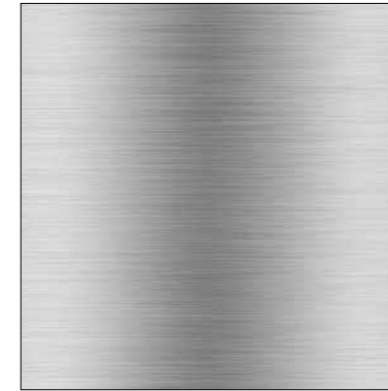

Uygulama / Application

Cephe / Facade

Ürün / Product

Solid

Malzeme / Material

Paslanmaz çelik / Stainless steel

Yüzey / Surface

Ayna yüzey / Mirror finish

Uygulama / Application

Asma tavan / Suspended ceiling

Ürün / Product

75x25x5mm genişletilmiş metal
75x25x5mm expanded mesh metal

Malzeme / Material

Çelik / Steel

Yüzey / Surface

Elektrostatik toz boya
Electrostatic powder coating



KANYON

Yer / Location	İstanbul, Türkiye
Tarih / Date	2006
Mimar / Architect	Jerde Partnership, Tabanlıoğlu Architecture
Tip / Type	Karma Kullanım / Mixed Use



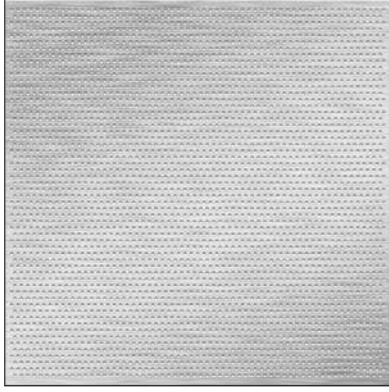

Uygulama / Application
Kubbe / Dome

Ürün / Product
Ø4mm delikli metal
Ø4mm perforated metal

Malzeme / Material
Alüminyum / Aluminum

Yüzey / Surface
Elektrostatik toz boya
Electrostatic powder coating

Uygulama / Application
Güneş kırıcı / Sun shading louvre

Ürün / Product
Solid

Malzeme / Material
Alüminyum / Aluminum

Yüzey / Surface
Elektrostatik toz boya
Electrostatic powder coating

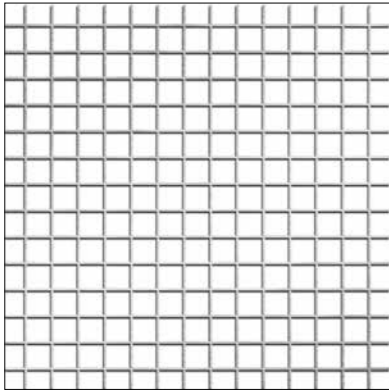

Uygulama / Application
Yürüme yolu / Cat walk

Ürün / Product
Geçme ızgara / Grid grating

Malzeme / Material
Alüminyum / Aluminum

Yüzey / Surface
Galvaniz / Galvanised



KANYON
İstanbul, Türkiye

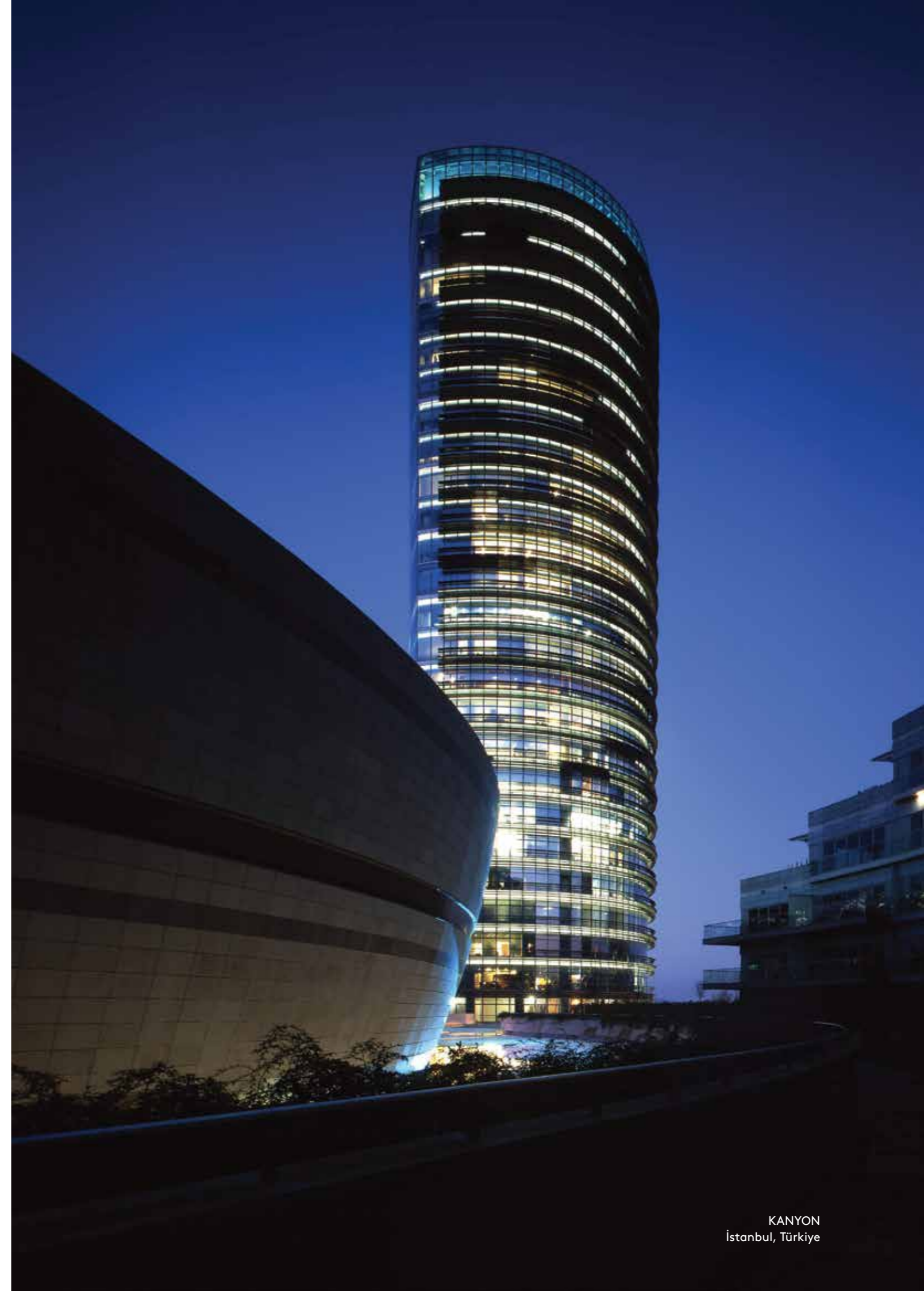

KANYON
İstanbul, Türkiye

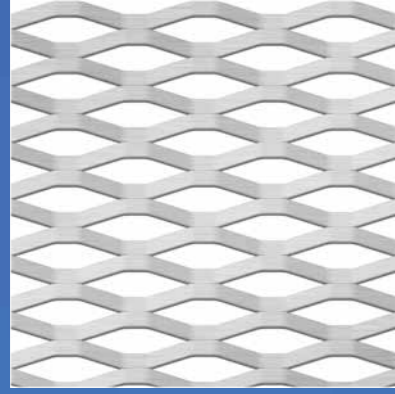
**Uygulama / Application**

Cephe / Facade

Ürün / Product

200x80x18mm genişletilmiş metal

200x80x18mm expanded mesh metal

Malzeme / Material

Alüminyum / Aluminum

Yüzey / Surface

Elektrostatik toz boya

Electrostatic powder coating

BİLKENT STATION

Yer / Location Ankara, Türkiye**Tarih / Date** 2015**Mimar / Architect** ABD+ Design Team**Tip / Type** Alışveriş Merkezi / Shopping Mall**Fotoğraf / Photo** Yusuf Özkazanç

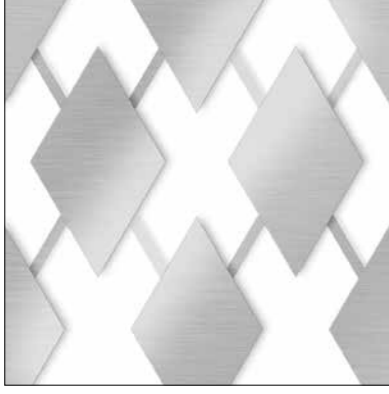
**Uygulama / Application**

Cephe, İç mekan / Facade, Interior

Ürün / Product

Özel tasarım / Custom design

Malzeme / Material

Alüminyum / Aluminum

Yüzey / Surface

Elektrostatik toz boya

Electrostatic powder coating



VAKKO İSTİNYE PARK

Yer / Location İstanbul, Türkiye

Tarih / Date 2017

Mimar / Architect Vakko Moda Center

Tip / Type Ticari / Commercial

Fotoğraf / Photo Ömer Bahlol



BAKÜ KONGRE MERKEZİ

BAKU CONVENTION CENTER

Yer / Location	Baku, Azerbaijan
Tarih / Date	2015
Mimar / Architect	Coop Himmelb(L)AU
Tip / Type	Kongre Merkezi / Convention Center



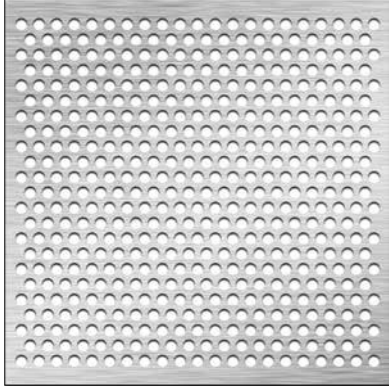

Uygulama / Application
Cephe / Facade

Ürün / Product
Ø15-D19mm delikli metal
Ø15-P19mm perforated metal

Malzeme / Material
Alüminyum kompozit
Aluminium composite

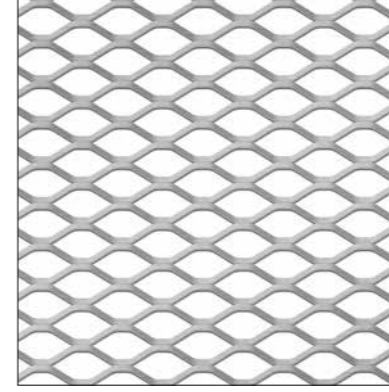

Uygulama / Application
Asma tavan / Suspended ceiling

Ürün / Product
115x50x11.5mm genişletilmiş metal
115x50x11.5mm expanded mesh metal

Malzeme / Material
Alüminyum / Aluminum

Yüzey / Surface
Eloksal / Anodized



BAKÜ KONGRE MERKEZİ
BAKU CONVENTION CENTER
İstanbul, Türkiye

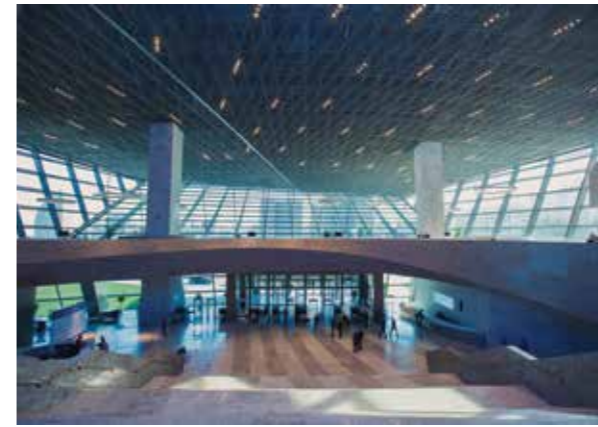

BAKÜ KONGRE MERKEZİ
BAKU CONVENTION CENTER
İstanbul, Türkiye



ÖZYEĞİN ÜNİVERSİTESİ / DERSLİK VE KÜTÜPHANE ÖZYEĞİN UNIVERSITY / LECTURE ROOM & LIBRARY

Yer / Location	İstanbul, Türkiye
Tarih / Date	2012
Mimar / Architect	B Design - RMJM Architecture
Tip / Type	Eğitim / Education
Fotoğraf / Photo	Koral Oral



Yerel Peyzaj / Local Landscape



Cephe Panel Renkleri / Facade Panel Colors

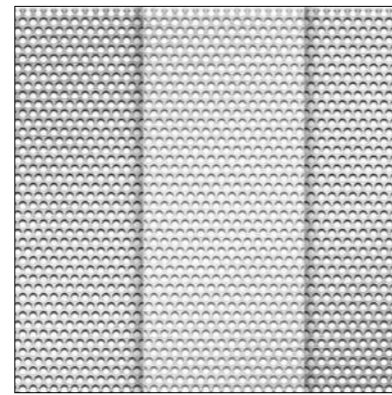

Uygulama / Application

Cephe / Facade

Ürün / Product

Ø10-D13mm delikli metal ve trapez form
Ø10-P13mm perforated metal &
trapezoid form

Malzeme / Material

Alüminyum / Aluminium

Yüzey / Surface

Elektrostatik toz boya
Electrostatic powder coating



ÖZYEĞİN ÜNİVERSİTESİ / İNGİLİZCE HAZIRLIK OKULU

ÖZYEĞİN UNIVERSITY / ENGLISH PREP SCHOOL

Yer / Location	İstanbul, Türkiye
Tarih / Date	2012
Mimar / Architect	B Design - RMJM Architecture
Tip / Type	Eğitim/Education
Fotoğraf / Photo	Koral Oral

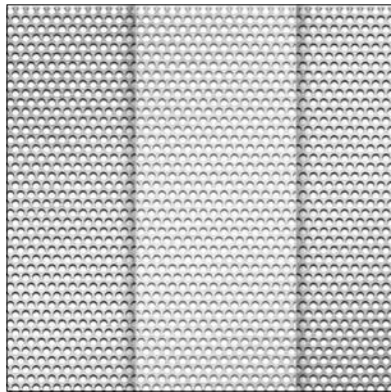

Uygulama / Application
Cephe / Facade

Ürün / Product
Ø10-D13mm delikli metal ve trapez form
Ø10-P13mm perforated metal &
trapezoid form

Malzeme / Material
Alüminyum / Aluminium

Yüzey / Surface
Elektrostatik toz boya
Electrostatic powder coating

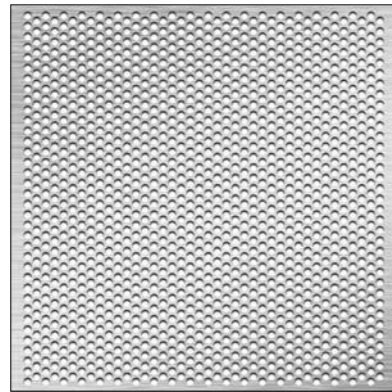

Uygulama / Application
Güneş kırıcı / Sun louvre

Ürün / Product
Ø10-D13mm delikli metal
Ø10-P13mm perforated metal

Malzeme / Material
Alüminyum / Aluminium

Yüzey / Surface
Elektrostatik toz boya
Electrostatic powder coating

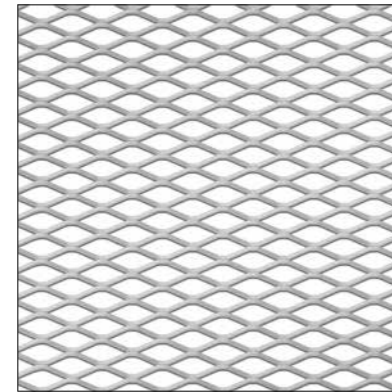

Uygulama / Application
Asma tavan / Suspended ceiling

Ürün / Product
75x25x5mm genişletilmiş metal
75x25x5mm expanded mesh metal

Malzeme / Material
Alüminyum / Aluminium

Yüzey / Surface
Elektrostatik toz boya
Electrostatic powder coating



PROTOKOL ANKARA

Yer / Location	Ankara, Türkiye
Tarih / Date	2017
Mimar / Architect	İklima Şenol Architecture
Tip / Type	Ofis / Office
Fotoğraf / Photo	Altkat Architectural Photography

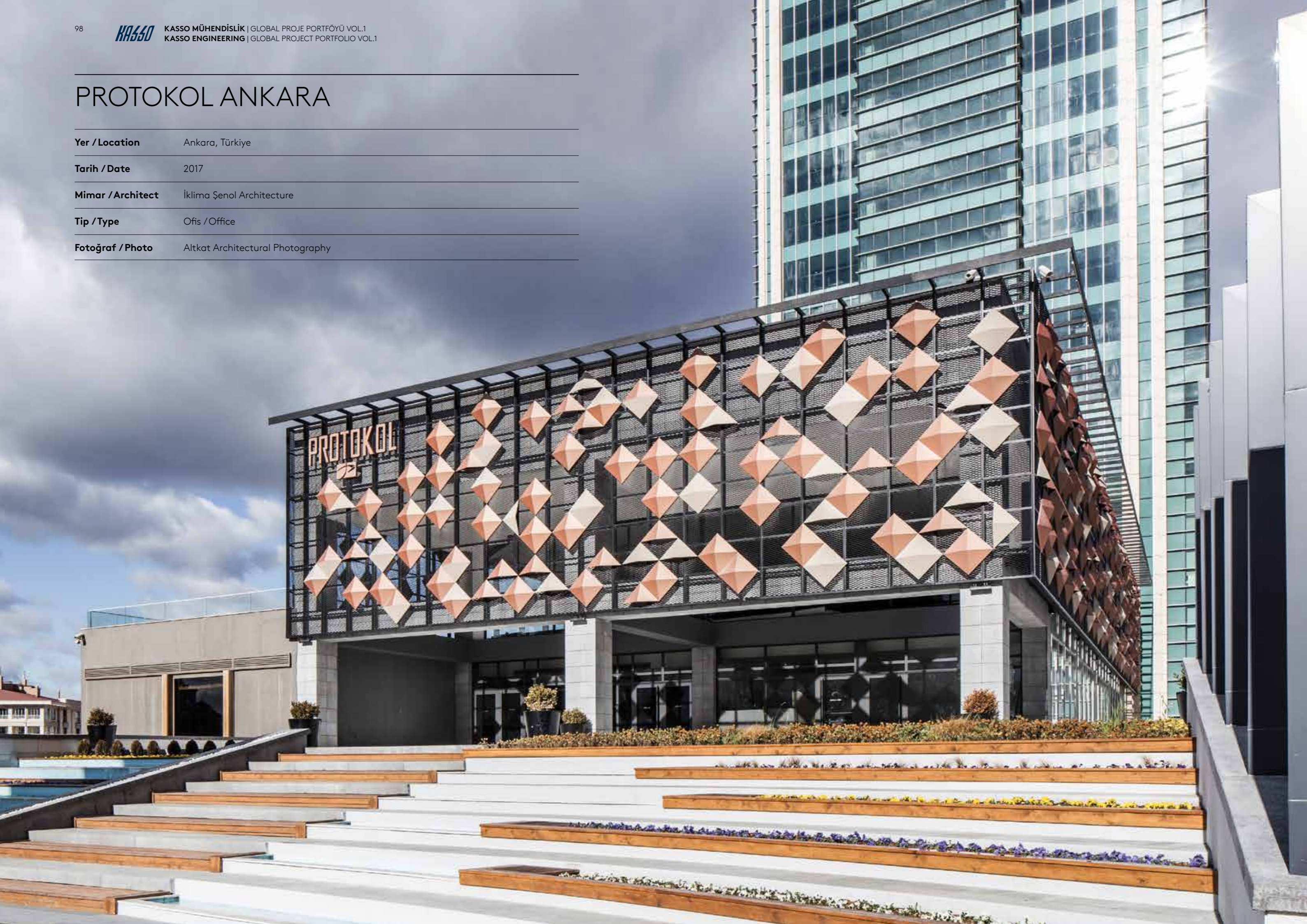

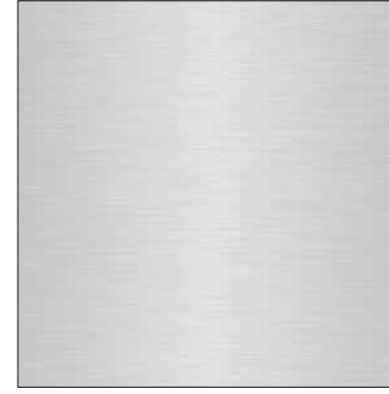

Uygulama / Application

3B cephe / 3D facade

Ürün / Product

Solid

Malzeme / Material

Alüminyum / Aluminium

Yüzey / Surface

Elektrostatik toz boya
Electrostatic powder coating

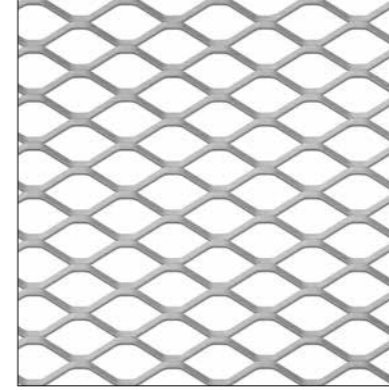

Uygulama / Application

Cephe / Facade

Ürün / Product

115x50x10mm genişletilmiş metal
115x50x10mm expanded mesh metal

Malzeme / Material

Alüminyum / Aluminium

Yüzey / Surface

Elektrostatik toz boya
Electrostatic powder coating

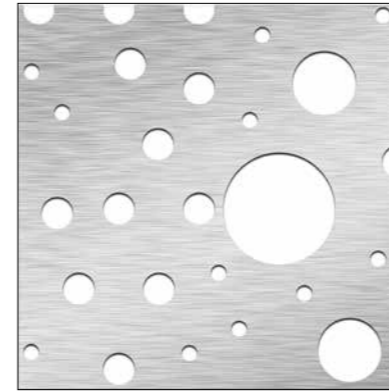

Uygulama / Application

Cephe / Facade

Ürün / Product

Ø20mm, Ø40mm, Ø70mm
multi-perforated metal
Ø20mm, Ø40mm, Ø70mm
multi-perforated metal

Malzeme / Material

Alüminyum / Aluminium

Yüzey / Surface

Elektrostatik toz boya
Electrostatic powder coating

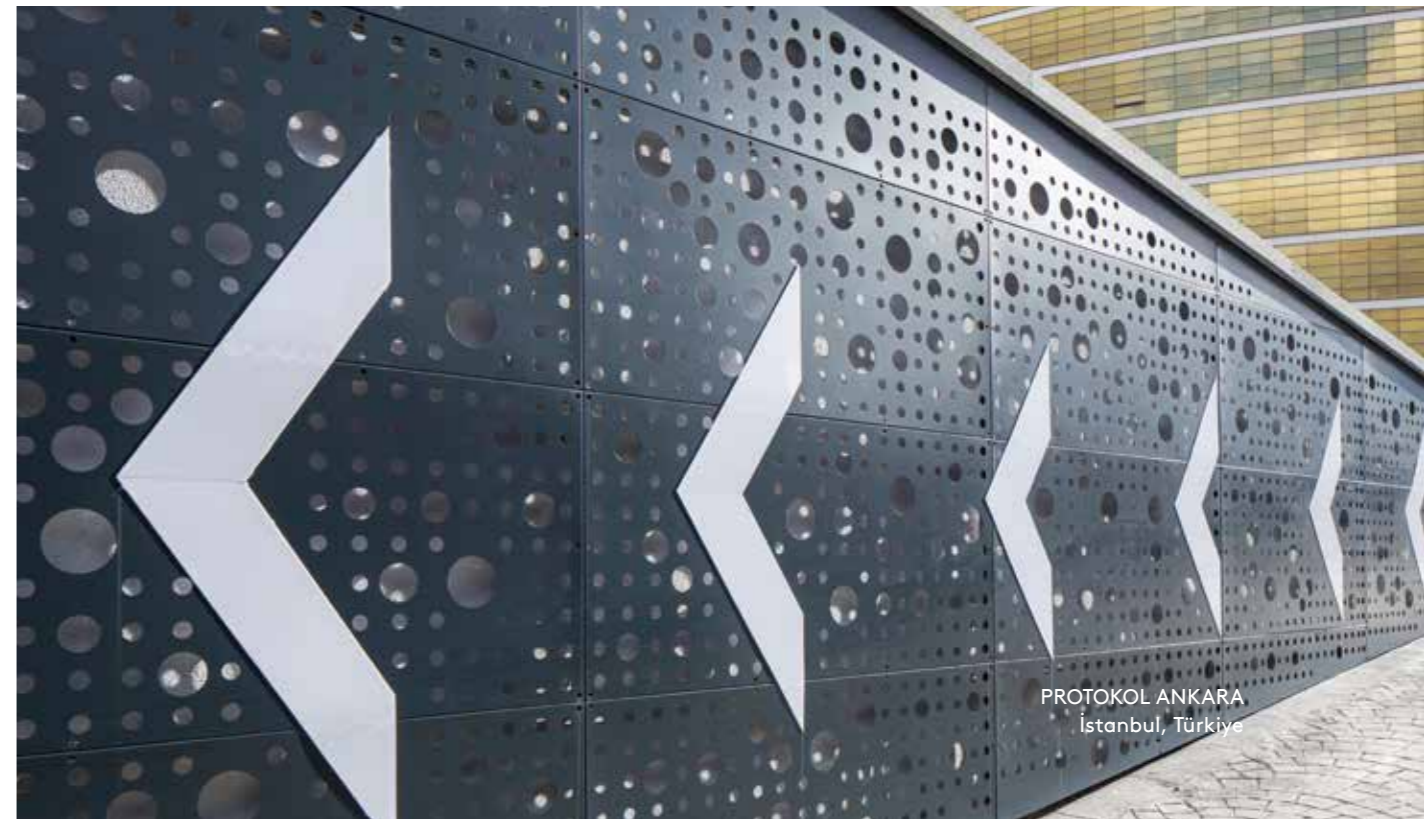



İZMİR ADNAN MENDERES HAVALİMANI / OTOPARK VE TERMİNAL BİNASI

İZMİR ADNAN MENDERES AIRPORT / AUTOPARK AND TERMINAL BUILDING

Yer / Location	İzmir, Türkiye
Tarih / Date	2014
Mimar / Architect	TAV - Yakup Hazan Architecture
Tip / Type	Ulaşım / Transportation
Fotoğraf / Photo	ZM YASA Architectural Photography



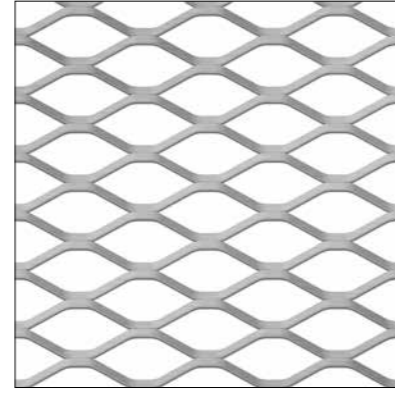

Uygulama / Application

Cephe / Facade

Ürün / Product

160x60x15mm genişletilmiş metal

160x60x15mm expanded mesh metal

Malzeme / Material

Alüminyum / Aluminum

Yüzey / Surface

Eloksal / Anodized



İZMİR ADNAN MENDERES HAVALİMANI / OTOPARK VE TERMİNAL BİNASI
İZMİR ADNAN MENDERES AIRPORT / AUTOPARK AND TERMINAL BUILDING
İzmir, Türkiye



İZMİR ADNAN MENDERES HAVALİMANI / OTOPARK VE TERMİNAL BİNASI
İZMİR ADNAN MENDERES AIRPORT / AUTOPARK AND TERMINAL BUILDING
İzmir, Türkiye

TÜRK TELEKOM STADYUMU

TÜRK TELEKOM STADIUM

Yer / Location	İstanbul, Türkiye
Tarih / Date	2011
Mimar / Architect	ASP Architecture
Tip / Type	Spor Kompleksi / Sports Complex

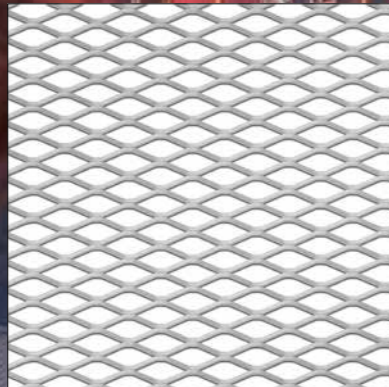

**Uygulama / Application**

Asma tavan / Suspended ceiling

Ürün / Product75x25x5mm genişletilmiş metal
75x25x5mm expanded mesh metal**Malzeme / Material**

Çelik / Steel

Yüzey / SurfaceElektrostatik toz boya
Electrostatic powder coating

GÜRAL SUADIYE RESIDENCE

Yer / Location	İstanbul, Türkiye
Tarih / Date	2016
Mimar / Architect	(EAA) - Emre Arolat Architecture
Tip / Type	Konut / Residential
Fotoğraf / Photo	Cemal Emden



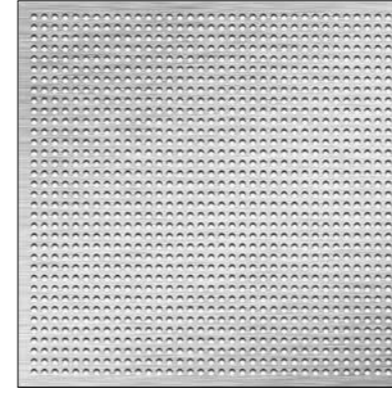

Uygulama / Application

Kayar ve katlanır cephe
Sliding & folding facade

Ürün / Product

Ø5-D8mm delikli metal
Ø5-P8mm perforated metal

Malzeme / Material

Alüminyum / Aluminium

Yüzey / Surface

Elektrostatik toz boya
Electrostatic powder coating



İSTANBUL TEKNİK ÜNİVERSİTESİ / MERKEZ DERSLİK BİNASI

İSTANBUL TECHNICAL UNIVERSITY / LECTURE HALL BUILDING

Yer / Location İstanbul, Türkiye

Tarih / Date 2011

Mimar / Architect Özsoy Architecture

Tip / Type Eğitim / Education

Ödül / Award National Architecture Exhibition 2014, Winner

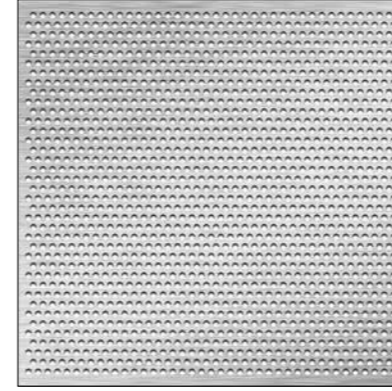

**Uygulama / Application**

Otomasyonlu kayar cephe
Automated sliding facade

Ürün / Product

Ø8-D12mm delikli metal
Ø8-P12mm perforated metal

Malzeme / Material

Alüminyum / Aluminium

Yüzey / Surface

Elektrostatik toz boya
Electrostatic powder coating



İSTANBUL TEKNİK ÜNİVERSİTESİ / MERKEZ DERSLİK BİNASI
İSTANBUL TECHNICAL UNIVERSITY / LECTURE HALL BUILDING
İstanbul, Türkiye

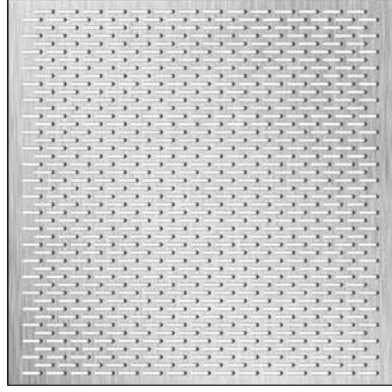

İSTANBUL TEKNİK ÜNİVERSİTESİ / MERKEZ DERSLİK BİNASI
İSTANBUL TECHNICAL UNIVERSITY / LECTURE HALL BUILDING
İstanbul, Türkiye

**Uygulama / Application**

Cephe, Çati, Tavan
Facade, Roof, Ceiling

Ürün / Product

Slot delikli metal
Slot perforated metal

Malzeme / Material

Alüminyum / Aluminium

Yüzey / Surface

PVDF kaplama / PVDF coating

MEEZA DATA CENTER

Yer / Location	Doha, Qatar
Tarih / Date	2011
Mimar / Architect	Arup Associates
Tip / Type	Endüstriyel / Industrial



AUDI SHOWROOM

Yer / Location İstanbul, Türkiye

Tarih / Date 2015, 2016, 2017, 2020

Mimar / Architect AUDI

Tip / Type Ticari / Commercial

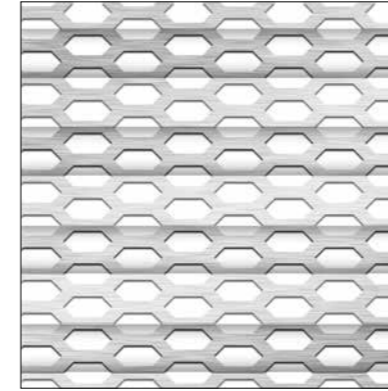

Uygulama / Application

Cephe / Facade

Ürün / Product

Petek delikli metal ve trapez form
Honeycomb perforated metal &
trapezoid form

Malzeme / Material

Alüminyum / Aluminium

Yüzey / Surface

Eloksal / Anodized

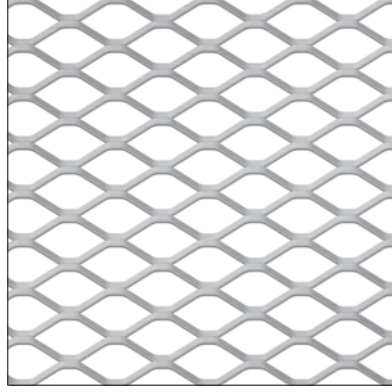

**Uygulama / Application**

Cephe / Facade

Ürün / Product

115x50x11.5mm genişletilmiş metal

115x50x11.5mm expanded mesh metal

Malzeme / Material

Alüminyum / Aluminium

Yüzey / Surface

Elektrostatik toz boya

Electrostatic powder coating

İSTANBUL MEDENİYET ÜNİVERSİTESİ

İSTANBUL MEDENİYET UNIVERSITY

Yer / Location İstanbul, Türkiye**Tarih / Date** 2015**Tip / Type** Eğitim / Education**Fotoğraf / Photo** Altkat Architectural Photography

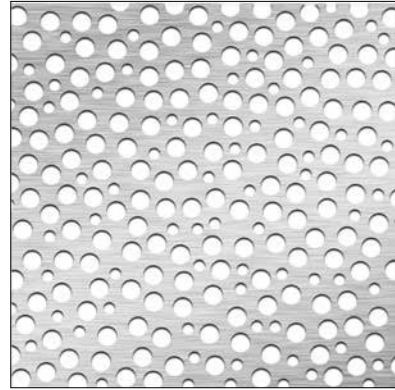
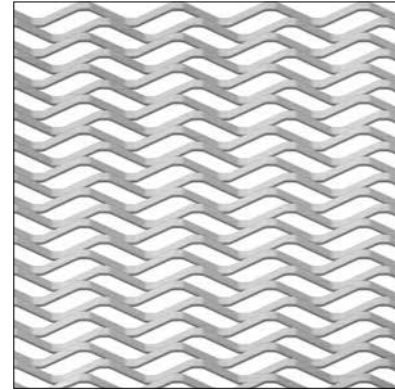
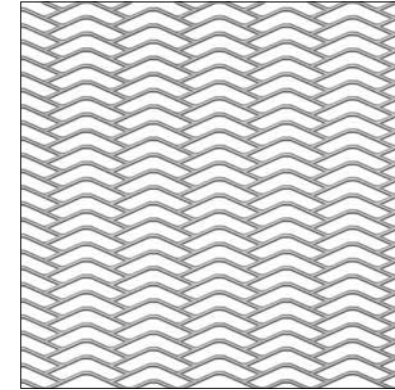
Uygulama / Application
Kanopi / Canopy**Ürün / Product**
Ø15mm, Ø25mm multiperfore metal
Ø15mm, Ø25mm multiperforated metal**Malzeme / Material**
Alüminyum / Aluminium**Yüzey / Surface**
Elektrostatik toz boya
Electrostatic powder coating**Uygulama / Application**
Cephe / Facade**Ürün / Product**
115x50x11mm-S genişletilmiş metal
115x50x11mm-S expanded mesh metal**Malzeme / Material**
Alüminyum / Aluminium**Yüzey / Surface**
Elektrostatik toz boya
Electrostatic powder coating**Uygulama / Application**
Cephe / Facade**Ürün / Product**
115x13x3mm-S genişletilmiş metal
115x13x3mm-S expanded mesh metal**Malzeme / Material**
Alüminyum / Aluminium**Yüzey / Surface**
Elektrostatik toz boya
Electrostatic powder coating

POINT BORNOVA ALIŞVERİŞ MERKEZİ

POINT BORNOVA SHOPPING MALL

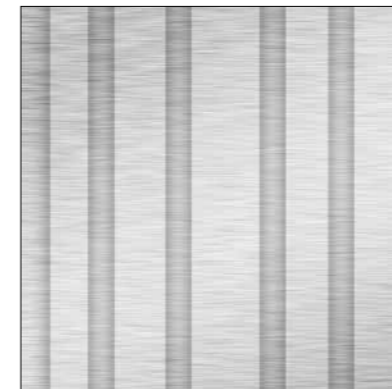
Yer / Location İzmir, Türkiye**Tarih / Date** 2015**Mimar / Architect** Derin Yeşil Architecture**Tip / Type** Alışveriş Merkezi / Shopping Mall**Uygulama / Application**
Kolon / Column**Ürün / Product**
Solid ve trapez form
Solid & trapezoid form**Malzeme / Material**
Alüminyum / Aluminium**Yüzey / Surface**
Elektrostatik toz boya
Electrostatic powder coating

GANACHE PATISSERIE

Yer / Location İstanbul, Türkiye

Tarih / Date 2014

Mimar / Architect Kaf Architecture

Tip / Type Ticari / Commercial

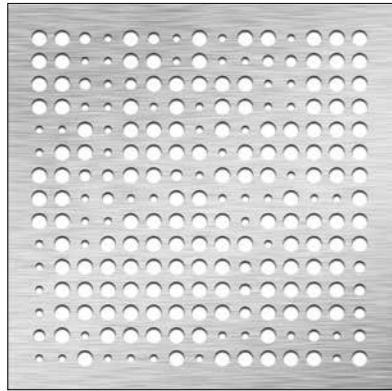

Uygulama / Application

Cephe / Facade

Ürün / Product

Ø10mm, Ø20mm multiperfore metal
Ø10mm, Ø20mm multiperforated metal

Malzeme / Material

Alüminyum / Aluminium

Yüzey / Surface

Elektrostatik toz boya
Electrostatical powder coating



MAKKAH KRALİYET SAAT KULESİ MAKKAH CLOCK ROYAL TOWER

Yer / Location Mecca, Saudi Arabia

Tarih / Date 2013

Mimar / Architect Dar al-Handasah Shair & Partners

Tip / Type Kamu / Public

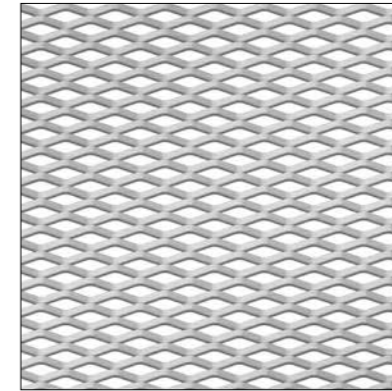

Uygulama / Application

Asma tavan / Suspended ceiling

Ürün / Product

60x20x9mm genişletilmiş metal
60x20x9mm expanded mesh metal

Malzeme / Material

Alüminyum / Aluminium

Yüzey / Surface

Elektrostatik toz boya
Electrostatic powder coating



FOLKART TOWERS

Yer / Location	İzmir, Türkiye
Tarih / Date	2014
Mimar / Architect	Yağcıoğlu Architecture
Tip / Type	Karma Kullanım / Mixed Use

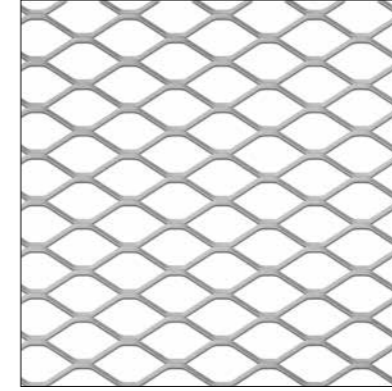

Uygulama / Application

Medya cephe / Media facade

Ürün / Product

115x50x7mm genişletilmiş metal

115x50x7mm expanded mesh metal

Malzeme / Material

Alüminyum / Aluminium

Yüzey / Surface

Elektrostatik toz boya

Electrostatic powder coating



ULUGÖL GENEL MÜDÜRLÜK

ULUGÖL HEADQUARTERS

Yer / Location İstanbul, Türkiye

Tarih / Date 2015

Mimar / Architect Tago Architects

Tip / Type Ofis / Office

Fotoğraf / Photo Gürkan Akay

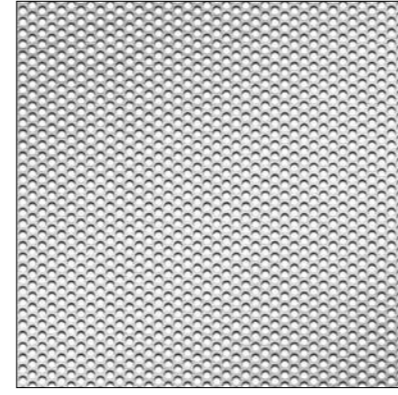

Uygulama / Application

Cephe / Facade

Ürün / Product

Ø10-D13mm delikli metal
Ø10-P13mm perforated metal

Malzeme / Material

Alüminyum / Aluminum

Yüzey / Surface

Elektrostatik toz boya
Electrostatic powder coating

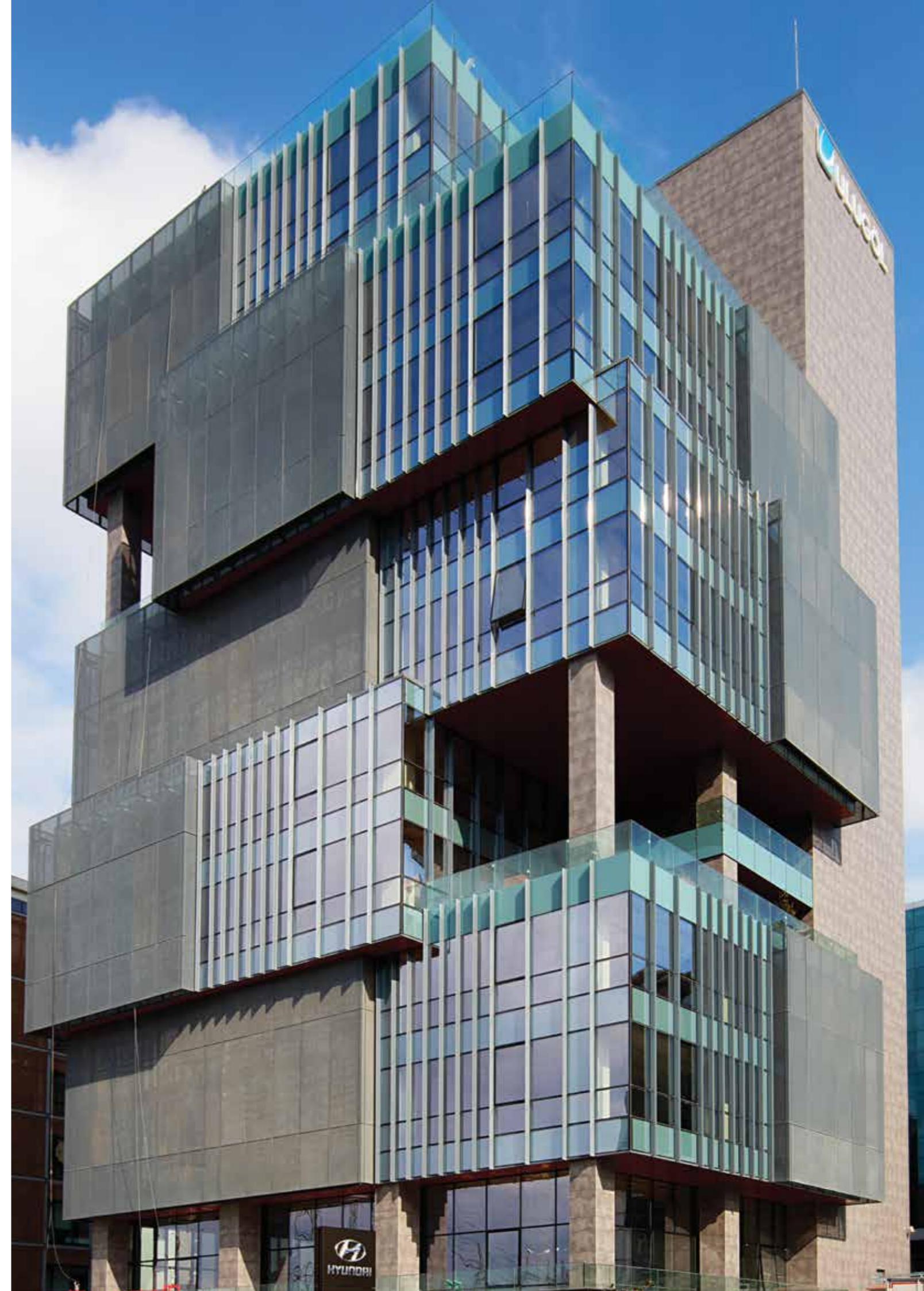



KASSO MÜHENDİSLİK SAN. VE TİC. A.Ş.
İstanbul Anadolu Yakası OSB
2. Sokak No: 5, 34953
Tuzla İstanbul TR

T +90 216 593 14 85 (pbx)
F +90 216 593 14 89

www.kasso.com.tr

KASSO DIŞ TİC. LTD. ŞTİ.
İstanbul Anadolu Yakası OSB
2. Sokak No: 5, 34953
Tuzla İstanbul TR

T +90 216 593 14 86
F +90 216 593 14 89

