

The background is a watercolor-style wash of colors. It features large, overlapping circular and irregular shapes in shades of blue, teal, and green, set against a light beige or cream-colored base. The edges of the washes are soft and feathered, creating a dreamy, artistic atmosphere.

# RIVAGE

BAL HARBOUR

A ONCE-IN-A-LIFETIME OCEANFRONT PARADISE

Perfectly poised on the most beautiful stretch of beach in the country, Rivage Bal Harbour rises from the lush tropical landscape, a beacon of modern living. This very limited collection of bespoke residences offers a luxurious life immersed in nature, mere steps from the ocean on the last beachfront property to be developed in Bal Harbour. These light-filled villas in the sky provide elevated services and amenities on par with the world's finest hotels. The result is a refined and considered approach to total well-being.

An aerial photograph of a coastal city at sunset. The foreground shows a residential area with many palm trees and houses. In the middle ground, there is a large body of water, possibly a bay or harbor, with several islands and a city skyline in the distance. The sky is filled with soft, golden light from the setting sun, with some clouds. The overall scene is peaceful and scenic.

PARADISE FOUND

Rivage Bal Harbour, the last new development on this pristine white sand beach, offers a rare and coveted opportunity. This is an unparalleled location, with unobstructed views of the Atlantic, the Intracoastal Waterway and beyond.

It's paradise on earth.

The background features a watercolor illustration of leaves and branches. The leaves are rendered in various shades of blue and teal, with some areas showing a darker, more saturated blue. The branches are depicted with thin, brownish-gold lines, some of which are slightly thicker and more prominent. The overall style is soft and artistic, with a focus on natural elements. The text 'Architecture & Design' is centered over the white background, which is partially framed by the watercolor elements.

Architecture & Design

SOM

Skidmore, Owings & Merrill (SOM) is a leading architecture, engineering, and planning practice responsible for some of the world's most technically and environmentally advanced buildings and public spaces — from Burj Khalifa in Dubai and One World Trade Center in New York City to Millennium Park in Chicago.





ARRIVAL FROM COLLINS AVENUE

#### TROPICAL MODERNISM

With its signature clean modernism as a point of departure, SOM let the site — with its unique access to the most exclusive beach — influence the evolution. The pure geometry of straight lines yielded to the organic contours of the landscape. The resulting tropical modernism incorporates rounded forms that echo the natural surroundings and maximize views of the Atlantic Ocean and Biscayne Bay.

ARTIST'S CONCEPTUAL RENDERING; SURROUNDING BUILDINGS, LANDSCAPES, AND LANDMARKS MODIFIED OR OMITTED.

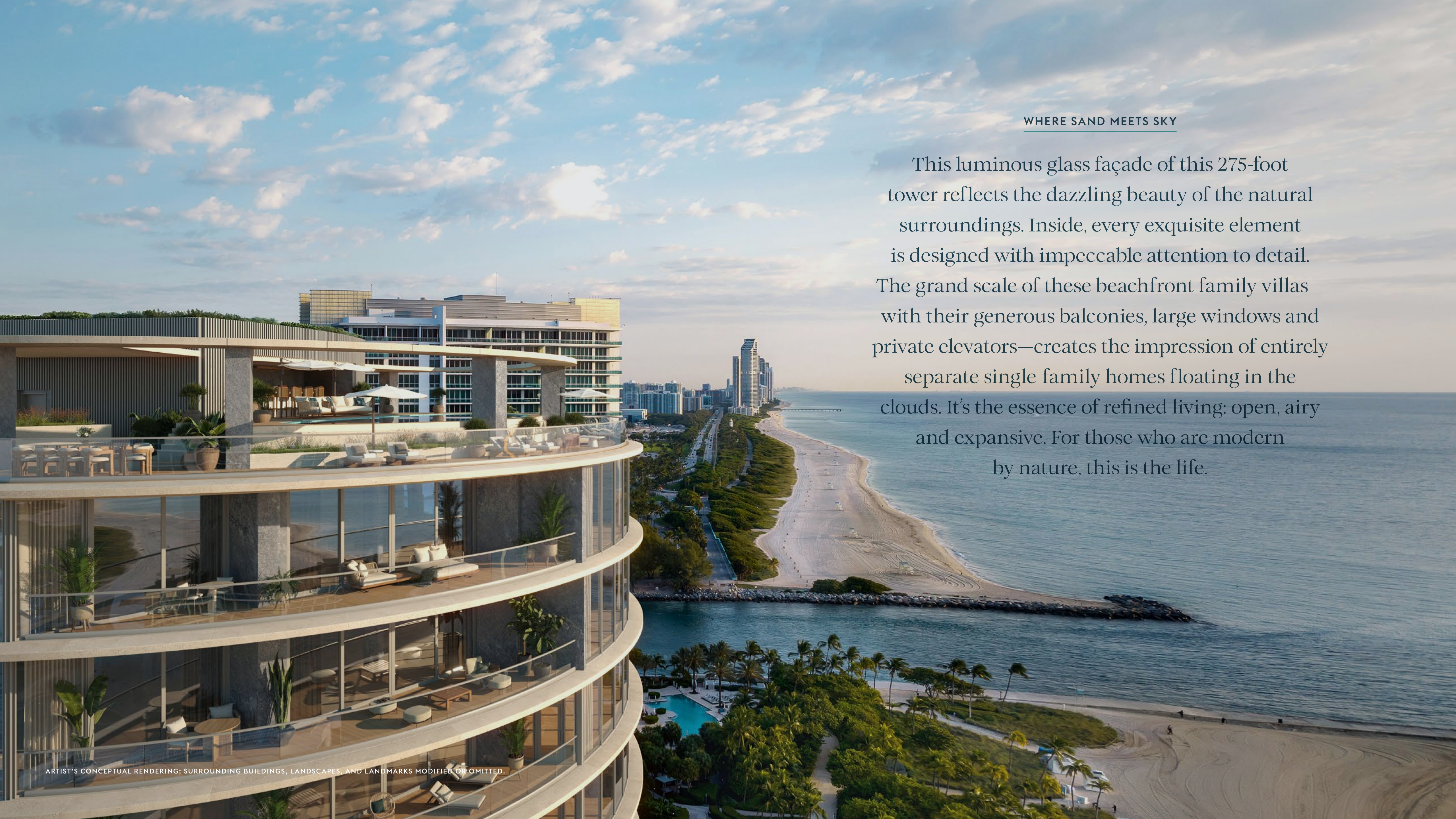

WHERE SAND MEETS SKY

This luminous glass façade of this 275-foot tower reflects the dazzling beauty of the natural surroundings. Inside, every exquisite element is designed with impeccable attention to detail. The grand scale of these beachfront family villas—with their generous balconies, large windows and private elevators—creates the impression of entirely separate single-family homes floating in the clouds. It's the essence of refined living: open, airy and expansive. For those who are modern by nature, this is the life.



The conceal/reveal technique is omnipresent, with water elements, stone walls and prolific plantings carving out intimate spaces and creating thresholds to outdoor rooms, encouraging exploration and surprise. Diaphanous architectural screens in lobbies and lounges, along with changes in elevation, also help build an alternating cadence of intimacy and openness, inviting residents to adventure through the property.



## Property Overview

- 200 linear feet of pristine private shoreline
- 2.67 acres
- 25 stories
- 56 homes designed by world-renowned architecture firm SOM, with interiors by Rottet Studio, and with sweeping views of the Atlantic Ocean and the Miami skyline
- Three- to eight-bedroom residences, ranging from approximately 3,300 to 12,600 SF
- A lavish amenity program, offering the best of Bal Harbour beachfront living
- Elegant two-story lobby, with full-time concierge offering comprehensive, customized services
- Curated art programs rotating in the lobby gallery and throughout the common spaces
- Two-car private garage and storage area for every residence



ARTIST'S CONCEPTUAL RENDERING; SURROUNDING BUILDINGS, LANDSCAPES, AND LANDMARKS MODIFIED OR OMITTED.

## Residences Overview

- Direct private-elevator entry to each residence
- 10-foot ceilings and floor-to-ceiling windows
- Terraces up to 12 feet deep offer direct views of the Atlantic Ocean and Biscayne Bay
- Spacious living, dining and entertaining area
- Custom kitchens with Sub-Zero and Wolf appliance suite (including gas cooktop and full-height wine cellar)
- Dornbracht fixtures, wood and marble finishes
- Custom bathroom and closet suites designed by Rottet Studio feature marble, white oak and Dornbracht fixtures
- Primary bathroom with travertine flooring and walls, marble slab countertop, lacquered vanity, stone-clad bathtub, custom mirrors and light fixtures
- Fully finished wardrobe in every bedroom, with oak millwork and leather-lined drawers

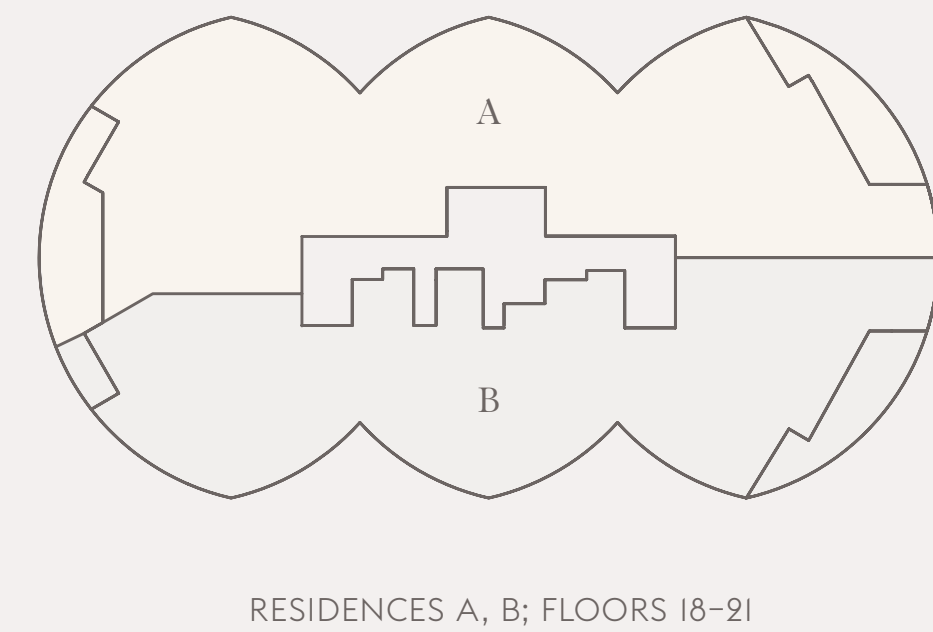
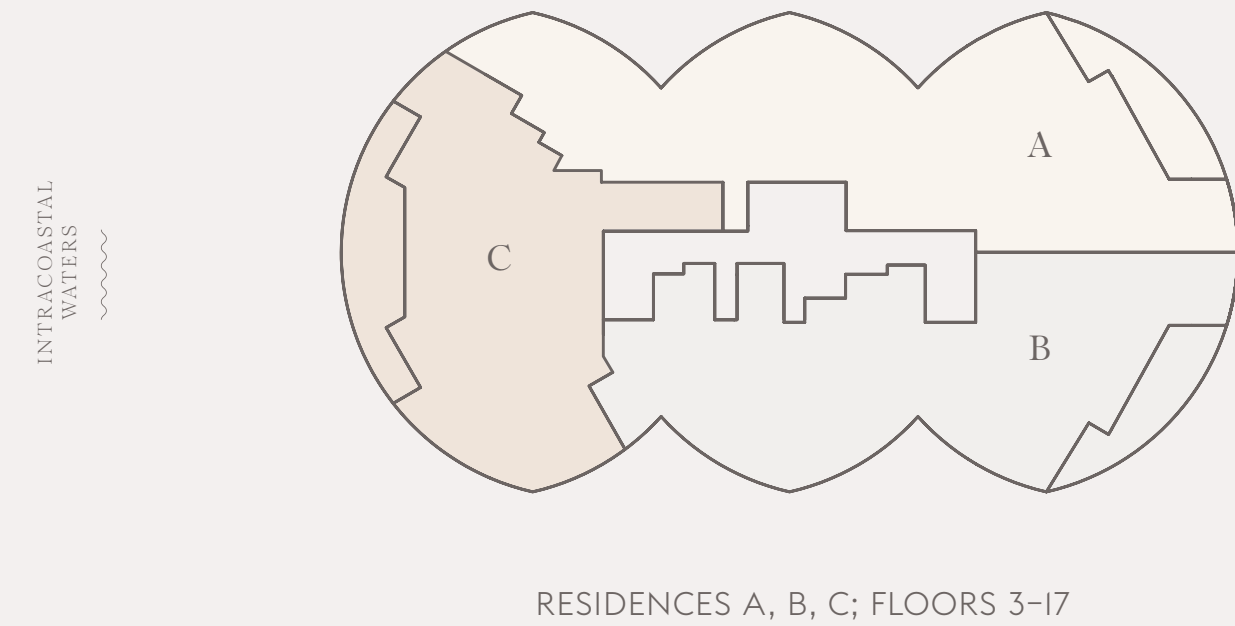
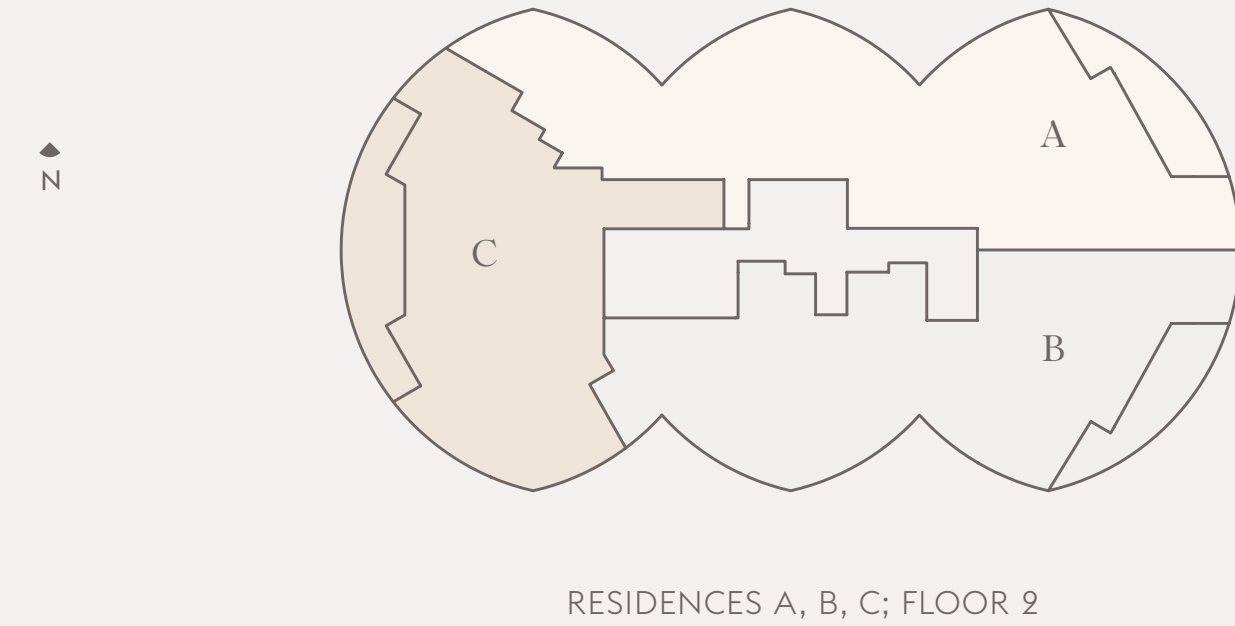





RESIDENCE TERRACE

ARTIST'S CONCEPTUAL RENDERING; SURROUNDING BUILDINGS, LANDSCAPES, AND LANDMARKS MODIFIED OR OMITTED.





ENDLESS SUNRISE VIEWS

ARTIST'S CONCEPTUAL RENDERING; SURROUNDING BUILDINGS, LANDSCAPES, AND LANDMARKS MODIFIED OR OMITTED.

RESIDENCES A & B



LIVING ROOM UNIT A

ARTIST'S CONCEPTUAL RENDERING; SURROUNDING BUILDINGS, LANDSCAPES, AND LANDMARKS MODIFIED OR OMITTED.



PRIMARY BEDROOM UNIT A





CHEF'S KITCHEN WITH CUSTOM MILLWORK, LACQUERED PANEL ISLAND AND INTEGRATED SUB-ZERO AND WOLF APPLIANCES





CHEF'S KITCHEN WITH CUSTOM MILLWORK, LACQUERED PANEL ISLAND AND INTEGRATED SUB-ZERO AND WOLF APPLIANCES



PRIMARY BATHROOM WITH WHITE VOLAKAS MARBLE  
& BRUSHED CHAMPAGNE DORNBRACHT FIXTURES

ARTIST'S CONCEPTUAL RENDERING.



PRIMARY BATHROOM WITH WHITE VOLAKAS MARBLE, FLUTED GLASS SHOWER & BRUSHED CHAMPAGNE DORNBRACHT FIXTURES

ARTIST'S CONCEPTUAL RENDERING.



SECONDARY BATHROOM

ARTIST'S CONCEPTUAL RENDERING.



POWDER ROOM WITH SUPER WHITE MARBLE VANITY & SURROUND  
AND BRUSHED CHAMPAGNE DORNBRACHT FIXTURES



WARDROBE WITH CUSTOM MILLWORK

ARTIST'S CONCEPTUAL RENDERING.

An arched ramp guides ingress through a profusion of plants and trees, like a secret garden that amplifies the sense of discovery and orchestrates the moment of arrival. Ocean breezes beckon.

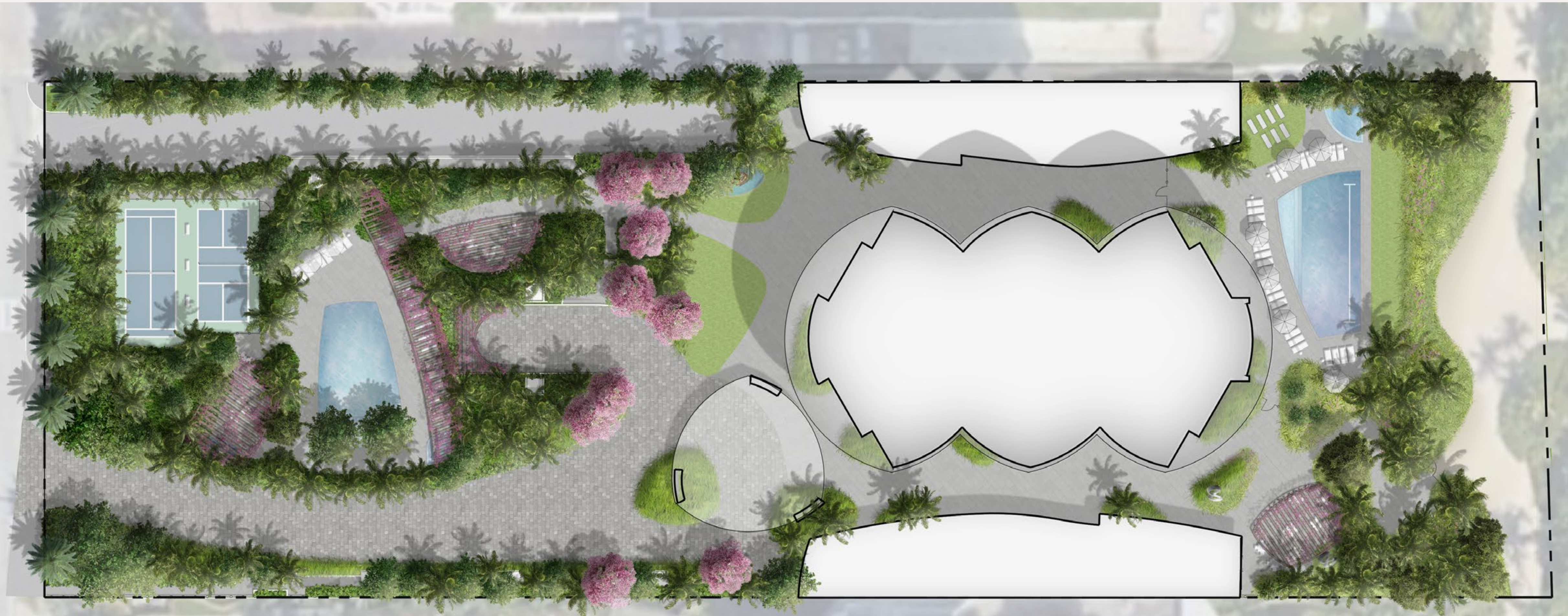

ARTIST'S CONCEPTUAL RENDERING; SURROUNDING BUILDINGS, LANDSCAPES, AND LANDMARKS MODIFIED OR OMITTED.



# A 2

4 BEDROOMS  
 5 BATHROOMS  
 2 POWDER ROOMS  
 DEN / SERVICE  
 OFFICE / GYM

INTERIOR  
 4,784 SF | 444 SQM

EXTERIOR  
 380 SF | 35 SQM

TOTAL  
 5,164 SF | 479 SQM

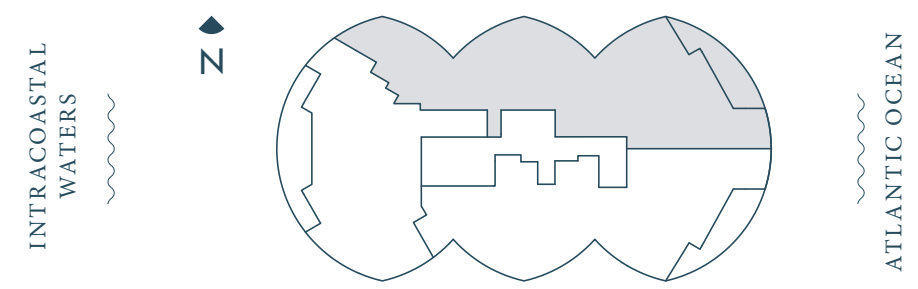
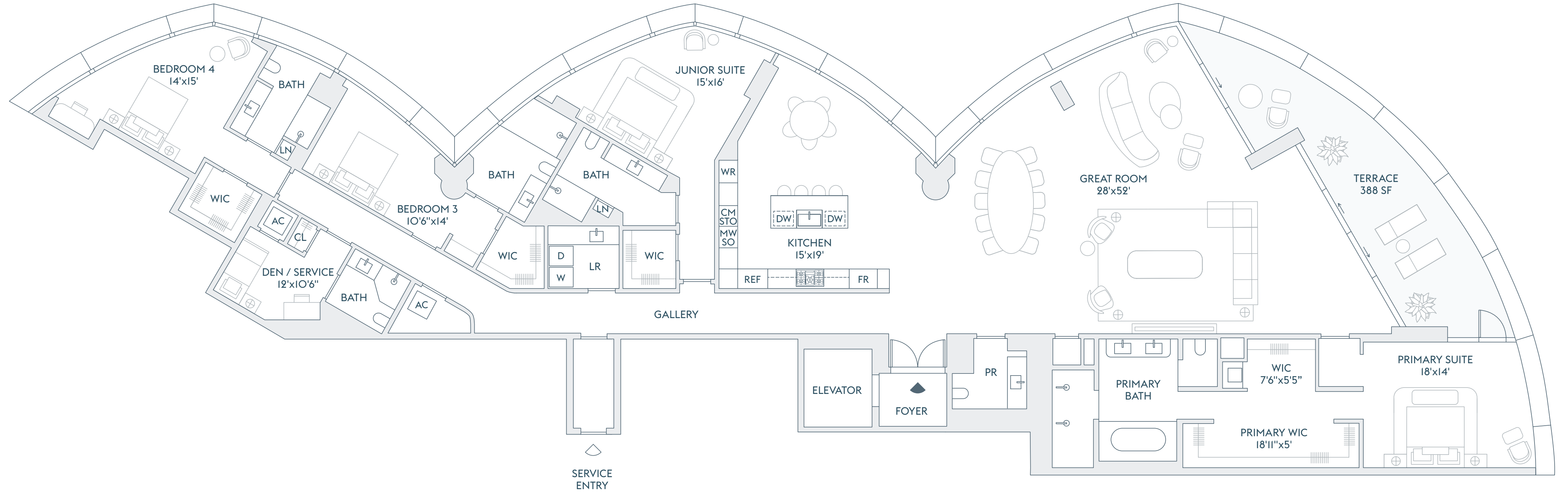

The dimensions stated for this floor plan are approximate because there are various recognized methods for calculating the square footage of a unit. The square footage stated here is calculated from the exterior boundaries of the exterior walls to the centerline of interior demising walls without deductions for cutouts, curves, or architectural features. This method typically results in quoted dimensions greater than the dimensions that would be determined by using other accepted methods. The definition of "Unit" and the calculation method to be relied upon is set forth by the Developer in Developer's prospectus which method may result in a square footage calculation less than the result of the calculation method used here. Renderings depict features not included with purchase, but which are available at an additional cost such as wine bar and closet millwork among others. Consult the Developer's prospectus to learn what is included with Unit purchase and to understand Unit dimensions. 2023 © Carlton Terrace Owner LLC, with all rights reserved.

# A 3-17

4 BEDROOMS  
 5 BATHROOMS  
 2 POWDER ROOMS  
 DEN / SERVICE  
 OFFICE / GYM

INTERIOR  
 4,810 SF | 446.5 SQM

EXTERIOR  
 380 SF | 35 SQM

TOTAL  
 5,190 SF | 481.5 SQM

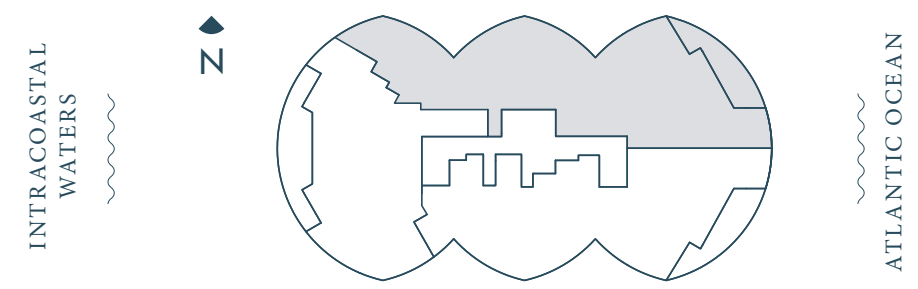
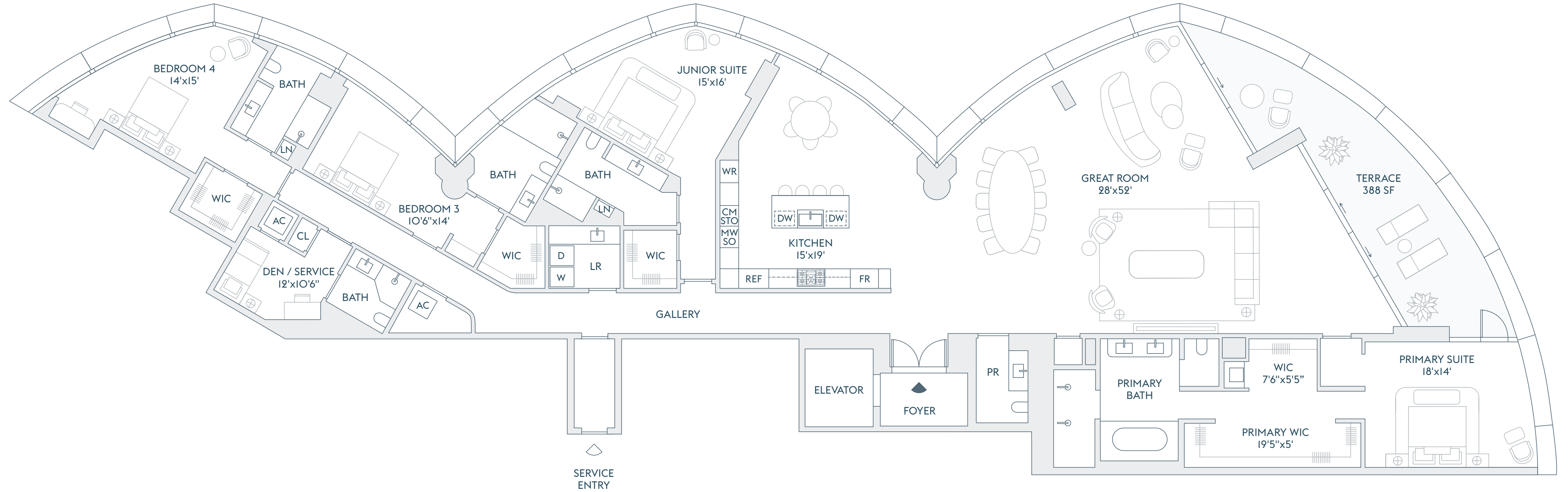

The dimensions stated for this floor plan are approximate because there are various recognized methods for calculating the square footage of a unit. The square footage stated here is calculated from the exterior boundaries of the exterior walls to the centerline of interior demising walls without deductions for cutouts, curves, or architectural features. This method typically results in quoted dimensions greater than the dimensions that would be determined by using other accepted methods. The definition of "Unit" and the calculation method to be relied upon is set forth by the Developer in Developer's prospectus which method may result in a square footage calculation less than the result of the calculation method used here. Renderings depict features not included with purchase, but which are available at an additional cost such as wine bar and closet millwork among others. Consult the Developer's prospectus to learn what is included with Unit purchase and to understand Unit dimensions. 2023 © Carlton Terrace Owner LLC, with all rights reserved.

# B 2

4 BEDROOMS  
 5 BATHROOMS  
 1 POWDER ROOM  
 DEN / SERVICE

INTERIOR  
 4,215 SF | 391.5 SQM

EXTERIOR  
 387 SF | 36 SQM

TOTAL  
 4,602 SF | 427.5 SQM

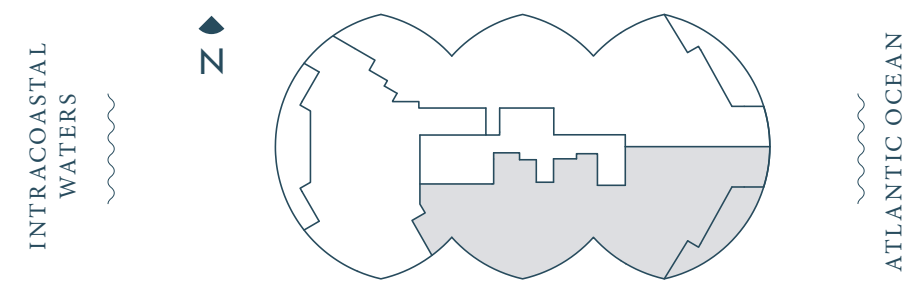
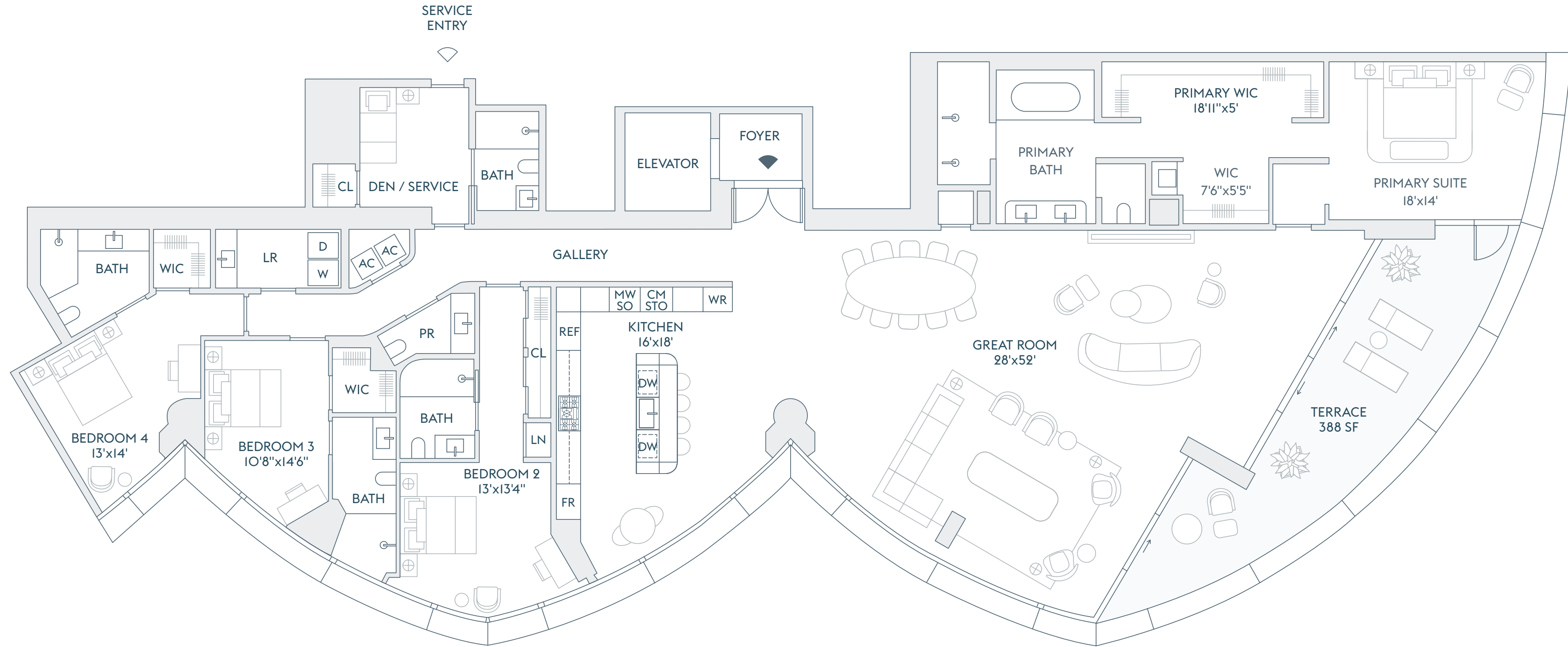

The dimensions stated for this floor plan are approximate because there are various recognized methods for calculating the square footage of a unit. The square footage stated here is calculated from the exterior boundaries of the exterior walls to the centerline of interior demising walls without deductions for cutouts, curves, or architectural features. This method typically results in quoted dimensions greater than the dimensions that would be determined by using other accepted methods. The definition of "Unit" and the calculation method to be relied upon is set forth by the Developer in Developer's prospectus which method may result in a square footage calculation less than the result of the calculation method used here. Renderings depict features not included with purchase, but which are available at an additional cost such as wine bar and closet millwork among others. Consult the Developer's prospectus to learn what is included with Unit purchase and to understand Unit dimensions. 2023 © Carlton Terrace Owner LLC, with all rights reserved.

# B 3-17

4 BEDROOMS  
 5 BATHROOMS  
 1 POWDER ROOM  
 DEN / SERVICE

INTERIOR  
 4,358 SF | 404.5 SQM

EXTERIOR  
 387 SF | 36 SQM

TOTAL  
 4,745 SF | 440.5 SQM

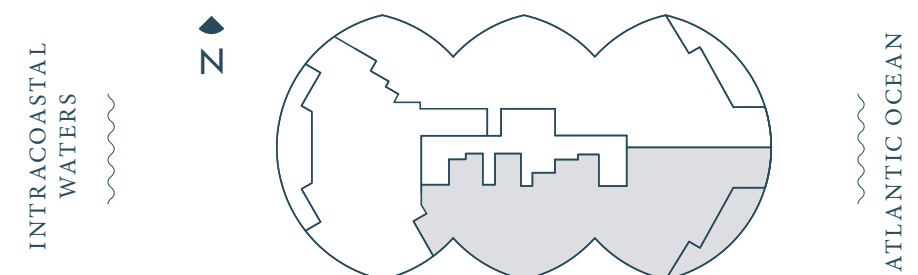
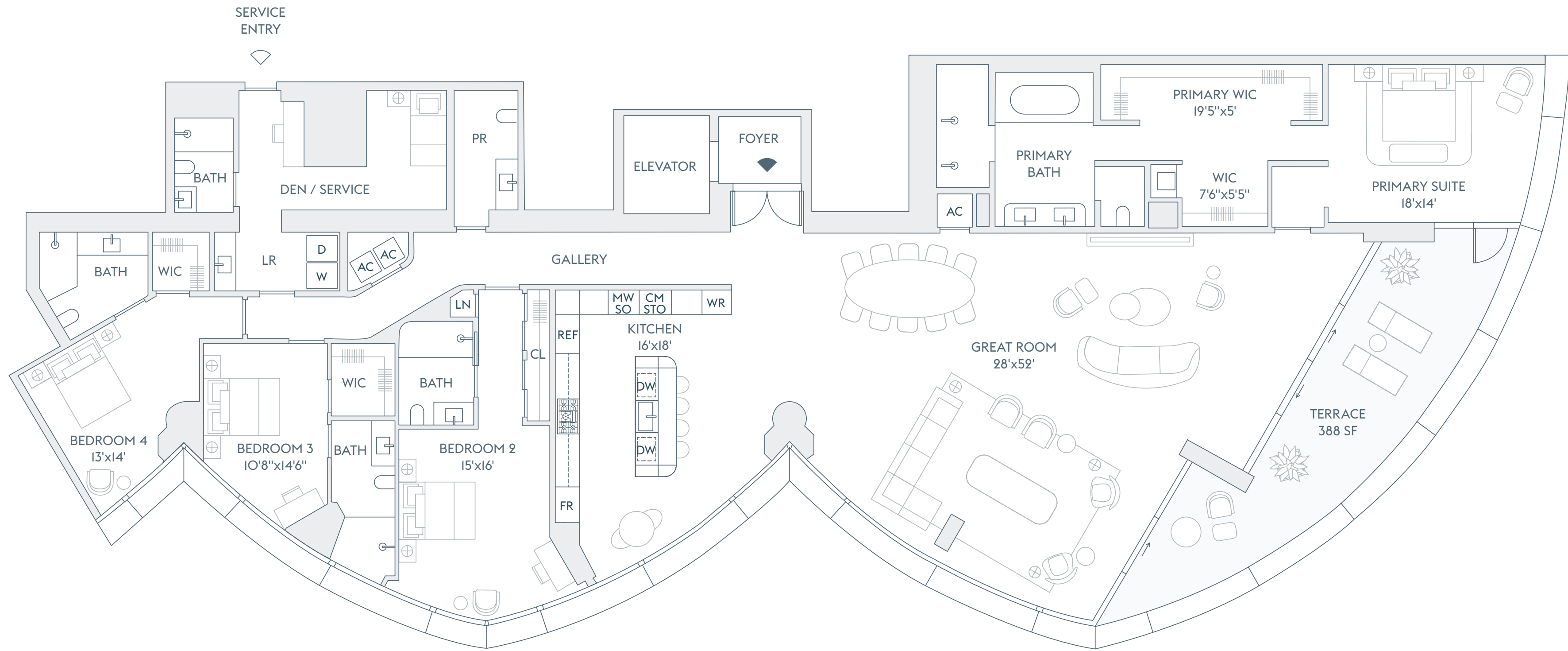

The dimensions stated for this floor plan are approximate because there are various recognized methods for calculating the square footage of a unit. The square footage stated here is calculated from the exterior boundaries of the exterior walls to the centerline of interior demising walls without deductions for cutouts, curves, or architectural features. This method typically results in quoted dimensions greater than the dimensions that would be determined by using other accepted methods. The definition of "Unit" and the calculation method to be relied upon is set forth by the Developer in Developer's prospectus which method may result in a square footage calculation less than the result of the calculation method used here. Renderings depict features not included with purchase, but which are available at an additional cost such as wine bar and closet millwork among others. Consult the Developer's prospectus to learn what is included with Unit purchase and to understand Unit dimensions. 2023 © Carlton Terrace Owner LLC, with all rights reserved.

RESIDENCE FLOOR

# C 2

3 BEDROOMS  
3 BATHROOMS  
1 POWDER ROOM  
OFFICE / DEN

INTERIOR  
3,284 SF | 305 SQM

EXTERIOR  
585 SF | 54 SQM

TOTAL  
3,869 SF | 359 SQM

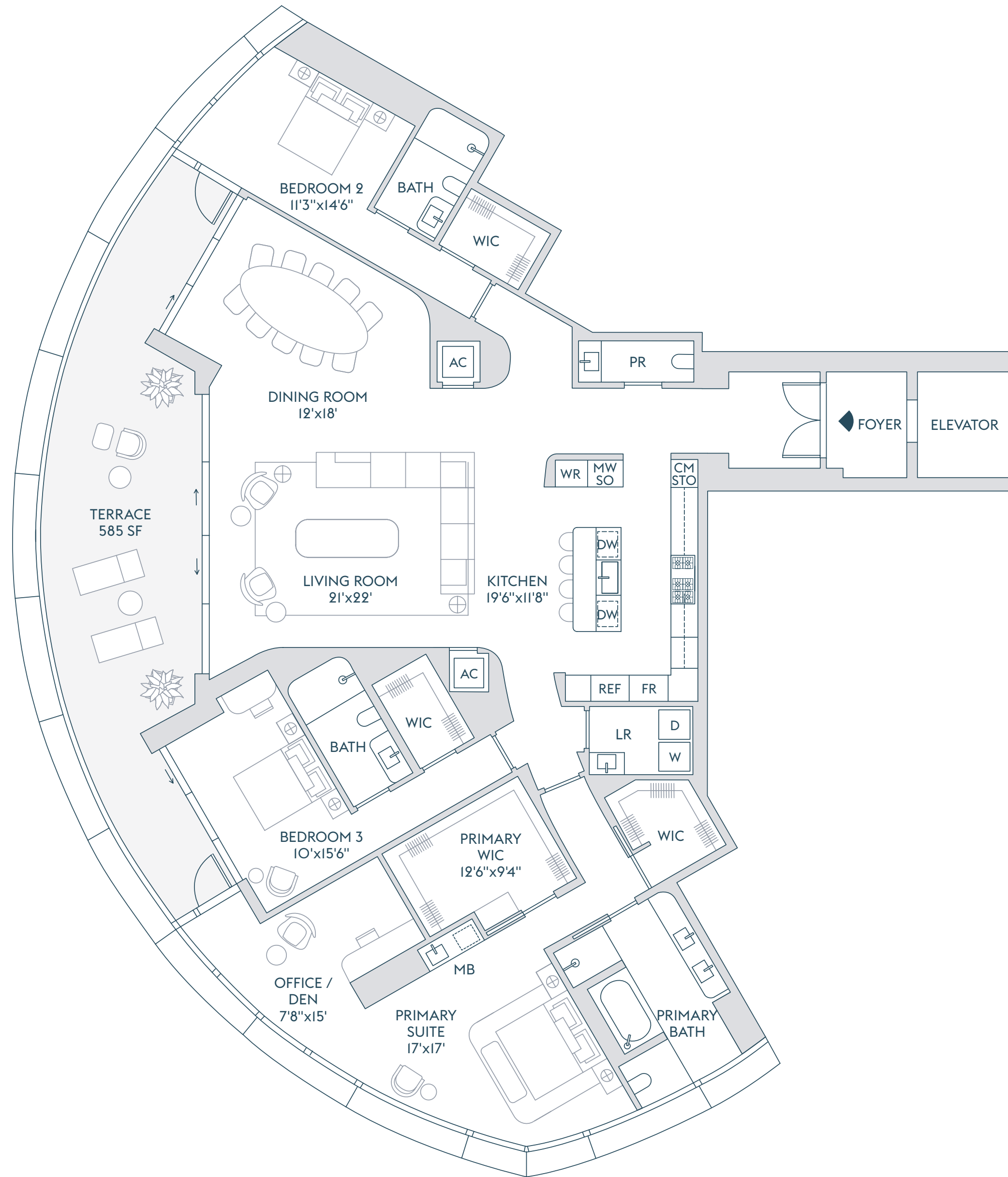

INTRACOASTAL  
WATERS

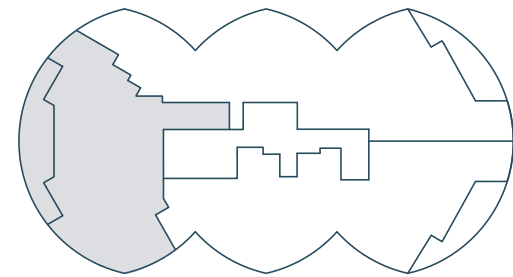

ATLANTIC OCEAN

The dimensions stated for this floor plan are approximate because there are various recognized methods for calculating the square footage of a unit. The square footage stated here is calculated from the exterior boundaries of the exterior walls to the centerline of interior demising walls without deductions for cutouts, curves, or architectural features. This method typically results in quoted dimensions greater than the dimensions that would be determined by using other accepted methods. The definition of "Unit" and the calculation method to be relied upon is set forth by the Developer in Developer's prospectus which method may result in a square footage calculation less than the result of the calculation method used here. Renderings depict features not included with purchase, but which are available at an additional cost such as wine bar and closet millwork among others. Consult the Developer's prospectus to learn what is included with Unit purchase and to understand Unit dimensions. 2023 © Carlton Terrace Owner LLC, with all rights reserved.

RESIDENCE

FLOORS

C

3-17

3 BEDROOMS  
3 BATHROOMS  
1 POWDER ROOM  
OFFICE / DEN

INTERIOR  
3,297 SF | 306.5 SQM

EXTERIOR  
585 SF | 54 SQM

TOTAL  
3,882 SF | 360.5 SQM

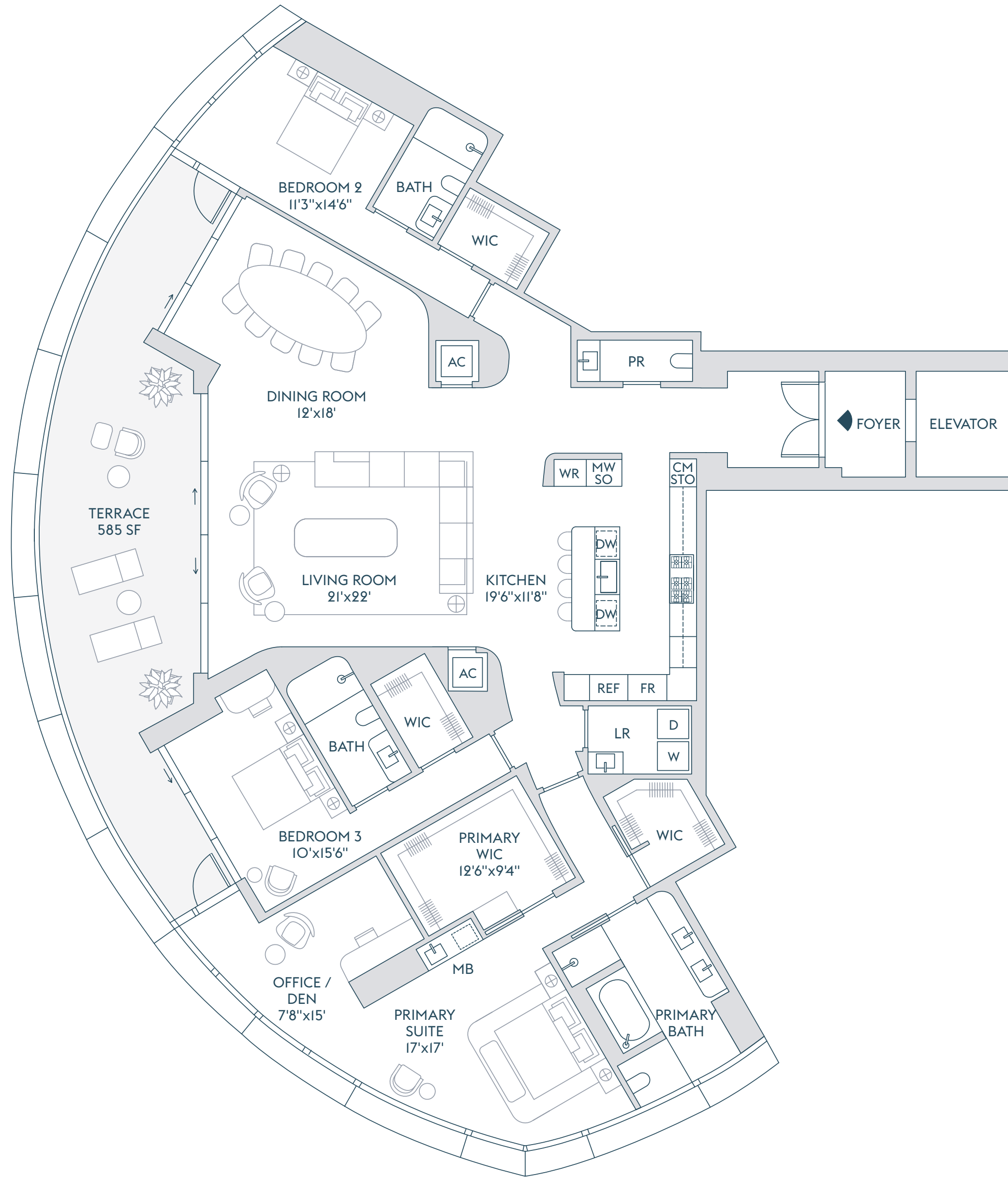

INTRACOASTAL  
WATERS

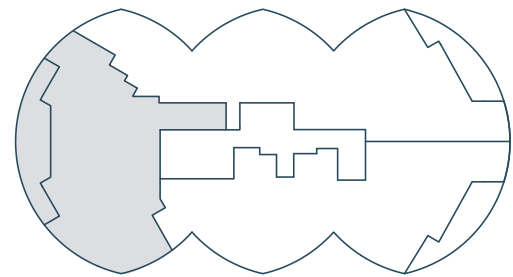

ATLANTIC OCEAN

The dimensions stated for this floor plan are approximate because there are various recognized methods for calculating the square footage of a unit. The square footage stated here is calculated from the exterior boundaries of the exterior walls to the centerline of interior demising walls without deductions for cutouts, curves, or architectural features. This method typically results in quoted dimensions greater than the dimensions that would be determined by using other accepted methods. The definition of "Unit" and the calculation method to be relied upon is set forth by the Developer in Developer's prospectus which method may result in a square footage calculation less than the result of the calculation method used here. Renderings depict features not included with purchase, but which are available at an additional cost such as wine bar and closet millwork among others. Consult the Developer's prospectus to learn what is included with Unit purchase and to understand Unit dimensions. 2023 © Carlton Terrace Owner LLC, with all rights reserved.

# A 18-21

- 4 BEDROOMS
- 6 BATHROOMS
- POWDER ROOM
- OFFICE / BEDROOM
- FAMILY ROOM
- DEN
- SERVICE

INTERIOR  
6,655 SF | 618 SQM

EXTERIOR  
876 SF | 81 SQM

TOTAL  
7,531 SF | 700 SQM

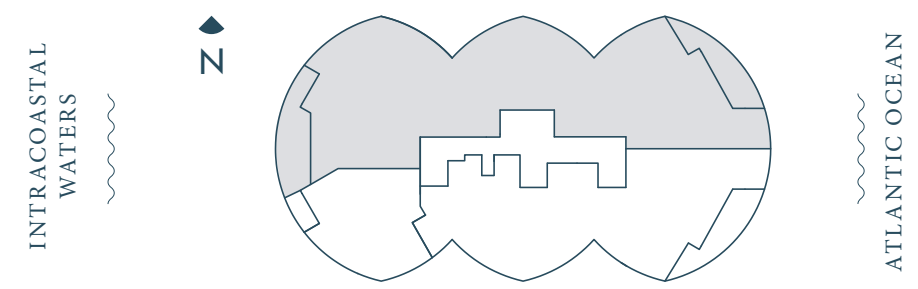
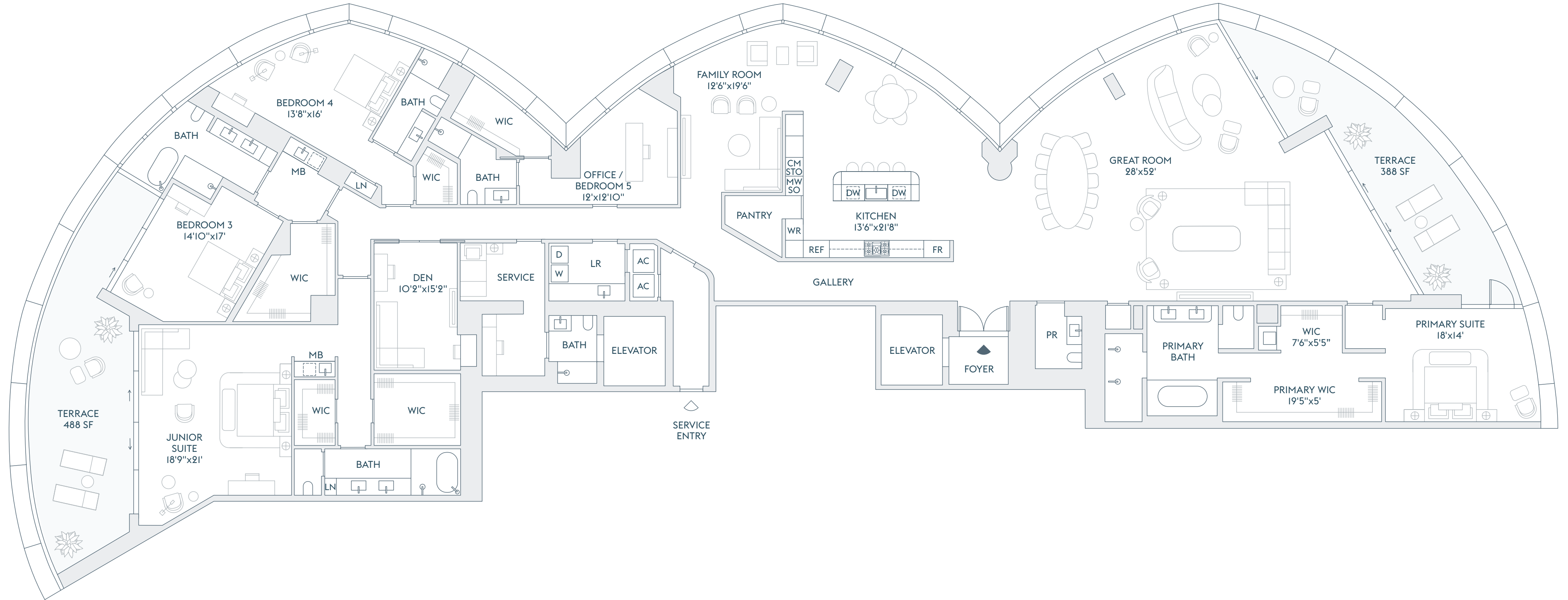

The dimensions stated for this floor plan are approximate because there are various recognized methods for calculating the square footage of a unit. The square footage stated here is calculated from the exterior boundaries of the exterior walls to the centerline of interior demising walls without deductions for cutouts, curves, or architectural features. This method typically results in quoted dimensions greater than the dimensions that would be determined by using other accepted methods. The definition of "Unit" and the calculation method to be relied upon is set forth by the Developer in Developer's prospectus which method may result in a square footage calculation less than the result of the calculation method used here. Renderings depict features not included with purchase, but which are available at an additional cost such as wine bar and closet millwork among others. Consult the Developer's prospectus to learn what is included with Unit purchase and to understand Unit dimensions. 2023 © Carlton Terrace Owner LLC, with all rights reserved.

# B 18-21

- 4 BEDROOMS
- 6 BATHROOMS
- POWDER ROOM
- OFFICE / BEDROOM
- FAMILY ROOM
- DEN
- SERVICE

INTERIOR  
5,810 SF | 540 SQM

EXTERIOR  
485 SF | 45 SQM

TOTAL  
6,295 SF | 585 SQM

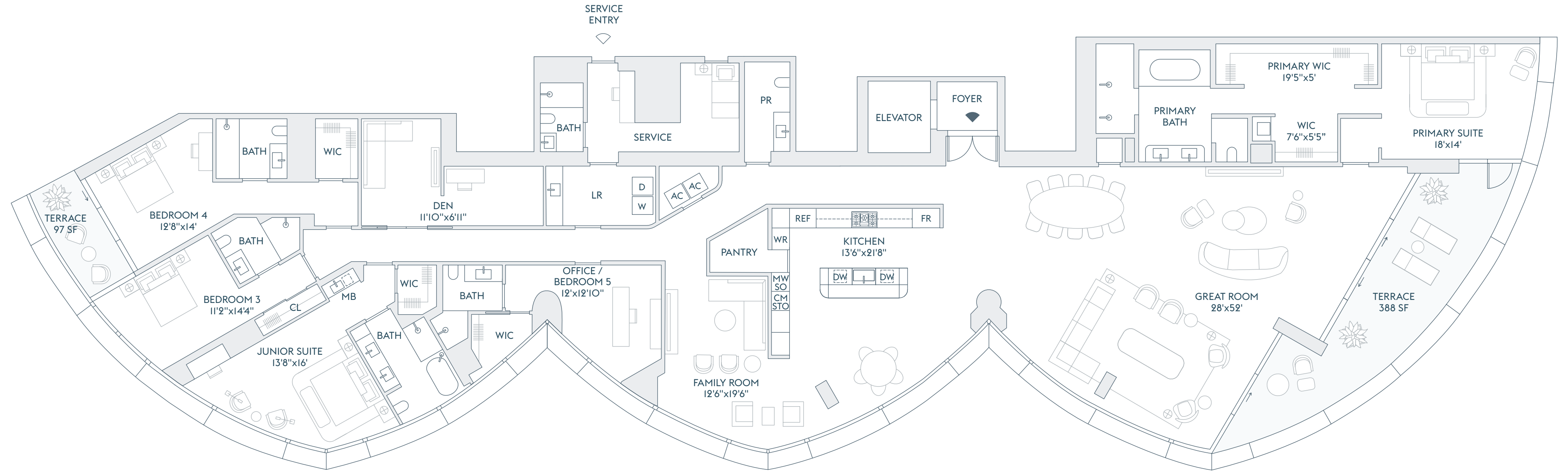

INTRACOASTAL WATERS

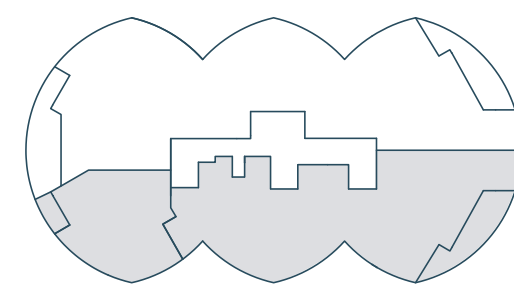

ATLANTIC OCEAN

The dimensions stated for this floor plan are approximate because there are various recognized methods for calculating the square footage of a unit. The square footage stated here is calculated from the exterior boundaries of the exterior walls to the centerline of interior demising walls without deductions for cutouts, curves, or architectural features. This method typically results in quoted dimensions greater than the dimensions that would be determined by using other accepted methods. The definition of "Unit" and the calculation method to be relied upon is set forth by the Developer in Developer's prospectus which method may result in a square footage calculation less than the result of the calculation method used here. Renderings depict features not included with purchase, but which are available at an additional cost such as wine bar and closet millwork among others. Consult the Developer's prospectus to learn what is included with Unit purchase and to understand Unit dimensions. 2023 © Carlton Terrace Owner LLC, with all rights reserved.



# A 23, 24, 25

- 5 BEDROOMS
- 7 BATHROOMS
- 3 POWDER ROOMS
- DEN / SERVICE
- MEDIA ROOM
- GAME ROOM
- LIBRARY / LOUNGE
- FITNESS STUDIO
- OUTDOOR KITCHEN
- POOL
- PRIVATE ELEVATOR

INTERIOR  
12,603 SF | 1,171 SQM

EXTERIOR  
4,918 SF | 457 SQM

TOTAL  
17,521 SF | 1,628 SQM

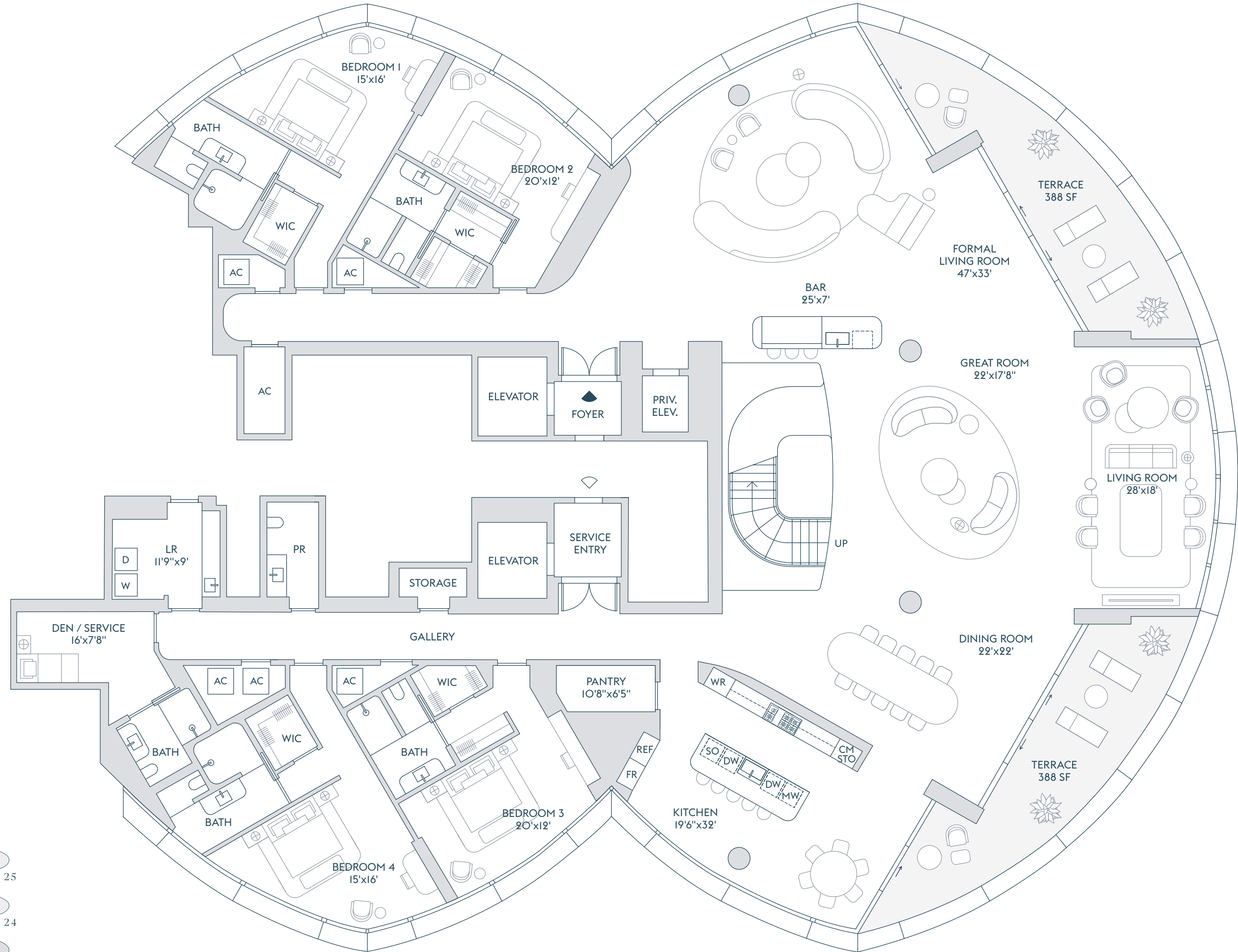

INTRACOASTAL  
WATERS

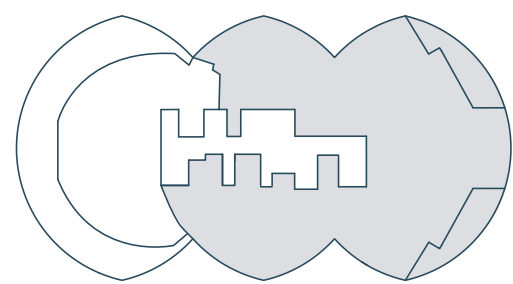

ATLANTIC OCEAN

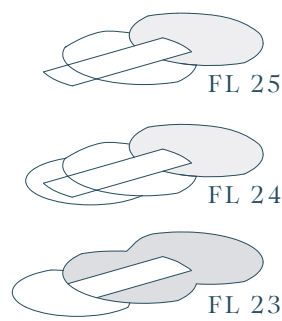

FLOOR 23

The dimensions stated for this floor plan are approximate because there are various recognized methods for calculating the square footage of a unit. The square footage stated here is calculated from the exterior boundaries of the exterior walls to the centerline of interior demising walls without deductions for cutouts, curves, or architectural features. This method typically results in quoted dimensions greater than the dimensions that would be determined by using other accepted methods. The definition of "Unit" and the calculation method to be relied upon is set forth by the Developer in Developer's prospectus which method may result in a square footage calculation less than the result of the calculation method used here. Renderings depict features not included with purchase, but which are available at an additional cost such as wine bar and closet millwork among others. Consult the Developer's prospectus to learn what is included with Unit purchase and to understand Unit dimensions. 2023 © Carlton Terrace Owner LLC, with all rights reserved.

# A 23, 24, 25

- 5 BEDROOMS
- 7 BATHROOMS
- 3 POWDER ROOMS
- DEN / SERVICE
- MEDIA ROOM
- GAME ROOM
- LIBRARY / LOUNGE
- FITNESS STUDIO
- OUTDOOR KITCHEN
- POOL
- PRIVATE ELEVATOR

INTERIOR  
12,603 SF | 1,171 SQM

EXTERIOR  
4,918 SF | 457 SQM

TOTAL  
17,521 SF | 1,628 SQM

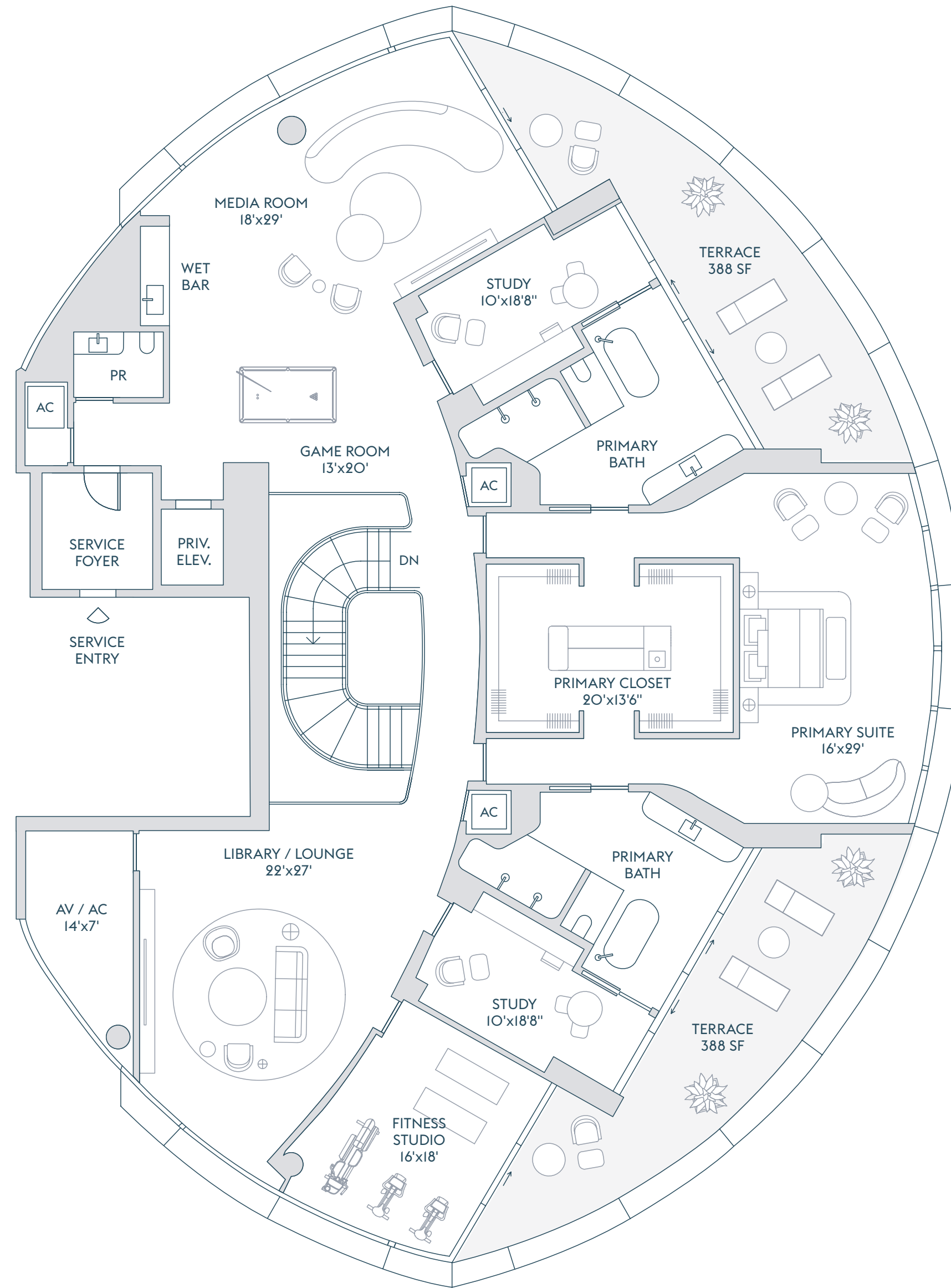

INTRACOASTAL  
WATERS

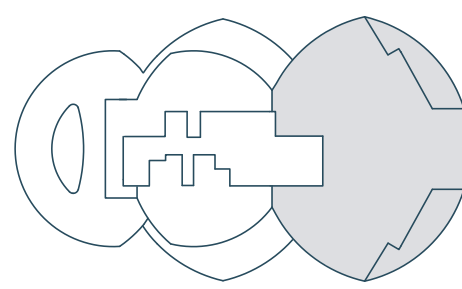

ATLANTIC OCEAN

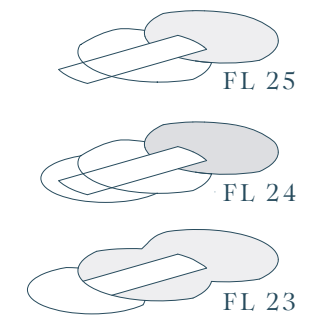

FLOOR 24

The dimensions stated for this floor plan are approximate because there are various recognized methods for calculating the square footage of a unit. The square footage stated here is calculated from the exterior boundaries of the exterior walls to the centerline of interior demising walls without deductions for cutouts, curves, or architectural features. This method typically results in quoted dimensions greater than the dimensions that would be determined by using other accepted methods. The definition of "Unit" and the calculation method to be relied upon is set forth by the Developer in Developer's prospectus which method may result in a square footage calculation less than the result of the calculation method used here. Renderings depict features not included with purchase, but which are available at an additional cost such as wine bar and closet millwork among others. Consult the Developer's prospectus to learn what is included with Unit purchase and to understand Unit dimensions. 2023 © Carlton Terrace Owner LLC, with all rights reserved.

# A 23, 24, 25

- 5 BEDROOMS
- 7 BATHROOMS
- 3 POWDER ROOMS
- DEN / SERVICE
- MEDIA ROOM
- GAME ROOM
- LIBRARY / LOUNGE
- FITNESS STUDIO
- OUTDOOR KITCHEN
- POOL
- PRIVATE ELEVATOR

INTERIOR  
12,603 SF | 1,171 SQM

EXTERIOR  
4,918 SF | 457 SQM

TOTAL  
17,521 SF | 1,628 SQM

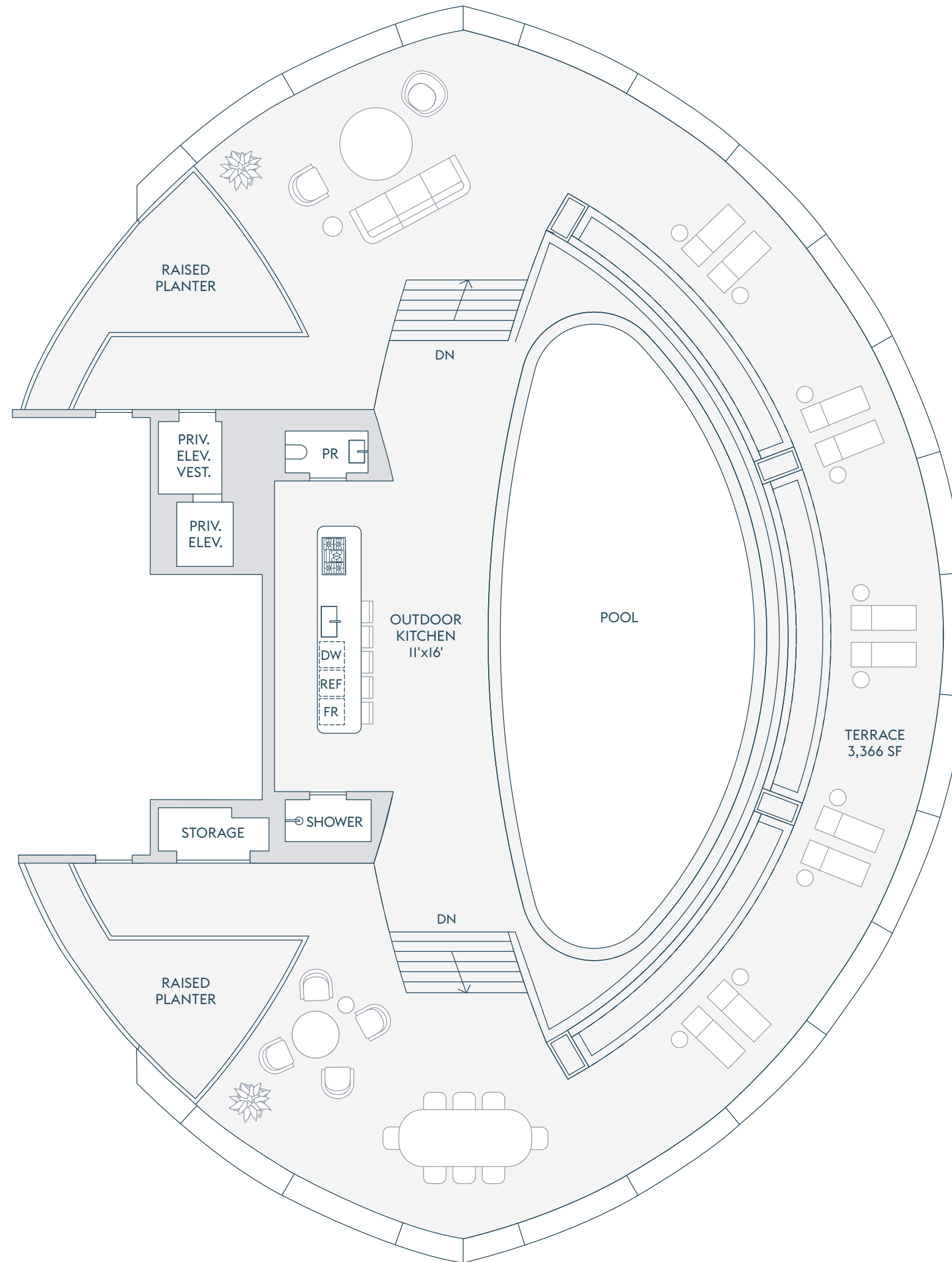

INTRACOASTAL  
WATERS

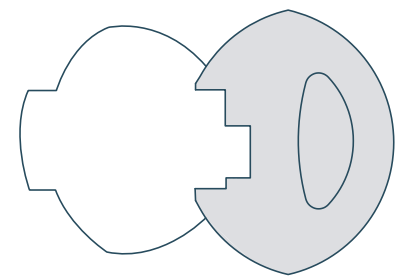

ATLANTIC OCEAN

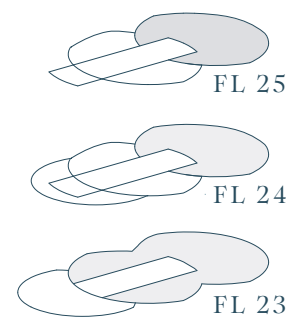

FLOOR 25

The dimensions stated for this floor plan are approximate because there are various recognized methods for calculating the square footage of a unit. The square footage stated here is calculated from the exterior boundaries of the exterior walls to the centerline of interior demising walls without deductions for cutouts, curves, or architectural features. This method typically results in quoted dimensions greater than the dimensions that would be determined by using other accepted methods. The definition of "Unit" and the calculation method to be relied upon is set forth by the Developer in Developer's prospectus which method may result in a square footage calculation less than the result of the calculation method used here. Renderings depict features not included with purchase, but which are available at an additional cost such as wine bar and closet millwork among others. Consult the Developer's prospectus to learn what is included with Unit purchase and to understand Unit dimensions. 2023 © Carlton Terrace Owner LLC, with all rights reserved.

# C 22, 23, 24

- 5 BEDROOMS
- 9 BATHROOMS
- POWDER ROOM
- 2 DEN / SERVICE
- FAMILY ROOM
- FITNESS STUDIO
- SKY ROOM
- OUTDOOR KITCHEN
- POOL
- PRIVATE ELEVATOR

INTERIOR  
8,677 SF | 806 SQM

EXTERIOR  
4,928 SF | 458 SQM

TOTAL  
13,605 SF | 1,264 SQM

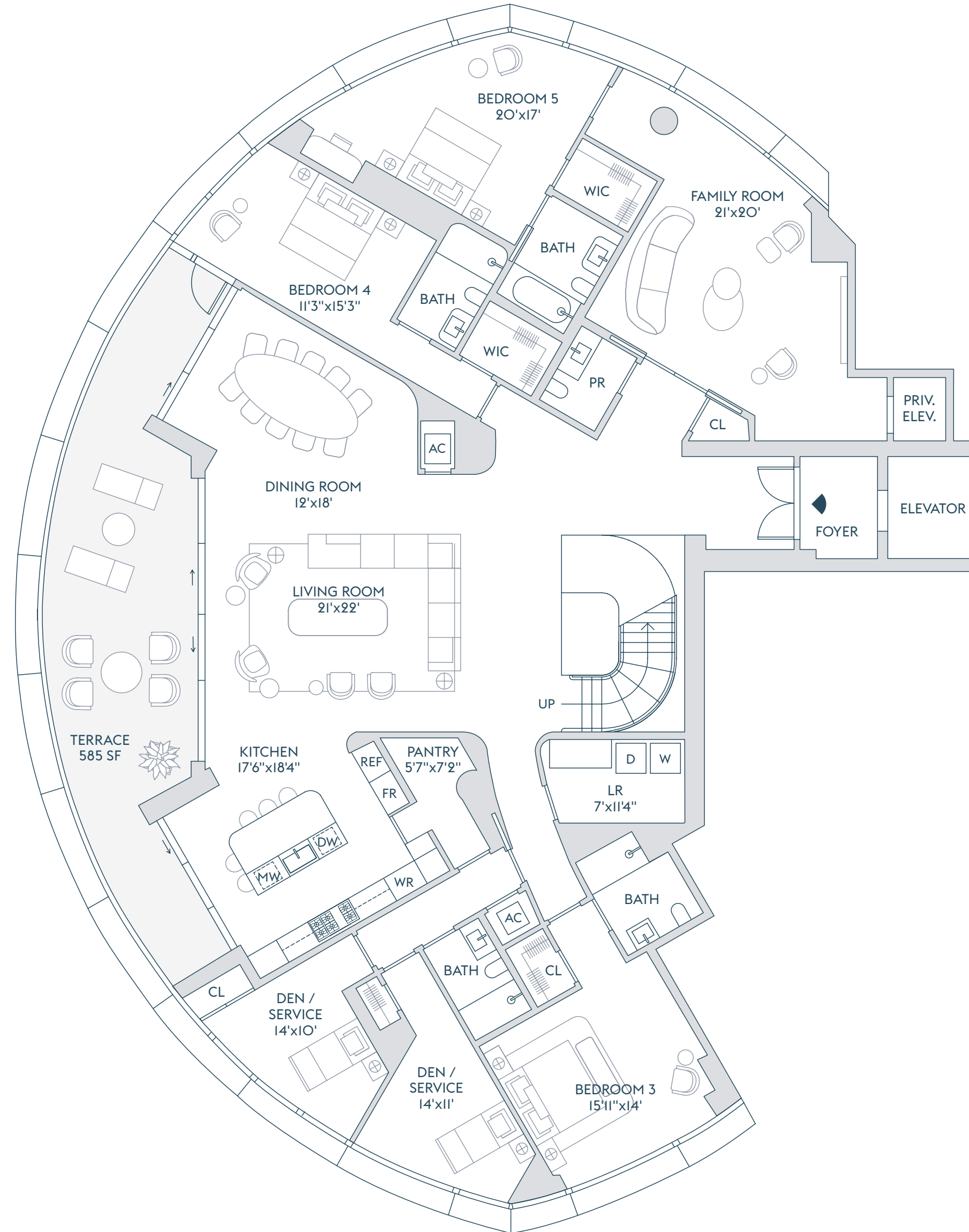

INTRACOASTAL  
WATERS

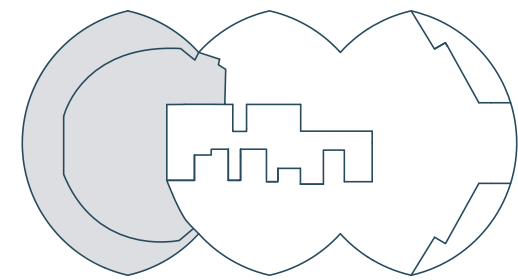

ATLANTIC OCEAN

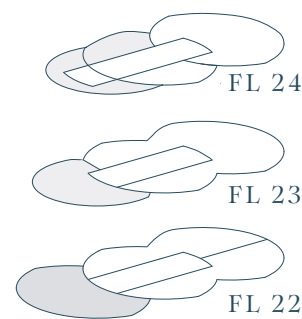

FLOOR 22

The dimensions stated for this floor plan are approximate because there are various recognized methods for calculating the square footage of a unit. The square footage stated here is calculated from the exterior boundaries of the exterior walls to the centerline of interior demising walls without deductions for cutouts, curves, or architectural features. This method typically results in quoted dimensions greater than the dimensions that would be determined by using other accepted methods. The definition of "Unit" and the calculation method to be relied upon is set forth by the Developer in Developer's prospectus which method may result in a square footage calculation less than the result of the calculation method used here. Renderings depict features not included with purchase, but which are available at an additional cost such as wine bar and closet millwork among others. Consult the Developer's prospectus to learn what is included with Unit purchase and to understand Unit dimensions. 2023 © Carlton Terrace Owner LLC, with all rights reserved.

BAY  
PENTHOUSE FLOORS

# C 22, 23, 24

- 5 BEDROOMS
- 9 BATHROOMS
- POWDER ROOM
- 2 DEN / SERVICE
- FAMILY ROOM
- FITNESS STUDIO
- SKY ROOM
- OUTDOOR KITCHEN
- POOL
- PRIVATE ELEVATOR

INTERIOR  
8,677 SF | 806 SQM

EXTERIOR  
4,928 SF | 458 SQM

TOTAL  
13,605 SF | 1,264 SQM

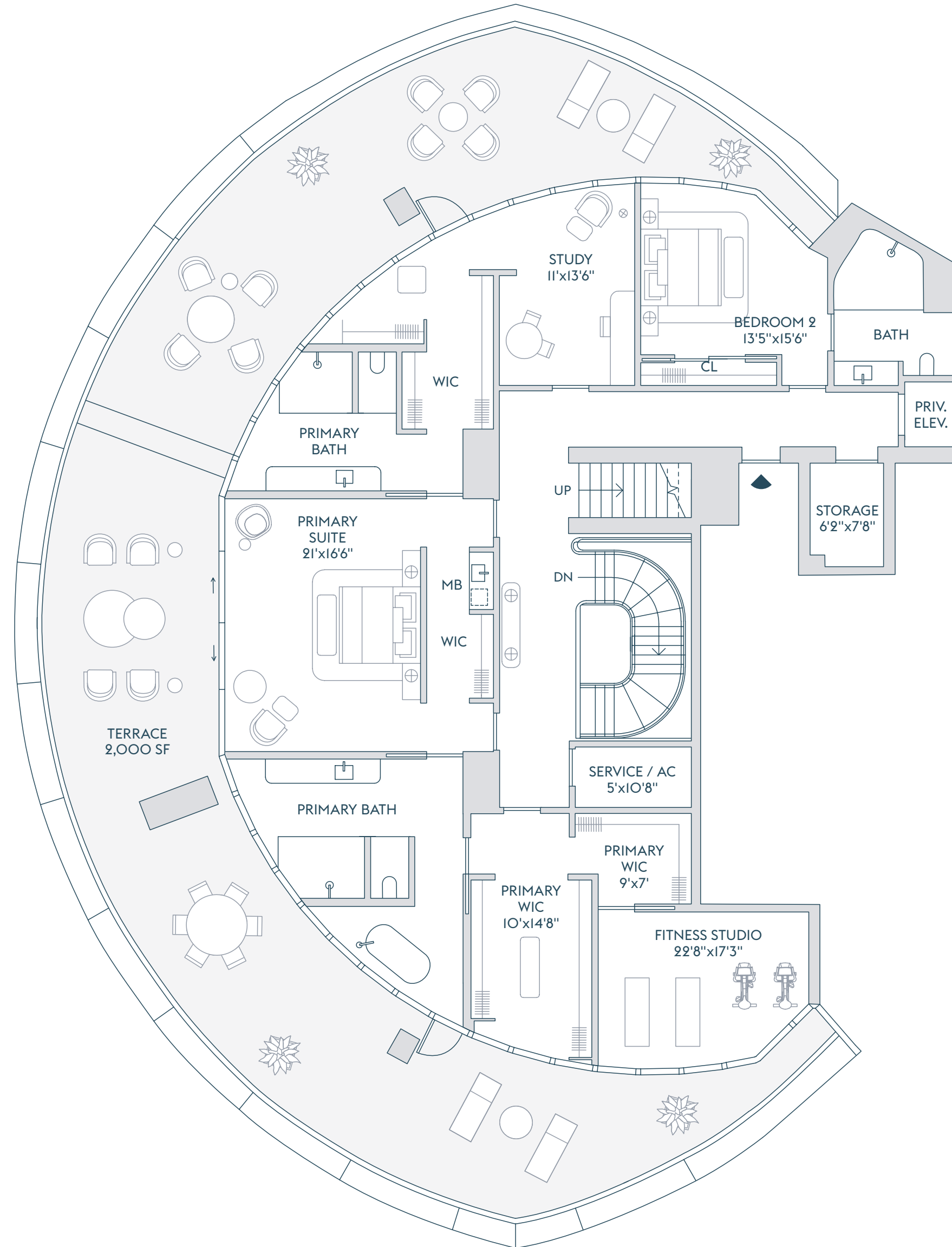

INTRACOASTAL  
WATERS

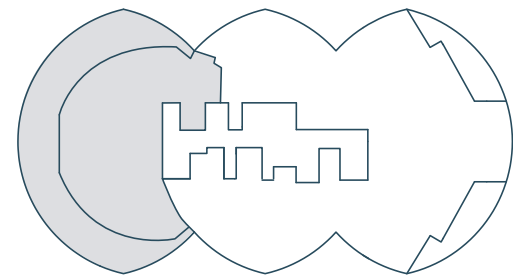

ATLANTIC OCEAN

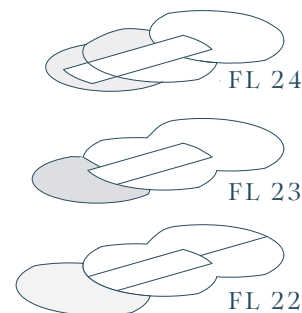

FLOOR 23

The dimensions stated for this floor plan are approximate because there are various recognized methods for calculating the square footage of a unit. The square footage stated here is calculated from the exterior boundaries of the exterior walls to the centerline of interior demising walls without deductions for cutouts, curves, or architectural features. This method typically results in quoted dimensions greater than the dimensions that would be determined by using other accepted methods. The definition of "Unit" and the calculation method to be relied upon is set forth by the Developer in Developer's prospectus which method may result in a square footage calculation less than the result of the calculation method used here. Renderings depict features not included with purchase, but which are available at an additional cost such as wine bar and closet millwork among others. Consult the Developer's prospectus to learn what is included with Unit purchase and to understand Unit dimensions. 2023 © Carlton Terrace Owner LLC, with all rights reserved.

# C 22, 23, 24

- 5 BEDROOMS
- 9 BATHROOMS
- POWDER ROOM
- 2 DEN / SERVICE
- FAMILY ROOM
- FITNESS STUDIO
- SKY ROOM
- OUTDOOR KITCHEN
- POOL
- PRIVATE ELEVATOR

INTERIOR  
8,677 SF | 806 SQM

EXTERIOR  
4,928 SF | 458 SQM

TOTAL  
13,605 SF | 1,264 SQM

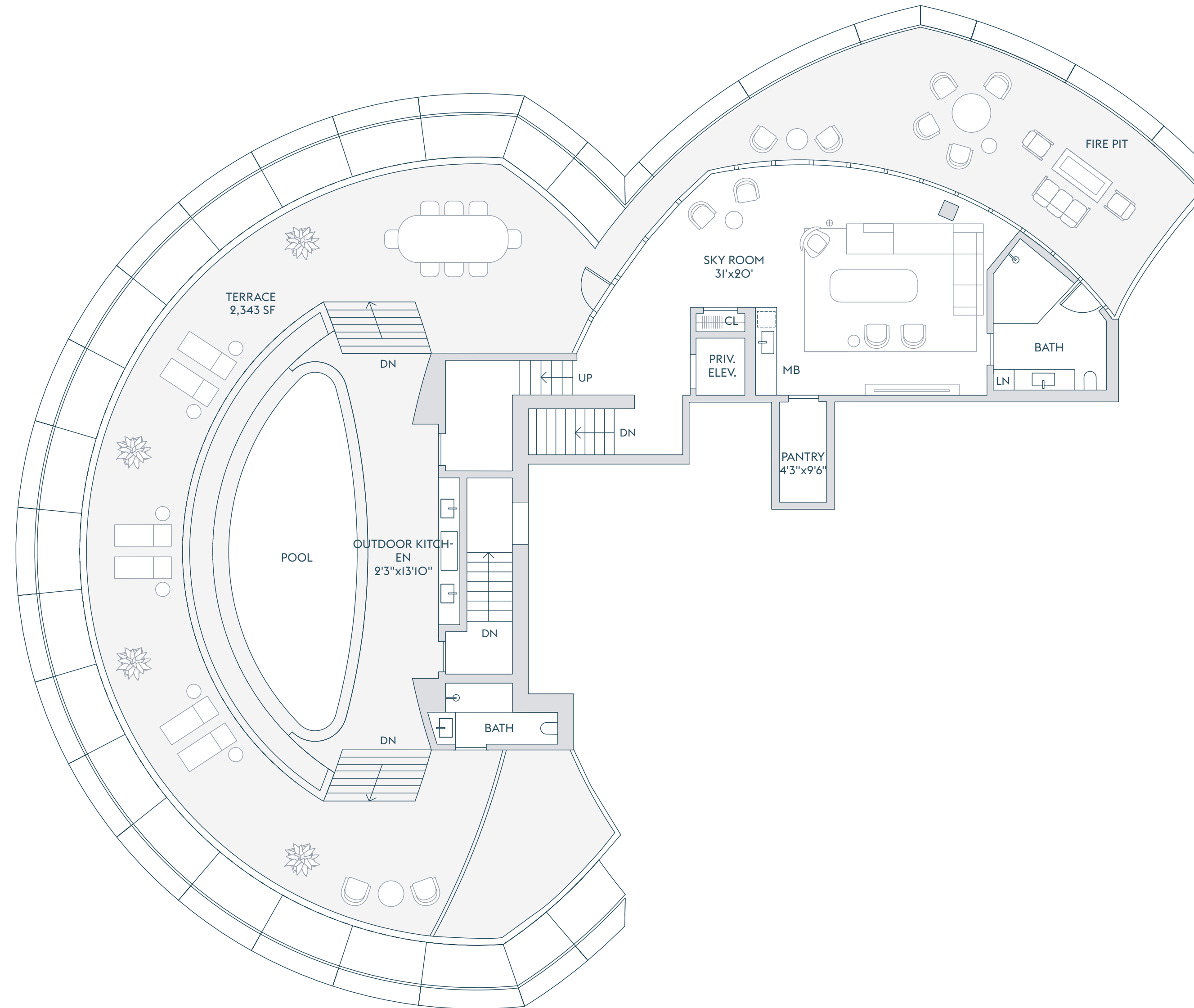

INTRACOASTAL  
WATERS

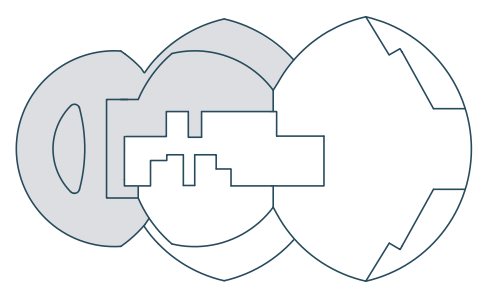

ATLANTIC OCEAN

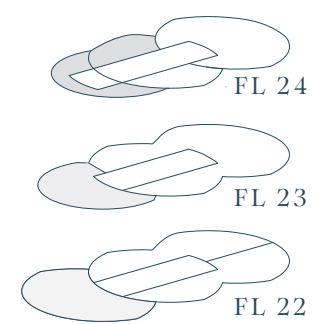

FLOOR 24

The dimensions stated for this floor plan are approximate because there are various recognized methods for calculating the square footage of a unit. The square footage stated here is calculated from the exterior boundaries of the exterior walls to the centerline of interior demising walls without deductions for cutouts, curves, or architectural features. This method typically results in quoted dimensions greater than the dimensions that would be determined by using other accepted methods. The definition of "Unit" and the calculation method to be relied upon is set forth by the Developer in Developer's prospectus which method may result in a square footage calculation less than the result of the calculation method used here. Renderings depict features not included with purchase, but which are available at an additional cost such as wine bar and closet millwork among others. Consult the Developer's prospectus to learn what is included with Unit purchase and to understand Unit dimensions. 2023 © Carlton Terrace Owner LLC, with all rights reserved.

# A 22, 24

- 6 BEDROOMS
- 9 BATHROOMS
- 2 POWDER ROOMS
- DEN
- SERVICE
- FAMILY ROOM
- SKY ROOM
- WINE ROOM
- OUTDOOR KITCHEN
- SPA POOL
- PRIVATE ELEVATOR

INTERIOR  
9,464 SF | 879 SQM

EXTERIOR  
1,346 SF | 125 SQM

TOTAL  
10,810 SF | 1,004 SQM

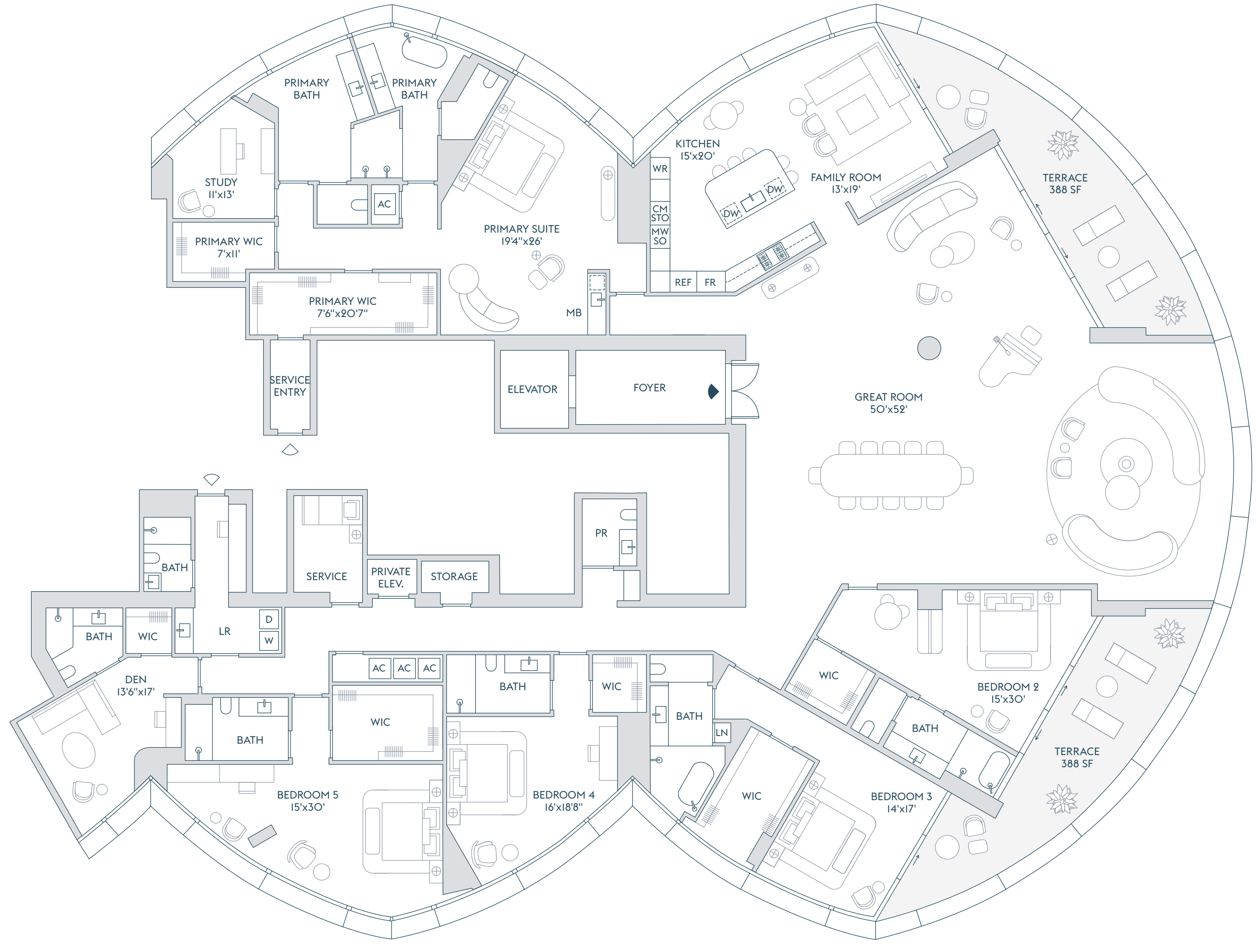

INTRACOASTAL  
WATERS

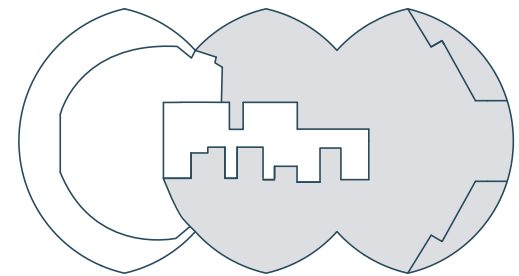

ATLANTIC OCEAN

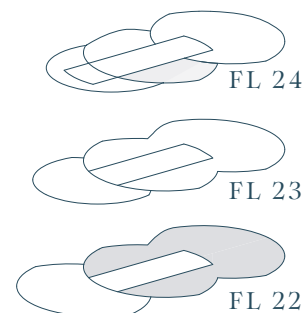

FLOOR 22

The dimensions stated for this floor plan are approximate because there are various recognized methods for calculating the square footage of a unit. The square footage stated here is calculated from the exterior boundaries of the exterior walls to the centerline of interior demising walls without deductions for cutouts, curves, or architectural features. This method typically results in quoted dimensions greater than the dimensions that would be determined by using other accepted methods. The definition of "Unit" and the calculation method to be relied upon is set forth by the Developer in Developer's prospectus which method may result in a square footage calculation less than the result of the calculation method used here. Renderings depict features not included with purchase, but which are available at an additional cost such as wine bar and closet millwork among others. Consult the Developer's prospectus to learn what is included with Unit purchase and to understand Unit dimensions. 2023 © Carlton Terrace Owner LLC, with all rights reserved.

LOWER  
PENTHOUSE FLOORS

# A 22, 24

- 6 BEDROOMS
- 9 BATHROOMS
- 2 POWDER ROOMS
- DEN
- SERVICE
- FAMILY ROOM
- SKY ROOM
- WINE ROOM
- OUTDOOR KITCHEN
- SPA POOL
- PRIVATE ELEVATOR

INTERIOR  
9,464 SF | 879 SQM

EXTERIOR  
1,346 SF | 125 SQM

TOTAL  
10,810 SF | 1,004 SQM

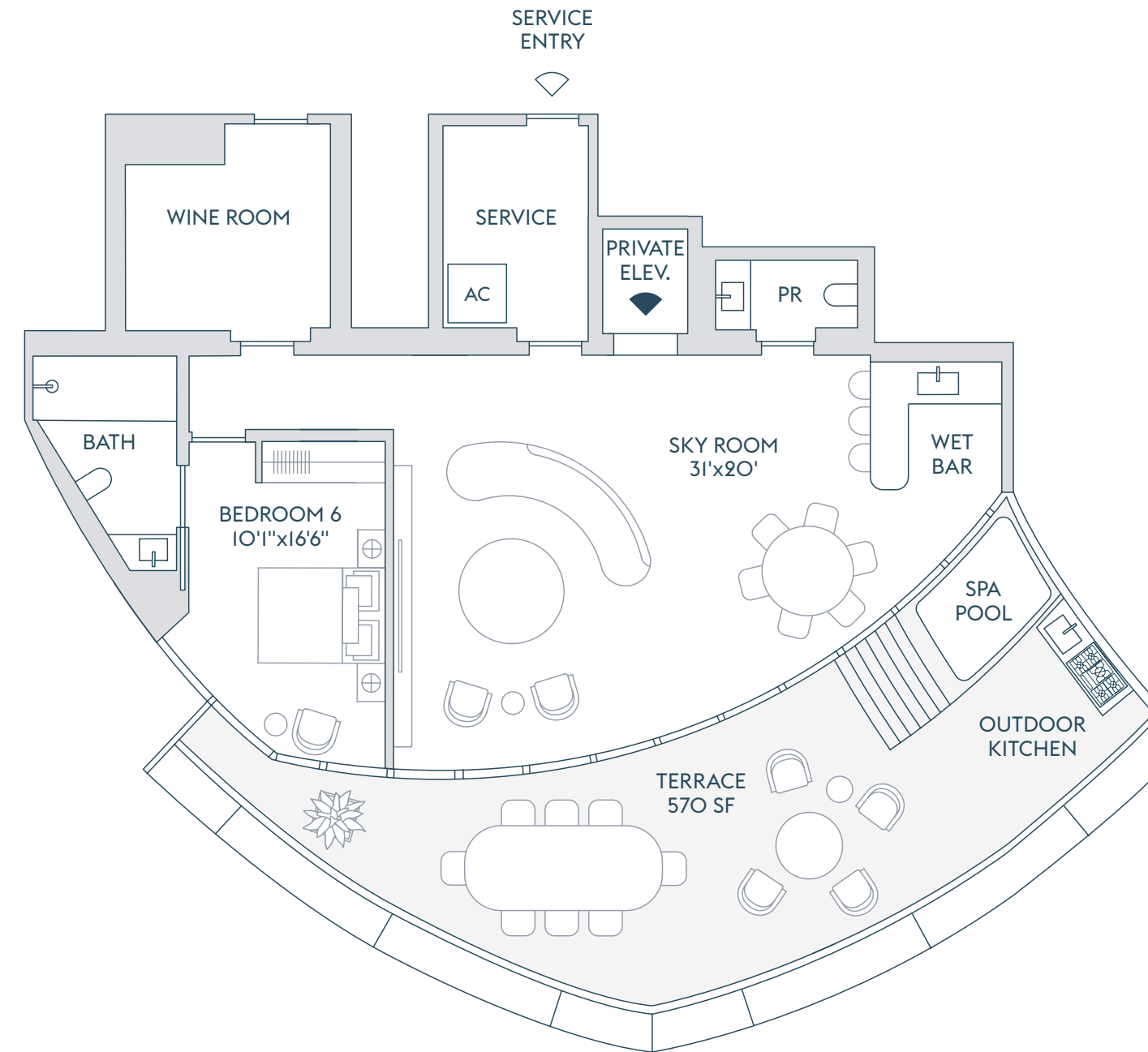

INTRACOASTAL  
WATERS

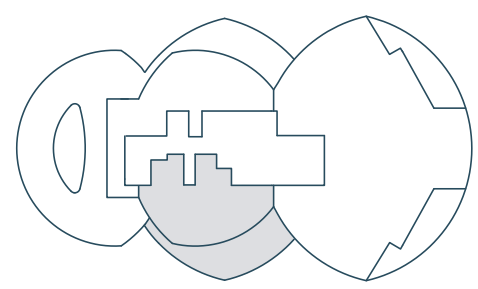

ATLANTIC OCEAN

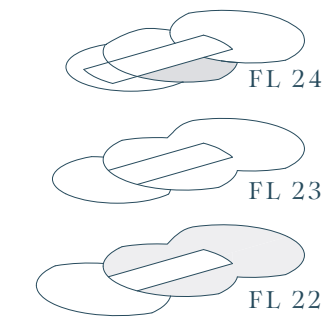

FLOOR 24

The dimensions stated for this floor plan are approximate because there are various recognized methods for calculating the square footage of a unit. The square footage stated here is calculated from the exterior boundaries of the exterior walls to the centerline of interior demising walls without deductions for cutouts, curves, or architectural features. This method typically results in quoted dimensions greater than the dimensions that would be determined by using other accepted methods. The definition of "Unit" and the calculation method to be relied upon is set forth by the Developer in Developer's prospectus which method may result in a square footage calculation less than the result of the calculation method used here. Renderings depict features not included with purchase, but which are available at an additional cost such as wine bar and closet millwork among others. Consult the Developer's prospectus to learn what is included with Unit purchase and to understand Unit dimensions. 2023 © Carlton Terrace Owner LLC, with all rights reserved.



The background is an abstract watercolor composition. It features a variety of colors including shades of teal, light blue, dark blue, purple, and brown. The colors are layered and blended, with some areas appearing as if they are torn pieces of paper pasted onto a white surface. The overall effect is organic and artistic.

# Amenities



PORTE COCHÈRE

ARTIST'S CONCEPTUAL RENDERING; SURROUNDING BUILDINGS, LANDSCAPES, AND LANDMARKS MODIFIED OR OMITTED.



ARTIST'S CONCEPTUAL RENDERING; SURROUNDING BUILDINGS, LANDSCAPES, AND LANDMARKS MODIFIED OR OMITTED.

SUNRISE POOL FOR MORNING SUN AND OCEAN VIEWS



ARTIST'S CONCEPTUAL RENDERING; SURROUNDING BUILDINGS, LANDSCAPES, AND LANDMARKS MODIFIED OR OMITTED.

SUNRISE POOL



SUNSET POOL FOR EVENING RELAXATION

ARTIST'S CONCEPTUAL RENDERING; SURROUNDING BUILDINGS, LANDSCAPES, AND LANDMARKS MODIFIED OR OMITTED.



READING LOUNGE

ARTIST'S CONCEPTUAL RENDERING; SURROUNDING BUILDINGS, LANDSCAPES, AND LANDMARKS MODIFIED OR OMITTED.



FORMAL SITTING LOUNGE

ARTIST'S CONCEPTUAL RENDERING; SURROUNDING BUILDINGS, LANDSCAPES, AND LANDMARKS MODIFIED OR OMITTED.



FORMAL SITTING LOUNGE



ARTIST'S CONCEPTUAL RENDERING.





COCKTAIL LOUNGE

ARTIST'S CONCEPTUAL RENDERING; SURROUNDING BUILDINGS, LANDSCAPES, AND LANDMARKS MODIFIED OR OMITTED.



OCEANFRONT DINING

ARTIST'S CONCEPTUAL RENDERING; SURROUNDING BUILDINGS, LANDSCAPES, AND LANDMARKS MODIFIED OR OMITTED.



PRIVATE DINING ROOM FOR RESIDENTS AND THEIR GUESTS

ARTIST'S CONCEPTUAL RENDERING.



SPA STAIRCASE WITH OCEAN VIEW

ARTIST'S CONCEPTUAL RENDERING; SURROUNDING BUILDINGS, LANDSCAPES, AND LANDMARKS MODIFIED OR OMITTED.



SPA ENTRANCE

ARTIST'S CONCEPTUAL RENDERING; SURROUNDING BUILDINGS, LANDSCAPES, AND LANDMARKS MODIFIED OR OMITTED.



SPA CORRIDOR AND TREATMENT ROOM



ARTIST'S CONCEPTUAL RENDERING.





ARTIST'S CONCEPTUAL RENDERING.

HOT AND COLD PLUNGE POOLS





FITNESS

FITNESS CENTER PAVILION

ARTIST'S CONCEPTUAL RENDERING; SURROUNDING BUILDINGS, LANDSCAPES, AND LANDMARKS MODIFIED OR OMITTED.



ARTIST'S CONCEPTUAL RENDERING; SURROUNDING BUILDINGS, LANDSCAPES, AND LANDMARKS MODIFIED OR OMITTED.

FITNESS ROOM WITH SWEEPING OCEAN VIEWS



ARTIST'S CONCEPTUAL RENDERING.

GOLF SIMULATOR



ARTIST'S CONCEPTUAL RENDERING

CHILDREN'S PLAYROOM

The background is a watercolor painting with horizontal bands of color. From top to bottom, the colors are: purple, orange, green, and blue. The colors are blended and layered, creating a soft, textured effect. The word "Neighborhood" is centered in the middle of the image in a dark blue, serif font.

Neighborhood



WELCOME TO THE AMERICAN RIVIERA

Since its inception in 1929, Bal Harbour has been an elite enclave on the tiny tip of this barrier island. It is unquestionably the most sophisticated and culturally rich version of South Florida's glamorous lifestyle.

This unparalleled location offers both a sense of privacy and convenient access to entertainment, dining, shopping, transportation and recreation.



A favorite of snowbirds from the beginning, the town welcomed the now-legendary Bal Harbour Shops in 1965 with a caliber of stores unrivaled by Manhattan's Madison and Fifth Avenues and the Champs-Élysées in Paris.





The village is also home to Unscripted Bal Harbour, a renowned public art program, and to its Art Access program that provides complimentary admission for residents and their guests to some of the area's finest museums.





Miami-Opa Locka Executive Airport

Fort Lauderdale-Hollywood International Airport

SUNNY ISLES

NORTH MIAMI

Haulover Beach

INTRACOASTAL WATERS

Bal Harbour Marina

The Ritz-Carlton Bal Harbour

BAL HARBOUR VILLAGE

RIVAGE

Miami Design District

Wynwood Art District

BAY HARBOR ISLANDS

Bal Harbour Shops

The St. Regis Bal Harbour Resort

Four Seasons Hotel at The Surf Club

INTRACOASTAL WATERS

Indian Creek Country Club

La Gorce Country Club

SURFSIDE

ATLANTIC OCEAN

Miami International Airport & Downtown Miami

SOUTH BEACH

### Perfectly Situated

- Bal Harbour Shops (0.5 miles)
- Bal Harbour Marina (0.5 miles)
- The Ritz-Carlton Bal Harbour (0.5 miles)
- The St. Regis Bal Harbour Resort (0.5 miles)
- Four Seasons Hotel at The Surf Club (1.5 miles)
- Haulover Beach (2.5 miles)
- Indian Creek Country Club (3 miles)
- La Gorce Country Club (4.5 miles)
- South Beach
  - Sunset Harbor (8 miles)
  - South of Fifth (9.5 miles)
- Miami Design District (10 miles)
- Miami-Opa Locka Executive Airport (11 miles)
- Wynwood Art District (11 miles)
- Downtown Miami (14 miles)
- Fort Lauderdale-Hollywood International Airport (16 miles)
- Miami International Airport (16 miles)

The background is a watercolor-style illustration. It features a central, faint outline of a globe or a similar spherical shape. The colors are primarily shades of blue, green, and yellow, with some darker blue and brownish tones. The watercolor effect is soft and blended, with some areas appearing more saturated than others. The overall composition is abstract and artistic.

Team

A LUMINARY TEAM

SOM

DESIGN ARCHITECT

Rottet Studio

INTERIOR DESIGNER

Enea Garden Design

LANDSCAPE ARCHITECT

Related Group

DEVELOPER

Two Roads  
Development

DEVELOPER

Douglas Elliman  
Development Marketing

EXCLUSIVE SALES AND MARKETING PARTNER



# Thank you

ORAL REPRESENTATIONS CANNOT BE RELIED UPON AS CORRECTLY STATING REPRESENTATIONS OF THE DEVELOPER. FOR CORRECT REPRESENTATIONS, MAKE REFERENCE TO THIS BROCHURE AND TO THE DOCUMENTS REQUIRED BY SECTION 718.503, FLORIDA STATUTES, TO BE FURNISHED BY A DEVELOPER TO A BUYER OR LESSEE.

New York Residents: THE COMPLETE OFFERING TERMS ARE FOUND IN A CPS-12 APPLICATION AVAILABLE FROM THE OFFEROR. FILE NO. CP23-0060.

WARNING: THE CALIFORNIA DEPARTMENT OF REAL ESTATE HAS NOT INSPECTED, EXAMINED, OR QUALIFIED THIS OFFERING.

THIS CONDOMINIUM HAS ALSO BEEN REGISTERED WITH THE MASSACHUSETTS BOARD OF REGISTRATION OF REAL ESTATE BROKERS AND SALESPERSONS F-1284-01-01.

RIVAGE BAL HARBOUR CONDOMINIUM is developed by Carlton Terrace Owner LLC ("Developer" or "Offeror"). This offering is made only by the Developer's Prospectus for the Condominium. Consult the Developer's Prospectus for the proposed budget, terms, conditions, specifications, fees, and Unit dimensions. Sketches, renderings, or photographs depicting use of space, design, furnishings, lifestyle, amenities, food services, club services, rental services, hosting services, finishes, materials, fixtures, appliances, cabinetry, soffits, lighting, countertops, floor plans, or art are proposed only, and the Developer reserves the right to modify or withdraw the same in its sole discretion. No specific view is guaranteed. No specific use of space is guaranteed. Pursuant to license agreements, Developer has a right to use the trade names, marks, and logos of: (1) The Related Group; and (2) Two Roads Development, each of which is a licensor. This is not intended to be an offer to sell, or solicitation of an offer to buy, condominium units to residents of any jurisdiction where prohibited by law. 2023 © Carlton Terrace Owner LLC, with all rights reserved.