



COMMERCIAL LAND FOR SALE ON ROUTE 1

1.35 ACRES / THREE PARCELS

ROUTE 1 / PROVIDENCE HIGHWAY WALPOLE, MASSACHUSETTS 02081



PROPERTY DESCRIPTION

- 1.35 Acres - Three Parcels
- Located on Route 1 (Providence Highway)
- Northeast quadrant of Providence Highway and Hilltop Drive
- Property is zoned as Highway Business
- Property being sold "as is" "where is"
- Buyer to perform all due diligence
- Located in front of The Preserve, a large multi family complex

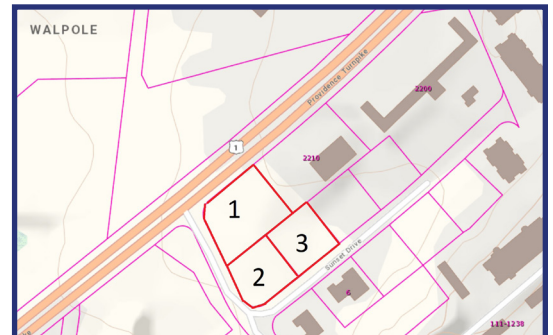

DAN GARDNER | DAN@DMGBROKERAGE.COM | O: 781.591.3232 X700
83 MORSE STREET, BUILDING #6 | NORWOOD, MA 02062 | 781.591.3232
WWW.DMGBROKERAGE.COM