

Cabinet Specifications

Framed / Traditional Engineering

Base & Vanity cabinet specifications

Standard cabinet box: Plywood construction

Interiors - Clear natural veneer plywood.

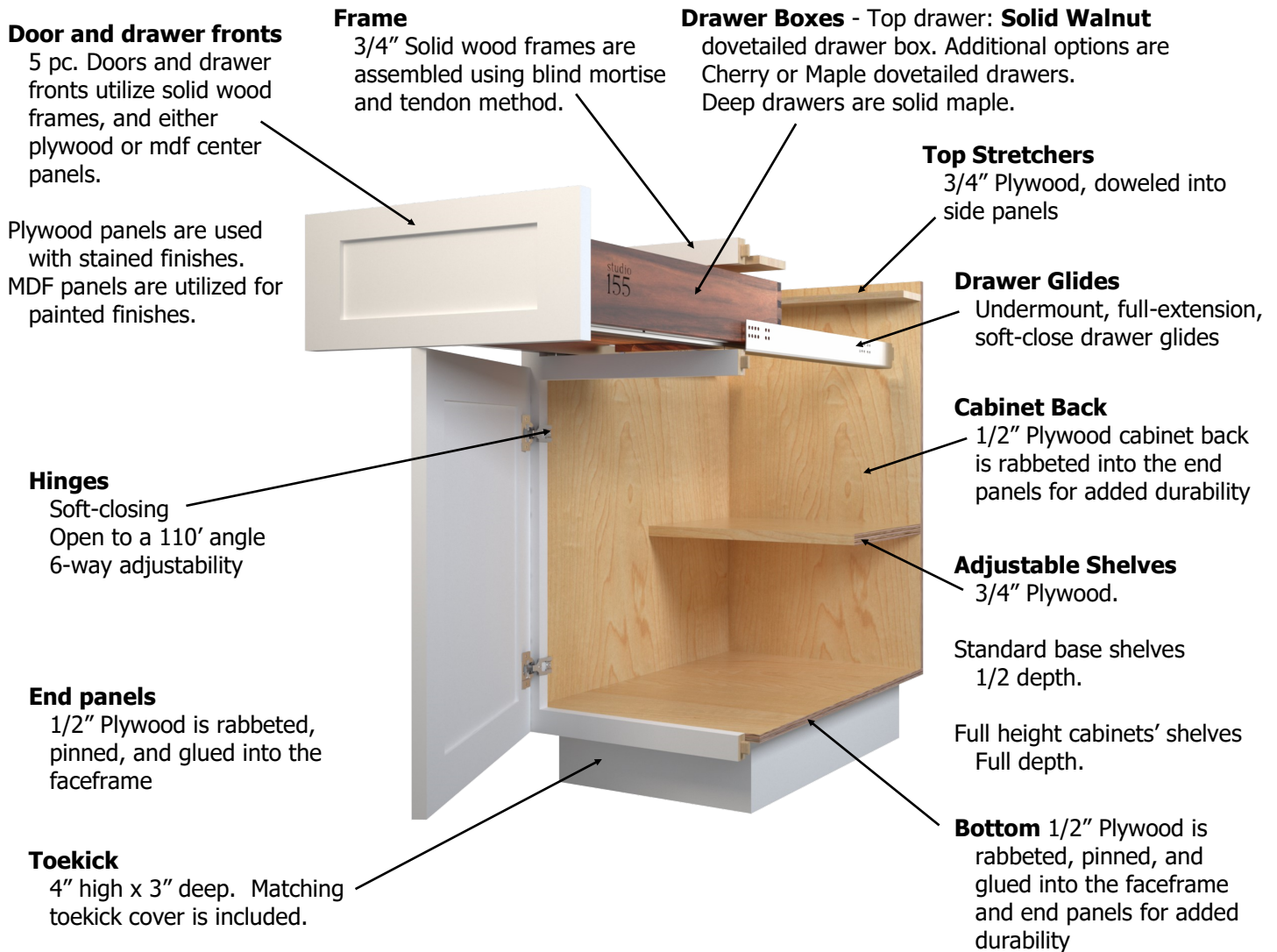

Finished end panels are 1/2" plywood with clear natural veneer on the inside and finished veneer on the exposed side.

Panels are set in 1/4" from the edge of the frame.
Flush decorative panels are available.

- **Full overlay, Flush Inset, or Beaded Inset overlay**
- **Cabinets over 36"** wide will have center stile
- **Finished interiors** to match the exterior are available
- **Cabinet specifications may change without notice**