

# Cabinet Specifications

## Framed / Traditional Engineering

### Base cabinet specifications

**Standard cabinet box: Plywood construction**

**Wall cabinets 13" deep unless specified**

**Interiors** - Clear natural veneer plywood.

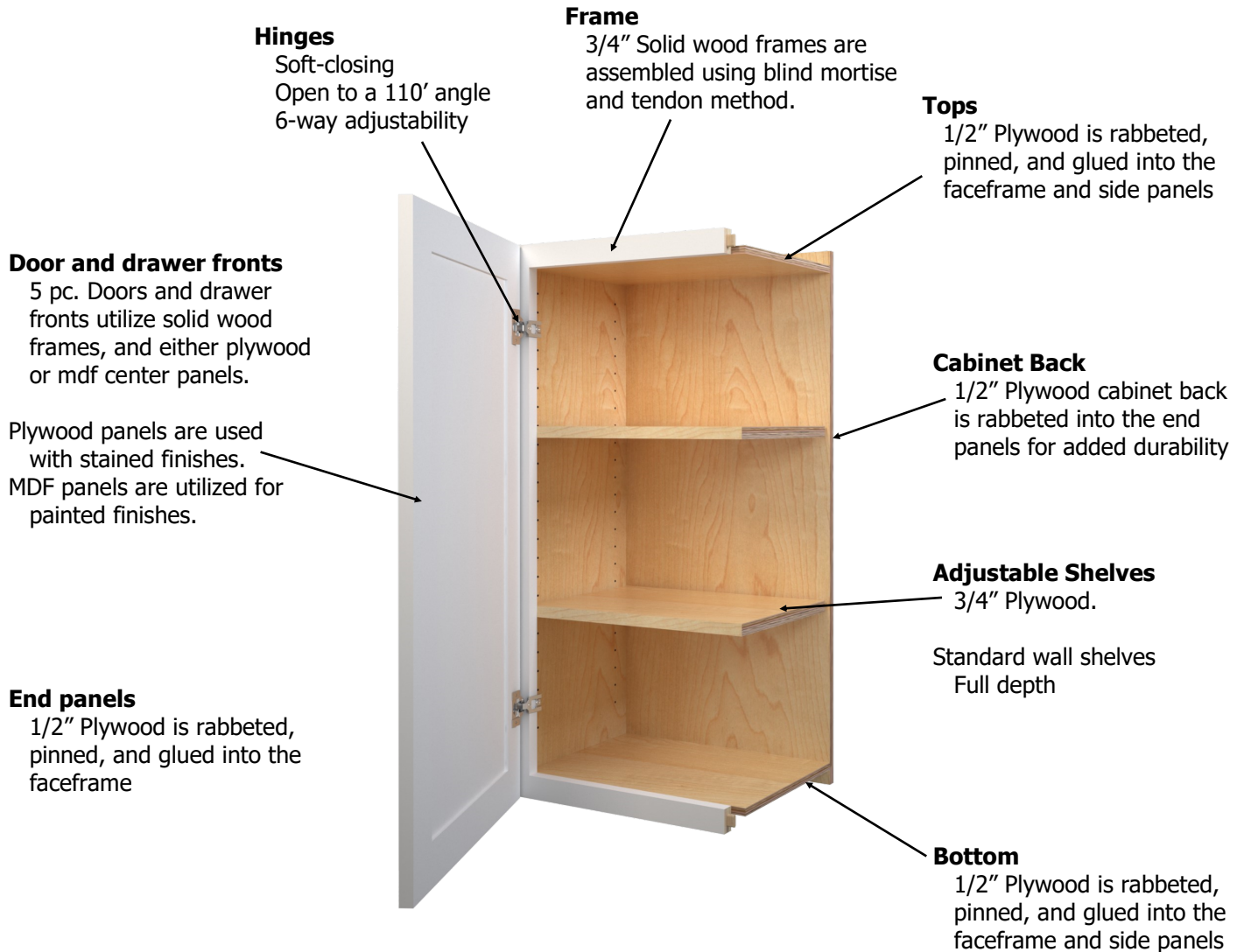

**Finished end panels** are 1/2" plywood with clear natural veneer on the inside and finished veneer on the exposed side.

Panels are set in 1/4" from the edge of the frame.  
Flush decorative panels are available.

- **Full overlay, Flush Inset, or Beaded Inset overlay**
- **Cabinets 39" wide and over** will have center stile
- **Finished interiors** to match the exterior are available
- **Cabinet specifications may change without notice**