

HOW TO INSTALL A DOUBLE GLAZED SLIDING DOOR - by Perception Windows

23/05/2016

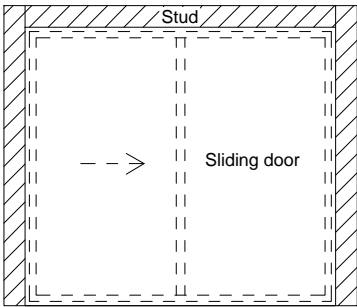

Check that opening is level. Measure opening to ensure that it allows a 20mm gap around Sliding door.

1. PREPARE WINDOW OPENING

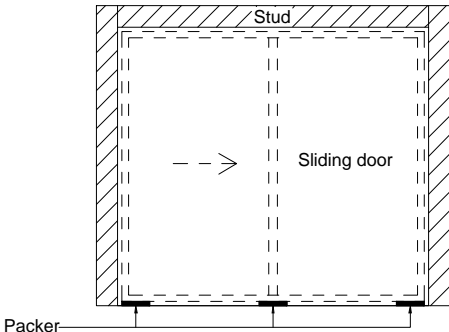

Fit Sliding door into opening, pack under door jambs until level. Temp tack door in through the reveals.

2. INSTALL WINDOW TO OPENING

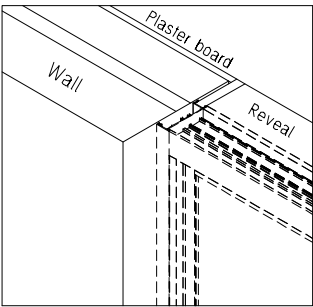

Position window into opening, until reveals align with plaster.
If un-plastered, window reveal needs to extend for 10mm with stud internally.

3. Positioning

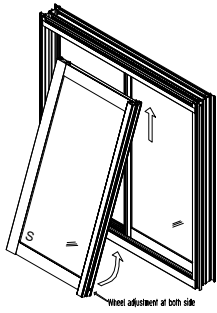

lift active door panel into head cavity until clear sill and position in place.
Slide door closed to check alignment.

4. FIT ACTIVE DOOR PANEL

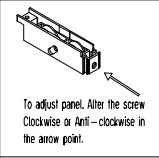

Check the gap between the door frame and door panel are leveled. repack as required and pre test the operation. Adjust as required and once level and operating then nail. After installed, adjust active door panel as per image below if required.

5. ADJUST DOOR PANEL