

HOW TO INSTALL A DOUBLE GLAZED AWNING WINDOW - PERCEPTION WINDOWS

23/05/2016

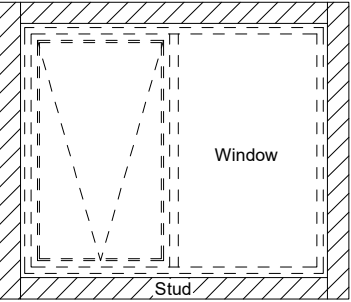

Check that opening is level. Measure opening to ensure that it allows a 20mm gap around window.

1. PREPARE WINDOW OPENING

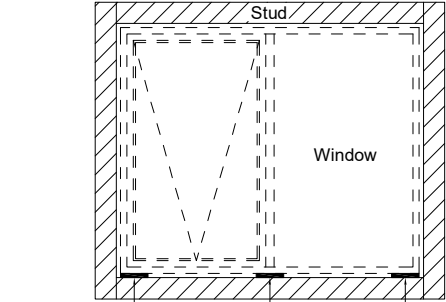

Fit window into opening, pack under window jambs and mullion(if has one) until level. Temp tack window in through the reveals.

2. INSTALL WINDOW TO OPENING

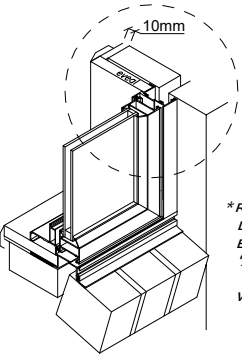

Position window into opening, until reveals align with plaster.
If un-plastered, window reveal needs to extend for 10mm with stud internally.

3. Positioning

**REVEAL DEPTH TO STANDARD WALL TYPES:
DOUBLE BRICK WALL - 130MM
BRICK VENEER - 110MM
75MM~100MM FOAM WALL - 110MM
10MM FC SHEET - 70MM
WEATHERBOARD - 85MM*

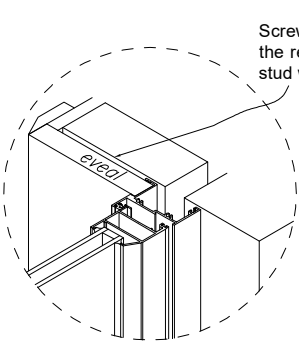

Check the gap between the window frame and sash are even from the front. repack as required and pre test the operation. Adjust as required and once level and operating then nail.

4. Fixing

5. ADJUST WINDOW SASH